

Windigaga

ROOM TO ROOM VENTILATION FAN

Model: BT-RTR08-LCD



We Are Here For You !
Support: support@windigaga.com

The user manual contains important safety information.
Please read and keep it for future reference.







INSTRUCTION >>

CONTENTS







Important Safeguards	01
Specifications	03
Parts List	03
Product Overview	04
Installation Guide	05
Controller Operation	08
– Smart Controller	08
– Mode Programming	09
Remote Control	12
FAQ	13
Warranty	14

IMPORTANT SAFEGUARDS

WARNING

-  Failure to follow these instructions may result in electric shock, fire, personal injury, or damage to the unit.
-  This symbol indicates important safety information. The accompanying illustration shows a warning: "Be careful of electric shock."
-  Always unplug the fan before moving it to a different location.
-  Use only with a power supply that matches the rated voltage. Using an incompatible power source may cause fire or electric shock.
-  Stop using the fan immediately if you notice smoke, unusual odors, abnormal motor sounds, or any other malfunction. Continued use may result in fire or electric shock.
-  Do not attempt to disassemble, repair, or modify the unit while it is in operation. This can lead to electric shock, fire, or personal injury.

CAUTION

-  Do not use the fan in or near a window. Exposure to rain may cause electrical hazards.
-  Do not damage, modify, excessively bend, pull, bind or place heavy objects on the power cord. Doing so may cause electric leakage, fire, or electric shock.
-  If the fan will not be used for an extended period, unplug it from the power outlet.
-  If the power cord is damaged, do not attempt to repair it yourself. Contact your local service center or a qualified electrician for replacement to avoid risk of injury or damage.
-  Never insert fingers, pencils, or any other objects through the safety guard while the fan is operating.
-  When unplugging the fan, always hold the plug—do not pull the cord. Pulling the cord may damage it and cause electric shock or fire.
-  Always disconnect the power before cleaning the fan.

FCC Warning Statement:

Changes or modifications not expressly approved by the party responsible for compliance could void the user's authority to operate the equipment. This equipment has been tested and found to comply with the limits for a Class B digital device, pursuant to Part 15 of the FCC Rules. These limits are designed to provide reasonable protection against harmful interference in a residential installation. This equipment generates, uses, and can radiate radio frequency energy and, if not installed and used in accordance with the instructions, may cause harmful interference to radio communications. However, there is no guarantee that interference will not occur in a particular installation. If this equipment does cause harmful interference to radio or television reception, which can be determined by turning the equipment off and on, the user is encouraged to try to correct the interference by one or more of the following measures:

- Reorient or relocate the receiving antenna.
- Increase the separation between the equipment and receiver.
- Connect the equipment into an outlet on a circuit different from that to which the receiver is connected.
- Consult the dealer or an experienced radio/TV technician for help.

This device complies with part 15 of the FCC Rules. Operation is subject to the following two conditions:

- (1) This device may not cause harmful interference, and
- (2) this device must accept any interference received, including interference that may cause undesired operation.



FCC-ID: 2BCGA-BT-RTR08-LCD

SPECIFICATIONS

Model No.	BT-RTR08-LCD
Power	10W
Power Supply	120V~ 60Hz
Operating Humidity	35%-85% RH
Operating Temperature	14°F-120°F
Maximum Airflow	320 CFM
Product Dimensions	10.12 x 10.12 x 4.5 inches
Compatible Wall Thickness	3.5 to 6.2 inches

PARTS LIST



Front Faceplate x1



Rear Faceplate x1

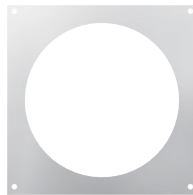

Front Faceplate
Stencil x1

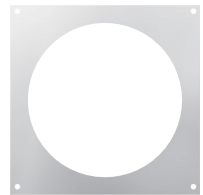

Rear Faceplate
Stencil x1



Screws and
Anchors x8



Adapter x1



Remote Control x1
(Batteries not included)



User Manual x1

PRODUCT OVERVIEW

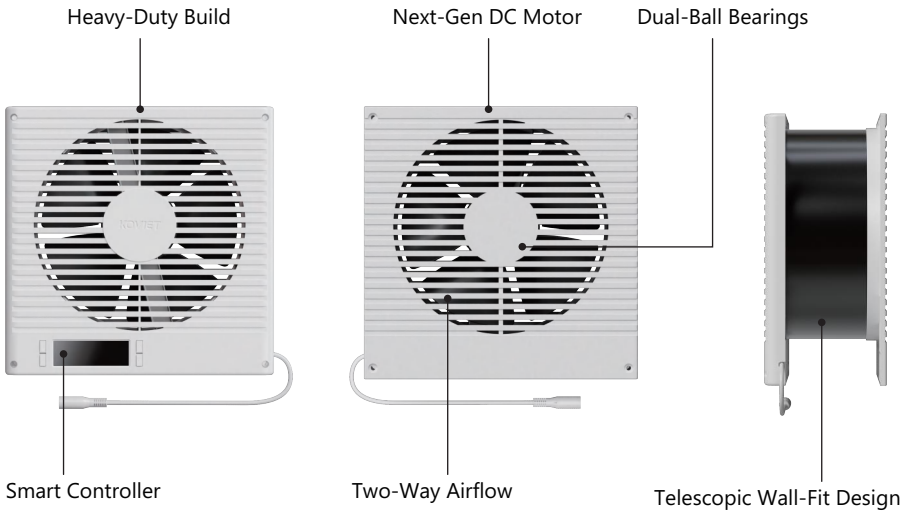

Application

This model improves ventilation between rooms through wall fans, making it ideal for offices, workshops, recreation rooms, laundry rooms, bedrooms, guest rooms, and other areas that might not otherwise have access to proper airflow.

Pwm Control Fans

The system utilizes high-performance DC motors controlled by PWM (Pulse Width Modulation). This technology allows the dual fans to operate smoothly at extremely low RPM speeds without generating motor or electromagnetic noise. Additionally, the fans feature blades designed with a high static pressure rating, making them perfect for applications where airflow is restricted, such as through ductwork. The motor housing allows the fan system to be mounted either horizontally or vertically.

INSTALLATION GUIDE

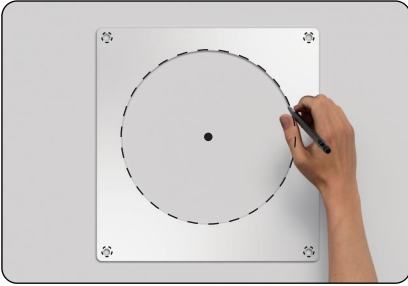

Step 1

Choose a mounting location free of obstructions (e.g., studs, waterlines, electrical cords, etc.). Ensure the wall is 3.5 to 6.2 inches thick.

Use the **rear faceplate stencil** to mark the center point, mounting points, and the circular outline.

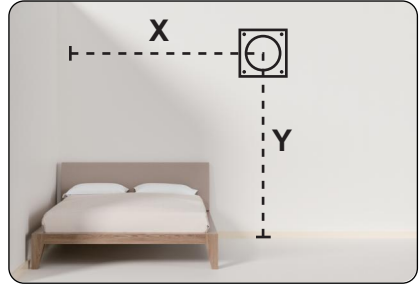

Step 2

From the center point, measure the distance to the end of the wall (X) and the height to the floor (Y).

Keep these measurements for Step 7.

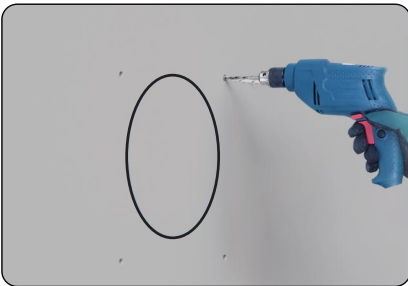

Step 3

Drill the mounting holes into the wall.

Cut the circular outline to create the opening using a saw for best results.





Step 4

Insert the included anchors into the mounting holes.

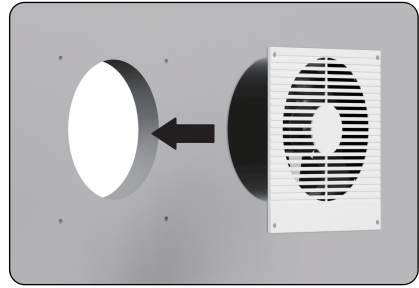

Step 5

Position the rear faceplate into the circular cutout, ensuring the mounting holes align.

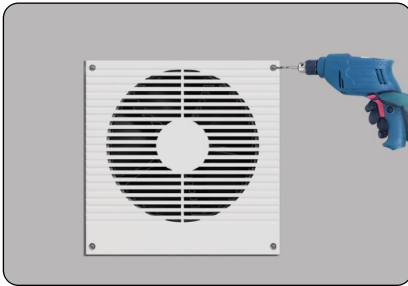

Step 6

Secure the rear faceplate by drilling the screws into the anchors.

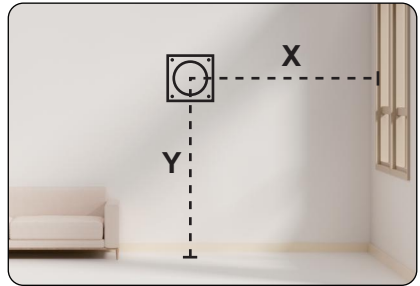

Step 7

On the opposite side of the wall, mark the center point using the length (X) and height (Y) from Step 2.

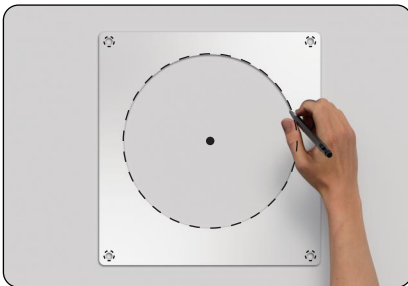

Step 8

Place the **front faceplate stencil** over the center point, then mark the mounting points and circular outline.

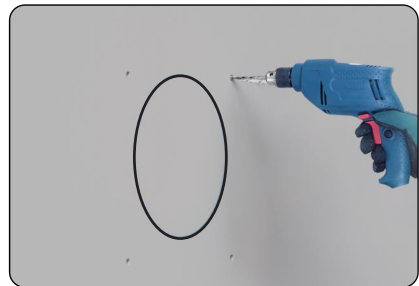

Step 9

Drill the mounting holes into the wall. Cut the circular outline to create the opening. Again, using a saw is recommended.



Step 10 Insert the included anchors into the mounting holes.

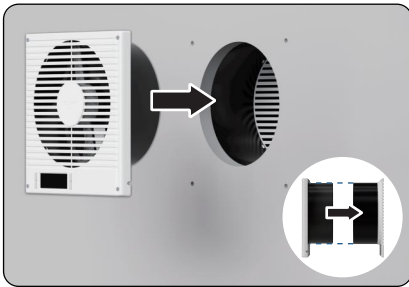
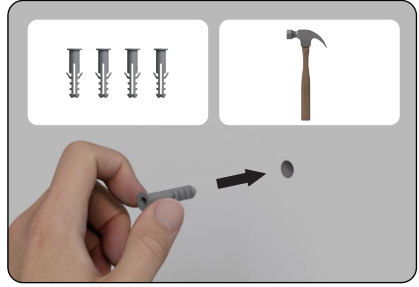

Step 11

Insert the front faceplate into the circular cutout, ensuring the mounting holes align. The cylinder should easily slide into the rear faceplate's cylinder.



Step 12

Route the power cord through the opening at the lower right corner to ensure the front faceplate is flush against the wall.

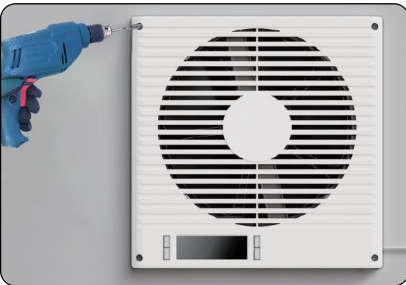

Step 13

Secure the front faceplate by drilling the screws into the anchors.

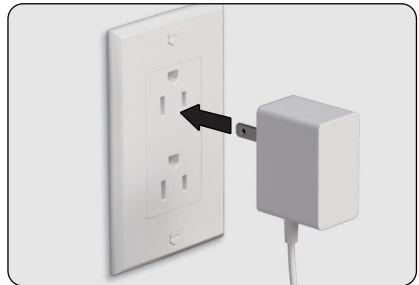

Step 14

Insert the power adapter cable into the unit's power socket. Then, plug the AC power cord into a wall outlet to power the fan.

CONTROLLER OPERATION

Smart Controller

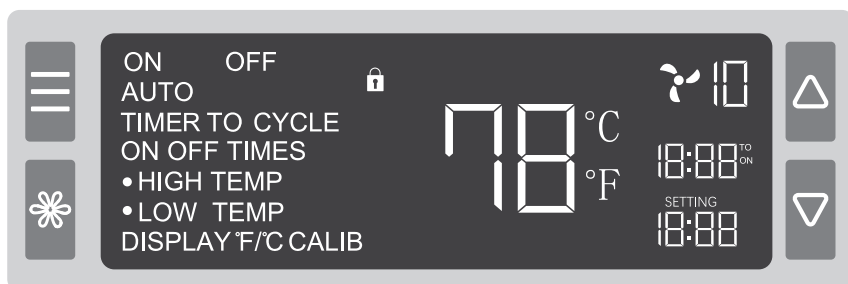

MODE Button

Cycles through the controller's modes: ON, OFF, AUTO (HIGH / LOW TEMP), TIMER (TIMER TO ON / OFF), and CYCLE (ON / OFF / CYCLE TIMES).



SETTING Button

Cycles through the controller's settings: DISPLAY, °F/°C, CALIB, and F/R (airflow direction).



UP / DOWN Buttons

Adjusts values in the selected mode.  increases the value,  decreases it.



Controller Mode / Setting

Displays the current operating mode or setting.



Child Lock

Indicates when Child Lock is enabled. Press and hold  for 3 seconds to toggle.



Sensor Temperature

Displays the current room temperature.



Fan Speed Level

Displays the current fan speed level.



Countdown

Shows remaining time in TIMER mode (TIMER TO ON / OFF) or remaining cycles in CYCLE TIMES mode.



User Settings



Displays the current value for the selected mode.

Mode Programming

NOTE 1: Each mode functions independently. Only one mode can be active at a time.

NOTE 2: Mode settings are automatically saved, so there is no need to reconfigure after restarting the device.

ON Mode

- Press  to select ON mode.
- Use  to adjust the fan speed level (0-10).
- The speed set in this mode also applies to other modes.



OFF Mode

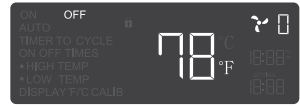

- Press  to select OFF mode.
- The fan will stop, and the speed will display as "0".



AUTO Mode



- Press  to enter AUTO mode.
- When either HIGH TEMP or LOW TEMP is enabled, the corresponding indicator will flash.

1. AUTO HIGH TEMP

- Use  to set the HIGH TEMP trigger.
- The fan will activate when the room temperature rises above the set value and gradually increase to the speed set in ON mode.
- To disable, press and hold  simultaneously for 3 seconds.



2. AUTO LOW TEMP

- While in HIGH TEMP mode, press  again to enter LOW TEMP.
- Use  to set the LOW TEMP trigger.
- The fan will activate when the room temperature falls below the set value and gradually increase to the speed set in ON mode.
- To disable, press and hold  simultaneously for 3 seconds.



3. Auto Range Setting (Factory setting)

- To operate the fan within a specific temperature range, set the HIGH TEMP trigger lower than the LOW TEMP trigger. **The fan will only work if the sensor temperature stays within this range.**



NOTE: 1. Both HIGH TEMP and LOW TEMP must be enabled for this function.

2. Factory setting is Auto range setting

TIMER Mode



- Press  to enter TIMER mode.
- This is a standalone mode used to set fan turn-on or turn-off timers. It cannot be used together with other modes.

TIMER TO ON

- Use   to set a startup countdown (max: 19h59min).
- After the countdown, the fan runs at the ON mode speed.



TIMER TO OFF



- While in TIMER TO ON mode, press  again to enter TIMER TO OFF.
- Use   to set a shutdown countdown (max: 19h59min).
- The fan stops when the countdown ends.



CYCLE Mode



- Press  to enter CYCLE mode. Set alternating ON and OFF durations for automatic cycling.

— Step 1 CYCLE ON

- Use   to set the ON duration (max: 19h59min).





— Step 2 CYCLE OFF

- Press  again to enter CYCLE OFF.
- Use   to set the OFF duration (max: 19h59min).





— Step 3 CYCLE TIMES

- After setting CYCLE OFF, press  again to enter CYCLE TIMES.
- Use   to adjust the number of cycles (max: 1999). The setting will confirm automatically after 3 seconds of inactivity.
- The fan will stop when the countdown reaches "0".
- "--" means unlimited continuous cycling based on ON/OFF durations.







DISPLAY Settings

- Press  to enter DISPLAY settings.
- Use   to switch brightness: Level 1, 2, 3, or "A3".
 - Level 3 = Maximum brightness
 - Level 1 = Minimum brightness
 - "A3" turns off the screen after 30 seconds of inactivity, while the fan keeps running.





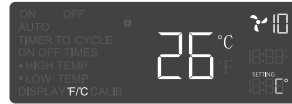

°F / °C Settings

- Press  to enter DISPLAY settings, then press  to select °F / °C.
- Use   to switch between Fahrenheit (°F) and Celsius (°C).
- All temperature readings will update accordingly.







CALIB Settings

- Press  to enter DISPLAY settings, then press  to select CALIB.
- Use   to manually calibrate the sensor temperature in 1-unit increments (range: -9 to 9) to match the actual temperature.



F/R Settings

- Press  to enter DISPLAY settings, then press  to select F/R.
- Use   to adjust airflow direction:
 - F (Forward Airflow)–Fan icon spins clockwise
 - R (Reverse Airflow)–Fan icon spins counterclockwise



REMOTE CONTROL



NOTE: Batteries are not included. Install 2 AAA batteries before using the remote.

ON

Press and hold for 5 seconds to pair the remote (beep confirms).

Press to enter ON mode. Use  to adjust the fan speed.

OFF

Press to enter OFF mode. The fan will stop running.

Press to enter AUTO mode.

AUTO

Use  to select HIGH TEMP or LOW TEMP.

Use  to set the trigger temperature. To disable HIGH TEMP or LOW TEMP, set the value to OFF (between 0 and -1).

TIMER

Press to enter TIMER mode.

Use  to select TIMER TO ON or TIMER TO OFF.

Use  to set the countdown.

Press to enter CYCLE mode.

CYCLE

Use  to select ON, OFF, or CYCLE TIMES.

Use  to set duration or cycle count.

Press to adjust airflow direction:

F/R

F (Forward Airflow)-Fan icon spins clockwise

R (Reverse Airflow)-Fan icon spins counterclockwise





Press to toggle buzzer sound.

Press and hold for 3 seconds to enable/disable child lock.



Press to enter DISPLAY settings.

Use  to adjust brightness.

Use  to switch between °F/ °C , CALIB, or F/R settings.

Q1 Why isn't the remote control working?

- a. The remote may not have been paired successfully. Press and hold ON button on the remote for 5 seconds until you hear a beep, indicating successful pairing.
- b. The remote requires 2 AAA batteries (not included in the package). Please do not use rechargeable batteries.
- c. Ensure that the plug is securely connected to the outlet. If the issue persists, try using a different power outlet. If the fan still does not turn on, please contact our customer support team for assistance.

Q2 What tools do I need to install this fan?

- a. We recommend the following tools for installation: pencil, ruler, tape measure, screwdriver, drill, drywall saw, and stud finder.

Q3 Where can I install this fan?

- a. You can install the fan in any desired location, except for windows, fire-rated walls, or exterior walls, as exposure to rain could cause product damage.

Q4 Why doesn't the fan work in AUTO mode when the set high or low temperature is reached?

- a. Check if the LOW TEMP trigger is set higher than the HIGH TEMP trigger. If so, the fan will only work within that specific temperature range. Disabling either the HIGH TEMP or LOW TEMP will restore normal operation.
- b. If the problem persists, please contact our customer support team for assistance.

Q5 How do I perform maintenance on this fan?

Step 1 Disconnect the power supply before cleaning or servicing the fan.

Step 2 Unscrew the bolts and remove the front grilles and fan blades.

Step 3 Clean the grilles and blades with warm, soapy water and a soft cloth. Do not use abrasive cleaners, wire brushes, or steel wool.

Step 4 Wipe the exterior with a dry cloth or use a light vacuum to remove dust.

WARRANTY

Windigaga warrants this product to be free of defects in material and workmanship for the applications specified in the Owner's Manual for a period of 24 months from date of purchase. This warranty only applies to the original purchaser of this product.

If you have any questions, you are welcome to contact us via email! We will get back to you within 24 hours.

Support: support@windigaga.com

※ Please have your order ID ready before contacting Customer Support



FCC-ID: 2B8CGA-BT-RTR08-LCD

