

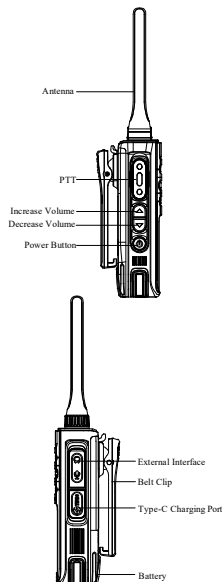

### Quick Operation Manual for Professional Walkie-Talkies

#### Familiarize with Product

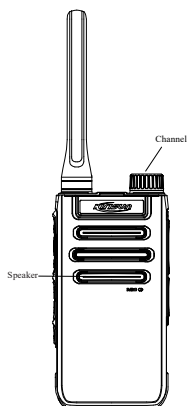

#### Unboxing Inspection

Please carefully open the packaging box and verify that it contains the items listed in the table below. If any items are missing or damaged, please contact your dealer promptly.

SN	Material Name	Quantity
1	Walkie-talkie	1
2	Charging Power Adapter	1
3	Power Cord	1
4	Battery	1
5	Belt Clip	1
6	Antenna	1
7	Lanyard	1
8	Certification of Conformity	1
9	User Manual	1
10	Charging Base (Optional)	1

#### Charging Method

1. Plug the charging power adapter into a suitable AC power outlet.
2. Lift the USB cover on the bottom side of the accessory cover, connect one end of the USB cable to the power adapter, and plug the other end into the TYPE-C port on the right side of the terminal. The blue indicator light turns on to start charging (please charge with the device off).
3. After about 4 hours of charging, the blue indicator light turns off, indicating the battery is fully charged.
4. Remove the charging power adapter from the AC power outlet.

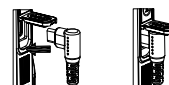

#### Charging Method: Dock Charger (Optional)

1. Plug the dock charger power adapter into a suitable AC power outlet.
2. Insert the walkie-talkie into the charging dock; the blue indicator light turns on to start charging (please charge with the device off).
3. After about 4 hours of charging, the blue indicator light turns off, indicating the battery is fully charged.
4. Remove the dock charger power adapter from the AC power outlet.

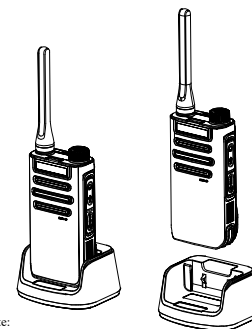

#### Note:

1. The walkie-talkie battery is not charged when it leaves the factory. Please charge the battery before the first use.
2. When charging the walkie-talkie with the battery, please turn off the walkie-talkie.
3. For a new battery's first charge or a battery that has been stored for a long time (over 2 months), it should be charged several times to reach normal capacity. Ensure that the battery is charged at least once every three months.



Kirisun Communication Co., Ltd.  
3rd Floor Building A, Trading Mart (Market) Harbour, No. 11 Langshan Road, Nanhai District, Shenzhen, 518057, P.R. China  
Tel: +86-755-86106898 | Email: marketing@kirisun.com | www.kirisun.com

167W06000688

#### Installing/Removing the Battery

##### Installing the Battery

1. Align the top of the battery with the battery installation position on the back of the walkie-talkie, and insert the battery.
2. Press the battery down and push the battery cover downwards until you hear a "click" sound, ensuring the battery latch is in the correct position.

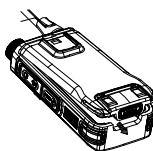

##### Removing the Battery

1. Press the bottom 【PUSH】 latch of the battery.
2. Once the battery is loosened, it can be removed.

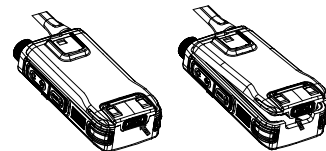

##### Note:

1. Do not short-circuit the battery terminals or dispose of the battery in fire.
2. Do not disassemble the battery casing on your own.

#### Installing/Removing the Antenna

1. For installation, insert the threaded end of the antenna into the antenna port at the top of the walkie-talkie, and rotate it clockwise until it is tight.
2. To remove the antenna, rotate it counterclockwise.

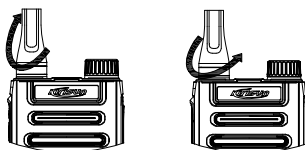

#### Installing/Removing the Belt Clip

##### Installing the Belt Clip

1. Flatten the belt clip bracket.
2. Align the raised rib on the back of the main unit's battery cover with the notch in the belt clip bracket.
3. Push the belt clip downward until you hear a "click" sound, indicating the belt clip is properly installed.

##### Removing the Belt Clip

1. Lift the spring latch on the belt clip bracket upwards to release it from the slot.
2. Push the belt clip upward to slide it out of the slot on top of the battery cover.
3. Remove the belt clip.

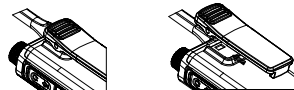

#### Basic Operations

##### 1. Turning On/Off the walkie-talkie

In the off state, press and hold the [Power] button for 5 seconds until you hear the announcement "Welcome to use", indicating successful power on.  
In the on state, press and hold the [Power] button for 5 seconds until you hear the announcement "OFF", indicating the device is turned off.

##### 2. Selecting a Channel

In standby mode, rotate the [Channel Knob] to select the desired channel.

##### 3. Adjusting Volume

To increase volume: Briefly press the side [▲] button to raise the volume, accompanied by a volume prompt sound from the speaker.  
To decrease volume: Briefly press the side [▼] button to lower the volume, accompanied by a volume prompt sound from the speaker.

##### 4. One-Click Frequency Matching Mode

- (1) Take down the antenna of "sub-telephone", press and hold the Power button and the side UP key until you hear "welcome to use", reporting the current channel, and then you hear a "tip" sound, the green light flashes once every 0.5 second, indicating entering the "Frequency matching mode".
- (2) Keep the walkie-talkie (mother telephone) to be intercommunicated 10 cm or less away from the "sub-telephone", and press and hold the Launch button until the frequency matching is successful and the green light of the "sub-telephone" is always on, the current channel number will be reported, at the moment, you can talk to each other.
- (3) When switching to other channels, just operate according to Step 2, then shut down and restart it to put an end to the frequency matching.

Note: If the operation of Step 2 fails, please switch the channel and try again.

##### 5. Dopy Mode

- (1) Take down the antenna of "sub-telephone", press and hold the Power button and the side Down key until you hear "welcome to use", reporting the current channel, and then you hear two "tip" sounds, the green light flashes once every 0.5 second, indicating entering the "Copy mode".
- (2) Operate according to Step 1 in other machines to be copied.
- (3) For the mother telephone, you do not need to take down the antenna and operate according to Step 1, keep it 10 cm or less away from the "sub-telephone", and press PTT button; the red indicator is always on, at the moment, it starts to copy the channel information in wireless way.
- (4) The green indicators of other copied machines are always on, until after receiving the signal, the machine will automatically shut down and the replication is completed.

Note: The copy is only applicable for the machines with the same model.

##### 6. Intercom Communication

Press the [PTT] key to initiate a call, then speak into the microphone using a normal voice tone. Keep the microphone about 3 to 5 centimeters from your lips for optimal sound quality. Release the [PTT] key to switch the walkie-talkie to receive mode.

#### LED Indicator

Indicator Light Status	Walkie-talkie Operating Status
Red Light On	Transmitting
Green Light On	Receiving signal.
Blue Light On	Charging the battery

#### Common Faults and Troubleshooting

SN	Failure Symptoms	Causes of Failure and Troubleshooting Methods
1	Won't Turn On	① Battery is dead: Please charge with a data cable or replace with a new battery. ② Faulty switch or other issues: Please visit a designated repair station for repair.
2	Low Volume in Walkie-talkie	① Speaking too far from the microphone: Optimal distance is 3-10cm. ② Incorrect volume setting: Increase the volume.
3	Unable to Intercom	① Incorrect channel parameter settings: Reset the parameters and try again. ② Check if the antenna is properly installed. ③ Exceeded the communication range of the device.

\*This device complies with part 15 of the FCC Rules. Operation is subject to the following two conditions: (1) This device may not cause harmful interference, and (2) this device must accept any interference received, including interference that may cause undesired operation"

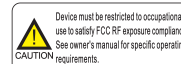

#### Golden Sunshine Service

Kirisun Corporation introduces the "Golden Sunshine Service" policy, solemnly launching the following service commitments:

- I. Kirisun products are warranted for 12 months for the main unit from the date of sale (based on the warranty card or invoice).  
Accessories are warranted for 6 months; if there are no special agreements, the national warranty laws apply.
- II. If the purchased main unit and accessories encounter non-human-made quality issues during the warranty period, customers can enjoy free warranty services at Kirisun Customer Service Center or its authorized service stations with the warranty card or invoice.

The following information should be completely filled out by the sales unit to assist the user:  
<Customer Retention Copy>

Model: \_\_\_\_\_  
Customer: \_\_\_\_\_  
Purchase Date: \_\_\_\_\_  
Customer Address: \_\_\_\_\_  
Sales Unit Contact Person: \_\_\_\_\_  
Name of Sales Unit (Valid with Stamp)

Name: \_\_\_\_\_  
Tel: \_\_\_\_\_  
Postal Code: \_\_\_\_\_

Tel: \_\_\_\_\_

#### Golden Sunshine Service

Kirisun Corporation introduces the "Golden Sunshine Service" policy, solemnly launching the following service commitments:

- I. Kirisun products are warranted for 12 months for the main unit from the date of sale (based on the warranty card or invoice).  
Accessories are warranted for 6 months; if there are no special agreements, the national warranty laws apply.
- II. If the purchased main unit and accessories encounter non-human-made quality issues during the warranty period, customers can enjoy free warranty services at Kirisun Customer Service Center or its authorized service stations with the warranty card or invoice.

The following information should be completely filled out by the sales unit to assist the user:  
<Sales Return Note>

Model: \_\_\_\_\_  
Customer: \_\_\_\_\_  
Purchase Date: \_\_\_\_\_  
Customer Address: \_\_\_\_\_  
Sales Unit Contact Person: \_\_\_\_\_  
Name of Sales Unit (Valid with Stamp)

Tel: \_\_\_\_\_

This equipment has been tested and found to comply with Class B digital device pursuant to part 15 of the FCC Rules. These limits are designed to provide reasonable protection against harmful interference when the equipment is operated in a commercial environment. This equipment generates, uses, and can radiate radio frequency energy and, if not installed and used in accordance with the instruction manual, may cause harmful interference to radio communications. Operation of this equipment in a residential area is likely to cause harmful interference in which case the user will be required to correct the interference at his own expense.

#### Warning (part 15.21)

Changes or modifications not expressly approved by the party responsible for compliance could void the user's authority to operate the equipment.



## **FCC Warning:**

Any Changes or modifications not expressly approved by the party responsible for compliance could void the user's authority to operate the equipment.

This device complies with part 15 of the FCC Rules. Operation is subject to the following two conditions: (1) This device may not cause harmful interference, and (2) this device must accept any interference received, including interference that may cause undesired operation.

**Note:** This equipment has been tested and found to comply with the limits for a Class B digital device, pursuant to part 15 of the FCC Rules. These limits are designed to provide reasonable protection against harmful interference in a residential installation. This equipment generates, uses and can radiate radio frequency energy and, if not installed and used in accordance with the instructions, may cause harmful interference to radio communications. However, there is no guarantee that interference will not occur in a particular installation. If this equipment does cause harmful interference to radio or television reception, which can be determined by turning the equipment off and on, the user is encouraged to try to correct the interference by one or more of the following measures:

- Reorient or relocate the receiving antenna.
- Increase the separation between the equipment and receiver.
- Connect the equipment into an outlet on a circuit different from that to which the receiver is connected.
- Consult the dealer or an experienced radio/TV technician for help.

## **RF Exposure Compliance and Control Guidelines and Operating Instructions**

To control your exposure and ensure compliance with the occupational/controlled environment exposure limits always adhere to the following procedures.

### **Guidelines:**

- Do not remove the RF Exposure Label from the device.
- User awareness instructions should accompany device when transferred to other users.
- Do not use this device if the operational requirements described herein are not met.

### **Operating Instructions:**

- Transmit no more than the rated duty factor of 50% of the time. To transmit (talk), push the Push-To-Talk (PTT) button. To receive calls, release the PTT button. Transmitting 50% of the time, or less, is important because this radio generates measurable RF energy exposure only when transmitting (in terms of measuring for standards compliance).

- Hold the radio in a vertical position in front of face with the microphone (and the other parts of the radio, including the antenna) at least one inch (2.5 cm) away from the nose. Keeping the radio at the proper distance is important because RF exposures decrease with distance from the antenna. Antenna should be kept away from eyes.
- When worn on the body, always place the radio in approved clip, holder, holster, case, or body harness for this product. Use of non-approved accessories may result in exposure levels, which exceed the occupational/controlled environment RF exposure limits.
- Use only manufacturer's name approved supplied or replacement antennas, batteries, and accessories. Use of non-manufacturer-name approved antennas, batteries, and accessories may exceed the FCC RF exposure guidelines.
- For a list approved accessories please consult your local dealer for information.