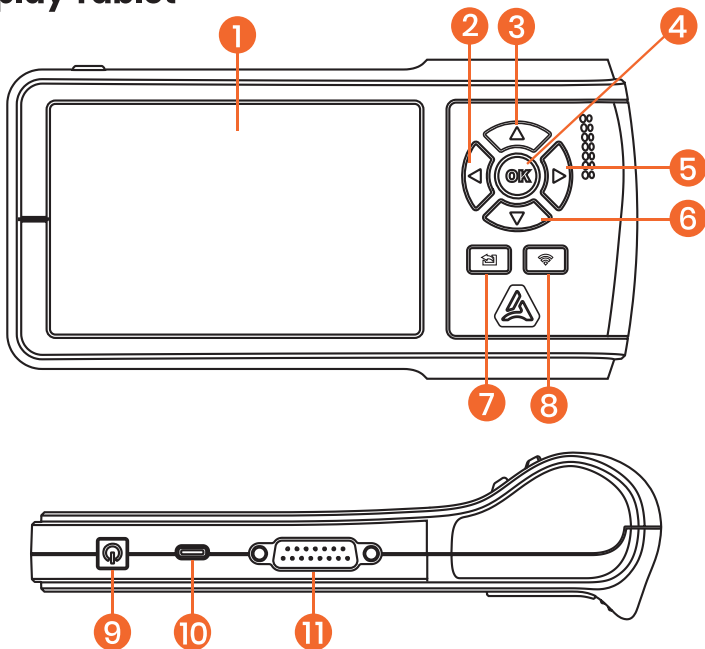

**Part 1****Display Tablet**

- 1 Screen
- 2 To the left
- 3 Up
- 4 OK for confirm
- 5 To the right
- 6 Down
- 7 Return key
- 8 Set wifi
- 9 Power
- 10 USB port
- 11 Main testing port

**Part 2****Warm Tips**

- 1. About the first use:** After connecting to the Internet, upgrade the product to the latest version. And you can also make some system settings, such as language and metric/imperial system selection.
- 2. About compatibility:** The compatibility will differ from specific year, truck, protocol and VIN. If HD430 fails to work on your truck, please feel free to contact us ([amazon@anceltech.com](mailto:amazon@anceltech.com)). Our engineer will help you solve the problem for fast support.
- 3. About pickups/light trucks:** HD430 only supports using OBDII/EOBD to diagnostic the engine system of light trucks/pickups. Meanwhile, HD430 doesn't support DPF regeneration for the following light truck/pickup brands equipped with Cummins engine, including Ford, Dodge, Chevrolet, and Nissan.
- 4. About feedback:** When you encounter problems during the diagnosis process, you can give a one-click feedback. Our engineers will analyze and handle it immediately upon receiving it.
- 5. About return:** All items we sent to Amazon warehouse are brand new, but around 1% of return products will be recognized as sellable by Amazon. This warehouse process is out of our control. Pls email us or Amazon to get a replacement if yours is resold or used product. (Mark it as unusable to avoid anyone else receiving it again.)

**Part 3****How to Use ANCEL HD43X Series (work out of box)**

1. Turn the ignition off.
2. Connect the HD430 and the truck diagnostic port.
3. Turn the ignition on.
4. According to your needs, choose the targeted menu to start your diagnosis.

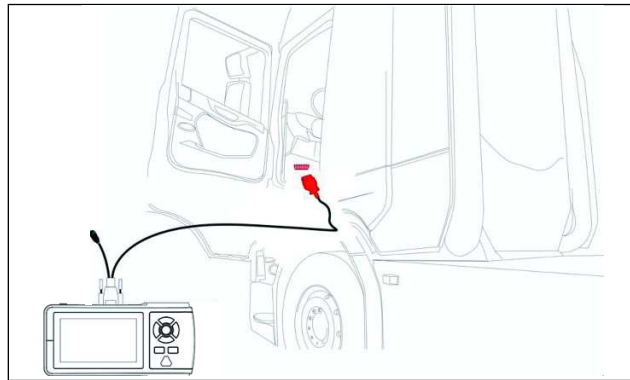
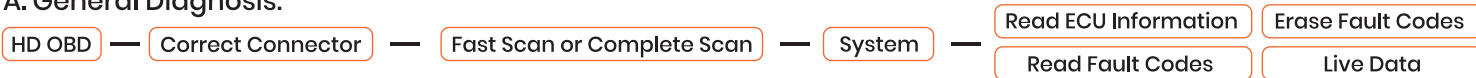
**Reference for the Usage Process****A. General Diagnosis:****B. DPF Regeneration:**

**Part 4****HD OBD**

To perform diagnostics such as reading/clearing fault codes or viewing live data, please select the correct menu based on your vehicle's diagnostic port after entering the HD OBD menu:

1. Round 6-pin/9-pin port: Select **Diesel 6&9pin**.
2. Green 9-pin port: Try one of the following:
  - \* **Diesel Green 9pin**
  - \* **Freightliner Green 9pin (2012-2015)**
  - \* **Green 9pin CAN3**

If unsure:

  - \* For **2012-2015** trucks, select **Freightliner Green 9pin (2012-2015)**
  - \* For **2016 and newer**, select **Diesel Green 9pin**
3. OBD16 port: Select **General OBD16** or **Mack/Volvo OBD16** (if applicable).

**Note:** These functions apply to standard DTCs and vehicles using J1939 or J1708 protocols.

The above is a simple reference we provide for you when choosing the diagnostic connector menu. If you have any other questions, feel free to contact us. We're here to help!

**Part 5****FAQs****Q1: Can't use HD430 to clear fault codes?**

- A: 1. Make sure the scanner is properly connected to the OBD port.
2. Clear the fault code, the relevant vehicle problems should be solved first.
  3. Special type fault codes, such as historical (inactive) fault code, are not supported to be cleared by the product.
  4. HD430 doesn't support clearing manufacturer-specific (non-standard) fault codes.
  5. If the fault code can't be cleared, you can search online to see what the problem might be and then solve it accordingly.

**Q2: DPF regeneration using HD430?**

- A: To use HD430 for DPF regeneration, it is necessary to ensure that the truck meets all the conditions required for DPF regeneration and there are no unresolved active fault codes. Additionally, your truck should be equipped with a DPF system and have a Cummins or Caterpillar engine.

**Q3: About the full system diagnosis of HD430?**

- A: Conduct a full system diagnosis using HD430, the truck need support or comply with standard protocols. At the same time, the system diagnosed by the product may vary depending on the year, brand and model of the truck, and what specific systems can be diagnosed can only be known after actual use.

**Q4: Is there a battery and an external power cord?**

- A: HD430 has no battery or external power cord. It can be turned on simply by plugging it into the truck diagnostic port, plug-and-play.