

# Quick Installation Guide

AC1200 Wireless Dual Band Gigabit Router

Archer C1200

## Connect the Hardware

If your internet connection is through an Ethernet cable from the wall instead of through a DSL / Cable / Satellite modem, connect the Ethernet cable directly to the router's Internet port, and then follow Step 4 and 5 to complete the hardware connection.

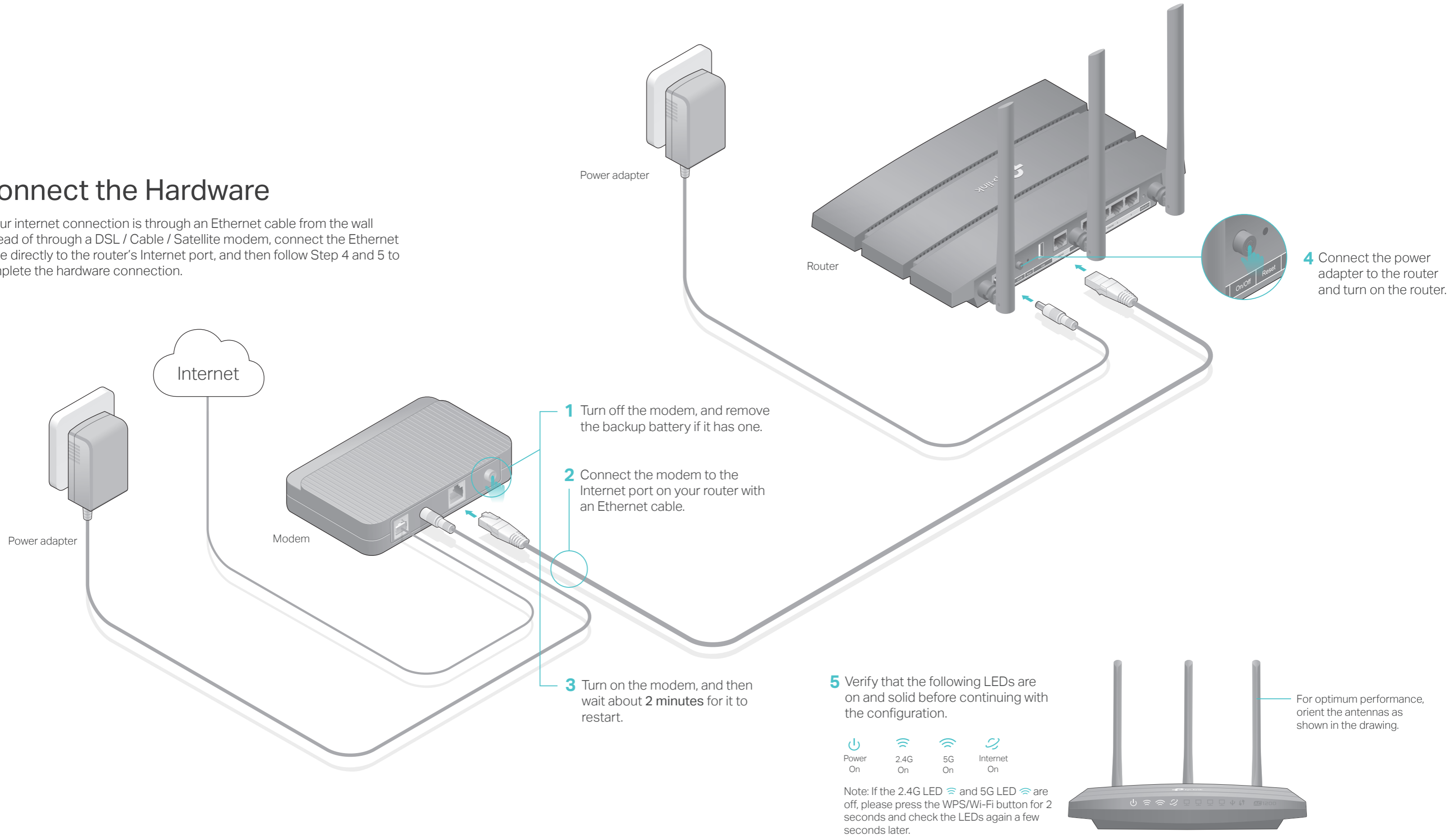

# Configure the Cloud Router

## Method ONE: Via the TP-Link Tether App

### 1. Download the Tether app.



### 2. Connect your smartphone to the router.

The default wireless network names (SSIDs) and password are printed on the label at the bottom of the router.



### 3. Connect the router to internet.

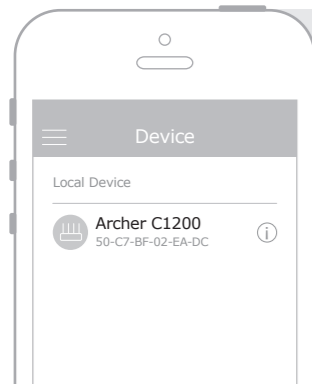

- A** Launch Tether. Select Archer C1200 from the local device list.
- B** Create a login password and then enter the password again to log in.
- C** Follow the steps to connect to internet.

### 4. Register the TP-Link Cloud service.

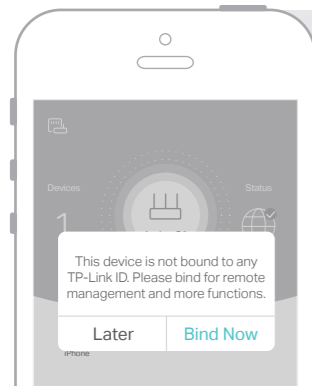

To enjoy a more complete service from TP-Link, tap **Bind Now** when prompted and follow the instructions to register and bind your TP-Link ID to your cloud router.

With your TP-Link ID, you can conveniently manage your home network from your smartphone or tablet via Tether, no matter where you find yourself.

😊 Enjoy the internet!

## Method TWO: Via Web Browser

### 1. Connect your device to the router (wired or wireless).

#### • Wired

Turn off the Wi-Fi on your computer and connect the devices as shown below.

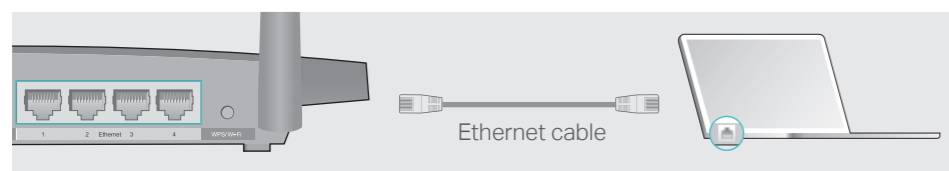

#### • Wireless

**a** Find the SSID and wireless password printed on the label of the router.

**b** Click the network icon of your computer or go to Wi-Fi settings of your smart device, and then select the SSID to join the network.

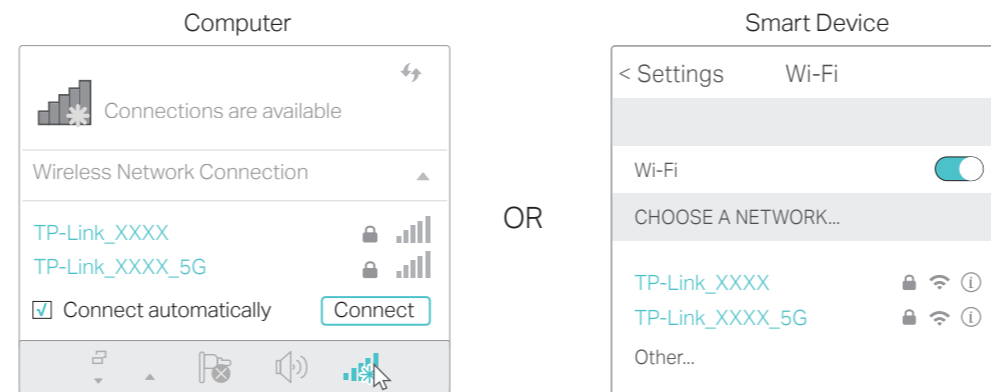

### 2. Connect the router to internet.

**A** Launch a web browser, and enter <http://tplinkwifi.net> or <http://192.168.0.1> in the address bar. Create a login password and then click **Let's Get Started**.

Note: If the login window does not appear, please refer to Q1 of **Need Help?** in this guide.

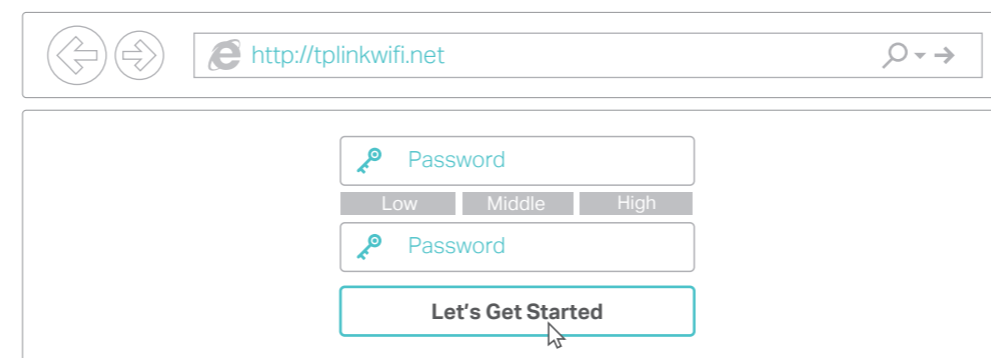

**B** Follow the step-by-step instructions to set up an internet connection and register the TP-Link Cloud service.

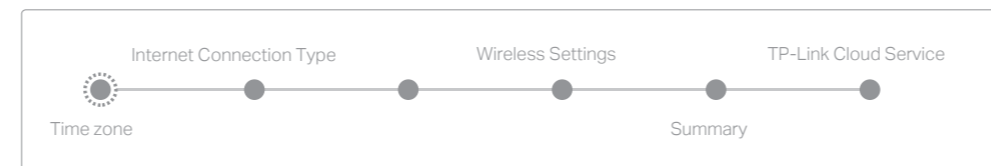

😊 Enjoy the internet!

## USB Applications

With a USB port, it's easy to share printers, files and media with multiple devices.

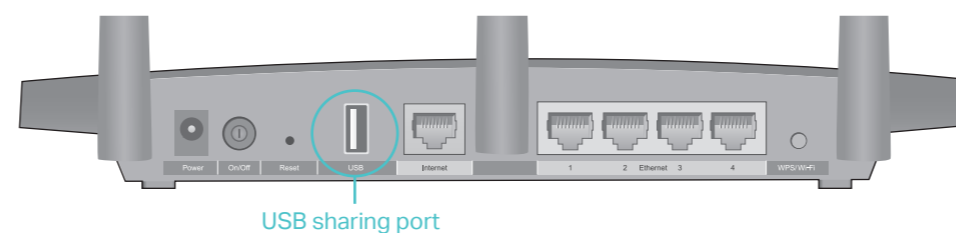

- Local Storage Sharing**  
Share files from the USB drive with devices in your home network
- Remote Access**  
Access the USB drive when you are away from home

- Printer Sharing**  
Share a printer with multiple computers connected to the router
- Media Server**  
Play media from the USB drive on your computer and smart devices



To learn more about the USB applications, visit <http://www.tp-link.com/app/usb>, or simply scan the QR code.

## TP-Link Cloud Service

TP-Link Cloud service provides a better way to manage your cloud devices. For example:



#### Remote Management

Easily manage your home network when you are out and about via the Tether app on your smartphone or tablet.

#### Timely Upgrade Notifications

Keep informed of the latest firmware updates, ensuring your router stays at its best.

#### One for All

Manage multiple TP-Link cloud devices, all from a single TP-Link ID.

You can set up and enjoy cloud functions via the Tether app or through the web management page at <http://tplinkwifi.net>.

To learn more about TP-Link Cloud service and other useful features supported by the router (including Guest Network, Parental Controls, Access Control and more), please refer to the **User Manual** at [www.tp-link.com](http://www.tp-link.com).

## Need Help?

### Q1. What can I do if the login window does not appear?

- If the computer is set to a static or fixed IP address, change settings to obtain an IP address automatically.
- Verify if <http://tplinkwifi.net> or <http://192.168.0.1> is correctly entered in the web browser. Alternatively, enter <http://192.168.1.1> in the web browser.
- Use another web browser and try again.
- Reboot your router and try again.
- Disable and then enable the network adapter.

### Q2. What can I do if I cannot access internet?

- Check if the internet is working normally by connecting a computer directly to the modem via an Ethernet cable. If it is not, contact your Internet Service Provider.
- Log in to the web management page of the router, and go to **Basic > Network Map** page to check whether the internet IP address is valid or not. If it is, please run the Quick Setup again; otherwise, check the hardware connection.
- Reboot your router and try again.
- For cable modem users, log in to the web management page of the router, and go to **Advanced > Network > Internet > MAC Clone**. Select **Use Current Computer MAC Address** and click **Save**. Then reboot both the modem and the router.

### Q3. How do I restore the router to its factory default settings?

- With the router powered on, use a pin to press and hold the **Reset** hole on the back until the Power LED  blinks.
- Log in to the web management page of the router, go to **Advanced > System Tools > Backup & Restore > Factory Default Restore**, and click **Factory Restore**. The router will restore and reboot automatically.

### Q4. What can I do if I forget my login password?

- If you are using a TP-Link ID to log in, click **Forgot password?** on the login page and then follow the instructions to reset it.
- Alternatively, use a pin to press and hold the **Reset** hole on the back until the Power LED  blinks to reset the router, and then visit <http://tplinkwifi.net> to create a new login password.

### Q5. What can I do if I forget my wireless network password?

- If you have not changed the default wireless password, it can be found on the label at the back of the router.
- Connect your computer to the router via an Ethernet cable. Log in to the web management page at <http://tplinkwifi.net>, and go to **Basic > Wireless** to retrieve or reset your wireless password.