

Door & Window Sensor

- User Manual -



CE FCC RoHS

1 Installation Instructions

Install the product on a door or window with the main body fixed on the door or window frame (Please install on wooden door or window), as shown in the following figure:

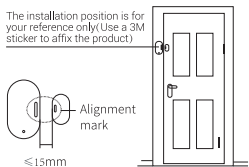

• Door & Window Sensor installation diagram

2 Network Configuration

1. Power on the product

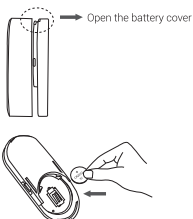

Remove the battery insulation film to power on the product

2. Press the RESET button for 3s and release, the red LED will flash for network configuration.



Tips:

*The Zigbee version product must be connected to the Zigbee gateway to function properly and upload data to the server/APP.

3 Product Parameters

Product Name	Door & Window Sensor
Wireless Protocol	Zigbee
Sensing Distance	≤15mm
Working Voltage	DC 3V
Battery Type	CR2032
Standby Current	≤10uA
Operating Temperature	-10°C ~ 55°C
Operating Humidity	0% ~ 99% RH
Luminance Meter	0~1000Lux (Only for with additional luminance version)
Product Size	Main body: 50×25×11mm Magnet: 30×15×10mm

4 Function Description

- The light value is only uploaded after the sensor is triggered. If real-time detection is required, the "Light Sense Interval Time" needs to be set on the APP.
- After setting parameters on the APP, the device needs to be triggered once to synchronize the parameters. For example, from Open to Close



FCC Statement

This equipment has been tested and found to comply with the limits for a Class B digital device, pursuant to part 15 of the FCC rules. These limits are designed to provide reasonable protection against harmful interference in a residential installation. This equipment generates, uses and can radiate radio frequency energy and, if not installed and used in accordance with the instructions, may cause harmful interference to radio communications. However, there is no guarantee that interference will not occur in a particular installation. If this equipment does cause harmful interference to radio or television reception, which can be determined by turning the equipment off and on, the user is encouraged to try to correct the interference by one or more of the following measures:
-Reorient or relocate the receiving antenna.
-Increase the separation between the equipment and receiver.

-Connect the equipment into an outlet on a circuit different from that to which the receiver is connected.

-Consult the dealer or an experienced radio/TV technician for help.

To assure continued compliance, any changes or modifications not expressly approved by the party responsible for compliance could void the user's authority to operate this equipment.

(Example - use only shielded interface cables when connecting to computer or peripheral devices). This equipment complies with Part 15 of the FCC Rules. Operation is subject to the following two conditions:

- (1) This device may not cause harmful interference, and
- (2) This device must accept any interference received, including interference that may cause undesired operation.

FCC Radiation Exposure Statement
The device has been evaluated to meet general RF exposure requirements. The device can be used in portable operation condition without restriction.

• Please read the manual carefully and use the product correctly

Thank you for purchasing and using this product. Before using the product, please read the manual carefully and use the product correctly. In order to avoid damage to the equipment, such as all consequences caused by abnormal operation, the company will not bear any responsibility.

* The pictures in this manual are used to guide the user's operation and are for reference only. Please refer to the actual product for details.

• Product description

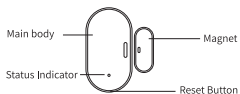

Version NO.: V2.0

Precautions:

- Do not install the product outdoors, on an unstable base or anywhere unprotected from the rain.
- Do not place magnetic metals or other objects near the product when pasting and installing, it is necessary to ensure that.
- The installation place of the door sensor should be smooth, flat, dry and clean.