

nulea®

User Manual

Wireless Illuminated Trackball Mouse

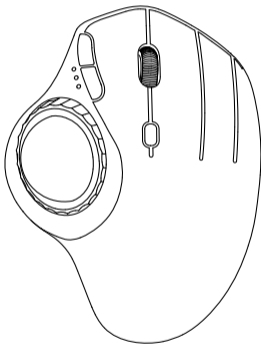

M508



Visit www.nulea.com to chat with a live representative, or email support@nulea.com for technical support or inquiries.

Contents

English	01-09
---------------	-------

Product Features

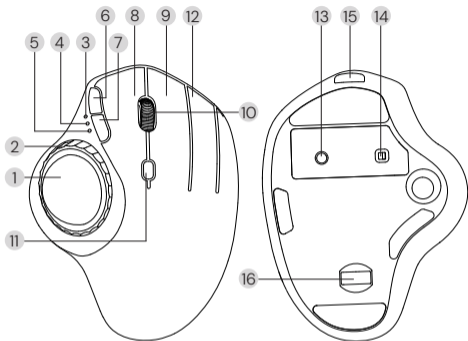

US/UK/CA

- ① Trackball
Trackball RGB Lighting
- ② Lighting Control Knob
- ③ 2.4GHz Mode
- ④ BT Mode 1
- ⑤ BT Mode 2
- ⑥ Forward Button
- ⑦ Back Button
- ⑧ Left Button
- ⑨ Right Button
- ⑩ Scroll Wheel
- ⑪ DPI Button
- ⑫ Window Switch Button
- ⑬ Channel Switch Button
- ⑭ On/Off Toggle Switch
- ⑮ Type-C Charging Port
- ⑯ USB Receiver

US/UK/CA

Specifications

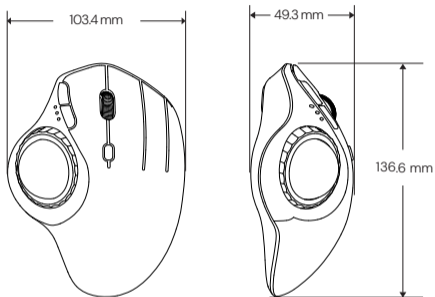

Model	M508
Dimensions	49.3 × 136.6 × 103.4 mm
Weight	150g
Material	ABS
Power Rating	DC 5V=0.3A
DPI	400 - 800 (default) - 1200 - 1600

Package Content

- 1 × Wireless Illuminated Trackball Mouse
- 1 × User Manual
- 1 × After-sales Service Card
- 1 × Type-C Charging Cable

Wireless Connection (BT Mode)

Windows System (Windows 10 as an example)

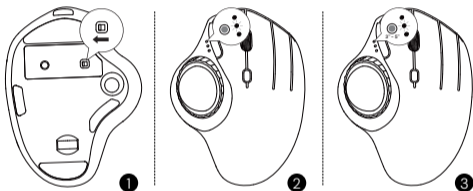

- 1 Turn on the mouse.
- 2 Press the channel switch button to switch to BT mode.
- 3 Press and hold the switch button for 3-5 seconds. The LED indicator will flash rapidly, indicating the mouse has entered BT pairing mode.

- 4 Click the "Devices" button on your computer.



- 5 Click the "Add Wireless Connection or other device" button.

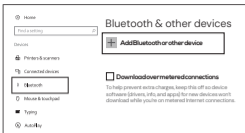

- 6 Search for the device "Nulea M508" and then click the Pair button.



- 7 If pairing is successful, the LED indicator will light up for 3 seconds and then turn off.

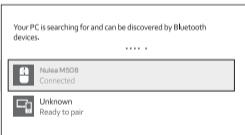

macOS System

Please complete wireless connection installation steps (1-3) before pairing.

- 1 Click "Continue" to begin installation.

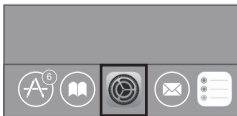

- 2 Click the wireless connection button in the System Preferences folder.



- 3 Search for the device "Nulea M508" and then click the pair button. If installation is complete, the mouse will function normally.



2.4G Connection

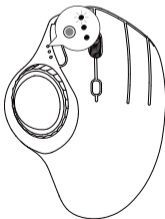

1

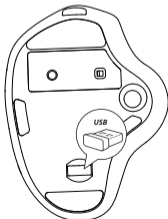

2

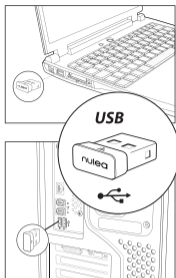

3

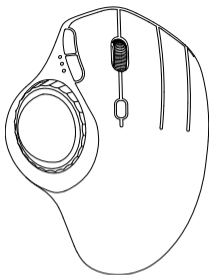

4

- 1 Turn on the mouse and briefly press the mode switch button to switch to 2.4G Mode. The LED indicator will flash slowly.
- 2 Remove the USB receiver from the bottom of the mouse.
- 3 Insert the USB receiver into the computer's USB port.
Note: Carefully check the connector orientation and insertion position. If you feel significant resistance when inserting the USB connector, check the connector's shape and orientation. Using excessive force may damage the connector.
- 4 The mouse is now ready to use.

Mode Switching

This mouse supports three connection channels: 2.4G, BT1, and BT2. After connecting the mouse to devices via 2.4G and the two BT channels (BT1, BT2), you can switch between connected devices by pressing the mode switch button. The LED indicator will turn off after successful pairing.

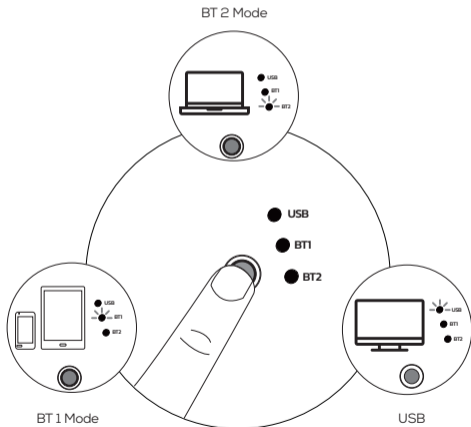

Trackball RGB Lighting Features

1. Adjust the trackball lighting effect: Simply rotate the lighting effect adjustment knob. The lighting modes are: flowing water/breathing/constant red/constant blue/constant purple/neon/off. The light will remain on while the trackball is scrolled. If the trackball is not scrolled for more than 3 minutes, the light will automatically turn off. The light will turn on again when the trackball is scrolled again.

2. DPI Settings: 400 (Red) / 800 (Blue, Default) / 1200 (Green) / 1600 (Purple).

When switching DPI levels, the indicator light will flash the corresponding color.

3. Low Battery: The trackball light will flash red.

4. Charging: The trackball light will glow green.

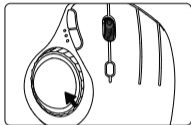

Charging

1. When the battery power is low, the red light on the trackball will flash. To avoid affecting the usage experience and functions of the mouse, please charge it in time.

2. When charging, the trackball light is green.

Note:

1. Please use the included charging cable to charge the mouse.

2. Do not use a fast charger to charge the mouse. Using a high-power adapter may damage the mouse's chip. (Please charge the mouse directly using a computer's USB port or a 5V charger.)

3. For the best user experience, please fully charge the mouse before first use.

4. The included USB cable is for charging only and should not be used as a wired mouse. The mouse will not work even if the USB charging cable is plugged directly into the computer port when it is not connected to the computer via a 2.4G USB receiver or wireless connection.

DPI Mode

There are 4 DPI settings available. Please press the DPI button to adjust the setting according to your preference. When switching DPI levels, the trackball light will flash the corresponding color: 400 (Red) / 800 (Blue, Default) / 1200 (Green) / 1600 (Purple).

If the highest DPI still does not meet your needs, you can also manually adjust the DPI on your computer.

Windows: Open "Microsoft Mouse and Keyboard Center", select the mouse you are using, click "Basic Settings", find "Sensitivity", and adjust it accordingly.

macOS: Open the "System Settings" menu, click "Mouse", and drag the "Tracking Speed" slider to adjust the DPI.

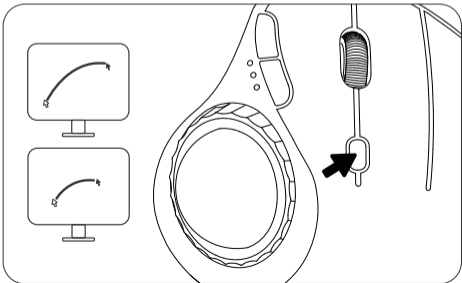

Sleep Mode & Wake Up

The Nulea M508 mouse features a smart sleep mode to extend battery life. When wirelessly connected, the M508 mouse will automatically enter sleep mode 30 minutes after your last use. To use the mouse, you need to move the trackball to wake it.

Note: If moving the trackball still does not wake the mouse, please check the following:

- Ensure the mouse battery is fully charged;
- The pairing mode is on the channel paired with the mouse;
- BT functionality on your device is working properly;
- If your computer is in sleep mode, please wake the computer first, then move the trackball to wake the mouse.

Important Safety Instructions

Please note: Repetitive use of the keyboard and mouse over a prolonged period may result in injury. We recommend that users avoid excessive use of this product or any keyboard and mouse.

- Avoid drops.
- Do not disassemble.
- Do not allow contact with liquids.
- This product is only suitable for use in mild climates.
- The ambient temperature should not exceed 40 degrees Celsius when using this product.
- Never place an open flame (such as a candle) on this product.
- Clean this product only with a dry cloth or brush.

FCC Statement

Any changes or modifications not expressly approved by the party responsible for compliance could void the user's authority to operate the equipment.

This device complies with part 15 of the FCC Rules. Operation is subject to the following two conditions: (1) this device may not cause harmful interference, and (2) this device must accept any interference received, including interference that may cause undesired operation.

FCC Radiation Exposure Statement

This equipment complies with FCC radiation exposure limits set forth for an uncontrolled environment.

Correct Disposal of This Product



(Waste Electrical & Electronic Equipment)

This marking shown on the product or its literature, indicate that it should not be disposed with other household wastes at the end of its working life.

To prevent possible harm to the environment or human health from uncontrolled waste disposal, please separate this from other types of wastes and recycle it responsibly to promote the sustainable reuse of material resources. Household user should contact either the retailer where they purchased this product or their local government office, for details of where and how they can take this item for environmentally safe recycling. Business users should contact their supplier and check the terms and conditions of the purchase contract. This product should not be mixed with other commercial wastes for disposal.

nulea®

WORK WITH YOUR FAVORITE



Visit www.nulea.com for our 24/7 live chat or send an email to support@nulea.com for support.

Manufacturer: Dongguan Togran Electronics Technology Co., Ltd.

Address: No. 110, Shijie Shidan Mid Rd, Shijie Town, Dongguan City, Guangdong Province, China

EU REP

HUMISS TRADING S.L

Calle Luis Bañuel 12-3A, Madrid, 28018, Spain

Email: eugpsres@outlook.com

Tel: +34 613 177 772

UK REP

CET Product Service Ltd.

Beacon House Stokenchurch Business Park,
Ibstone Rd, Stokenchurch

High Wycombe HP14 3FE UK

Email: info.cetservice@gmail.com

Phone: +44 741 932 5266



MADE IN CHINA

FABRIQUÉ EN CHINE

This device complies with part 15 of the FCC Rules. Operation is subject to the following two conditions: (1) This device may not cause harmful interference, and (2) this device must accept any interference received, including interference that may cause undesired operation.

Any Changes or modifications not expressly approved by the party responsible for compliance could void the user's authority to operate the equipment.

Note: This equipment has been tested and found to comply with the limits for a Class B digital device, pursuant to part 15 of the FCC Rules. These limits are designed to provide reasonable protection against harmful interference in a residential installation. This equipment generates uses and can radiate radio frequency energy and, if not installed and used in accordance with the instructions, may cause harmful interference to radio communications. However, there is no guarantee that interference will not occur in a particular installation. If this equipment does cause harmful interference to radio or television reception, which can be determined by turning the equipment off and on, the user is encouraged to try to correct the interference by one or more of the following measures:

- Reorient or relocate the receiving antenna.
- Increase the separation between the equipment and receiver.
- Connect the equipment into an outlet on a circuit different from that to which the receiver is connected.
- Consult the dealer or an experienced radio/TV technician for help.

FCC Radiation Exposure statement

The device has been evaluatec to meel general RF exposure requirement. The device can be used in portable exposure condition without restriction.