



LIGHT THE WAY

AUXBEAM BRAND INTRODUCTION

Founded in 2008, Auxbeam strives every day to share our enjoyment of open-air, off-road adventure with as many people as possible. Today, Auxbeam has achieved a leading market position on account of affordable price and updated excellent quality products, high standards of manufacturing and superior customer service.

Nowadays...

Auxbeam focuses on providing all types of cost-effective outdoor auto spare parts in special design styles to meet different customers' needs. We offer a wide variety of items, including auto parts & accessories, LED lights, switch panels and so on.



QUESTIONS & ANSWERS

Q: WHY ARE THE DRL OR THE TURN SIGNAL NOT WORKING?

A: This could be because the extension wires are not connected well, or the wire splitters did not cut through the parking light wire and the turn signal wire on the grille, so the current could not pass through.

Q: WOULD IT BE OK TO RUN THE AMBER LIGHT AS MY DRL ALL THE TIME?

A: Yes, the amber light can be wired to ACC in the fuse box (cigarette lighter fuse), parking lights, or however you would like to control them.

Q: HOW TO REMOVE THE MOISTURE IN THE HEADLIGHTS?

A: First, remove the headlights and open the vent valve on the back cover, with the front panel facing down and the cover facing up. Second, turn on the light for half an hour to remove the moisture. Third, after removing the moisture, cover the vent valve back and install it back in your car.

Vent Valve



LIGHTING EFFECT

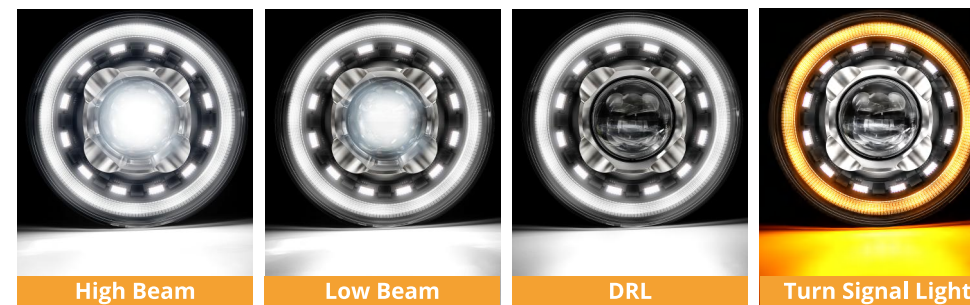

High Beam

Low Beam

DRL

Turn Signal Light

CAUTIONS



- READ ALL SAFETY MESSAGES AND UNDERSTAND ALL INSTRUCTIONS BEFORE ATTEMPTING TO INSTALL THIS PRODUCT.
- ALWAYS WEAR SAFETY GLASSES DURING INSTALL.



7 Inch LED Headlights

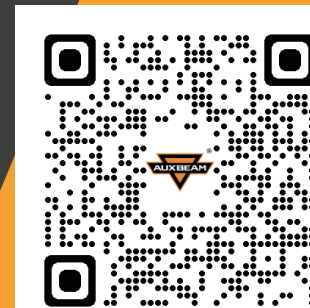

SCAN QR CODE TO OBTAIN SUPPORTING
CUSTOMER@AUXBEAM.COM

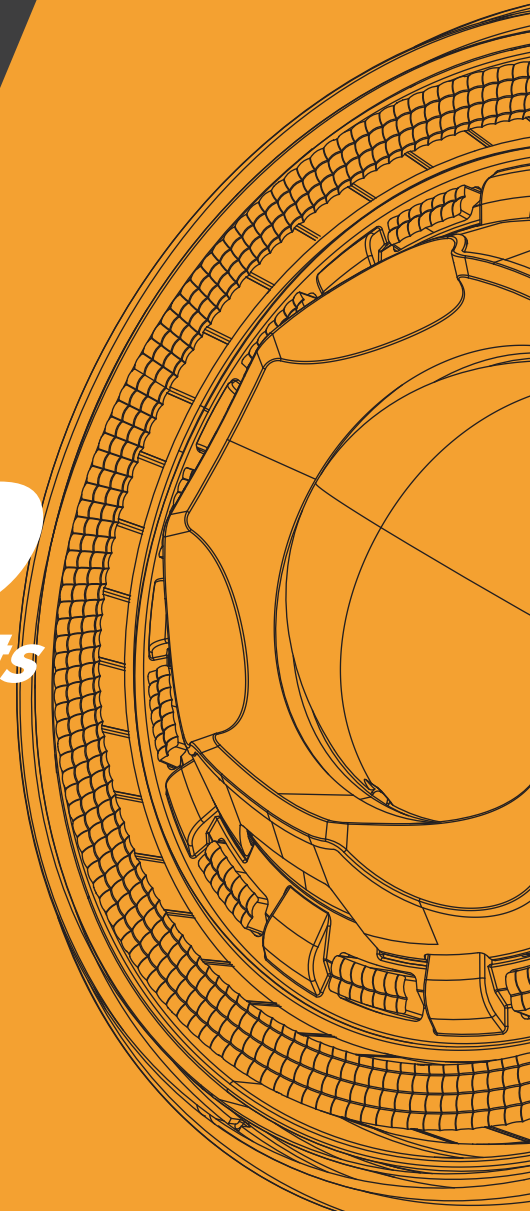

Starlight Flow

THANK YOU

FOR CHOOSING AUXBEAM'S PRODUCTS

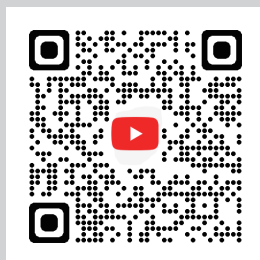
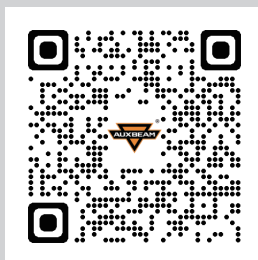

If you have any questions, please contact our customer service.

CUSTOMER@AUXBEAM.COM

Please scan the QR code on YouTube to access more **installation & operation videos** for the LED headlights.

www.youtube.com/@Auxbeam

www.auxbeam.com

www.facebook.com/auxbeam

www.instagram.com/auxbeamledlight

TIPS

1. Personal safety first: Safety always comes first. During the installation process, please ensure your personal safety. If you need to work under a vehicle, make sure you use proper support and safety equipment to avoid injury.
2. Read the instructions: Before starting the installation, please be sure to read the entire installation manual carefully. Familiarize yourself with the steps and requirements to avoid misuse.
3. Avoid risks involved: If you do not have the necessary skills or experience, or are not familiar with automotive electrical systems, it is recommended that you ask professional technicians to assist in the installation to avoid potential risks.
4. Check and test: After the installation is complete, be sure to check all connections to ensure that the product has been installed correctly. Before the actual drive, test to make sure everything is working properly.
5. Consult in time if you have any questions: If you encounter problems during the installation process, please feel free to contact our customer support team. Don't hesitate, we are here to help you.

LED HEADLIGHT WIRING DIAGRAM

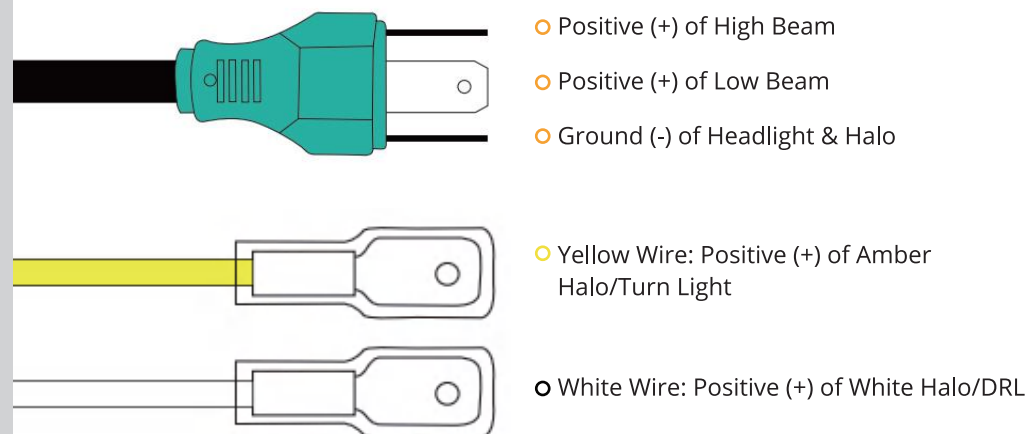

INSTALLATION STEPS

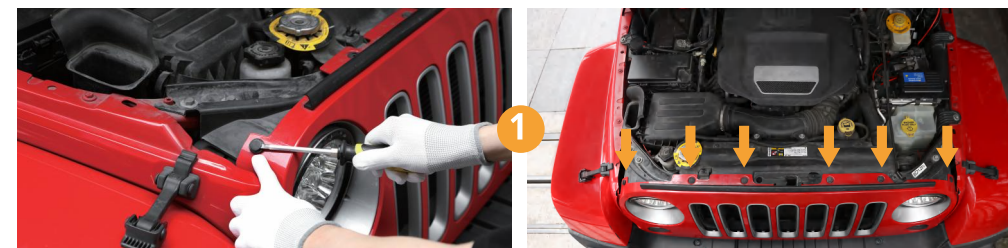

1. Open the hood and remove the six push clips on the grille.



2. Remove the grille, and disconnect the turn signal connector at the bottom of the back of the grille.

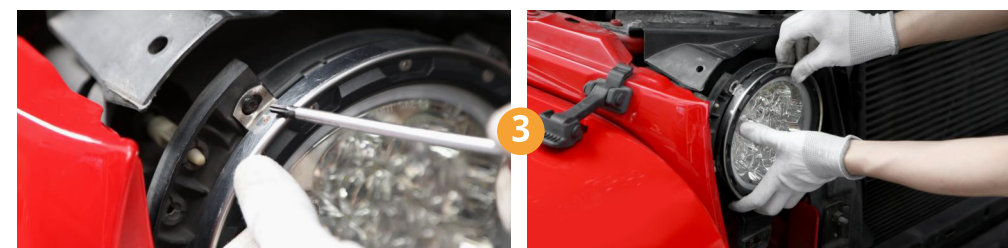

3. Remove the four screws and the trim ring that secure the headlight. (You need to hold on to the headlight to avoid it falling.)



4. Disconnect the plug at the back of the factory headlight, and replace it with new headlight. Auxbeam's headlight has DRL (white wire) and turn signal (yellow wire).

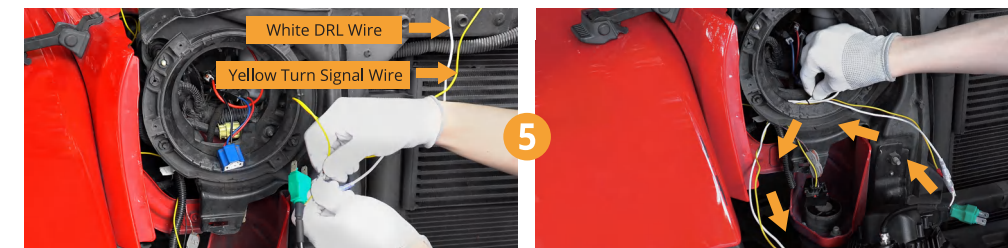

5. Connect the DRL and turn signal to the extension wires respectively, and run the extension wires through the headlight socket and down to the turn signal area.

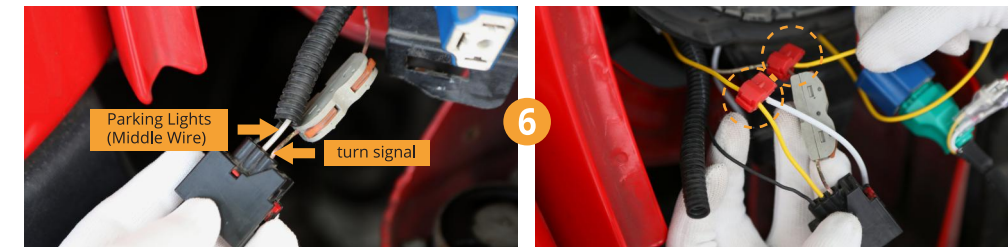

6. Use wire splitters to link the white extension wire (DRL) with the grille's parking wire (middle wire). Use wire splitters to connect the yellow extension wire (turn signal) with the grille's turn signal wire (farthest from the black wire).



7. Now we can go ahead and plug it into the factory H4 headlight connector. Then reattach the trim ring and screws back in.



8. Repeat the steps 3-7 on the driver side, test the function of the new headlights. Once the headlights have worked properly, reinstall the grille and secure it with the original push rivets.