

GEEPHON

Shine Brighter, Stay Greener

DIGITAL SIGNAGE

USER MANUAL

Please read this manual carefully before operating your set and retain it for future reference.



WARNING



CAUTION

**RISK OF ELECTRIC SHOCK
DO NOT OPEN**



CAUTION: TO AVOID THE RISK OF ELECTRIC SHOCK.
DO NOT REMOVE COVER (OR BACK).
NO USER - SERVICEABLE PARTS INSIDE.
REFER SERVICING TO QUALIFIED SERVICE PERSONNEL.



This symbol is intended to alert the user to avoid the risk of electric shock, do not disassemble this equipment by anyone except a qualified service personnel.



This symbol is intended to alert the user to the presence of important operation and maintenance instructions in the literature accompanying the equipment.

FCC Caution.

§ 15.19 Label requirements. (Suit for Verification (VOC) and Certification (ID))

This device complies with part 15 of the FCC Rules. Operation is subject to the following two conditions: (1) This device may not cause harmful interference, and (2) this device must accept any interference received, including interference that may cause undesired operation.

§ 15.21 Information to user.(Suit for Verification (VOC) and Certification (ID) and Declaration of Conformity(DOC))

Any Changes or modifications not expressly approved by the party responsible for compliance could void the user's authority to operate the equipment.

§ 15.105 Information to the user. (Suit for Class A and Class B digital device(unintentional radiator or intentional radiator))

Note: This equipment has been tested and found to comply with the limits for a Class B digital device, pursuant to part 15 of the FCC Rules. These limits are designed to provide reasonable protection against harmful interference in a residential installation. This equipment generates uses and can radiate radio frequency energy and, if not installed and used in accordance with the instructions, may cause harmful interference to radio communications. However, there is no guarantee that interference will not occur in a particular installation. If this equipment does cause harmful interference to radio or television reception, which can be determined by turning the equipment off and on, the user is encouraged to try to correct the interference by one or more of the following measures:

- Reorient or relocate the receiving antenna.
- Increase the separation between the equipment and receiver.
- Connect the equipment into an outlet on a circuit different from that to which the receiver is connected.
- Consult the dealer or an experienced radio/TV technician for help.

***RF warning for Mobile device:**(Suit for FCC Part 15.247 of ID)

This equipment complies with FCC radiation exposure limits set forth for an uncontrolled environment. This equipment should be installed and operated with minimum distance 20cm between the radiator & your body.

I Precautions for Safe Installation

- Before installation, it is essential to read the "Preparatory Matters before Installation" thoroughly and adhere to all operational instructions within this guide.
- Employ lifting equipment appropriate for the product's weight for hoisting. Prior to hoisting, ascertain the dimensions, weight, hoisting height, etc. of the equipment. Overloading is strictly prohibited.
- Before hoisting, it is essential to inspect the work site, lifting and hoisting machinery, slings, safety devices, control mechanisms, brakes, hooks and so on.
- Obvious and visible safety warning signs must be set up in the hoisting operation area.
- Before the hoisting operation, the weight and center of gravity of the object to be hoisted must be clearly known, and the center of gravity should be accurately located when hoisting.
- Trial hoisting and trial lowering must be carried out before the formal hoisting to ensure that the hoisting and landing processes are smooth and stable.
- There should be sufficient lighting equipment for night operations.
- Hoisting operations are prohibited in bad weather conditions such as heavy fog, strong winds, and heavy rain.
- Tools and debris on the equipment should be removed before hoisting to avoid hurting people if they fall.
- When hoisting, the installation personnel should stand in a position where they can avoid. When the equipment has been hoisted and moved to the docking position of the fixed base, the installation personnel can then approach to support the equipment for alignment.

I Precautions for Use

The specification of the AC power cord must be matched with the corresponding wire diameter according to the maximum current value used by the equipment to prevent the wire from heating up due to substandard wire specifications.

When the equipment is exposed to intense sunlight, its surface will become very hot. Please do not touch it at this time.

Under intense sunlight, the remote control may not work, which is a normal phenomenon. In case of such a situation, it is necessary to shield the remote control and place it close to the receiving head of the equipment, or wait until the sunlight is no longer intense before operating it.

When disconnecting the AC power supply, please ensure that the equipment is not exposed to intense sunlight for a long time. When storing the equipment, cover it with a cloth or box. This can prevent problems such as screen blackening, creasing and yellowing, and help extend the service life of electronic components.

■ Safety Instruction

1. Read Instructions

All the safety and operating instructions should be read before the appliance is operated.

2. Retain Instructions

The safety and operating instructions should be retained for future reference.

3. Heed Warnings

All warnings on the appliance and in the operating instructions should be adhered to.

4. Follow Instructions

All operating instructions should be followed.

5. Battery

Batteries shall not be exposed to excessive heat such as sunshine, fire or so on.

6. Earthing Connection

The apparatus shall be connected to a MAINS socket outlet with a protective earthing connection.

7. Water and Moisture

The appliance should not be used near water.

8. Ventilation

The appliance should be well situated so that its location or position does not interfere with its proper ventilation.

9. Heat

This appliance should be placed away from heat sources such as radiators, heat registers and stoves.

10. Power Sources

The appliance should only be connected to a power supply as described in the operating instructions or as marked on the appliance.

11. Grounding or Polarization

Precautions should be taken.

12. Power Cord Protection

Power supply cord should be located so that it is not likely to be walked on or pinched by items placed upon it.

■ Safety Instruction

13. Cleaning

The appliance should be cleaned only as recommended by the manufacturer.

14. Non-use Periods

The power cord of the appliance should be unplugged from the outlet when left unused for a long period of time.

15. Objects and Liquids

Care should be taken to prevent objects from falling and liquids from spilling into the enclosure through openings.

16. Conditions Requiring Service

The appliance should be serviced by qualified service personnel when the supply cord or plug has been damaged, objects have fallen on, or liquid has been spilled into the appliance. This caution also applies when the appliance has been exposed to rain, does not appear to operate normally, or exhibits a marked change in performance.

17. Caution

There is a button cell inside. Keep it away from children and the elderly to prevent accidental ingestion. If ingestion occurs, seek medical attention immediately.

18. Keep the key properly

There are high voltage and dangerous live parts inside. It's better to maintain and repair with a professional.

■ Preparatory Matters before Installation

- Not liable for any damage caused by fires, natural disaster (such as thunderstorms earthquake, etc.), acts by the third parties, accidents, owner's misuse or use in otherimproper conditions.
- Not liable for incidental damages (such as profit loss or interruption in business modification, erasure of record data, etc.) caused by use or inability to use of product.
- Not liable for any damage caused by neglect of the instructions described in the owner's manual.
- Not liable for any damage caused by misuse or malfunction through simultaneous use of this product and the connected equipment.

■ Making Connections

Power connection:

Connect the power cord of the display to the corresponding external power terminal.

This DIGITAL SIGNAGE can be connected to 100-240V - 50/60Hz.

Network connection:

Insert the network cable terminal(RJ45) into the ethernet connector, and tighten it, and then insert it into the ethernet in connector.

⚠ Note: The ethernet out connector must remain closed (tightly covered).

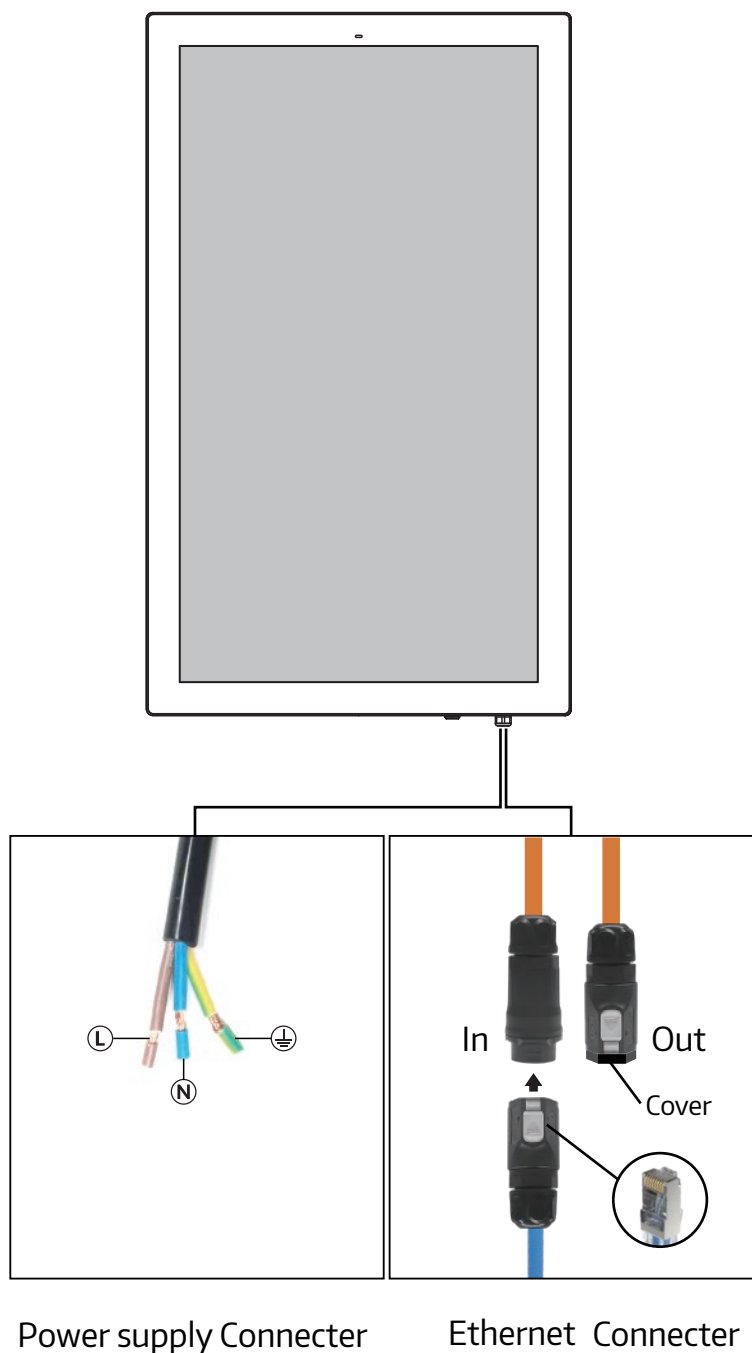

■ Making Connections

Network interconnection for three displays:

Insert the network cable terminal into the ethernet connector, and tighten it, and then insert it into the ethernet in connector of the 1st display. Connect the ethernet out of the 1st display to the ethernet in of the 2nd display, Connect the ethernet out of the 2nd display to the ethernet in of the 3rd display.

⚠ Note: The ethernet out connector of the 3rd display must remain closed (tightly covered).

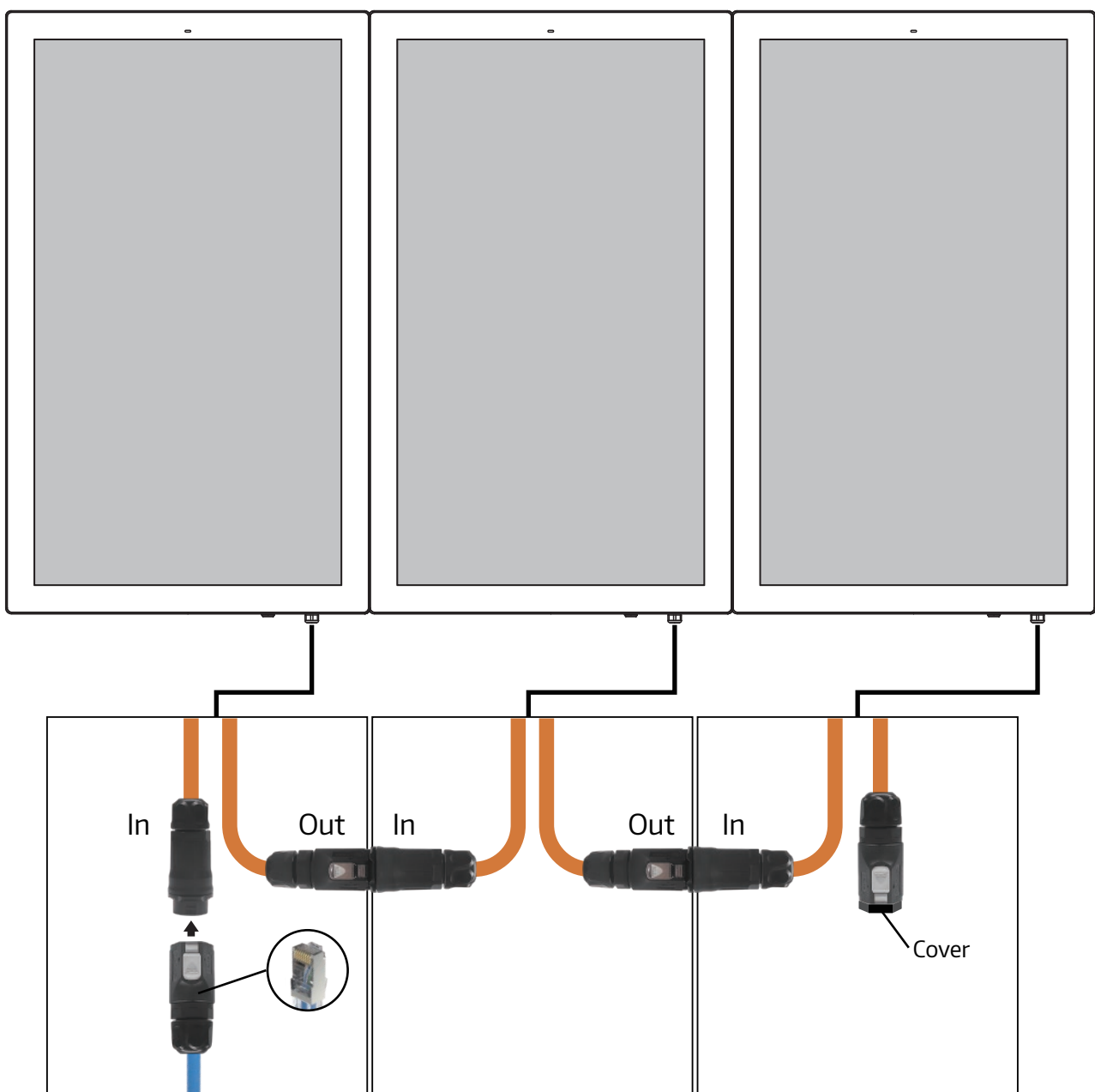

SPECIFICATIONS

INPUT SPEC				
INPUT FORMAT	Resolution	Horizontal Frequency(kHz)	Vertical Frequency(Hz)	Standard
	640 x 480	31.5	60	VGA
	640 x 480	37.861	72.809	VESA
	640 x 480	37.5	75	VESA
	720 x 400	31.5	70	VGA-T
	800 x 600	37.9	60	VESA Guidelines
	800 x 600	48.077	72.19	VESA
	800 x 600	46.9	75	VESA
	832 x 624	49.7	75	Mac
	1024 x 768	48.4	60	VESA Guidelines
	1024 x 768	60	75	VESA
	1125 x 870	68.68	75	MAC
	1280 x 800	47.8	59.8	-----
	1280 x 960	60.0	60	VESA
	1280 x 1024	63.595	60	VESA
	1440 x 900	55.9	59.9	VESA
	1680 x 1050	65.3	60	-----
	1920 x 1080	67.5	60	VESA
	3840 x 2160	67.5	30	



SPECIFICATIONS

INPUT SPEC

Mode	Resolution	Horizontal Frequency(kHz)	Vertical Frequency(Hz)
480i	720 x 480i	15.73	59.94/60
576i	720 x 576i	15.63	50
480p	720 x 480p	31.47	59.94/60
576p	720 x 480p	31.26	50
720p	1280 x 720p	37.50 44.96	50 59.94/60
1080i	1920 x 1080i	28.13 33.75	50 59.94/60
1080p	1920 x 1080p	56.25 67.5	50 59.94/60
2160p	3840 x 2160	56.25	25
2160p	3840 x 2160	67.5	30



GEEPHON

Shine Brighter, Stay Greener

