



Russell Hobbs



26200

 www.russellhobbs.com

Register online for an EXTRA year guarantee

Visit www.russellhobbs.co.uk/productregister/ You must register within 28 days of purchase



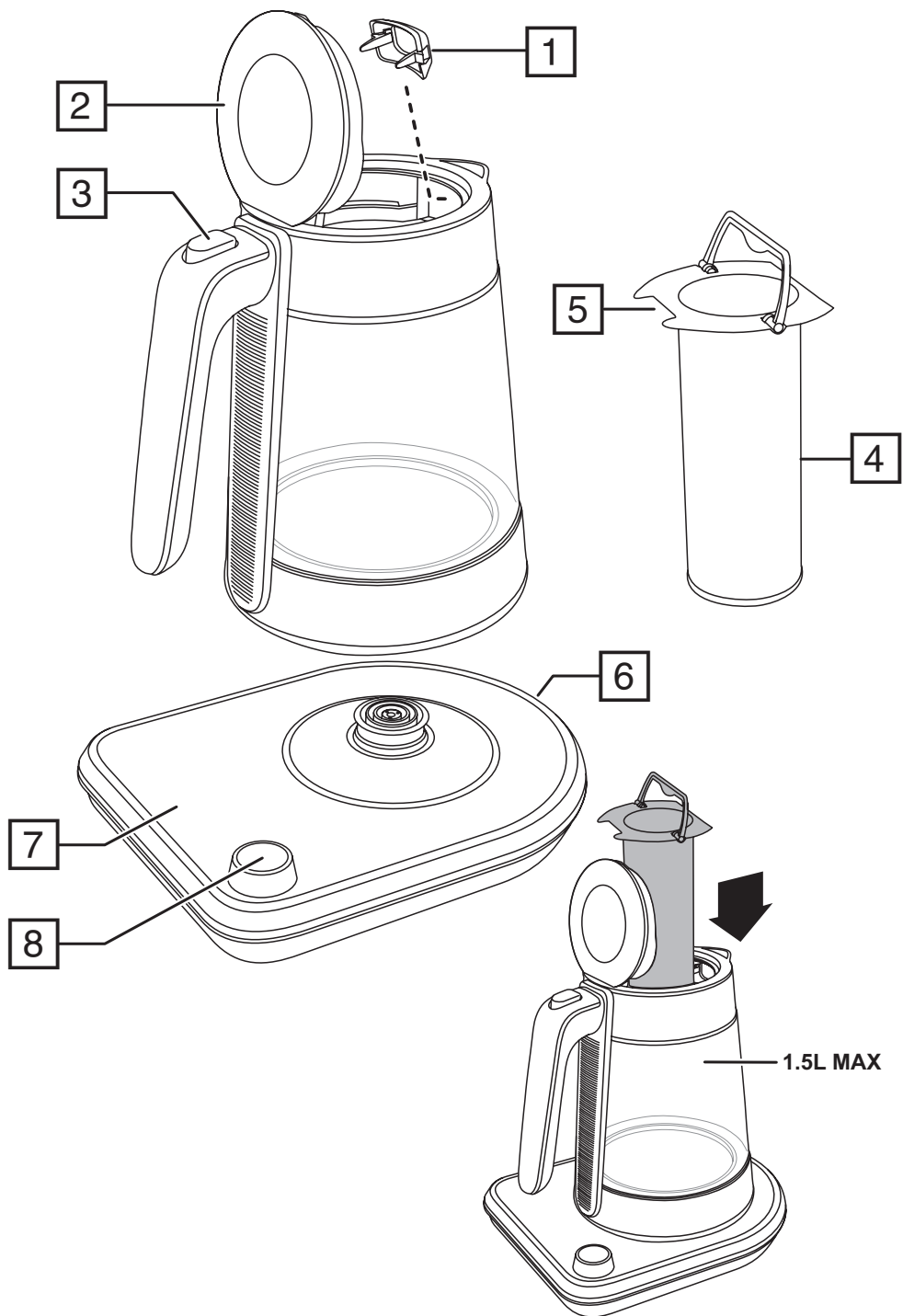

Read the instructions, keep them safe, pass them on if you pass the appliance on.
Remove all packaging before use.

IMPORTANT SAFEGUARDS

Follow basic safety precautions, including:

This appliance can be used by children aged from 8 years and above and persons with reduced physical, sensory or mental capabilities or lack of experience and knowledge if they have been supervised/instructed and understand the hazards involved. Children shall not play with the appliance.

Cleaning and user maintenance shall not be done by children unless they are older than 8 and supervised.

Keep the appliance and cable out of reach of children under 8 years.

 Parts of the appliance will get hot during use.

WARNING: Do not open the lid while the water is boiling.

If you overfill, the kettle may spit boiling water.

Use the kettle only with the stand supplied (and vice versa).

If the cable is damaged, it must be replaced by the manufacturer, its service agent, or someone similarly qualified, to avoid hazard.

Avoid spillage on the stand/connector.

The surface of the heating element is subject to residual heat after use.

Use the appliance according to these instructions. Any misuse may cause potential injury, electric shock or other hazards.

 Do not immerse in any liquid.

This appliance is intended to be used in household and similar applications such as:

- staff kitchen areas in shops, offices and other working environments;
- by clients in hotels, motels and other residential type environments;
- bed and breakfast type environments;
- farm houses.
- Keep the kettle, stand, and cable away from the edges of worktops.
- Don't use the kettle for any purpose other than heating water.
- Don't operate the appliance if it's damaged or malfunctions.

PARTS

- | | |
|----------------------|-------------------------------|
| 1. Anti scale filter | 5. Opening |
| 2. Lid | 6. Base unit |
| 3. Lid release | 7. Touch controls and display |
| 4. Infuser | 8. Select/confirm knob |

CONTROLS AND LED DISPLAY

To activate a function, touch its icon. The icon will light up brightly and the remaining icons will be dimly lit to show that they are available for use.



The LED display shows the water temperature, the selected water temperature or the steeping/keep warm time depending on the mode your kettle is in.

Your kettle will revert to the standby mode if no controls are touched or settings changed within 5 minutes. You can also select standby mode at any time by touching the  icon.

PREPARATION AND FILLING

1. Put the base unit on a stable, level surface.
2. Plug the base unit into the wall socket.
3. Remove the kettle from the base unit and press the lid release button.
4. Fill with at least 0.5 L of water, but not above the MAX (1.7 L) mark.
5. Close the lid, and press down to lock it.
6. Place the kettle onto the base unit.

BOILING WATER (100°C)

1. If your kettle is in standby mode, tap the  icon.
2. Tap the  icon.
3. The numerical display will show the current water temperature which will start to rise as your kettle starts to boil the water.
4. When the temperature of the water reaches 100°C (boiling) your kettle will switch off.
5. To cancel at any time you can tap the cancel  icon, or lift the kettle off the base.

HEATING WATER TO A SELECTED TEMPERATURE

Your kettle's variable temperature mode allows you to tailor the water temperature to suit specific teas, coffee and even baby food and milks. The range is adjustable from 40-100°C.

Heating water to a precise temperature depends on several factors. One of these is the amount of water you are trying to heat. The final temperature of a small quantity of water may overshoot the desired temperature. If it is important that the temperature of the water is exact, we recommend using the Keep Warm feature of your kettle which will allow the temperature of the water to stabilise naturally.

1. If your kettle is in standby mode, tap the ☺ icon.
2. Tap the ⚙ icon.
3. The numerical display will show the last selected water temperature.
4. Turn the select/confirm knob until the desired temperature is displayed.
5. Press the select/confirm knob ✓ to start heating the water.
6. To cancel at any time you can tap the cancel ⊗ icon, or lift the kettle off the base.

TEMPERATURE GUIDE

Tea Type	Temperature °C	Brewing time (min)
Black	90 – 100	3 - 5
Oolong	70 – 80	2 – 3
White tea	70 – 80	1 – 3
Green tea	70 – 85	1 - 3
Rooibos	90 – 100	5 - 6
Hibiscus	70 – 75	5 - 7
Pu-erh	80 – 100	2 - 5
Mate	90 – 100	5 - 6
Herbal/Fruit	90 – 100	3 - 5
Coffee	Temperature °C	Brewing time (min)
Instant coffee	85 - 95	-
Filter ground coffee	80 - 90	-

For baby milk/formula, follow the manufacturer's instructions, or local health authority guidance.

USING THE INFUSER AND STEEP TIMER

The steep timer allows you to time infusions when using the infuser accessory. You must first heat the water to the desired temperature see HEATING WATER TO A SELECTED TEMPERATURE. The timer can be set from 1 to 40 minutes.

Note: When using the infuser, only fill your kettle to the 1.5L marking. This will allow room for the infuser and its contents when you insert it into the kettle, and prevent water from being displaced out of the spout.

1. Prepare the infuser accessory by putting the desired amount of tea leaves into it.
2. When the water reaches the desired temperature, open the lid and put the infuser into your kettle. The opening in the infuser should face the handle.
3. Tap the ☺ icon.

4. Turn the select/confirm knob until the desired steeping time is shown on the numerical display. Turning the control slowly will increase/decrease the time in 1 minute intervals. Turning the control quickly will increase/decrease the time in 5 minute intervals.
5. Press the select/confirm knob ✓. The last used temperature will then be displayed.
6. Turn the select/confirm knob to adjust desired temperature (or skip this step if the current temperature is already correct).
7. Press the select/confirm knob ✓ to start the countdown.
8. Your kettle will beep when the time is up. Note that the infusion will start to cool down naturally after the timer has elapsed.
9. To cancel at any time you can tap the cancel ⊗ icon.

KEEP WARM MODE

This mode allows you to keep the heated water at a specified temperature. The keep warm mode can be set from 1 to 40 minutes.

1. Tap the ☺ icon.
2. Turn the select/confirm knob until the desired keep warm time is shown on the numerical display. Turning the control slowly will increase/decrease the time in 1 minute intervals. Turning the control quickly will increase/decrease the time in 5 minute intervals.
3. Press the select/confirm knob ✓. The last used temperature will then be displayed.
4. Turn the select/confirm knob to adjust desired temperature (or skip this step if the current temperature is already correct).
5. Press the select/confirm knob ✓ to start the countdown.
6. Your kettle will beep when the time is up.
7. To cancel at any time you can tap the cancel ⊗ icon.

BOIL DRY PROTECTION

If your kettle boils dry, a safety cut-out device will automatically switch it off. If this happens, unplug your kettle and allow it to cool down until the cut-out resets itself. Allowing your kettle to boil dry will shorten the life of the element.

CARE AND MAINTENANCE

1. Unplug the stand, and let the kettle cool before cleaning.
2. Wipe all surfaces with a clean damp cloth.
3. Open the lid.
4. Squeeze the two lugs together on the anti scale filter then remove it from the kettle.
5. Rinse it under a running tap while brushing with a soft brush.
6. Insert the anti scale filter back into the kettle and push it into place until it clicks.

Descale regularly, (at least monthly).

Descale the appliance at least monthly with a proprietary descaler. Follow the instructions on the package of descaler.

Products returned under guarantee with faults due to scale will be subject to a repair charge.

RECYCLING

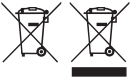

To avoid environmental and health problems due to hazardous substances, appliances and rechargeable and non-rechargeable batteries marked with one of these symbols must not be disposed of with unsorted municipal waste. Always dispose of electrical and electronic products and, where applicable, rechargeable and non-rechargeable batteries, at an appropriate official recycling/collection point.

SERVICE

If you ring Customer Service, please have the Model Number to hand, as we won't be able to help you without it. It's on the rating plate (usually underneath the product). The product isn't user-serviceable. If it's not working, read the instructions, check the plug fuse and main fuse/circuit breaker. If it's still not working, consult your retailer. If that doesn't solve the problem – ring Customer Service – they may be able to offer technical advice.

If they advise you to return the product to us, pack it carefully, include a note with your name, address, day phone number, and what's wrong. If under guarantee, say where and when purchased, and include proof of purchase (till receipt). Send it to:

Customer Service

Spectrum Brands (UK) Ltd

Fir Street, Failsworth, Manchester M35 0HS

email: support@russellhobbs.com

telephone: 0345 658 9700 (local rate number)

Please note: If you have purchased the product within the last 6 months, please contact the retailer in the first instance to deal with any matters relating to warranty.

GUARANTEE

Defects affecting product functionality appearing within the guarantee period will be corrected by replacement or repair at our option provided the product is used and maintained in accordance with the instructions. Your statutory rights are not affected.

This warranty shall not be valid where it is contrary to U.S. and other applicable laws, or where the warranty would be prohibited under any economic sanctions, export control laws, embargos, or other restrictive trade measures enforced by the United States or other applicable jurisdictions. This includes, without limitation, any warranty claims implicating parties from, or otherwise located in, Cuba, Iran, North Korea, Syria and the Crimea region.

Guarantee period = 2 years from first retail purchase.

To claim an extra 1 year guarantee, register your product online within 28 days of purchase. Register at: **uk.russellhobbs.com/product-registration**

Consumables are guaranteed only for their recommended lifecycle. Replacement/ Spare parts* are excluded and are only covered by a 1 year warranty.

* Examples include filters, removable grill plates, drip trays/crumb trays etc.

 **ONLINE**

www.russellhobbs.com for more products