

# Dreame AirPursue™ PM20 Purifier

DREAME



# Safety Instructions

READ AND SAVE THESE INSTRUCTIONS

READ ALL INSTRUCTIONS BEFORE USING (THIS APPLIANCE). Failure to follow the warnings and instructions may result in electric shock, fire and/or serious injury.

## Warning

- This appliance can be used by children aged from 8 years and above under supervision.
- This appliance can be used by persons with reduced physical, sensory or mental capabilities or lack of experience and knowledge if they have been given supervision or instruction concerning use of the appliance in a safe way and understand the hazards involved.
- The purifier is not a toy. Children shall not play with or operate this product. Please exercise caution when using the purifier near children. Do not allow children to clean or maintain the purifier unless supervised by a parent or guardian.
- Do not use the purifier outdoors or on wet surfaces. Only use the product on dry indoor surfaces. Do not touch the plug or any part of the product with wet hands.
- Do not use the purifier near bathtubs, showers, or swimming pools.
- To reduce the risk of fire, make sure that the supply cord and the product are kept away from heat sources or direct sunlight.
- Make sure the appliance is off and unplugged when not used for extended periods as well as prior to performing any maintenance or repairs.
- To reduce the risk of fire, explosion, or injury, make sure that the supply cord and lithium battery are undamaged before use. Do not use the appliance if the supply cord and lithium battery are damaged.
- If the supply cord is damaged, it must be replaced by the manufacturer, its service department, or similarly qualified personnel to avoid hazards.
- Do not stretch the cable or place the cable under strain. Do not unplug by pulling on the cable. To unplug, grasp the plug, not the cable. Do not use a power extension cord.
- Do not route the cable under the product. This product must not be placed directly below a socket.
- In order to avoid overheating, do not cover the appliance or power cord.

- To avoid burns, do not let bare skin touch product's heating components.
- The fans can be used for tropical climates.
- Keep combustible materials, such as textiles and curtains, away from the product outlet.
- Appliances that are obviously damaged must not be operated.
- Warning: Do not spray or apply perfume directly on or near the filter. Keep essential oils and chemicals away from this product.
- Always carry the appliance by the base, do not carry it by the product head.
- Do not use the product if it is damaged or has been submerged in water.
- Do not lean the appliance against any unstable surface, as this may cause damage to the appliance or personal injury. If the appliance becomes damaged or is otherwise malfunctioning, please contact our authorized service department. Never attempt to disassemble the device on your own.
- **WARNING: Chemical Burn and Choking Hazard. Keep batteries away from children. If swallowed, contact your physician or local poison control.**
- Pacemakers, defibrillators and electronic storage media may be affected by strong magnetic fields. Anyone using a pacemaker, defibrillator or electronic storage media should avoid carrying the remote in their pocket or near the device.
- Only use accessories and replacement parts recommended by the manufacturer.
- Only use or install the product on dry indoor surfaces.
- Do not use this heater in the immediate surroundings of a bath, a shower or a swimming pool.
- Do not use this heater if it has been dropped.
- Do not use if there are visible signs of damage to the heater.
- Use this heater on a horizontal and stable surface.
- Children of less than 3 years should be kept away unless continuously supervised.
- Children aged from 3 years and less than 8 years shall only switch on/off the appliance provided that it has been placed or installed in its intended normal operating position and they have been given supervision or instruction concerning use of the appliance in a safe way and understand the hazards involved. Children aged from 3 years and less than 8 years shall not plug in, regulate and clean the appliance or perform user maintenance.

**CAUTION** — Some parts of this product can become very hot and cause burns. Particular attention has to be given where children and vulnerable people are present.

**WARNING:** Do not use this heater in small rooms when they are occupied by persons not capable of leaving the room on their own, unless constant supervision is provided.

**WARNING:** To reduce the risk of fire, keep textiles, curtains, or any other flammable material a minimum distance of 1 m from the air outlet.



**Do not cover:** In order to avoid overheating, do not cover the heater.

This appliance has a polarized plug (one blade is wider than the other). To reduce the risk of electric shock, this plug is intended to fit in a polarized outlet only one way. If the plug does not fit fully in the outlet, reverse the plug. If it still does not fit, contact a qualified electrician. Do not attempt to defeat this safety feature.

**WARNING** - To Reduce The Risk Of Fire Or Electric Shock, Do Not Use This Fan With Any Solid-State Speed Control Device.

**WARNING** - To Reduce The Risk Of Fire, Electric Shock Or Injury To Persons, Do Not Use Replacement Parts That Have Not Been Recommended By The Manufacturer (e.g. Parts Made At Home Using A 3D Printer).

## IMPORTANT INSTRUCTIONS

When using electrical appliances, basic precautions should always be followed to reduce the risk of fire, electric shock, injury to persons, and hyperthermia, including the following:

- 01) Read all instructions before using this heater.
- 02) This heater is hot when in use. To avoid burns, do not let bare skin touch hot surfaces. If provided, use handles when moving this heater. Keep combustible materials, such as furniture, pillows, bedding, papers, clothes, and curtains at least a 3 feet (0.9 m) from the front of the heater and keep them away from the sides and rear.
- 03) Extreme caution is necessary when any heater is used by or near children or invalids and whenever the heater is left operating and unattended.
- 04) Always unplug heater when not in use.
- 05) Do not operate any heater with a damaged cord or plug or after the heater malfunctions, has been dropped or damaged in any manner. Discard heater, or return to authorized service facility for examination and/or repair.
- 06) Do not use outdoors.
- 07) This heater is not intended for use in bathrooms, laundry areas and similar indoor locations. Never locate heater where it may fall into a bathtub or other water container.
- 08) Do not run cord under carpeting. Do not cover cord with throw rugs, runners, or similar coverings. Do not route cord under furniture or appliances. Arrange cord away from traffic area and where it will not be tripped over.
- 09) To disconnect heater, turn controls to off, then remove plug from outlet.
- 10) Do not insert or allow foreign objects to enter any ventilation or exhaust opening as this may cause an electric shock or fire, or damage the heater.
- 11) To prevent a possible fire, do not block air intakes or exhaust in any manner. Do not use on soft surfaces, like a bed, where openings may become blocked.
- 12) A heater has hot and arcing or sparking parts inside. Do not use it in areas where gasoline, paint, or flammable liquids are used or stored.
- 13) Use this heater only as described in this manual. Any other use not recommended by the manufacturer may cause fire, electric shock, or injury to persons.
- 14) Always plug heaters directly into a wall outlet/receptacle. Never use with an extension cord or relocatable power tap (outlet/power strip).
- 15) Hyperthermia can result in death. Symptoms of hyperthermia include high body temperature, headache, nausea, vomiting, tiredness,

dizziness, fainting, and rapid pulse. If you begin to experience symptoms related to hyperthermia, turn off the heater and seek medical attention.

16) To avoid excessive room temperatures which can cause hyperthermia: DO NOT leave product running unattended in a confined space around infants, or individuals with reduced physical, sensory, or mental capabilities.

17) **"SAVE THESE INSTRUCTIONS"**

THERMALLY PROTECTED

CAUTION - High temperature, keep electrical cords, drapery, and other furnishings at least 3 feet (0.9 m) from the front of the heater and away from the side and rear. WARNING - Risk of Hyperthermia.

# Product Overview

Note: The illustrations in this manual are indicative only. The actual product may differ.

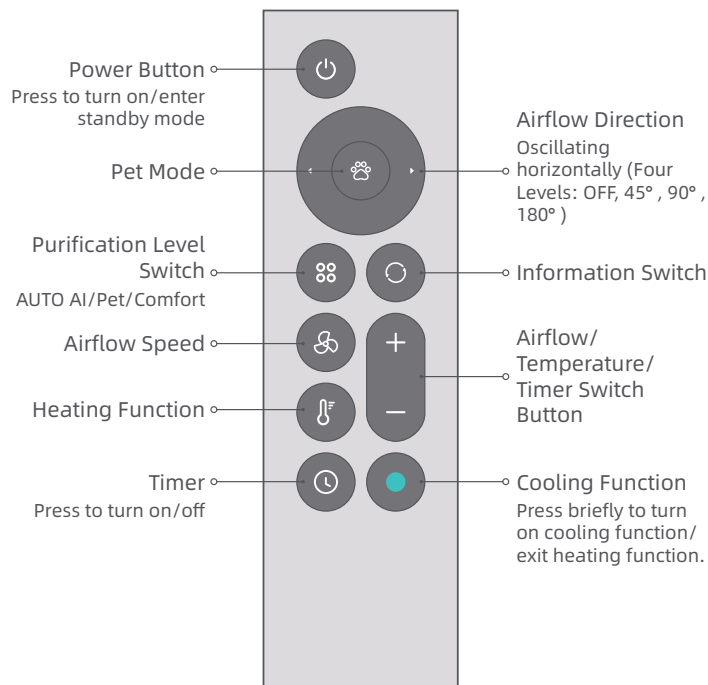
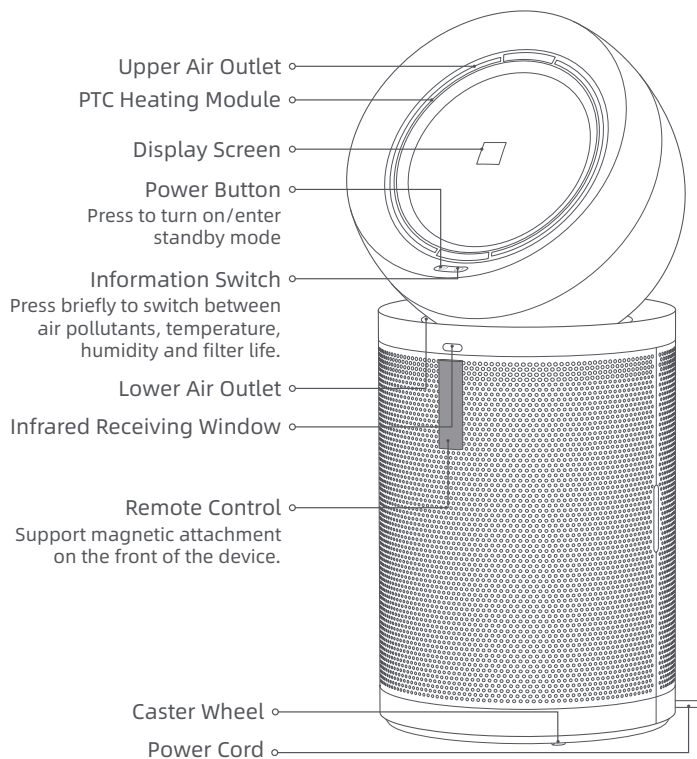

# Product Overview

## Filter Assembly

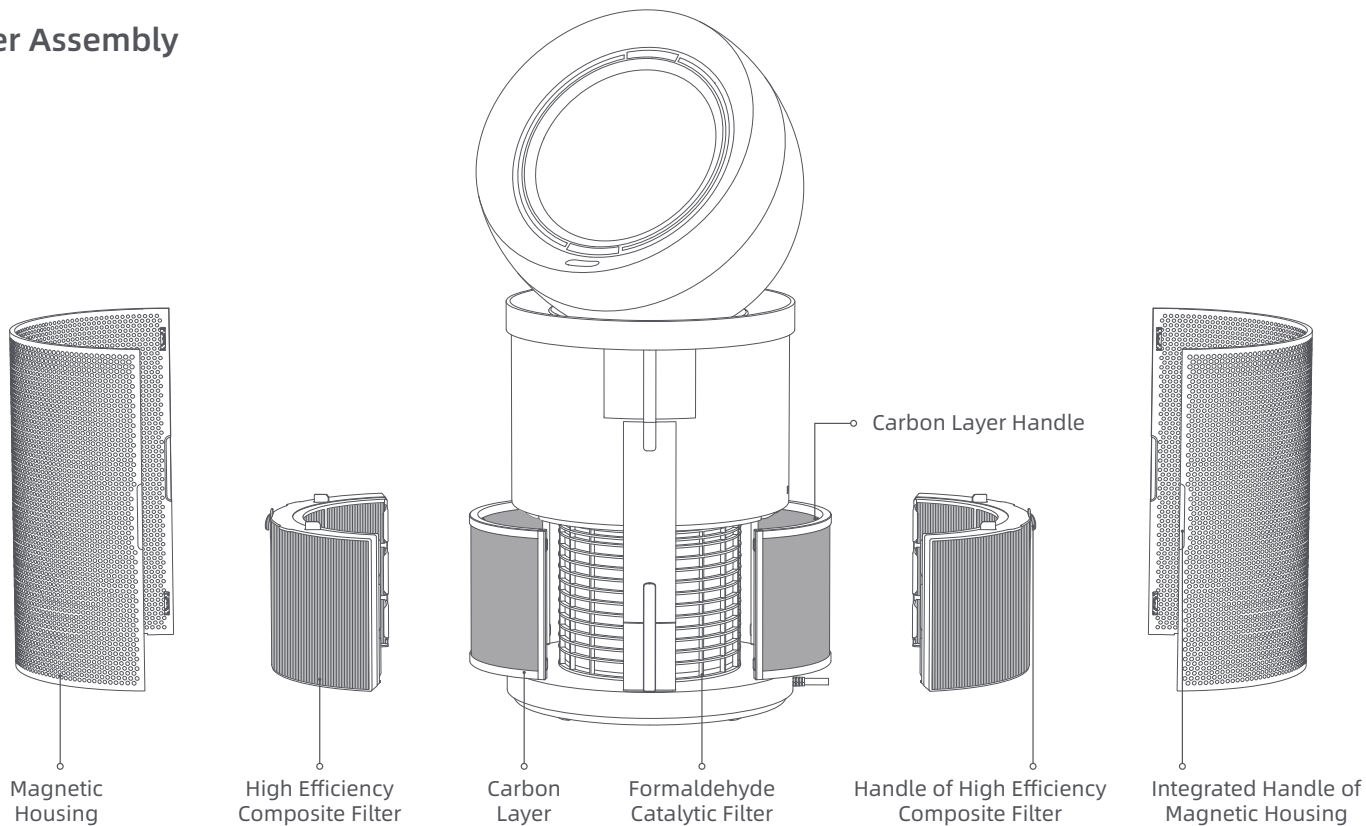

# Product Overview

## Display Screen

Information Display  
It can be switched to display air quality, PM1/PM2.5/PM10, TVOC concentration, formaldehyde concentration, temperature and humidity.



Purification Level Switch  
AUTO AI  
Pet  
Comfort  
Custom

Air Quality Level  
The green, yellow, orange, and red parts correspond to excellent, good, mild pollution, and heavy pollution levels of air quality, respectively.

# Connecting with the Dreamehome App

## 1. Download the Dreamehome App

Scan the QR code on the purifier, or search "Dreamehome" in the app store to download and install the app.

Note:

- Only 2.4 GHz Wi-Fi is supported.
- Due to upgrades in the app software, the actual operations may differ from the descriptions in this manual. Please follow the instructions based on the current app version.

## 2. Add Device

Open the Dreamehome App, tap "Scan QR code to connect" and scan the same QR code again to add the device. Please follow the prompts to finish the Wi-Fi connection.

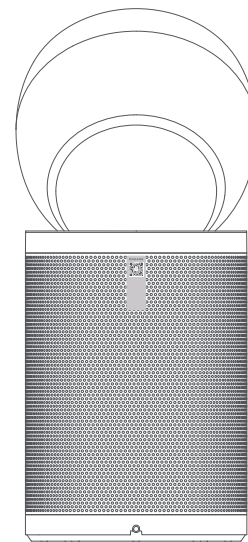

# How to Use

Note:

- Do not pull or manually rotate the machine head.
- Before use, place the product steadily in a suitable position, and then connect the power supply.

## ⏻ Power On/Standby

Briefly press the power button on the machine or remote control to turn on the machine. Wi-Fi is enabled by default, and the factory default setting is AUTO AI mode. When the machine stops operating, it will resume the last settings upon restarting. Besides, you can enter the standby mode by pressing the power button.





Note: If the machine is in standby mode, it will automatically start working when it detects someone within a 3-meter range. It is disabled by default and can be enabled in the App.

# How to Use

## Information Switch

Briefly press the information switch button to switch between air quality, pollutants, temperature, humidity, and filter life.

## Purification Level Switch

-  **AUTO AI:** In this mode, the ventilation speed is dynamically adjusted based on real-time monitoring of pollutant levels, and the upper and lower air outlets switch automatically every 2 minutes. Once the target air quality is reached, the product keeps the lower outlet open and runs at the lowest fan speed. The screen brightness adjusts automatically according to ambient light.
-  **Pet:** It supports capturing floating pet hair and odors from the air. When the function is enabled, both the upper and lower air outlets open simultaneously, airflow speed will be at the highest level and the screen brightness will be adjusted automatically based on ambient light.
-  **Comfort:** Airflow speed will be at the lowest level. If there is no operation for 3 seconds, the display will automatically turn off.
-  **Custom:** Briefly press the airflow speed button (“+”, “-”) to exit the selected purification level and adjust the airflow speed as needed.

## Heating Function

Briefly press the heating function to enable the function. Within 3 seconds, briefly press the “+” or “-” buttons to adjust the temperature within the range of 0-40° C. If there is no operation for 3 seconds, the temperature will be automatically confirmed. Briefly press the cooling function to exit the heating function.

Note: The temperature range is based on laboratory test conditions.

## Timer

Briefly press the timer button to enable the function. Within 3 seconds, briefly press the “+” or “-” buttons to adjust the time within the range of 0-12 hours. The time will be automatically confirmed after 3 seconds without any operation. Press the timer button again to cancel the timer.

# How to Use

## Directional Air Delivery

When only a single person is detected, air delivery follows the person's position. When multiple people are detected, air delivery oscillates between the largest angle formed by the people positions.

Note: It is disabled by default and can be turned on in the App. When fixed angle oscillation function is turned on, the function is disabled.

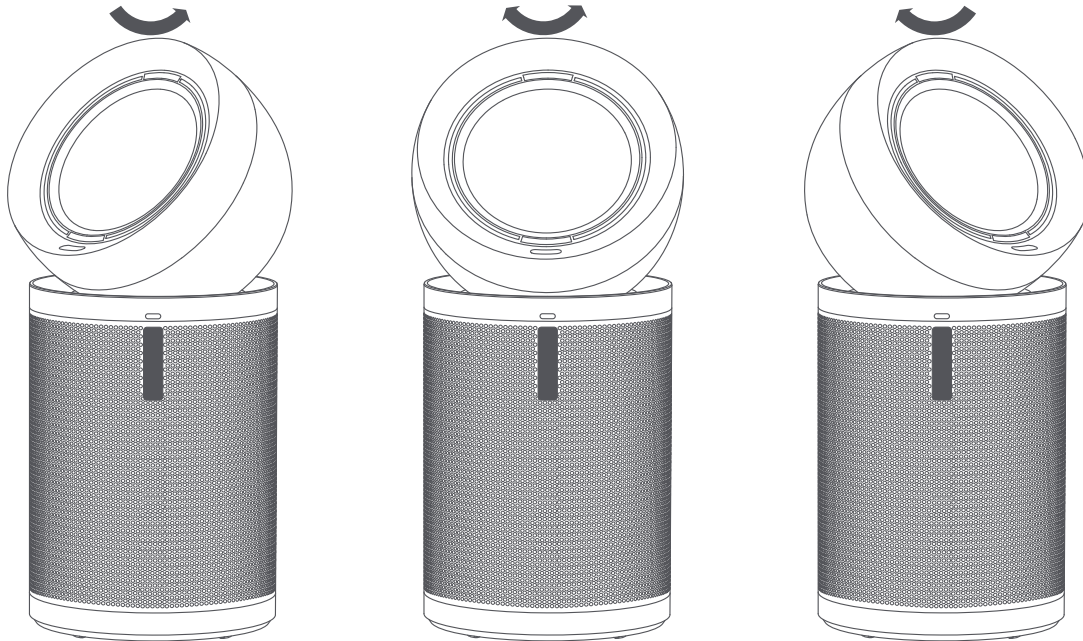

# How to Use

## Restore Factory Setting

If the machine stops responding or cannot be turned off, press and hold the power button for 10 seconds to forcefully turn it off. Then press and hold the power button for 3 seconds to turn the machine on.

## Air Pollutants

**Particulate matter (PM1):** Microscopic particles up to 1 microns in size, suspended in the air we breathe. These include industrial emissions and vehicle exhaust.

**Particulate matter (PM2.5):** Microscopic particles up to 2.5 microns in size, suspended in the air we breathe. These include smoke, bacteria and allergens.

**Particulate matter (PM10):** Microscopic particles up to 10 microns in size, suspended in the air we breathe. These include dust, mould and pollen.

**TVOC:** Total Volatile Organic Compounds. Volatile Organic Compounds(VOCs) are indoor gases emitted from solids or liquids, typically from paint, carpets, ceilings, and adhesives.

**Formaldehyde(HCHO):** A common indoor pollutant. It can be usually released from new furniture and paint materials.



# Care & Maintenance

## Note:

- When the filter life remaining is 10%, the screen will display a reminder. When the life of the filter is exhausted, it means the filter is clogged with pollutants and may restrict purified air flow and may give off unpleasant smell if continue running over time. To ensure product running at maximum efficiency, kindly replace filter within scheduled maintenance.
  - The remaining life of carbon layer and high efficiency composite filter can be checked in the App.
  - According to Dreame's internal testing, based on 12 hours of daily usage, it is recommended to replace the carbon layer every 6 to 12 months and the high-efficiency composite filter every 16 to 24 months.
  - Before the care and maintenance, please turn off the product and unplug the power cord.
- \* Only use accessories and replacement parts recommended by the manufacturer.

## Replacing the Carbon Layer

1. Remove the magnetic housing from the machine. Grab the handle of high efficiency composite filter to pull it out of the machine. Then, pull the handle of carbon layer upwards to take it out.
2. Insert the new carbon layer vertically into the high efficiency composite filter.

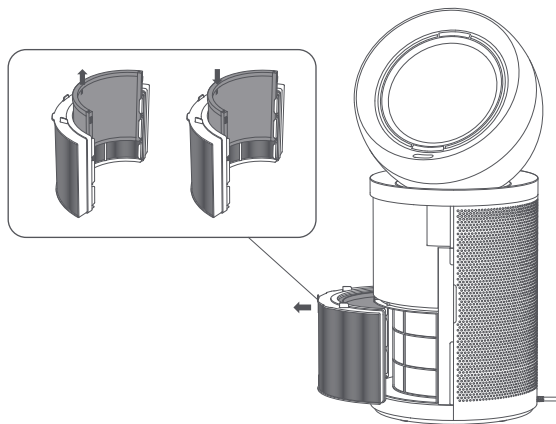

## Replacing the High Efficiency Composite Filter

1. Remove the magnetic housing from the machine. Grab the handle of high efficiency composite filter to pull it out of the machine. Then, pull the handle of carbon layer upwards to take it out.
2. Insert the carbon layer vertically into the new high efficiency composite filter.

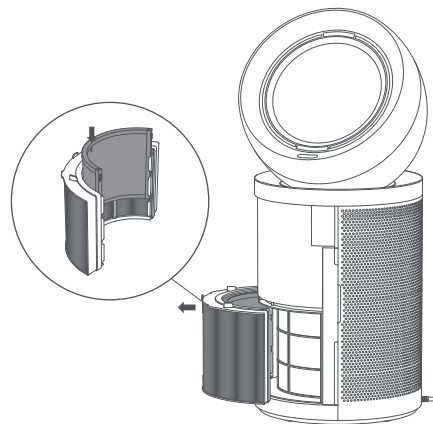

# Care & Maintenance

## Reset the Filter Life

Slide the assembled high efficiency composite filter and carbon layer into the machine, then reinstall the magnetic housing. After replacing the new filter assembly, connect the power and start the machine. Briefly press the information switch button on the machine to select the filter life interface of the new filter. Then, simultaneously press and hold the power button and information switch button for 5 seconds until the screen prompts that the filter life reset is completed.

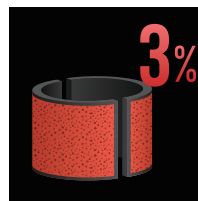
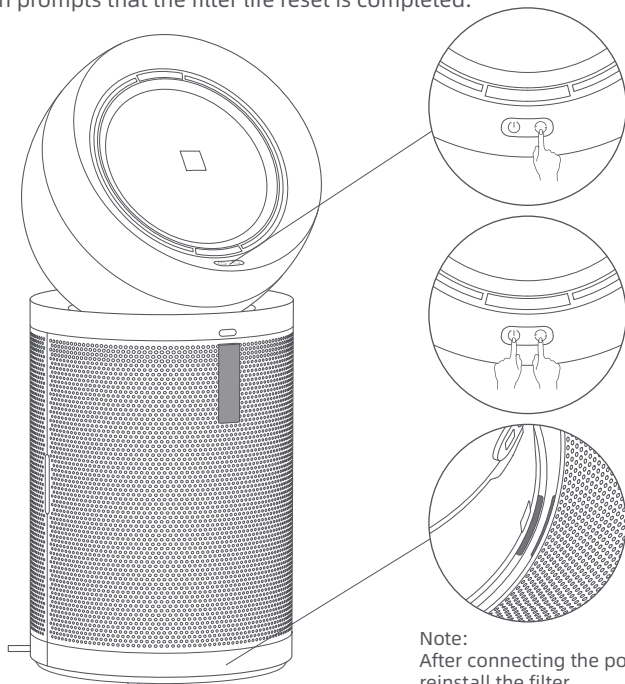

Life of Carbon Layer

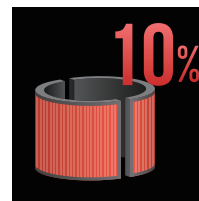

Life of High Efficiency Composite Filter



Life of Carbon Layer Reset Completed

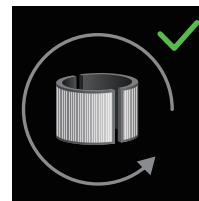

Life of High Efficiency Composite Filter Life Reset Completed

### Note:

After connecting the power, if the screen displays "", the filter is not properly installed. Please reinstall the filter.

If the machine is not working properly, please refer to the table below.

| Errors  | Possible Causes   | Solutions   |
|---|---|---|
| Machine does not turn on.                               | The power is not connected or both ends of the charger are not plugged in correctly.  | Check whether the power cord is connected to the socket. Ensure the power plug is properly inserted before use.   |
|   | No power in the socket.   | Try another power socket.   |
|   | The machine is damaged.   | Please contact the after-sales department for maintenance.  |
| Emission of odor after the startup of the air purifier. | The air purifier is equipped with a formaldehyde decomposition filter. When first unpacked and exposed to air, its formaldehyde-removal formula reaches optimal activation state and may emit a faint medicinal-like odor. This is a normal characteristic of the formula activation process, and neither indicates product malfunction nor harmful gas emission. | After unpacking, place the air purifier in a well-ventilated area. It is recommended to enable the "Pet Mode" (at maximum air speed) and run the purifier for 3-5 hours with windows and doors slightly open to enhance indoor-outdoor air circulation. Generally, such odor will diminish and dissipate within 1 week, requiring no special treatment. |
|   | The machine has absorbed excessive gaseous pollutants.  | Replace the filter or place the filter in a well-ventilated area to air out.  |
|   | Filter is damp.   | Air-dry the filter and ensure the product is in a dry environment.  |
|   | Filter life has expired.  | Replace the filter and reset the filter life.   |
| The machine makes a strange noise.                      | The machine is not placed stably.   | Place the machine on a stable surface.  |
|   | If the problem persists after ruling out the above possibility, please contact the  | after-sales service department for maintenance.   |
| The machine continuously displays poor air quality.     | Filter life has expired.  | Replace the filter and reset the filter life.   |
|   | The outdoor air quality is poor, such as severe weather and smoke from combustion.  | Please close windows and doors while using the machine.   |
|   | There is high-concentration pollution source interference in the room, such as smoke from smoking or cooking, incense, perfume or alcohol.  | Please open windows for ventilation.  |
|   | If the problem persists after ruling out the above possibilities, please contact the  | after-sales service department for maintenance.   |
| The airflow direction cannot be adjusted.               | The machine head does not rotate smoothly.  | Check if there are any obstructions blocking the rotation of the machine head.  |
|   | If the problem persists after ruling out the above possibility, please contact the  | after-sales service department for maintenance.   |
| Heating function does not work.                         | The temperature is set lower than the current ambient temperature.  | Adjust the temperature to the appropriate value.  |
|   | The air outlet is clogged.  | Clean the blockage in the air outlet.   |
|   | If the problem persists after ruling out the above possibilities, please contact the  | after-sales service department for maintenance.   |

# FAQ

|  |   |   |
|--|---|---|
| Filter replacement reminder continues after replacement.     | The filter life has not been reset.   | After replacing the filter, please reset the filter life.           |
| The screen displays an error code/icon.                      | Please contact the after-sales department for maintenance.                    |   |
| The screen of the air purifier turns black during operation. | The product is subjected to impact, vibration, shaking, or tilting over 70° . | Place the air purifier on a flat and steady surface and restart it. |
|  | The display module of the product is damaged.                                 | Please contact our after-sales service personnel for repair.        |

## Specifications

|   |  |   |                    |  |         |
|---|--|---|--------------------|--|---------|
| Model   | CVF14A   | Rated Input                                       | 120 V~60 Hz        | Rated Power                                | 1400 W  |
| Bacteria Removal Rate                             | ≥ 99.9 % (Staphylococcus epidermidis; Staphylococcus aureus) | Dimensions  | 380 × 380 × 850 mm | Rated Power (fan mode)                     | 33 W    |
| Clean Air Delivery Rate (CADR) (for particles)    | ≥ 400 m <sup>3</sup> /h                                      | Cumulative Purification Volume (for particles)    | P4                 | Purification Efficiency (for particles)    | Level 1 |
| Clean Air Delivery Rate (CADR) (for formaldehyde) | ≥ 220 m <sup>3</sup> /h                                      | Cumulative Purification Volume (for formaldehyde) | F4                 | Purification Efficiency (for formaldehyde) | Level 1 |

The purification values are obtained with the machine operating in Pet Mode with both upper and lower air outlets fully open.

The filter material of this machine adopts: treated H13 grade composite, treated activated carbon, and unique never needs replacing catalytic sponge.

The filter's purification performance gradually diminishes over its lifecycle. The machine's LCD screen will indicate the remaining filter life and notify when a replacement is needed.