



COFFEE DISPENSERS

**Models SBC570NCF
SBC570CF
SBC570CMTWIN**



SBC570NCF

Instruction Manual

BEFORE USE, PLEASE READ AND FOLLOW ALL SAFETY RULES AND OPERATING INSTRUCTIONS.

Write Model No. and Serial No. (from back of unit) here:

Felix Storch, Inc.
An ISO 9001:2015 registered company
770 Garrison Avenue
Bronx, NY 10474
www.summitappliance.com

IMPORTANT SAFEGUARDS



IMPORTANT – All persons who will operate this equipment must read and become thoroughly familiar with all operating procedures and safety precautions. Misuse of this equipment may result in personal injury, death, or property damage.

1. You will need this manual for the safety warnings and precautions, operating, inspection, maintenance and cleaning procedures, parts list and assembly diagram. Record the Model and Serial Numbers (from the back of the unit) on the cover of this manual. **Keep the manual in a safe and dry place for future reference.**
2. The warnings, cautions and instructions discussed in this manual cannot cover all possible conditions and situations that may occur. It must be understood by the operator that common sense and caution are factors that cannot be built into this product but must be supplied by the operator.
3. Never use this product for anything but its intended use. Never modify this product. Failure to comply with the precautions, warnings and recommendations in this manual will nullify your warranty and may result in injury or even death.
4. Always insure that this coffee dispenser is plugged into a grounded outlet with the proper power supply available.
5. Do not unplug the machine by pulling or tugging on the power cord. Firmly grasp the plug and remove from the outlet.
6. Make sure the power outlet, plug and power cords are in good condition. Worn, frayed or damaged plugs, cords and outlets should be replaced or repaired by a certified electrician who is properly qualified to meet local safety and electrical codes. Power supply cords should be replaced by the manufacturer.
Avoid using extension cords or 3-prong adaptors.
7. To reduce the risk of electrical shock or fire, make sure your unit is properly grounded. *Never tamper with, remove or cut the grounding pin!* The wall outlet used with this coffee dispenser **MUST** be properly grounded. If you do not have a grounded outlet, have one installed by a certified electrician who is properly qualified to meet local safety and electrical codes.
8. Make sure your machine is unplugged when you conduct any maintenance or repair. A qualified service technician should always perform service or repair.
9. This product is not intended for commercial use.
10. Do not cover the power cord. Do not immerse cord in water or use in high traffic areas. Do not run cord over carpets or heating sources or elements. Never use the appliance with damaged cords or plugs.
11. **This product is intended for upright, free-standing use only.** Do not install in a cabinet or enclosed space.
12. Do not operate with missing or broken parts.
13. **This product is intended for indoor use only.** Do not use outdoors.
14. Only qualified repair personnel should perform generator service. Service or maintenance performed by unqualified personnel could result in injury.
15. Do not operate this coffee dispenser in explosive atmospheres, such as in the presence of flammable liquids, gases or dust.
16. Do not tamper with or modify the controls.
17. Do not roll a loaded coffee dispenser over carpeting. Make sure your unit is empty before moving it.

18. KEEP UNIT UPRIGHT when transporting. Do not allow to tilt past 45 degrees. Do not upend or turn upside down.
19. WARNING! Children must be supervised around this machine. Make sure that children know that this coffee dispenser is NOT A TOY. Close door during operation and leave closed at all times when children are present.

WARNING: EXTENSION CORDS

Because of inherent dangers from faulty or inferior cords, avoid the use of extension cords. When you cannot avoid their use, be sure that the cord is a 3-wire cord with a 3-prong grounded plug. The cord should be rated for AT LEAST 1875 watts and a No. 14 AWG minimum size.

DANGER: RISK OF CHILD ENTRAPMENT

If you are disposing of this machine, we recommend that you remove the door but leave any shelves in place to reduce the risk of injury to children. DO NOT ALLOW CHILDREN TO BECOME TRAPPED.

ALWAYS supervise children when using this product when they are present. At all times be sure that children are not playing with the unit.

LOCATION RECOMMENDATIONS

1. INDOOR USE ONLY. DO NOT ATTEMPT TO USE OUTDOORS.
2. INTENDED FOR UPRIGHT, FREE-STANDING USE ONLY. Do not install in cabinet or enclosed space.
3. Get the most out of your coffee dispenser! To maximize efficiency and long life, use near a proper electrical outlet and ensure that there is adequate ventilation and clearance around the unit. Allow at least 5 inches clearance around all sides of the coffee dispenser. Dimensions: 21.3"W x 26.6"D x 33.2"H (with casters and without tap)
4. Avoid locations where this unit will be in contact with heating elements or direct sunlight.

NITROGEN (N₂) SAFETY PRECAUTIONS, WARNINGS & DANGER NOTICES

1. **DANGER!** Nitrogen is a potentially dangerous gas. Canisters or cylinders are under pressure and proper handling is essential for safety. Familiarize yourself with canister installation and replacement before operating this unit. HANDLE WITH CARE. Never jostle, toss or treat cylinders roughly. If you experience headache or difficulty breathing, a leak may be occurring; open windows and doors to ventilate the area and leave immediately.
2. INTENDED FOR UPRIGHT, FREE-STANDING USE ONLY. Do not install in cabinet or enclosed spaces.
3. Store N₂ cylinders away from heat or explosive gases. Keep in a cool, dry space (lower than 70°F) and chain canisters upright to avoid tipping or knocking. Always wear gloves and safety glasses when around chemicals.
4. Review and follow instructions for changing N₂ cylinders. NEVER CONNECT A NITROGEN CANISTER DIRECTLY TO THE UNIT. To avoid potential explosion that could result in grave injury or even death, ALWAYS CONNECT THE CANISTER TO THE N₂ REGULATOR. There are two safety valves, located separately. One is in the regulator and one on the N₂ canister. DO NOT REMOVE VALVES, AND DO NOT EXCEED 50 PSI.
5. DO NOT ATTEMPT TO REFILL N₂ CANISTERS! Refills are available where most canisters are sold (see page 6 for more information).

SAVE THESE INSTRUCTIONS

TABLE OF CONTENTS

<i>Important Safeguards</i>	1-2
<i>Technical Information</i>	3
<i>Coffee Dispenser Accessories</i>	4
<i>Coffee Dispenser Assembly</i>	5-7
<i>Caster Assembly</i>	5
<i>Guardrail Assembly</i>	5
<i>Coffee Tap Installation</i>	5
<i>N₂ Regulator Installation</i>	6-7
<i>Operation, Maintenance & Storage</i>	8
<i>Limited Warranty</i>	11

TECHNICAL INFORMATION

Models:	SBC570NCF (for nitro-infused cold brew coffee) SBC570CF (for “flat” cold brew coffee) SBC570CMTWIN (for both types)
Capacity:	6.0 cubic feet
Electrical Input:	115VAC ~ 60Hz
Rated Current:	1.9A
High Side Pressure:	300psi
Low Side Pressure:	88psi
Refrigerant:	R134a, 2.82 oz.
Net Weight:	88.2 lbs
Unit Dimensions:	21.3"W x 26.6"D x 33.2"H <i>(with casters but without coffee dispenser tower)</i>

COFFEE DISPENSER ACCESSORIES

Tower Assembly



Ball Lock (Pepsi Kegs)



N₂ Regulator Valve

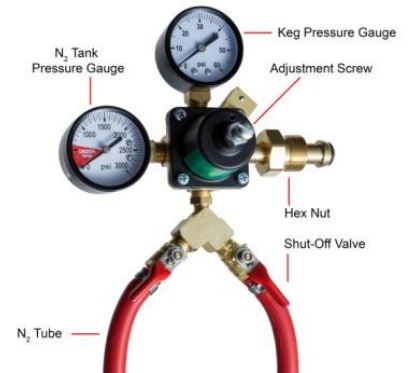

Cornelius Keg



(not included)

N₂ Gas Cylinder



COFFEE DISPENSER ASSEMBLY

Be sure you have a thorough familiarity with the assembly and installation process before turning on your coffee dispenser.

NOTE: Once casters are assembled, place your unit in an upright position and allow it to sit for at least 8-10 hours before plugging into an outlet. This will allow the refrigerant to settle before operation.

CASTER ASSEMBLY

1. Remove everything from the cabinet and lay the unit on a clean, dry and padded surface.
2. Install casters into holes on bottom of unit as shown and tighten with a wrench. Two of the four casters provided are equipped with locks to prevent slippage of the keg on smooth surfaces such as hardwood floors, linoleum or tile. **These casters should be installed on the front of the unit.**
3. Once all four casters are attached, return the coffee dispenser to an upright position and allow it to rest for at least 8-10 hours. (See Note above.)

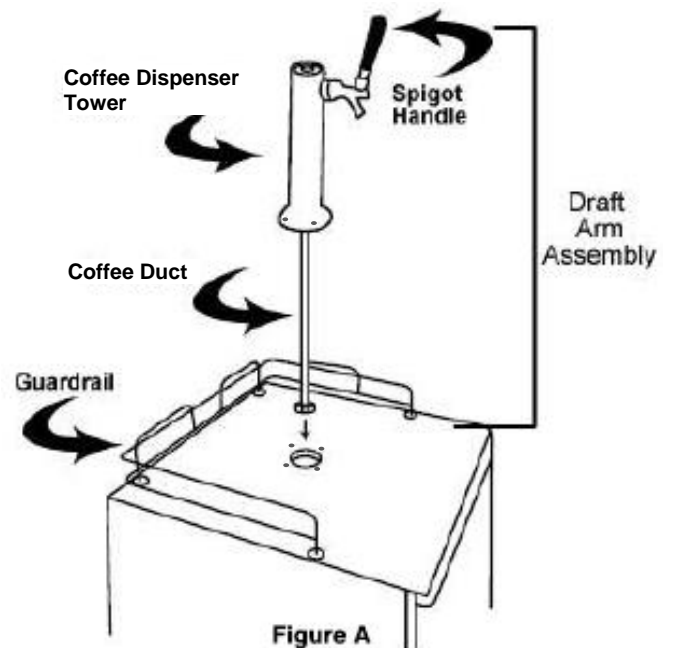

Figure A

GUARDRAIL INSTALLATION

To install the guardrail,

1. Place the guardrail on top of the coffee dispenser and line up the feet of the guardrail with the holes on top of the cabinet.
2. Using the screws provided, secure each foot to the cabinet.

COFFEE TAP INSTALLATION

1. Put draft tower directly over the hole on the top of the coffee dispenser's upper surface. Fix the tower assembly with screws directly to the upper surface of the dispenser. (See figures A and B in the next column.)

While not required, we recommend the use of the black rubber gasket when installing the coffee tap. Using the gasket will provide a more secure seating for the arm assembly.



Figure B

N₂ REGULATOR INSTALLATION

Proper installation of your nitrogen regulator and a thorough understanding of N₂ canisters are essential to the safe use of this product. Review and follow instructions for handling N₂ cylinders and this section in particular to ensure your safety and the safety of others.

NEVER CONNECT A NITROGEN CANISTER DIRECTLY TO THE UNIT! To avoid potential explosion that could result in grave injury or even death, ALWAYS CONNECT THE CANISTER TO THE N₂ REGULATOR.

IMPORTANT! Your N₂ canister is shipped to you **EMPTY** for safety reasons. You will need to get this canister filled before you can use your unit. In most areas, you can get canisters filled at:

- stores that sell kegs
- party stores or convenience stores
- fire and welding supply stores.

DO NOT ATTEMPT TO REFILL N₂ CANISTERS YOURSELF!

DANGER! Nitrogen is a potentially dangerous gas. Canisters or cylinders are under pressure and proper handling is essential to safety. ALWAYS HANDLE WITH CARE!

To install the nitrogen (N₂) cylinder:



1. Using a wrench, tighten the hex nut port on the regulator valve to the N₂ gas outlet on the N₂ gas cylinder. (See figure D.)

Figure D

2. Place the N₂ gas cylinder into the bracket on the rear wall of the coffee dispenser's inside cabinet and fix the N₂ cylinder with the bolt. (See figure E.)



Figure E

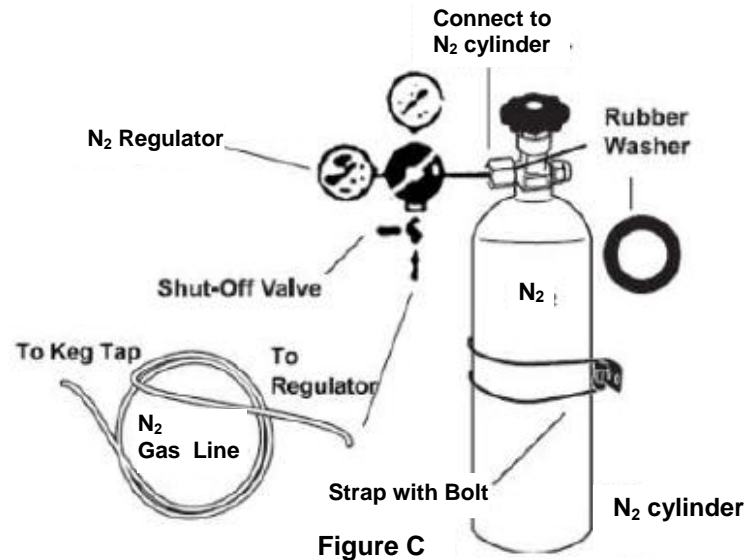

Figure C



3. Carefully place the keg inside the coffee dispenser. Attach the coffee tube from the tower to the “out” post of the of the Cornelius keg by pushing the ball lock down over the “out” post until it snaps in place. (See figure F.)

Figure F

4. Attach the N₂ tube to the “in” post of the Cornelius keg by pushing the ball lock down over the “in” post until it snaps on.
5. Set the desired pressure on the regulator valve. If serving flat iced coffee, open the regulator valve and set the pressure between 4-8 psi. If serving nitro-infused coffee from the stout-style tap, set the pressure between 30-45 psi.
6. Install the tap handle(s) and coffee tap(s). Screw the tap handle clockwise into the coffee tap to make a firm connection, then connect the tap to the coffee tower components and tighten with a wrench.

NOTE: For optimum nitro-infused coffee service, agitate the keg before serving.

7. Install the upper cover guardrail (provided with your kegerator) and drip tray.

SPECIAL PRECAUTIONS: Ensure that the safety devices for your pressurized system are installed and remain installed. Once installed, **NEVER** remove the rubber washers in the regulator attachment nut to the canister or in the tap mechanism. **NEVER** bypass these safety features.

Failure to comply will void your warranty and could result in serious injury or death!

Notes:

- These taps are designed for dispensing coffee and should not be used for milk or any other substance.
- When replacing the coffee keg, first turn the safety switch on the N₂ regulator valve and remove the ball locks to take out the keg.
- When replacing the N₂ gas cylinder, remember to turn off the main switch of the N₂ tank and the safety switch on the N₂ regulator valve. Afterwards, use a wrench to loosen the hexagonal nut port connecting the N₂ regulator valve with the N₂ tank. Then, using a wrench, remove the fixed bolt of the N₂ tank.
- During the installation process, be sure that all parts are connected tightly and that there are no gas leaks.
- High-pressured compressed gas in the N₂ tank can be dangerous if not handled properly. For optimum safety, make a note of the D.O.T. testing date on the cylinder neck before installation. If it is more than 5 years old, do not use.
- Keep the gas cylinder away from heat sources. Unused cylinders should be placed upright in a cool, ventilated place, preferably at 70°F.

OPERATION, MAINTENANCE & STORAGE

USING YOUR COFFEE DISPENSER

1. First be sure that you are connected safely to the proper power supply: a 120V, 60Hz, 16 Amp grounded AC outlet. The cord should be rated for **AT LEAST 1875 Watts and a No. 14 AWG minimum size**.
2. Slide the drip tray beneath the spigot to catch any spillage, then pull the tower handle toward your body to open the tap and dispense coffee.

Note: If coffee does not dispense, check previous sections on Coffee Dispenser Assembly.

If your coffee is dispensing too slowly, adjust the pressure on the regulator judiciously (**DO NOT EXCEED 8 PSI FOR "FLAT" COLD BREW COFFEE, OR 45 PSI FOR NITRO-INFUSED**).

Condensation on the spigot or tap is normal.

STORING YOUR COFFEE DISPENSER

1. To prevent ice buildup on the inside of the cabinet, set the temperature control to MID or LOW if you live in a cold area. This unit does not self-defrost. The temperature control is located inside the coffee dispenser.
2. If you do not expect to use your coffee dispenser for an extended period of time, rinse the coffee line to prevent mold or bacterial buildup which could cause illness.
3. Never use sharp objects in your coffee dispenser. If you are storing your machine, be sure to prevent children from playing in or around the unit.

DANGER! Children can become trapped in an unsecured and unsupervised environment.

CLEANING AND MAINTENANCE

To clean the lines and tap, first:

1. **TURN OFF THE N₂.**
2. Next, wipe the outside of the machine, clean drip tray and around guardrail. Clean the inside of the cabinet by wiping with a damp cloth. Clean gasket on door to help eliminate trapped, spilled coffee which could produce mold and mildew.
3. Disconnect the coffee hose from the tap coupler and twist dispenser faucet carefully off the top of the coffee dispenser.
4. Set the dispenser handle to the open or down position before flushing, then position the faucet over a sink and hold the coffee line under running water for approximately 5 minutes, allowing the water to flush out the faucet head. This will also help eliminate trapped, spilled coffee which could produce mold and mildew.
5. Reconnect coffee line and dispenser faucet when done or leave disconnected if you plan to store for a long period.

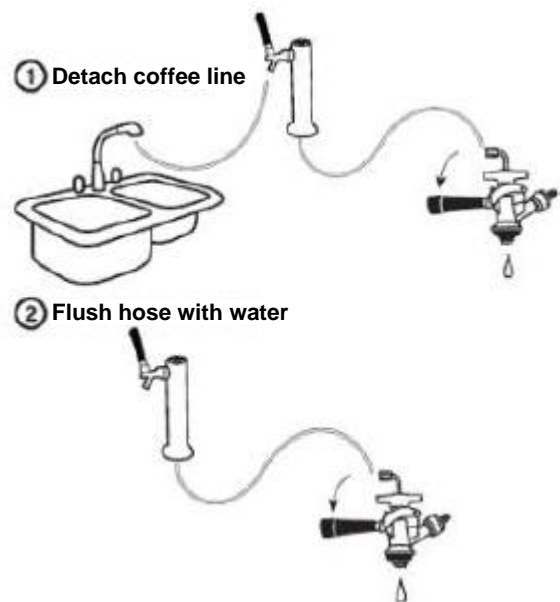

NOTES



NOTES



LIMITED WARRANTY

ONE-YEAR LIMITED WARRANTY

Within the 48 contiguous United States, for one year from the date of purchase, when this appliance is operated and maintained according to instructions attached to or furnished with the product, warrantor will pay for factory-specified parts and repair labor to correct defects in materials or workmanship. Service must be provided by a designated service company. Outside the 48 states, all parts are warranted for one year from manufacturing defects. Plastic parts, shelves and cabinets are warranted to be manufactured to commercially acceptable standards, and are not covered from damage during handling or breakage.

5-YEAR COMPRESSOR WARRANTY

1. The compressor is covered for 5 years.
2. Replacement does not include labor.

ITEMS WARRANTOR WILL NOT PAY FOR:

1. Service calls to correct the installation of your appliance, to instruct you how to use your appliance, to replace or repair fuses or to correct wiring or plumbing.
2. Service calls to repair or replace appliance light bulbs or broken shelves. Consumable parts (such as filters) are excluded from warranty coverage.
3. Damage resulting from accident, alteration, misuse, abuse, fire, flood, acts of God, improper installation, installation not in accordance with electrical or plumbing codes, or use of products not approved by warrantor.
4. Replacement parts or repair labor costs for units operated outside the United States.
5. Repairs to parts or systems resulting from unauthorized modifications made to the appliance.
6. The removal and reinstallation of your appliance if it is installed in an inaccessible location or is not installed in accordance with published installation instructions.

DISCLAIMER OF IMPLIED WARRANTIES; LIMITATION OF REMEDIES

CUSTOMER'S SOLE AND EXCLUSIVE REMEDY UNDER THIS LIMITED WARRANTY SHALL BE PRODUCT REPAIR AS PROVIDED HEREIN. IMPLIED WARRANTIES, INCLUDING WARRANTIES OF MERCHANTABILITY OR FITNESS FOR A PARTICULAR PURPOSE, ARE LIMITED TO ONE YEAR. WARRANTOR SHALL NOT BE LIABLE FOR INCIDENTAL OR CONSEQUENTIAL DAMAGES. SOME STATES DO NOT ALLOW THE EXCLUSION OR LIMITATION OF INCIDENTAL OR CONSEQUENTIAL DAMAGES, OR LIMITATIONS ON THE DURATION OF IMPLIED WARRANTIES OF MERCHANTABILITY OR FITNESS, SO THESE EXCLUSIONS OR LIMITATIONS MAY NOT APPLY TO YOU. THIS WARRANTY GIVES YOU SPECIFIC LEGAL RIGHTS AND YOU MAY ALSO HAVE OTHER RIGHTS, WHICH VARY FROM STATE TO STATE.



WARNING: This product can expose you to chemicals including Nickel (Metallic) which is known to the State of California to cause cancer.

For more information go to www.P65Warnings.ca.gov

Note: Nickel is a component in all stainless steel and some other metal components.

FELIX STORCH, INC.
770 Garrison Avenue
Bronx, NY 10474
Phone: (718) 893-3900
Fax: (844) 478-8799
www.summitappliance.com

SUMMIT

For parts and accessory ordering,
troubleshooting and helpful hints, visit:
www.summitappliance.com/support