USER MANUAL

KINGSLIM DL12 Pro Dash Cam

KINGSLIM

v2.0

CONTACT US

For any inquiries about KingSlim products, please feel free to contact us. We will respond within 24 hours.

Tel: 888-811-1140 (US)

Email: cs@kingslim.net

Web: www.kingslim.net

CONTENTS

What's in the Box	2
Camera Overview	3
Installation	4
Formatting the microSD Card	7
Start Video Recording	7
Icon Introduction	8
Setup Menu	9
Gestures	14
Download the GPS Player	16
Specifications	16
Troubleshooting	17
Caution!	17

WHAT'S IN THE BOX



Mirror Dash Cam
DL12 Pro * 1



Waterproof Rear
Camera * 1



External GPS Module * 1



23ft Rear Camera
Extension Cable * 1



Car Charger with 11.5ft
Power Cable * 1



Back Straps * 4



Screws * 4



Double-sided Adhesive Tape
for Rear Camera * 2



Cable Clips * 5



Pry Tool * 1



Quick Start Guide * 1

CAMERA OVERVIEW

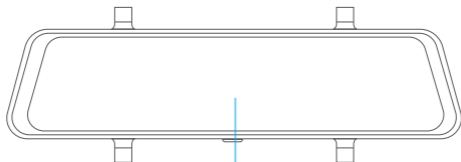

Touchscreen Display



Mini USB Power Port

Memory Card Slot

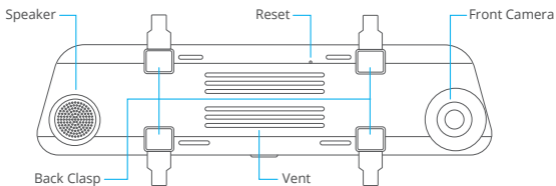

Back Clasp

Vent



Mic

Power Button/Screen Saver

INSTALLATION

1. Insert the memory card.

Warm Tips: A Class 10 or above memory card is highly recommended for the DL12 Pro dash cam (memory card is not included). DL12 Pro dash cam supports an up to 128GB memory card. Please format your card in the camera before using this dash cam. Do not remove or insert the memory card when the dash cam is turned on. This may damage the memory card.

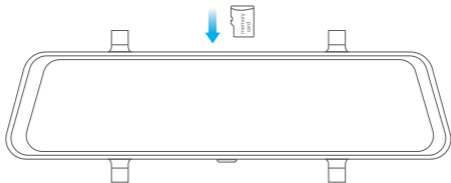

2. Install the mirror dash cam

Mount the DL12 Pro over the original rearview mirror of the car with the provided strap, then adjust the angle of the front camera.

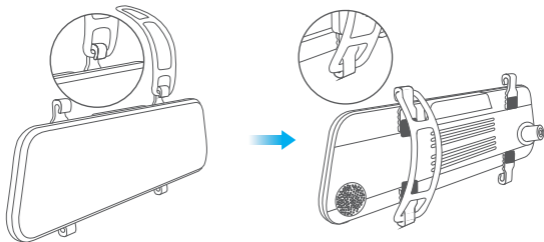

3. Connect the USB power cable into the USB power port of DL12 Pro Dash Cam, then plug the car charger into the cigarette lighter of your car.

4. Connect the GPS module to the dash cam and attach it on the A-Pillar.

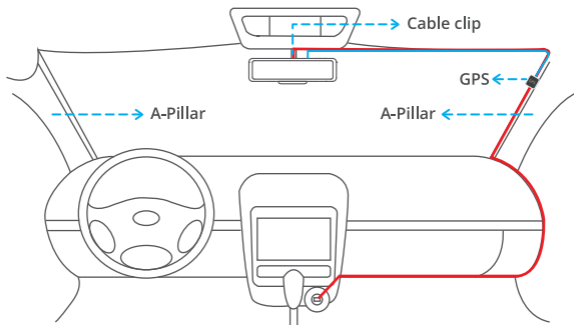

5. Install the rear camera.

① Connect the rear camera with the extension cable into DL12 Pro Dash Cam to check whether the rear camera works well.

② Installation position options.

Position 1: Install the rear camera on the rear windshield. Position 1 is designed for live stream rear review only, not for reversing guide. This installation is much easier than other products.



Position 2: Install the rear camera near the license plate. Position 2 is highly recommended. The back image is crisp and clear for both rear viewing and reversing guide.



To use the reversing function, please install the rear camera in position 2, then connect the red trigger wire of the rear camera extension cable to the positive lead of the vehicle reversing lamp.

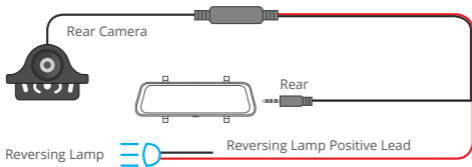

Note:

- Pay attention to the connector position when connecting the rear camera with the extension cable. Please refer to the below details:



- Please clean the position to ensure the adhesive quality before installing the rear camera.
- Please clean the rear windshield regularly to ensure the image quality if you choose the position 1.
- If you choose the position 2, you can install the rear camera with the included adhesive stickers or screws.

6. Use the pry tool to hide the cables.

FORMAT THE MEMORY CARD

1. Tap the setting icon  to enter the Settings page.
2. Select "Format SD" then tap the "Confirm" icon. Wait a few seconds to finish the formatting, and the system will exit automatically.

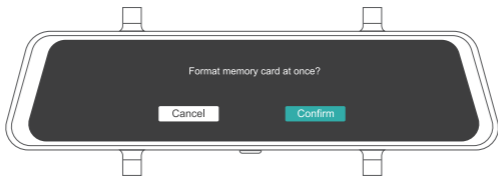

START VIDEO RECORDING

1. After finishing formatting, connect a car charger and start the car engine. The device will automatically turn on and begin recording.
2. Loop recording is already enabled on the DL12 Pro dash cam. The default setting is "1 MIN".
3. G-sensor is already enabled on the dash cam. The default setting is Low. If an impact or sudden braking is detected, it will automatically start recording and save footage to either the "Front urgent video" or "Rear urgent video" folder.

ICON INTRODUCTION

The Main Interface

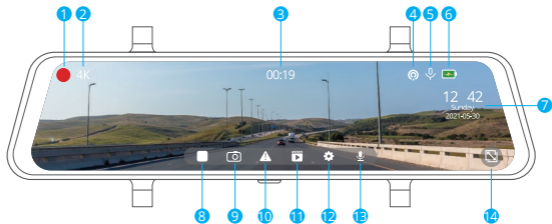

- | | |
|--|-------------------------------|
| 1 Recording Indicator | 2 Recording Resolution |
| 3 Video Time | 4 GPS |
| 5 Microphone Indicator | 6 Power Status |
| 7 Date/Time | 8 Stop/Start Recording |
| 9 Taking Photo | |
| When taking photos, click the icon "📷" to save the photo. | |
| 10 Emergency Recording | |
| When DL12 begins to work, click the icon "⚠️" to lock the current video. | |
| 11 Audio Record (Mute/Unmute) | 12 Setting |
| 13 Microphone Indicator | 14 Zoom out |

SET-UP MENU

1. Resolution

Choose a recording resolution.

Options: 4K (3840*2160) / 2K (3840*2160)

Default Setting: 4K+1080P

2. Split time

Files will be saved every 3 minutes if you choose the 3 MINS option. When the memory card is full, the new file will cover the existed one if loop recording is on.

Options: 1 MIN/3 MINS/5 MINS

Default Setting: 1MIN

3. Video Encode

H.265 minimizes the footage size, so you can store more video files on the memory card. H.264 has better compatibility.

Options: H.264 / H.265

Default Setting: H.265

4. Audio

Sound will be recorded simultaneously with video.

Options: On/Off

Default Setting: On

5. Sensitivity

When the G-Sensor is turned on, it will automatically start recording and save content if an impact or sudden braking is detected. The videos will be locked and will never be overwritten by new files. The higher the sensitivity level, the easier it is to trigger the emergency recording.

Options: Off / Low / Middle / High

Default Setting: Low

6. Parking Guard

The camera will automatically turn on, begin the 20s recording, and lock if there is an impact to the car during parking. The higher the level you select, the easier it is to trigger the recording.

Options: Off / Low / Middle / High

Default Setting: Off

Note: In parking mode, the screen will not display, and the working indicator will be flickering while recording is in progress. When the dash cam is on, the message box is shown on the screen.

7. Frequency

Choose the right frequency to avoid flickering. This should be based on your local AC parameters.

Options: 60Hz / 50Hz

Default Setting: 60Hz

8. Screen Dormant

The screen will turn off automatically after the time you set. When the screen turns off, power consumption will be reduced. The camera still works while the display screen is turned off. Just click the screen, and it will turn on.

Options: Off / 1MIN / 3MINS

Default Setting: 1MIN

9. Screen Brightness

Slide icon to left or right to dimming the screen light.

10. Keypad tone

11. Volume

Adjust the volume in the playback video.

12. Intelligent voice

Option: ON and OFF

Default Setting: ON

Turn on the intelligent voice feature, user can operate the device by saying key command while driving.

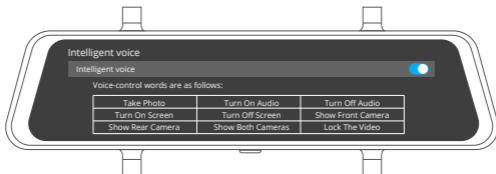

13. Rear Mirror

This function is for the rear camera. The rear camera video is flipped horizontally and vertically in the main recording interface, as if you are looking in a mirror.

Options: ON and OFF

Default Setting: ON

14. Perspective

Option: Full Screen and Full Frame

Default Setting: Full Screen

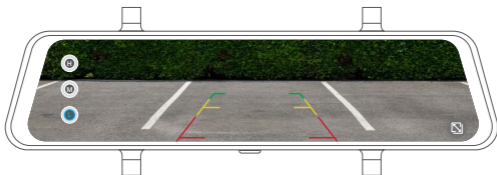

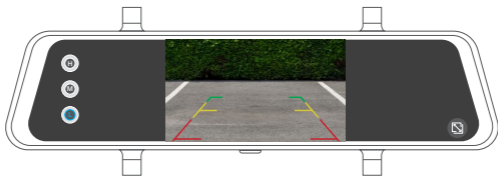

The device can set High/Middle/Low which three types of reversing assistance while reversing car.

15. Fatigue reminder

Option: ON and OFF

The device will remind you to rest every 2 hours when you have been driving.

16. Time Setting

Set date and time format.

17. OSD

Option: ON and OFF

Recording video with or without watermark.

18. USB Mode

Storage: The device can be connected to a computer via a USB cable to copy and transfer files to/from a computer.

UVC: USB video class. The device can be connected to a computer via a USB cable as a computer camera.

CHARGE: Charging the dash cam.

19. Language

English / 简体中文 / 繁體中文 / 日本語 / русский / ไทย / Deutsch / Le Français / Español / Polskie / Italiano

Default Setting: English

20. Time format

Three types of date formats can be set.

21. Format

Format the memory card.

Note:

- ① All data will be deleted. Before formatting your memory card, please remember to back up your important data on another device.
- ② Before the memory card is inserted for the first time, please format it in the camera to ensure that the card is compatible with the camera.

22. Default

The dash cam will be restored to factory settings.

23. Version

Use this to check the version of the dash camera.

24. GPS info

Check the GPS information.

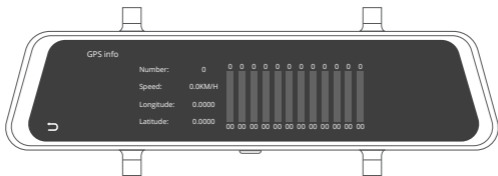

25. Time Zone

Choose the time zone manually. The device will then display the time of the selected time zone.

Default Setting: OFF

26. Speed Unit

You can set the speed unit that you prefer.

Options: KM/H and MP/H

Default Setting: KM/H

GESTURES

1. SWITCH RECORDING DISPLAY MODES

On the screen, slide from right to left to switch the view modes among front view only, back view only, and both front and back views.



2. ENTER THE PLAYBACK MENU

On the screen, slide from left to right to enter the playback menu. Tap the folder name to choose a folder.



3. ADJUST THE VIEWING ANGLE OF THE CAMERA

On the left side of the screen, slide your finger up or down to adjust the viewing angle.

Note: If you choose the view mode that displays both views of the front and rear cameras, the view angle adjustment feature is disabled.



4. ADJUST THE SCREEN BRIGHTNESS

On the right side of the screen, slide your finger up or down to adjust the screen brightness.



DOWNLOAD THE GPS PLAYER

Download the GPS player: www.kingslim.net/player

SPECIFICATIONS

Front Camera	f/1.8, 170° FOV
Rear Camera	f/1.8, 160° FOV
Video	4K+1080P/2.5k+1080P
Screen	12-inch IPS touchscreen
Video Coding	H.264/H.265
Input	5V DC
Memory Card	support up to 128GB
Battery	500mAh
Working Temperature	-20°C~60°C (-4°F~140°F)

TROUBLESHOOTING

1. The dash cam is not recording.

Check whether your memory card has enough space. Back up any important data to another device first, and then format the memory card.

2. The dash cam stops during recording.

During recording, a large amount of high-definition video data is processed. Please use a high-speed memory card of Class 10 or higher.

3. A "File Error" prompt appears when playing back pictures and videos.

Use a legal copy memory card, and be sure to format it.

4. The image is misty.

Ensure there are no fingerprints or other marks on the camera lens. Use a soft and dry cloth to clean the lens. Clean the front windshield.

5. Crashing

If your device crashes, use a sharp object to press the reset button to restart the device.

6. No sound on the video.

Ensure the audio recording mode is on.

7. The camera keeps turning on and off automatically.

Please charge the camera with the included car charger. Do not charge the battery via the USB data cable with other adapters.

CAUTION!

1. Please place your device in a secure location and protect the lens from scratches and dirt.
2. Do not expose the device to rain, moisture, or water under any circumstance.

Only the rear camera is waterproof.

3. Avoid leaving the device in direct sunlight for extended periods of time.
4. Do not remove or expose the internal battery.