

4G Smart Watch

User Manuel

SIM Card Tray Q153



Leefine

Contents

1. Preparation Work.....	02-04
1.1 Package content.....	02
1.2 Requirements of SIM Card.....	02-03
1.3 Physical features of watch.....	03-04
2. Getting Started.....	05
2.1 Install SIM Card.....	05
2.2 Download the Mobile App.....	05-06
2.3 Register APP account.....	06-10
3. Part of functions of the watch.....	11-12
4. Part of functions of the APP.....	13-16
5. Specifications.....	17
6. Frequently Asked Questions.....	17-19
7. Warning and Caution.....	20-26

1. Preparation Work

1.1 Package Content

Smart Watch.....	1pc
User Manual.....	1pc
Charging Cable.....	1pc

1.2 Requirements of SIM Card

Please prepare a **4G NANO SIM Card** and make sure:

- A** 4G frequencies of the SIM card is compatible with that of the watch(you can consult with seller or operator for that);
- B** It has good 4G coverage in your area;

- C** It has been activated properly and you have applied for a suitable monthly/yearly plan;
- D** The monthly/yearly plan includes data and caller ID service.

1.3 Physical Features of watch

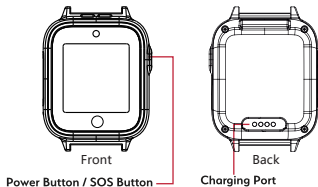
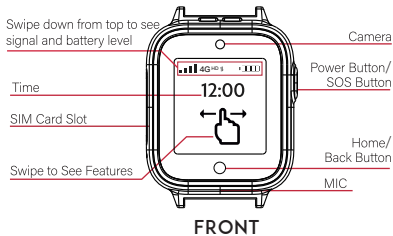

Power Button: ON/OFF/SOS

Short Press 1 time: ON/OFF the screen

Long press power button 3s to start up SOS

#Additional remarks: 1. If there is separate SOS button on your device, please long press it 3s to start up SOS.
2. After inserting the SIM card, please enter to the watch's settings to restart it.

Charging instructions:

1. Please use the charging cable inside the box to charge.
2. Please use a charger that meets national standards for charging, with a voltage of 5V and current of 1A.

2. Getting Started

2.1 Install SIM Card

- A** Make sure you have prepared the correct NANO SIM card as follow:



SIM



Micro SIM



NANO SIM

- B** Do not turn on the watch before installing SIM Card.
- C** Pull the SIM Card tray out.
- D** Put the SIM Card into the card tray, pay attention to unfilled corner; Or insert the SIM card according to the card insertion prompt on the watch.
- E** Put card tray back into the watch.

2.2 Download the Mobile App.

Choose one of the following options to download the mobile app.

- A** Download the app from the Apple Store or Google Play by searching "Leefine".



Leefine

- B** Scan one of the QR codes below to download to your phone (be aware that IOS and Android system use the different QR Code)



Scan for IOS



Scan for Android

2.3 Register APP Account

To use the APP properly, you need to register in APP and have an account, there are 2 ways to do so.

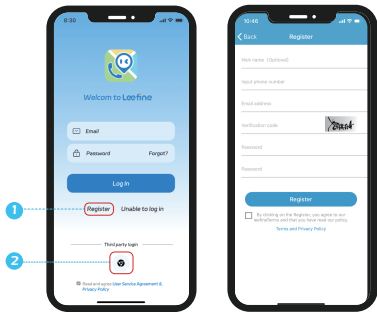

- A** Open Leefine APP, Tap "Register" and fill in all necessary information, please note it is guardian's information, not kid's.
- B** You can use your Google account to log in as a third party (if you have one), in login page there is "fast login" option at the bottom, remember to fill in the correct phone number you are now using,

Tips: One mobile phone number can only register one Leefine account, so if you have got an account by normal registering, then you must differentiate your mobile phone number when using "fast login", for example add country code before your number .

2.4.Pair the watch with the App.

To use the watch properly you must pair the watch with Leefine App so that they can "communicate" properly. Log in Leefine, enter homepage, tap on the top-right corner, tap "the avatar" and "Scan Binding Code", then scan the QR Code(binding Code) at the backside of the watch, fill in all necessary information and then done.

Important Note: the information you are about to enter is the KID'S INFORMATION who will be using this watch. Phone number here is the number of the watch, not your mobile phone number.

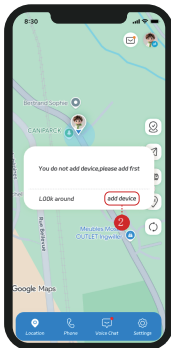
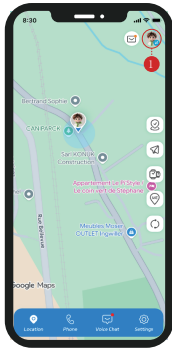

Tips 1: The first account that binds the watch will be primary account, primary account has the access to all watch's functions while other account can only use part of them.

Tips 2: One account can bind more than one watch, and it's the same binding way.

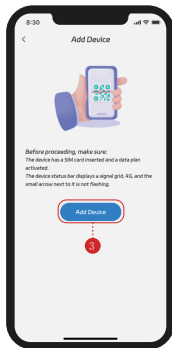

Tips 3: If the binding code at the backside of the watch is missing, you can also find it from inside the watch: Main menu—User guide—Binding code.

3.Part of functions of the

3.1 Video Call: (a) how to make video call from the watch? Search "Video Call" from the main menu and click, select the right contact and make the call. (b) video call is power-consumptive, so it's limited to 3 minutes each time, after 3 minutes it will be hung up and you can only use it again after around 3-5 minutes.

3.2 Voice Chat: watch can receive voice and emoji, while watch can only send voice, no text.

3.3 Wallpaper(home page) change: press and hold home page(time display page), swipe left or right to browse all wallpapers and tap to select the one you want.

3.4 Camera: select "Camera" from main menu, tap icon at bottom side to take pictures and tap the icon at top right corner to enter "Album" quickly.

3.5 Album: select "Album" from main menu, you can see all photos taken, tap one of them to zoom in, tap sub menu at top right corner for more operations.

3.6 User guide: inside there are two QR codes: the first is to download APP, the second is to bind watch.

3.7 Settings: you can change homepage, language, time zone, etc. here.

4.Part of functions of the

4.1 Introduction of the Location Page:



- 1 Position correction (if you think the current position is not accurate enough)
- 2 Tap to navigate to where the current watch is
- 3 Tap to display multiple watches you bound
- 4 Last location of the other watches(if you have more than 1)
- 5 Click to see where your mobile phone is
- 6 Tap to get latest location of current watch you are supervising
- 7 Battery level of the watch
- 8 Exact address of current watch
- 9 Swipe to switch the watch you bound(if you have more than 1)

4.2 SOS

You can set up 3 SOS numbers for kid to call when he/she is in danger, watch will call these 3 numbers orderly 3 rounds until someone pick up, watch will hang up after 3 rounds if no one picks up.

4.3 Class Mode

If you enable "Class Mode" function and set up class time, then during this period of time the watch can do nothing except SOS, so that no one can disturb the kid.

4.4 Remote call

This function is for parents(guardians) to track kids closely when they are in danger, please use it carefully and be aware of invasion of privacy. In order to comply with local laws some watches don't have this function, please consult with your seller if you have any questions.

4.5 Safe Zones

Set a safe zone for kids so you will get alert when they come in or out of the Zone, you can decide the center point and the area, and you can add more than one safe zone if need.

4.6 History Track

Click" History Track", select the date, then you can see where the kid was the whole day or during the past hours.

4.7 Set Tracking

Enable "Set Tracking" function, set "tracking duration", and "tracking time", watch will send location info to APP automatically, which will form above-mentioned "History Track", please bear in mind that tracking function is power-consumptive thus try to avoid using it frequently.

4.8 Call Limit

Enable this function the watch will refuse all stranger calls, only those who are in watch's contact list can call watch normally.

4.9 How to unbind(Reset) the watch

Open Leefine APP > Settings > APP Settings > Device information > Ubind(reset)

4.10 How to change the info of APP user

Leefine APP > Settings > APP Settings > My Information, change and save.

4.11 How to revise the info of the watch

Leefine APP > Settings > APP Settings > Watch User Info,change and save.

5. Specifications

Band Frequencies Supported:

4G watch has 3 versions: US Version, European Version, Asia-Pacific Version. Please consult with your seller for detailed Bands/Frequencies info.

Location Way: GPS(Optional)+WIFI+LBS

SIM Card Type: NANO Sim card

Screen: HD IPS display panel

Battery Type: Polymer lithium-ion battery

6. Frequently Asked Questions

Q: Why video call function is not available?

Video call function is very power-consuming, you can only use it 3 minutes after the first use, then you must wait 5 minutes before using again.

Q: Why can I only see/use part of all functions?

There are two different APP users: One is administrator, the other is follower, Administrator can use all functions while followers can only use part of, that's for the safety of watch users.

Q: Is the watch water-proof

The watch is splash-resistant. You can wear it when washing hands or in rainy days but please remove before swimming or showering.

Q: Why my "History" track is incomplete?

- (1) When you were indoors without Wi-Fi or some extremely remote places, watch can't get location report, and the position track would be a straight line.
- (2) Check your Location Set (Open App-Settings-Location set). There is no location report from the watch when out of the Location Time you set (Meanwhile, manual positioning is available).

(3) Location Mode also decides the History track, but be careful, if the user chooses a more frequent time (Every 10 minutes for instance), it will make the watch consume more power and have less standby time.

Q: Why my location is inaccurate?

Accuracy of location depends on Location ways. When in open area with GPS mode, the accuracy can be within 30 meters, with Wi-Fi mode (inside the building or in urban area) the accuracy can be 50-150 meters, while LBS (When GPS and Wi-Fi are all not available) accuracy can be within a few kilometers.

For more questions, please go to visit the website at: <https://www.leefine.net/>



7.Warning and Caution

Product Usage Precautions:

1. Use only batteries approved by the manufacturer. Using the wrong battery type may cause explosion, fire, or other hazards.
2. Do not expose the product to high-temperature environments such as direct sunlight, open flames, or microwave ovens to prevent explosion, leakage, or fire.
3. Do not disassemble, impact, crush, or insert sharp objects into any openings, the speaker, SIM card slot, or the interior of the product. This may damage the battery and cause explosion or fire. If the product becomes abnormally hot, deformed, swollen, or if the battery leaks flammable liquid/gas, discontinue use immediately and seek professional repair.

4. Do not place the product in extremely low-pressure environments, as this may cause battery explosion or leakage of flammable substances.

5. Use only the charging cable provided with the product. When using a power adapter, ensure it is a certified standard adapter with a DC output of ~~5V~~ 1A.

6. Charge the device in a dry, well-ventilated environment at 5°C to 35°C. Temperatures outside this range can affect battery performance, prolong charging time, or cause accidents. Ensure the watch and charging contacts are dry and clean before charging. Clean dirty charging contacts on the watch back with a soft, dry cloth. Do not scrape with hard metal objects.

7. During charging, as the battery temperature rises, do not place the device on bedding, clothing, or other insulating materials to prevent heat buildup, abnormal temperature rise, and fire risk.

8. Avoid using or storing the product in high-temperature, humid, high-static, or strong magnetic field environments.

9. This product is not a toy. To reduce the risk of electric shock, children under 14 should charge and use the device under adult supervision.

10. The device may feel warm to the touch when using power-intensive applications or using apps for extended periods. This is normal.

11. A dirty screen, user-applied screen protector/case, unclean hands (e.g., with sweat), or a scratched/damaged screen may cause slow or unresponsive touch screen performance.

12. Any radio transmission device (including this product) may interfere with improperly protected medical equipment. Maintain a safe distance between this product and medical devices (e.g., pacemakers, hearing aids, cochlear implants). Consult the device manufacturer and your doctor regarding adequate RF shielding. If you suspect interference, turn off the product immediately. Follow all regulations prohibiting the use of wireless devices in specific locations.

13. Do not use this product in environments such as gas stations, fuel depots, chemical plants, or fuel/chemical storage/transport facilities, as this may cause explosion or fire. Turn off the product before airplane takeoff. Do not use it during flight.

Caution for Sensitive Skin User

1. Individuals with sensitive skin may experience discomfort when wearing the device. Please exercise caution.
2. If discomfort occurs, it may be due to wearing the strap too tightly or for too long. Adjust the strap fit.
3. If redness, swelling, itching, or other irritation appears on the skin around or under the device, stop wearing it immediately and consult a doctor.
4. If symptoms reappear after resuming use, or if discomfort increases, try switching wrists.
5. To replace the strap, visit an authorized service center. Straps from unofficial channels may cause skin allergies.
6. The company is not liable for discomfort caused by individual physical conditions.

Warning :

1.This product, all packaging materials (tape, stickers, packing bags, SIM tray removal, tags, cable ties, etc.), and small parts are not suitable for children under 3 years old, to prevent choking hazards or other dangers from swallowing small components.

2.In avoid of hearing damage or loss, please do not over time use device at high dB levels.

3.In avoid of visual damage or loss, please adjust the brightness of screen to a suitable range.

4.The device has a built-in speaker. Do not put magnetic objects or magnetic-avoiding objects close to the device to avoid damage.

5.If the device is part or whole broken, do not touch or remove the broken part, stop using it immediately and contact your seller.

6.It is not allowed to poke any body part of the device

7.Do not use device fiercely(strike, scratch or drop the device)

8.Do not use the device during thunderstorm or lightning outdoor.

9.It is not allowed to use the device during charging.

10.Consumer must choose and use a power adapter which obtains the legal standard certificates and meets the parameters:5V= 1A

THIS DOCUMENT IS FOR INFORMATION PURPOSE ONLY,
AND DOES NOT CONSTITUTE ANY KIND OF WARRANTIES.

FCC Statement

This equipment has been tested and found to comply with the limits for a Class B digital device, pursuant to part 15 of the FCC Rules. These limits are designed to provide reasonable protection against harmful interference in a residential installation. This equipment generates, uses and can radiate radio frequency energy and, if not installed and used in accordance with the instructions, may cause harmful interference to radio communications. However, there is no guarantee that interference will not occur in a particular installation. If this equipment does cause harmful interference to radio or television reception, which can be determined by turning the equipment off and on, the user is encouraged to try to correct the interference by one or more of the following measures:

- Reorient or relocate the receiving antenna.
- Increase the separation between the equipment and receiver.
- Connect the equipment into an outlet on a circuit different from that to which the receiver is connected.
- Consult the dealer or an experienced radio/TV technician for help.

Caution: Any changes or modifications to this device not explicitly approved by manufacturer could void your authority to operate this equipment.

This device complies with part 15 of the FCC Rules. Operation is subject to the following two conditions: (1) This device may not cause harmful interference, and (2) this device must accept any interference received, including interference that may cause undesired operation.

Specific Absorption Rate (SAR) information:

This device meets the government's requirements for exposure to radio waves. The guidelines are based on standards that were developed by independent scientific organizations through periodic and thorough evaluation of scientific studies. The standards include a substantial safety margin designed to assure the safety of all persons regardless of age or health. FCC RF Exposure Information and Statement the SAR limit of USA (FCC) is 1.6 W/kg averaged over one gram of tissue. Device types: 4G kids smart watch has also been tested against this SAR limit. This device was tested for typical body-worn operations with the back of the device kept 0mm from the body. To maintain compliance with FCC RF exposure requirements, use accessories that maintain a 0mm separation distance between the user's body and the back of the device. The use of belt clips, holsters and similar accessories should not contain metallic components in its assembly. The use of accessories that do not satisfy these requirements may not comply with FCC RF exposure requirements, and should be avoided.