

3A81WG0S10GB0

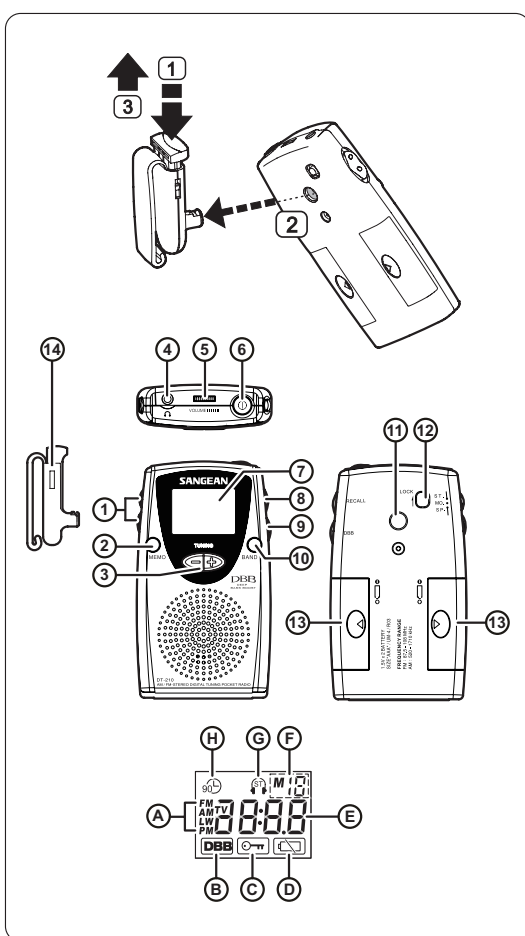

## 01

### GB

### Operating instruction

#### Controls

- ① Stereo / Mono / Speaker switch
- ② Memory button
- ③ Tuning Up / Down
- ④ Earphones Jack
- ⑤ Volume Control
- ⑥ Power switch
- ⑦ Display
- ⑧ Memory Recall
- ⑨ DBB (Deep Bass Boost) selection
- ⑩ Band selector
- ⑪ Belt Clip holder
- ⑫ Lock switch
- ⑬ Battery compartment
- ⑭ Belt Clip

#### Display

- (A) Waveband indicator
- (B) DBB on
- (C) Key lock indicator
- (D) Low battery indicator
- (E) Frequency display
- (F) Memory preset
- (G) Stereo indicator
- (H) 90 minutes auto shut off indicator

## 02

### Installing batteries

1. Position the radio face down.
2. Press the catch and slide in the direction of the mark.
3. Lift up the battery cover and insert 1xUM-4 (AAA) size on each side of battery compartment. Make sure the batteries are positioned in accordance with the diagram indicated.
4. Replace the battery cover.

#### Battery replacement

The battery indicator  will appear and flash in the display when the batteries are in need of replacement. After removing the batteries, you have approximately 3 minutes to replace the batteries after which the preset memory information will be lost.

#### Operating the radio

#### Search tuning

1. Switch on the radio by pressing the Power button.

#### Note:

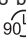
The radio is originally set to be 90 minutes auto shut off after Power is switched on (  symbol will appear on the display).

If you don't need this feature, press Power button for more than 2 seconds until symbol removed from the display.

2. Select the required waveband by repeatedly pressing the Band button. On FM and TV band (DT-210V only), connect the supplied earphones as the antenna or the wire antenna. On AM (MW) and LW band (DT-210L), rotate the radio for best reception.
3. Press and hold down either the Tuning Up or Down buttons until frequency in the display begins to change rapidly. Release the button.
4. The radio will scan the selected waveband, stopping each time if finds a station of sufficient strength. Adjust the volume control to the required level.

## 03

### Manual tuning

- Switch on the radio by pressing the Power button.
- Select the required waveband and connect the supplied earphones or wire antenna for FM and TV band (DT-210V) listening.  
On AM (MW) or LW band (DT-210L), rotate the radio for best reception.
- A single press on either the Tuning Up / Down will change the frequency up or down. Adjust the volume control to the required level.

### Presetting stations

You may store up to 15 stations on FM band and 10 stations on AM (MW) band for DT-210 (10 stations each on AM / FM / TV band for DT-210V and 10 stations each on AM (MW) / FM / LW band for DT-210L).

- Tune into the required stations using one of the tuning methods previously described.
- To store the station, press MEMO button, display will flash M and the suggested memory location. Press MEMO button again to finalize the station presetting.

During the M and suggested memory location are flashing, you may use either Tuning Up or Down to change the memory location to edit your memory program then press MEMO button again to finalize the presetting.

### Recalling a preset station

- Switch on the radio.
- Press RECALL button and Tuning Up / Down to recall required preset station Display will flash preset station.
- Press RECALL button again, once the required preset station is found.

### Lock Switch

The lock switch located on the rear cabinet is used to prevent unintentional operation.

## 05

### DBB (Deep Bass Boost) button

Press DBB button to activate the Deep Bass Boost to have stronger bass sound, display will appear DBB symbol. Another press will cancel the DBB.



#### Note:

Suggest to activate the DBB only using earphones.

### Specifications

<b>Power Supply</b>	2 x AAA (UM-4) (R03) batteries
<b>Output Power</b>	100mW (10% T.H.D. 1 kHz)
<b>Earphones socket</b>	3.5mm dia stereo 32ohm
<b>Frequency range</b>	
FM	87.50-108 MHz
AM (MW)	522-1629 kHz (DT-210/L)
	520-1710 kHz (DT-210V)
LW	153-279 kHz (DT-210L)
TV	2-13 CH (DT-210V)
<b>Battery Life</b>	Approx. 24hours (via speaker) using Alkaline battery
	Approx. 32hours (via earphones) using Alkaline battery

## 04

Slide the lock switch to the up locked position, the  symbol will appear in the display. The power and all other buttons will be disabled. This will prevent accidental operation when the radio is packed in a suitcase. To release the lock switch, move the switch to the down unlocked position, the  symbol will be removed from the display.

### Earphones and antenna

The earphones also acts as the FM antenna when plugged into the earphones jack. While listening via speaker, you may plug the supplied wire antenna into the earphones jack, and set the ST / MO / SP switch to the SP (speaker) position.

### ST / MO / SP (Stereo / Mono / Speaker)

- Switch the switch to SP (speaker) position, while you listen to the radio program via speaker. Make sure to plug the supplied wire antenna or the earphones to get best FM reception.
- This radio is capable of receiving FM stereo radio program by plug the supplied earphones into the earphones jack and set the ST / MO / SP switch to ST (stereo) position, display will show stereo symbol.

If the station being received is weak, some hiss may be audible, to reduce the hiss, switch the ST / MO / SP to MO(mono) position. The stereo indicator will be removed from the display.

### Change AM (MW) band tuning step (available only on DT-210 / V not for LW version)

In Europe and other parts of the world, AM (MW) tuning step are 9kHz, in America the AM tuning step is 10kHz.

To change the AM tuning step from 10kHz to 9kHz, proceed as follows, Press TuningDown button then the power button to switch on the radio, the radio will be changed into 9kHz tuning step on AM band.

To change the AM tuning step from 9kHz to 10kHz, proceed as follows, Press Tuning UP button then Power button to switch on the radio, the radio will be changed into 10 kHz tuning step on AM band.

## 06

### ※ The barcode label on the product is defined as below:

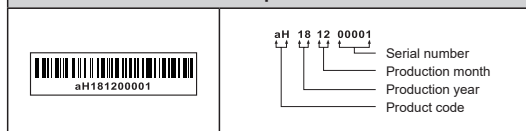

Sangean reserves the right to amend the specifications without notice.

 RECYCLING This product bears the selective sorting symbol for Waste electrical and electronic equipment (WEEE). This means that this product must be handled pursuant to European directive 2012/19/EU in order to be recycled or dismantled to minimize its impact on the environment.