

USE AND CARE GUIDE

FLUSH MOUNT CEILING LIGHT WITH MOTION SENSOR

PACKAGE CONTENTS

Part	Description	Quantity
A	Fixture body	1
B	Diffuser Shade	1

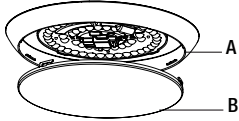

HARDWARE INCLUDED

Part	Description	Quantity
AA	Mounting Screw	2
BB	Wire Connector	2
CC	Trim Ring	1



NOTE: Keep your receipt and these instructions for proof of purchase.

WARNING: RISK OF ELECTRIC SHOCK. Ensure the electricity to the wires you are working on is shut off. Either remove the fuse or turn off the circuit breaker before removing an existing light fixture or installing the new one.

If you are unfamiliar with electrical installations, we recommend you contact a qualified electrician to do the installation.

INSTALLATION

Select a suitable location that can support the weight of the fixture. Determine the method for mounting the fixture before drilling, based on the type of ceiling.

- Turn counterclockwise to open the diffuser shade (B) to expose the mounting holes. Customize the color temperature and motion sensor's detection range of the light.
 - Choose your favorite correlated color temperature (CCT) from five options: 2700K, 3000K, 3500K, 4000K, 5000K. The factory setting is 3000K.
 - Motion detection is factory-set to OFF by default. Four sensing modes (5FT, 10FT, 15FT, and OFF) can be adjusted. Once the sensor detects motion, the light will remain on and will automatically turn off if no motion is detected after 5 minutes.

STEP 1.

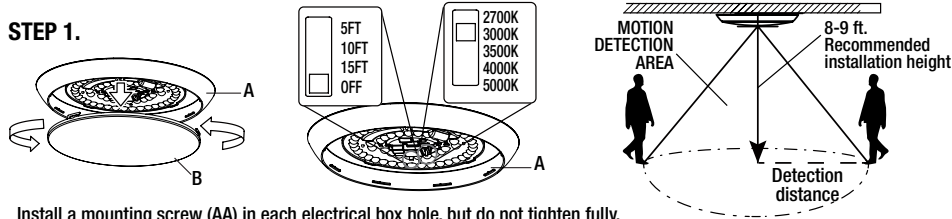

- Install a mounting screw (AA) in each electrical box hole, but do not tighten fully.
- Connect the hot and neutral (black and white) wires from the electrical box to the same color wires from the fixture body (A). Cover the wire connections using the wire connectors (BB). Make sure to fasten them well. Cover the wire connectors (BB) with electrical tape for a more secure connection.
- Position the wires back inside the electrical box. Make the mounting screw (AA) head cross the large ends of the keyholes on the fixture body (A), slide the base towards the narrow hole, and fasten these screws well.
- Reinstall the diffuser shade (B) on the fixture body (A). Restore power at the electrical panel. Turn on the light switch to activate the fixture.

STEP 2.

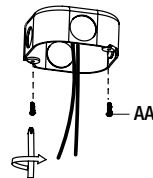

STEP 3.

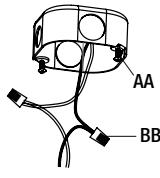

STEP 4.

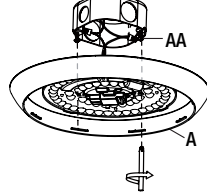

STEP 5.

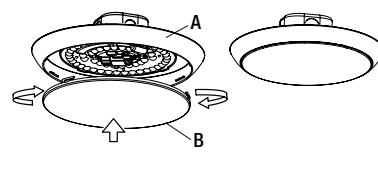

CHANGING COLOR TRIM RING

- Return to INSTALLATION Step 3 (with the fixture body (A) without diffuser shade (B) and not fixed to the electrical box, leaving enough space around the outer edge of the fixture body (A) for installing the trim ring (CC)).
- Carefully align the trim ring (CC) with the fixture body (A), fasten the trim ring (CC) onto the fixture body (A) until its outer edge fully wraps around it.
- Continue to complete the fixture installation following Steps 4 and 5.

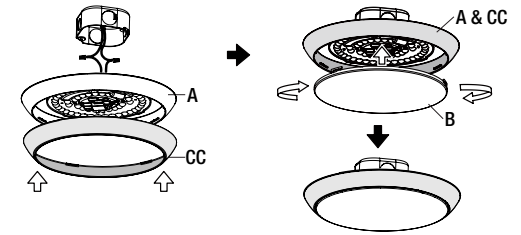

CARE AND CLEANING

CAUTION: Before attempting to clean the tube and luminaire/light fixture, disconnect the power to the fixture by turning the breaker off or removing the fuse from the fuse box. Clean with a soft, dry cloth. Do not use cleaners with chemicals, solvents, or harsh abrasives. Do not use liquid cleaner on the LEDs, LED driver, or wiring.

TROUBLESHOOTING

Minor problems often can be fixed without the help of an electrician.

WARNING: Before doing any work on the fixture, disconnect power to the light fixture.

Problem	Possible Cause	Solution
The fixture will not light.	The power is off.	Ensure the power supply is on.
	The circuit breaker is off.	Ensure the circuit breaker is in the on position.
	There is a bad connection.	Check to ensure proper wire connections are made. Contact a qualified electrician.
The fuse blows or the circuit breaker trips when the light is turned on.	There is a defective switch.	Contact a qualified electrician.
	The wires are crossed or the power wire is grounding out.	Check the wire connections. Contact a qualified electrician or call customer service 1-877-527-0313.

WARNING: Carefully read and understand the information given in this manual before beginning the assembly and installation. Failure to do so could lead to electric shock, fire, or other injuries which could be hazardous or even fatal. • Ensure the electricity to the wires you are working on is shut off. Either remove the fuse or turn off the circuit breaker.

NOTICE: Any changes or modifications not expressly approved by the party responsible for compliance could void the user's authority to operate the equipment.

This equipment has been tested and found to comply with the limits for a Class B digital device, pursuant to Part 15 of the FCC Rules. These limits are designed to provide reasonable protection against harmful interference in a residential installation. This equipment generates uses and can radiate radio frequency energy and, if not installed and used in accordance with the instructions, may cause harmful interference to radio communications. However, there is no guarantee that interference will not occur in a particular installation. If this equipment does cause harmful interference to radio or television reception, which can be determined by turning the equipment off and on, the user is encouraged to try to correct the interference by one or more of the following measures: • Reorient or relocate the receiving antenna. • increase the separation between the equipment and receiver. • Connect the equipment into an outlet on a circuit different from that to which thereceiver is connected. • Consult the dealer or an experienced radio/TV technician for help.

NOTICE: FCC Radiation Exposure Statement This equipment complies with FCC radiation exposure limits set forth for an uncontrolled environment. This transmitter must not be co-located or operating in conjunction with any other antenna or transmitter. This equipment should be installed and operated with minimum distance 20cm between the radiator & you body.

This device complies with part 15 of the FCC Rules. Operation is subject to the following two conditions: (1) This device may not cause harmful interference, and (2) this device must accept any interference received, including interference that may cause undesired operation.

WARRANTY

WHAT IS COVERED

The manufacturer warrants this lighting fixture to be free from defects in materials and workmanship for a period of five (5) years from date of purchase. This warranty applies only to the original consumer purchaser and only to products used in normal use and service. If this product is found to be defective, the manufacturer's only obligation, and your exclusive remedy, is the repair or replacement of the product at the manufacturer's discretion, provided that the product has not been damaged through misuse, abuse, accident, modifications, alterations, neglect, or mishandling.

WHAT IS NOT COVERED

This warranty shall not apply to any product that is found to have been improperly installed, set-up, or used in anyway not in accordance with the instructions supplied with the product. This warranty shall not apply to a failure of the product as a result of an accident, misuse, abuse, negligence, alteration, faulty installation, or any other failure not relating to faulty material or workmanship. This warranty shall not apply to the finish on any portion of the product, such as surface and/or weathering, as this is considered normal wear and tear.

The manufacturer does not warrant and specifically disclaims any warranty, whether express or implied, of fitness for a particular purpose, other than the warranty contained herein. The manufacturer specifically disclaims any liability and shall not be liable for any consequential or incidental loss or damage, including but not limited to any labor / expense costs involved in the replacement or repair of said product.

Contact the Customer Service Team at 1-877-527-0313 or visit www.HomeDepot.com.

Questions, problems, missing parts? Before returning to the store, call Commercial Electric Customer Service
 8 a.m. - 7 p.m., EST, Monday - Friday
 9 a.m. - 6 p.m., EST, Saturday
 1-877-527-0313 | HOMEDEPOT.COM