



BLAST™ PORTABLE BLENDER BC100ANZ Series | Owner's Guide

IMPORTANT SAFETY INSTRUCTIONS

PLEASE READ ALL INSTRUCTIONS BEFORE USE • FOR HOUSEHOLD USE ONLY

	Read and review instructions for operation and use.
	Indicates the presence of a hazard that can cause personal injury, death or substantial property damage if the warning included with this symbol is ignored.
	For household use only.
	Indicates location to attach USB-C cord for charging unit.
When using electrical appliances, basic safety precautions should always be followed, including the following:	

⚠ WARNING: To reduce the risk of injury, fire, electrical shock or property damage, basic safety precautions must always be followed, including the following numbered warnings and subsequent instructions. Do not use appliance for other than intended use.

- 1 Read all instructions prior to using the appliance and its accessories.
- 2 Use only a power supply with an extra low voltage corresponding to the marking on the bottom of the motor base.
- 3 **ALWAYS** exercise care when handling the BlastBlade™ Assembly. The blades are sharp, handle carefully. **ONLY** grasp the BlastBlade™ Assembly by the motor base. Failure to use care when handling the BlastBlade™ Assembly will result in a risk of laceration.
- 4 Take your time and exercise care during unpacking and appliance setup. This appliance contains sharp, loose blades that can cause injury if mishandled.
- 5 Take inventory of all contents to ensure you have all parts needed to properly and safely operate your appliance.
- 6 Before use, wash all parts that may contact food. Follow washing instructions covered in this Owner's Guide.
- 7 **DO NOT** blend hot liquids, effervescent, or carbonated liquids, as doing so may cause pressure buildup, resulting in risk of burns or other injuries to the user.
- 8 **DO NOT** fill the blending vessel past the **MAX FILL** line.
- 9 Blades are sharp. Handle carefully.
- 10 Keep hands, hair, and clothing out of the vessel when loading and operating. **DO NOT put your hands inside the vessel or anywhere near the BlastBlade™ Assembly. Blades can still activate when the sip lid is removed.**
- 11 Remove utensils prior to processing. Failure to remove may cause the blending vessel to be damaged or to shatter, which may cause personal injury.
- 12 To protect against the risk of fire from battery damage, **DO NOT** submerge the motor base in any form of liquid.
- 13 **DO NOT** store outdoors or allow the product to be submerged in liquid.
- 14 **DO NOT** allow children to operate this appliance or use as a toy. Close supervision is necessary when any appliance is used near children.
- 15 This appliance is **NOT** intended to be used by people with reduced physical, sensory, or mental capabilities, or lack of experience and knowledge, unless they have been given supervision or instruction concerning use of the appliance by a person responsible for their safety.
- 16 Before each use, inspect BlastBlade™ Assembly for damage. If a blade is bent or damage is suspected, contact SharkNinja to arrange for replacement.
- 17 **DO NOT** attempt to sharpen blades.
- 18 **DO NOT** allow any part of the unit to contact hot surfaces, including stoves and other heating appliances.
- 19 **ALWAYS** use the appliance on a dry and level surface.

IMPORTANT SAFETY INSTRUCTIONS

PLEASE READ ALL INSTRUCTIONS BEFORE USE • FOR HOUSEHOLD USE ONLY

- 20 Keep hands, hair, and clothing out of the vessel when loading and operating.
- 21 **ONLY** use attachments and accessories that are provided with the product or are recommended by SharkNinja. The use of attachments not recommended or sold by SharkNinja may cause fire, electric shock, or injury.
- 22 During operation and handling of the appliance, avoid contact with moving parts.
- 23 **DO NOT** operate the appliance with an empty container.
- 24 **DO NOT** microwave any containers or accessories provided with the appliance.
- 25 **DO NOT** perform grinding operations.
- 26 Before operation, ensure all utensils are removed from containers. Failure to remove utensils can cause the vessel to shatter and potentially result in personal injury and property damage.
- 27 **DO NOT** attempt to defeat the interlock mechanism. Ensure the vessel and sip lid are properly installed before operation.
- 28 **DO NOT** expose the containers and accessories to extreme temperature changes. They may experience damage.
- 29 **NEVER** leave the appliance unattended while in use.
- 30 If you find unmixed ingredients sticking to the sides of the cup, turn off the appliance using the Power Button, and use a scraper to dislodge ingredients.
- 31 **DO NOT** attempt to remove the vessel and/or sip lid from the motor base while the BlastBlade™ Assembly is still spinning. Allow the appliance to come to a complete stop before removing lid and/or vessel.
- 32 **DO NOT** store ingredients for extended amounts of time before or after blending them. Some foods may contain active ingredients or release gases that will expand if left in a sealed container, resulting in excessive pressure buildup that can pose a risk of injury.
- 33 If the appliance overheats, a thermal switch will activate and temporarily disable the motor. To reset, turn **OFF** the Ninja Blast™ Portable Blender using the Power Button and allow it to cool for approximately 15 minutes before using again.
- 34 **DO NOT** process dry ingredients without adding liquid to the blending vessel. Unit is not intended for dry blending.
- 35 Operate **ONLY** with the sip lid on.
- 36 **DO NOT** refrigerate or freeze blender.
- 37 Switch off the appliance and disconnect from supply before changing accessories or approaching parts that move in use.
- 38 **DO NOT** misuse the appliance to avoid potential injury.

BATTERY USE

- 1 The battery is the power source for the Ninja Blast™ Portable Blender. Carefully read and follow all charging instructions.
- 2 **DO NOT** incinerate this appliance even if it is severely damaged. The lithium-ion batteries can explode in a fire. Always properly recycle products powered by lithium-ion batteries.
- 3 Since there is no power cord, prevent accidental blade activation by ensuring the blender is turned **OFF** when not in use, while cleaning, or when drinking from the sip lid.
- 4 Keep the battery away from all metal objects such as paper clips, coins, keys, nails, or screws. Shorting the battery terminals together increases the risk of fire or burns.
- 5 Under abusive conditions, liquid may be ejected from the battery. Avoid contact with this liquid, as it may cause irritation or burns. If contact occurs, flush with water. If liquid contacts eyes, seek medical help.
- 6 This unit contains batteries that are only replaceable by skilled persons.
- 7 This unit contains batteries that are non-replaceable and moving parts that potentially present risk to the user.

SAVE THESE INSTRUCTIONS

AUS +61 2 8801 7666 | NZ +64 800 112 660

PARTS

- A Sip Lid
- B Carry Handle
- C Blending Vessel
- D Vessel Cap*
- E Blade Cover*
- F Motor Base with BlastBlade™ Assembly
- G USB-C Charging Cord
- H Charging Port

*Accessories and unit color may vary by model.

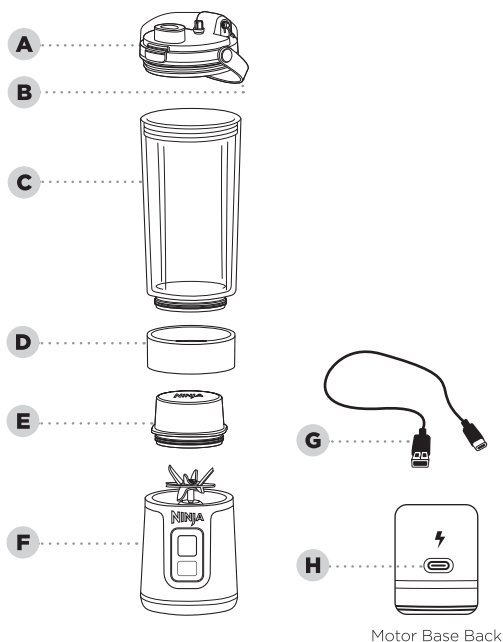

CHARGING ⚡

Charge the unit using the provided charging cord and a 5V 3A power supply until the LEDs illuminate solid green. Charging port is located at the back of the motor base.

BEFORE FIRST USE

IMPORTANT: Review all warnings at the beginning of this Owner's Guide before proceeding.

NOTES:

- Handle the BlastBlade™ Assembly by grasping around the motor base.
- All attachments are BPA free. All attachments **EXCEPT** the motor base are top-rack dishwasher safe. **DO NOT** use a heated dry cycle. Ensure lid and vessel are removed from motor base before placing in the dishwasher. Exercise care when handling BlastBlade™ Assembly.

Remove all packaging materials from the unit. Exercise care when unpacking BlastBlade™ Assembly, as the blades are sharp.

Wash vessel, lid, and BlastBlade™ Assembly in warm, soapy water using a dishwashing utensil with a handle to avoid direct contact with the blades. **DO NOT** submerge the motor base in water when cleaning. Exercise care when handling BlastBlade™ Assembly, as the blades are sharp.

Thoroughly rinse and air-dry all appropriate parts.

USING THE CONTROL PANEL



PROGRAMS:

START/STOP BUTTON

Press Start/Stop button once to activate the 30-second blend cycle.

POWER BUTTON

Press Power button to turn unit **ON** and **OFF**.

TROUBLESHOOTING	LED Shows	Solutions
Vessel and Base are Not Aligned	Flashing WHITE	Ensure vessel and motor base are aligned using the arrows on the back of motor base and vessel.
Blades are Blocked	Flashing ORANGE	Move lodged ingredients from blade and restart blend program.
Needs Charge	Solid RED	Charge unit.
Abnormal charger	Flashing RED and BLUE	Defective charger, unplug and find correct 5V 3A charger.
Unit Cool Down Time Out	Clockwise-moving ORANGE LEDs	Let unit sit at room temp for 15 minutes before using again.
While Charging	Flashing WHITE and RED	Call Customer Service at AUS +61 2 8801 7666 NZ +64 800 112 660.
While Blending	Flashing RED in the bottom left and top right	Call Customer Service at AUS +61 2 8801 7666 NZ +64 800 112 660.

USING THE BLENDING VESSEL

IMPORTANT: Review all warnings at the beginning of this Owner's Guide before proceeding.

- 1 Ensure the motor base is fully charged and the vessel is properly installed by aligning vessel arrow with motor base arrow located on the back of the motor base.

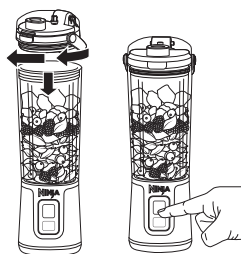
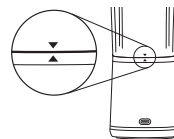

- 2 Turn unit **ON** by pressing the  button until Start/Stop button lights illuminate.
- 3 Add ingredients, starting with liquids to the **MIN LIQUID** line then solid ingredients. If using ice, always add last. **DO NOT** fill ingredients past the **MAX FILL** line. Secure lid onto the vessel, twisting clockwise to tighten.
- 4 Blend for a 30-second blend cycle by pressing the Start/Stop button.

-
- 5 Open the sip lid to sip, or remove the lid to pour out blender outputs into another container. **DO NOT** remove vessel from motor base when filled. Empty vessel prior to removing from motor base.
 - 6 After blending, power **OFF** the unit by pressing the  button. Motor base should be turned **OFF** when drinking from the sip lid and when blender is no longer in use.
 - 7 Refer to the Care & Maintenance section for cleaning and storage instructions.

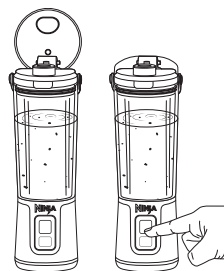

CARE & MAINTENANCE

CLEANING

Blades can still operate when the lid is removed. Always turn the unit OFF when cleaning without the lid on or when the BlastBlade™ Assembly is exposed.

Hand-Washing

Wash vessel, lid, and BlastBlade™ Assembly with warm, soapy water. Use a dishwashing utensil or cloth to clean the BlastBlade™ Assembly on the motor base. Exercise care when handling the BlastBlade™ Assembly on the motor base as the blades are sharp. Wipe the motor base with a clean, damp cloth. **DO NOT** submerge the motor base in water. Thoroughly rinse and air-dry all appropriate parts.

Motor Base

The USB-C port is water resistant, which means the motor base can get rinsed in the sink; **HOWEVER DO NOT** put the motor base in the dishwasher or submerge it in water. Ensure the USB-C charger is not inserted before cleaning. After cleaning, let the USB-C charging port air-dry for 30 minutes before charging the unit.

DEEPER CLEAN

Dishwasher

Vessel and sip lid are top-rack dishwasher safe. **DO NOT** use a heated dry cycle. Ensure the vessel and sip lid are removed from the motor base before being placed in the dishwasher.

STORING

Store the unit upright and with the lid, vessel, and motor base fully assembled.

DO NOT store blended or unblended ingredients in the vessel with the BlastBlade™ Assembly for prolonged periods of time.

DO NOT stack items on top of the vessel. Store any remaining attachments alongside the unit or in a cabinet where they will not be damaged or create a hazard.

ORDERING REPLACEMENT PARTS

To order additional parts and attachments, visit ninjakitchen.com.au | ninjakitchen.co.nz.

TROUBLESHOOTING GUIDE

⚠WARNING: To reduce the risk of shock and unintended operation, turn OFF unit before troubleshooting.

Ensure the unit is not charging when troubleshooting. Ensure the unit is fully charged and vessel is properly aligned.

Control panel doesn't turn off.

- Press the  button to turn the unit **ON** and **OFF**.

Doesn't mix well; ingredients get stuck.

- When filling the vessel, start with liquid to the **MIN LIQUID** line, then fresh fruit or veggies, followed by leafy greens or herbs. Add your seeds, powders, or nut butters. Finish with ice or frozen ingredients.
- If ingredients are routinely getting stuck, adding some liquid will usually help. Ensure you have filled the vessel to or above the **MIN LIQUID** line. You can also shake the blender while blending or turn the blender upside down, start a blend cycle, and turn it right side up to move ingredients while blending.

Sip lid is hard to assemble on the vessel.

- Set the assembled motor base and vessel on a level surface. Place the sip lid on the top of the vessel and align the threads so the sip lid sits flat. Turn clockwise until you have a tight seal.

Vessel is hard to assemble on the motor base.

- Set the motor base on a level surface. Place the vessel on the top of the motor base and align the threads so the vessel sits flat. Turn clockwise until you have a tight seal. The LEDs on the display will be solid purple when the vessel is properly installed.

Mann&Noble

ONE (1) YEAR LIMITED WARRANTY

For warranty claims, you will need to submit a proof of purchase in the form of a valid receipt that displays date and place of purchase. This warranty does not replace but is in addition to your statutory rights.

If your product becomes defective due to faulty material or workmanship within a period of one (1) year from the date of purchase, we warrant to do the following:

- **For New Zealand Consumers:** We will replace the defective/faulty part with a new product, free of charge, or if the unit is deemed defective/faulty we replace the unit with an equivalent or upgraded model, at our discretion.
- **For Australian Consumers:** Our goods come with guarantees that cannot be excluded under the Australian Consumer Law. You are entitled to a replacement or refund for a major failure and for compensation for any other reasonably foreseeable loss or damage. You are also entitled to have the goods repaired or replaced if the goods fail to be of acceptable quality and the failure does not amount to a major failure.

Replacement items will be covered by the limited warranty for the balance of the warranty period from the date of the original purchase.

Your warranty is subject to the following conditions

- DO NOT operate the appliance with a damaged plug or cord, or if the unit has been dropped, damaged or dropped in water.
- To avoid the risk of electric shock, do not disassemble or attempt to repair the appliance on your own. If the supply cord is damaged, it must be replaced by a qualified electrician to avoid a hazard. Incorrect re-assembly or repair can cause a risk of electric shock or injury to persons when the appliance is used.
- The item has not been misused, abused, neglected, altered, modified or repaired by anyone.
- The item has been subjected to fair wear and tear.
- The item has not been used for trade, professional or hire purposes.
- The item has not sustained damage through foreign objects, substances or accident

Customer costs within warranty

The customer is responsible for any inwards freight charge to return a product for warranty if requested, and outward freight charge for warranty parts and or replacement unit.

Who is covered?

This warranty applies only to the original purchaser, who bought the product from an authorised retailer and may not be transferred. Proof of purchase is required.

What is not covered?

- Accessories supplied with the item.
- Components that are subject to natural wear and tear caused by normal use in accordance with operating instructions.
- Unauthorised/improper maintenance/handling or overload is excluded from this warranty.



REGISTER YOUR PURCHASE



AU ninjakitchen.com.au/apps/product-registration

NZ ninjakitchen.co.nz/apps/product-registration



Scan QR code using mobile device

RECORD THIS INFORMATION

Model Number: _____

Serial Number: _____

Date of Purchase: _____
(Keep receipt)

Store of Purchase: _____

TECHNICAL SPECIFICATIONS

Voltage: 5V⁼⁼, 0.5A-3A

Proudly distributed by
Mann & Noble Pty Ltd
Building D, 33 Quarry Road
Erskine Park NSW, Australia, 2759
AU 02 8801 7666 | NZ 0800 112 660
AU ninjakitchen.com.au | NZ ninjakitchen.co.nz

Illustrations may differ from actual product. We are constantly striving to improve our products; therefore the specifications contained herein are subject to change without notice.

BLASTBLADE and NINJA BLAST are trademarks of SharkNinja Operating LLC.

© 2023 SharkNinja Operating LLC

BC100ANZSeries_IB_MP_Mv7_231002

