

DOGTRA SMART NOBARK

NOBARK COLLAR

Owner's Manual

Please read this manual thoroughly
before operating the DOGTRA SMART NOBARK.

IMPORTANT SAFETY AND PRODUCT INFORMATION

WARNING

Please read all safety and product information below before using your Dogtra product. Failure to follow these safety instructions could result in injury to you, your dog and others, or it could result in damage to your

Dogtra product or other property. DOG SAFETY

Proper Use

Dogtra products should be used to train, educate, monitor, or track dogs. Each dog may have a different tolerance for and reaction to Dogtra products. Closely observe your dog when determining the right level of stimulation, collar fit, and other settings of your Dogtra product.

Training Methods

Dogtra products may be used with a variety of training methods that provide clear and consistent messages to your dog.

Fit and Wear

Proper fit and wear of your Dogtra product is important for the comfort of your dog as well as the functioning of your product. Dogtra collars should fit comfortably and not too tightly, so that the collar stays in place and does not move around your dog's neck. Do not leave a collar on your dog for an extended time. Although each dog is different, Dogtra recommends that its collars be used a maximum of 4 to 6 hours at any one time on your dog.

A collar that is used for overly long periods or that fits improperly may cause skin irritation or sores on your dog's neck. Regularly check the collar's contact area on your dog's skin. If your dog exhibits skin irritation or sores, stop using the Dogtra product and consult with a veterinarian.

UNAUTHORIZED USE

Dogtra products should be used only in a safe and responsible manner to train, educate, monitor, or track dogs. Dogtra products are not intended for use in any other manner; they are not intended for use with other animals or with humans; and they are not intended for use in unsafe situations or environments that could lead to death, injury, loss or damage.

BATTERY

Your Dogtra product contains batteries. Do not attempt to replace the battery yourself. Contact Dogtra or your Dogtra retailer to replace your battery. Dispose of batteries as provided by your local regulations. Do not disassemble, crush, heat, or otherwise alter the battery as it may cause fire, explosion, injury and/or property damage.

OWNER SAFETY

Handling and Repair

Dogtra products can be damaged or malfunction if dropped, especially on hard surfaces, or otherwise improperly handled. Do not use a damaged or malfunctioning product as it may cause injury or property damage. If your product is damaged or malfunctions, contact Dogtra to obtain service before using the product.

Electrical Product

Your Dogtra product contains electrical components and batteries. Do not use or keep your product near heat or flammable sources. Such use or storage may damage your product and/or cause fire, explosion, injury, or property damage.

Medical Device Interference

Dogtra products contain electrical and magnetic components that emit low level electromagnetic waves and radio frequencies. These electromagnetic waves or radio frequencies may interfere with pacemakers, defibrillators, or other medical devices. Consult your physician or medical device maker before using your medical device with a Dogtra product. If you think that your Dogtra product is interfering with your pacemaker, defibrillator, or other medical device, stop using the Dogtra product.

Aggressive Dogs

Do not use Dogtra products with aggressive dogs as such dogs may react adversely and cause injury to people or other dogs. Seek the assistance of a dog-training specialist or veterinarian when dealing with aggressive dogs.

Children

Dogtra products are not toys. Adult supervision and close attention are necessary when Dogtra products are used by or near children.

CONTENTS

PACKAGE CONTENTS	5
MAIN FEATURES.....	5
OVERVIEW	6
HOW TO USE SMART NOBARK(COLLAR)	
1. TURNING THE SMART NOBARK ON/OFF	7
2. MAIN DISPLAY	7
3. MODE CHANGE.....	8
4. INDICATOR LIGHT.....	10
GETTING STARTED(WITH APP)	
1. DOWNLOADING THE APP	11
2. COLLAR SETUP GUIDE.....	11
3. PAIRING THE COLLAR TO A PHONE	12
3-1 PAIRING ADDITIONAL COLLAR TO A PHONE..	13
4. KEY FEATURES OF SMART NOBARK APP	14
COLLAR FITTING	25
CHARGING BATTERY	26
MAINTENANCE	28
TROUBLESHOOTING GUIDE	29
FCC/IC WARNING STATEMENT.....	31
DOGTRA EXTENDED PRODUCT WARRANTY	33

PACKAGE CONTENTS



MAIN FEATURES



IPX9K
Waterproof
Certified



2-Hour Rapid
Charge Batteries



For Dogs as
Small as 10 lbs



Medium Output in
100 Intensity Levels



Removable Contact
Points



High Performance
Pager



Barkmeter
behavior report



Expandable
3-Dog system



USB C-type
Charging Cable



Customize Detection
Sensitivity

OVERVIEW



HOW TO USE SMART NOBARK

1. Turning the SMART NOBARK ON/OFF



Power on

Press and hold on/off button to turn on the collar. Dogtra logo will show up on the display.

Power off

Press and hold on/off button to turn off the collar. As the collar turns off remaining battery will show on the display.

2. Main Display



When the product is turned on, the Display views in the Setting screen. The main display shows three information: battery life, current NOBARK mode, and total count. This information can also be viewed in the app when synced with a smartphone.

Note: If no buttons are pressed for 15 seconds, the display turns off to save battery. If any button is pressed, the display turns on again.

3. Mode change

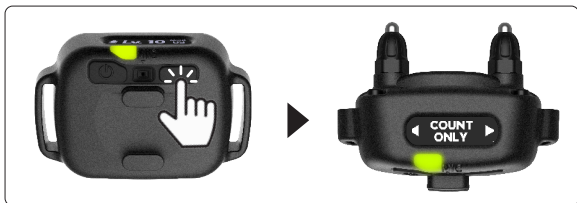

- 1) Press and hold the mode select button (right button) to enter the mode select.
- 2) Use the left and right buttons to change mode.
- 3) Stay in the selected mode for 5 seconds; the display will blink and then return to the main display, indicating the change is complete.

The no-bark collar feature operates independently of app connectivity.

Note: When first using the SMART NOBARK Collar, it is recommended to start at the lowest stimulation level. If your dog continues to bark, gradually increase the stimulation level. Closely monitor your dog's reaction to find the right stimulation level for your dog.

Count Only

- Counts dog's vocalization without any stimulation.

PAGER - HPP (High Performance Pager) Vibration

- The SMART NOBARK will vibrate twice when your dog barks.

Auto Increase

- Automatically adjusts the level of stimulation based on barking frequency. This mode can be used by setting the stimulation level within a certain range in the app, so it is recommended to use it by pairing with the app. For detailed explanation of Auto Increase mode, please refer to 3-3 mode selection in GETTING STARTED.

Level 1-10

- The SMART NOBARK has stimulation levels 1 (lowest) through 10(highest). Each stimulation level begins with vibrate once followed by the stimulation.

* There is a 15 second safety delay between the vibration on PAGER and the stimulation on Auto Increase, levels 1-10 mode.

* Vibration on the device when setting the 'Set Level' or 'Auto Increase modes' can be disabled on the app. On 'Setting' page, Stimulation Mode Select Set Level or Auto Increase Switch off 'Vibrate warning before each stimulation'

4. INDICATOR LIGHT



Turning On

When SMART NOBARK is turned on, the indicator will emit a green light for 2 seconds and then blink every 4 seconds.

Stimulation occurs

- 1) Light on when stimulates triggered by Bark or Whining & Howling
- 2) When the Constant stimulation is commanded in training tab in the app, the Green light fast blinking

Battery status

The indicator light blinks green when the battery is fully charged and turns amber when battery life is low. If the light blinks red, the battery needs to be recharged.

GETTING STARTED(WITH APP)

1. DOWNLOADING THE DOGTRA SMART NOBARK



DOGTRA SMART NOBARK

To download the app:

- 1) Go to the Apple app store or Google play store on your phone.
- 2) Search for "DOGTRA SMART NOBARK" app.
- 3) Download the app on your phone

The app is currently compatible with:

- 1) iPhone 8 or newer
- 2) Android version 8 or newer

Compatibilities are subject to change.

*DOGTRA SMART NOBARK app and screenshot images are subject to change as Dogtra continues to update the software.

2. COLLAR SETUP GUIDE

To ensure the device performs accurately, we provide guidance on how to wear the collar, adjust the sensitivity, and configure the mode after connecting the collar.

For more information:

On 'More' page, Select Collar(;) → Collar Setup Guide

3. PAIRING THE COLLAR TO A PHONE

The DOGTRA SMART NOBARK Collar connects a smartphone and collar. Up to three collars can be paired at the same time.

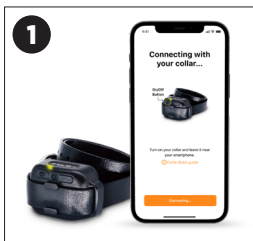

Make sure the DOGTRA SMART NOBARK app has been downloaded on your phone. Place the Collar close to your phone.

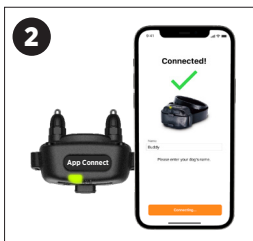

Once connected successfully, the app will show a connection completed message on the screen and on the collar.

If smartphone cannot connect with collar, check the following:

- Maintain a distance of within 30 yard from the smartphone.
- Check if the collar is on.
- Check if the collar is already connected to another smart device.

3-1. PAIRING ADDITIONAL COLLAR TO A PHONE

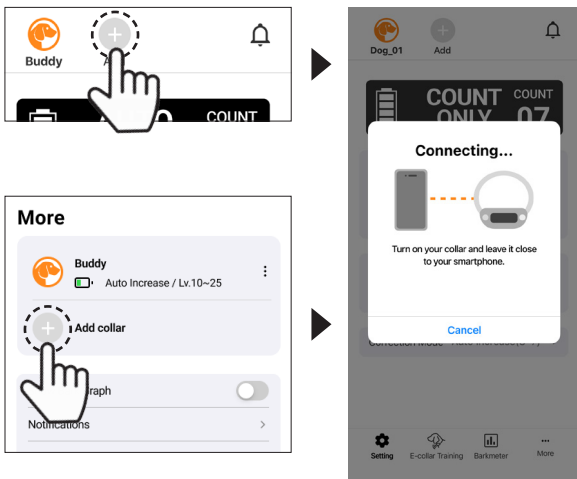

Press 'Add' button on header. once the pairing pop-up shows on the app. or go to More tab and press 'Add Device'. Up to 3 collars can be registered.

4. KEY FEATURES OF SMART NOBARK APP



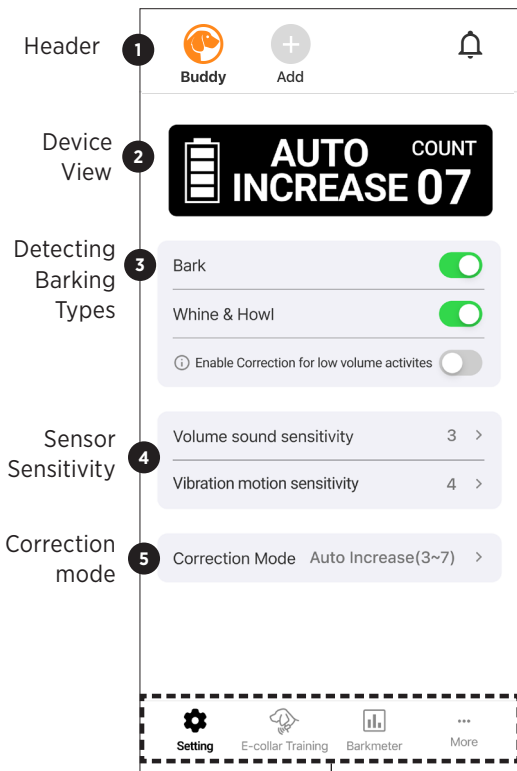



A) SETTING page



Main menu bar

1) HEADER

Indicates the currently added collar and whether or not there is a new notification.

Selected dog		Unselected dog		Add	Notification	
Connected	App Out of Range	Connected	App Out of Range		Unread	Read
						

2) DEVICE VIEW

Indicates the collar's current battery, setting mode, and counts.

The count is the sum of Bark and Whine&Howl.

3) DETECTING BARKING TYPES

Select which bark types to count. Multiple selections are possible, but you must select at least one.

Notes: Enable Correction for low volume activities

Detects even the low volume barking and whining/howling to activate stimulation. (When turned off, it won't detect or activate on low tones.)

4) SENSOR SENSITIVITY

Set the vocalizations you want to count and the detection sensitivity. (More detail on next page)

5) CORRECTION MODE

Set the modes and stimulation levels. (More detail on next page)

4-1) SENSOR SENSITIVITY page

Click 'Sensor Sensitivity' section' on the Setting page to adjust the sensitivity to better suit your dog's vocal activity type.

* While on this page, the collar will switch to Count Only mode, and won't apply any correction for safety reasons.

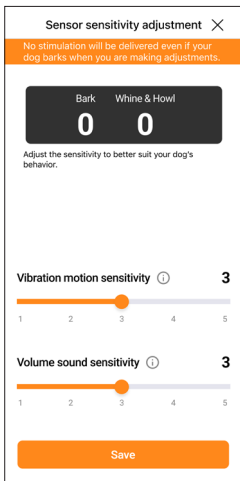

Vocal cord vibrations sensitivity

Adjust the sensitivity for detecting vocal cord vibrations when your dog barks. Higher settings increase detection accuracy. For smaller dogs, higher sensitivity may be beneficial.

Bark Volume Sensitivity

Adjust the sensitivity for detecting your dog's bark volume. Higher sensitivity improves detection of quieter barks. Increase microphone sensitivity if your dog's bark is soft.

* The counts at the top of the screen are for reference purpose only while adjusting the sensitivity. These counts are not included in the totals shown on the Setting tab or the Barkmeter tab.

5-1) CORRECTION MODE page

Select the type of correction to apply when a behavior is detected. If you've already set a mode on the collar, the app will display the corresponding mode.

Count Only

Counts dog's vocalization without any stimulation.

Pager Vibration

Vibrates when a dog's vocalization is detected.

Auto Increase

The collar automatically adjusts the stimulation level, starting from the lowest setting. It increases gradually until barking slows down and decreases as your dog stays quiet.

After each stimulation, there's a 15-second safety pause. If your dog barks again soon after, the level slightly increases (by 0.2 levels); if they stay quiet, it lowers to about half of the previous level.

Set Level

→ See next page

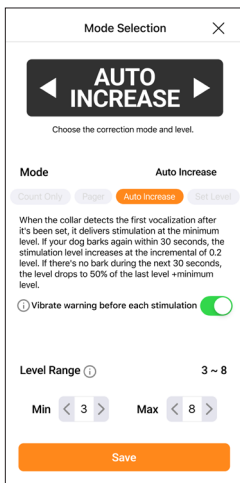

Set Level

You can set the fixed stimulation level between 1 (lowest) and 10 (highest). After each stimulation, there is a 15-second safety period with no further correction.

* Each correction starts with a vibration, followed by stimulation in both “Auto Increase” and “Set Level” modes. This gives your dog a warning before stimulation occurs, and helps them learn to respond to Pager Vibration alone over time.

B) E-COLLAR TRAINING

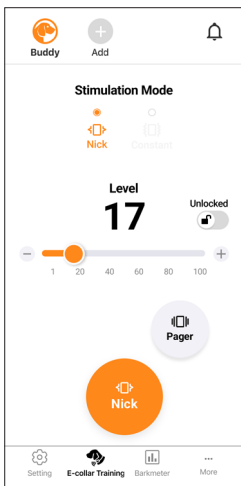

How to Use

- 1) Select the collar from the top header section.
- 2) Select the stimulation mode and level per collar.

Stimulation mode

Nick delivers a single quick pulse of stimulation. Constant provides continuous stimulation while the button is pressed, for up to 12 seconds.

Level

Slider bar controls the stimulation level, with a maximum output at level 100.

Level lock

Lock/unlock the stimulation level to prevent accidental changes by pressing and holding the button on the slider bar.

Pager

Press Pager to emit the Pager vibration as long as the button is pressed, up to 12 seconds.

FINDING THE RIGHT STIMULATION

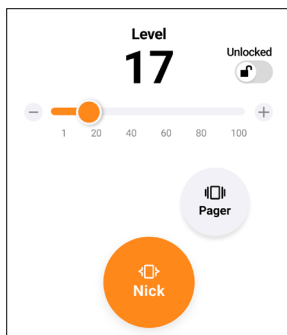

- Always start at the lowest level of stimulation and work your way up.
- The appropriate level can be found when your dog responds to the stimulation with a mild reaction, such as a tensing of the neck muscles.

C) BARKMETER

Counts by the collar are categorized and displayed by period on a chart.

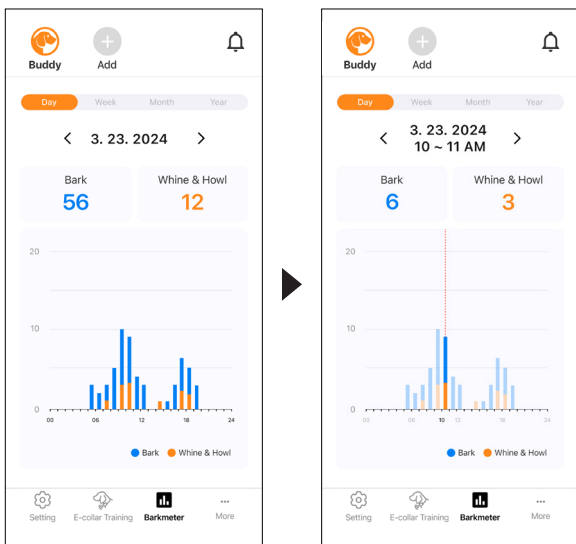

Day tab shows the hourly counts for a day.

Week, Month, Year tab shows the average daily count for that period, and you can see detailed information by pressing each graph bar.

Select the category that the graph represents and select a specific period left and right to compare the average counts for that period with the call over the period by checking the graph for the detailed period.

D) MORE

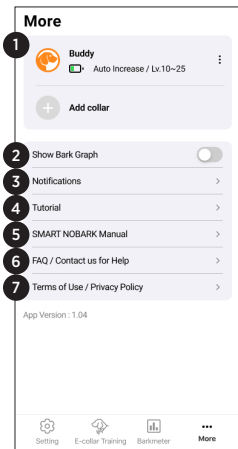

1) Collar List

Shows the status of added collars and allows you to delete them or edit their name/color. (More detail on next page)

2) Show bark meter

When enabled, a Bark Graph is displayed at the top of the screen.

3) Notifications

Shows the notification history for connected collars. (More detail on next page)

4) Tutorial

Describes basic contents.

1. Initial setup describes Collar and pairing.
2. Main function will describe each tab.

5) SMART NOBARK Manual

Find step-by-step instructions to set up, connect, and optimize your experience with the Dogtra SMART NOBARK.

6) FAQ / Contact us

Find solutions to issues you may be experiencing with your collar.

7) Terms of Use/Privacy Policy

Check Terms of Use and Privacy Policy before using the app.

1-1) COLLAR LIST

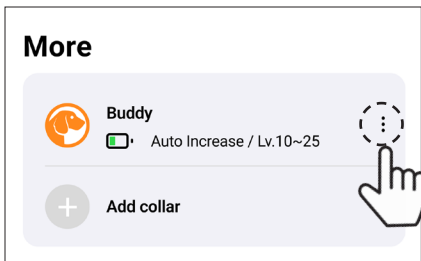

EDIT COLLAR NAME& COLOR

- 1) Press the **:** button in More tab
- 2) Select the 'Edit Name & color'
 - If you set a different color for each dog, when you select a dog in the app, the button will change to that color, making it easier to distinguish between dogs.

DELETE COLLAR IN APP

- 1) Press the **:** button in More tab
- 2) Select the 'Delete collar'
 - Please note that if you delete the collar, the collar's count data saved in the app will also delete.



COLLAR SETUP GUIDE

- 1) Press the **:** button in More tab
- 2) Select the 'Collar Setup Guide'
 - For accurate measurement, this guide provides instructions on how to wear the collar, set the sensitivity, and configure the mode.

3-1) NOTIFICATION

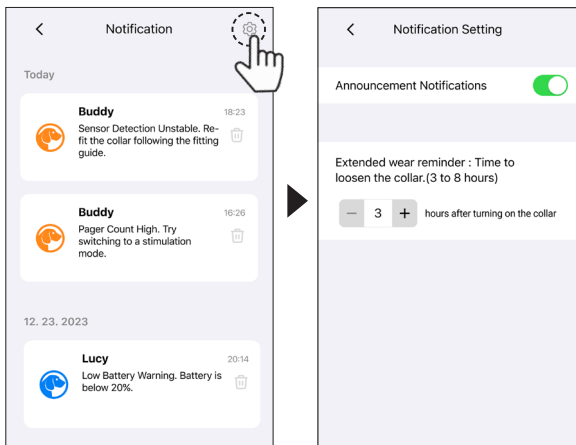
Notifies you of the specific status of the collar to ensure your dog's safety and proper use of the product.



- 1) Press  in Header or Notifications in More tab.
- 2) Press  button in the upper right corner in the Notification page, you can turn on/off conditions that trigger notifications.

Note

These settings are applied equally to all registered collars.

Status/Message	Action/Tip
Unstable Sensor / “Sensor Detection Unstable. Re-fit the collar following the fitting guide.”	Immediately re-fit the collar on your dog’s neck. A poor fit can lead to inconsistent or ineffective correction
Consistent barking while on ‘Set Level’ mode / “Stimulation Count High. Consider increasing the Set Level.”	On ‘Setting’ page, click the ‘Correction Mode’ module, then on the Set Level page, to change the correction stimulation level. Or change the level on the collar, using the Mode Select button.
Consistent barking while on ‘Auto Increase’ mode / “Stimulation Count High. Consider increasing the Max Level.”	On ‘Setting’ page, click the ‘Correction Mode’ module, then on the ‘Auto Increase’ page, to change the “Max” number of the ‘Level Range’.
Consistent barking while on ‘Pager’ mode / “Pager Count High. Try switching to a stimulation mode.”	Try other correction types on the ‘Correction Mode’ page.
“Low Battery Warning. Battery is below 20%.”	Charge the collar immediately.
“Safety Alert. Your collar has been running for over 6 hours. Consider taking it off and charging it now.”	This is an extended wear reminder. Take the collar off your dog to prevent skin irritation. Ensure the device is fully charged for next use.

COLLAR FITTING

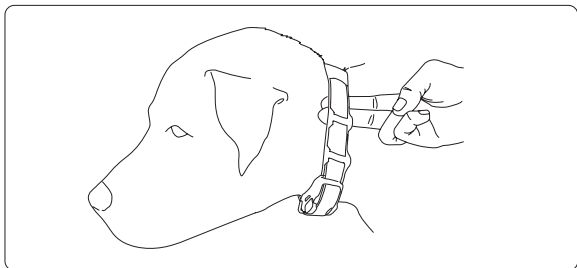

Proper Fit

Fit the collar on either side of the dog's windpipe so that the contact points press firmly against the dog's skin. You should be able to fit two fingers underneath the collar strap.

Improper Fit

A loose fit can allow the collar to move around on the dog's neck and cause irritation. If the collar is too loose, the contact will be inconsistent and cause inconsistent stimulation.

Attention!

While Dogtra uses medical grade stainless steel contact points and anti-microbial plastic to protect the dog's skin, leaving the collar in the same location for an extended period of time can cause skin irritation due to the sensitivity from the contact points. Reposition the collar every few hours to move the contact points and remove the collar after 6 hours of use. Check for skin irritation each time you use the unit.

CHARGING THE BATTERY

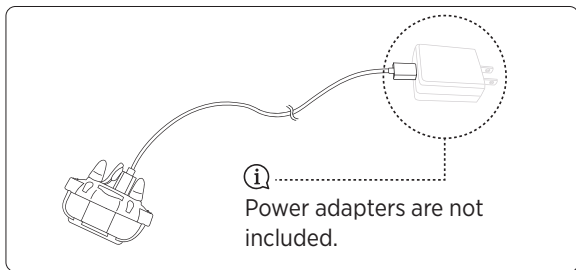

The Dogtra SMART NOBARK uses a lithium polymer battery. Recharge the unit if the indicator light is red or does not come on or the system will not stay on when any button is pressed.

NOTE 1: Only use Dogtra-approved batteries, chargers, and accessories for your Dogtra E-collars. This will prevent any damage that can be incurred from attempting to use a different charger.

NOTE 2: The unit has a partial charge when it leaves the Dogtra facility. Upon receipt of the system, be sure to give it a full 2-hour initial charge before the first use away from any flammable substances.

NOTE 3: When a charger is not in use, disconnect it from the power source. Fully charge the batteries if the unit is to be stored without use for a period of 3 months or more.

Follow the steps below to charge your system:

1. Open the rubber plug on the battery charging receptacle and plug in the charging cable.
2. Plug the charger into a 120-volt wall outlet or, if using the auto charger, plug into a cigarette lighter only for lithium polymer batteries (use a 220 volt European charger for Europe). All indicator lights should glow red when properly plugged in and the unit will automatically shut off during the charging process. You will need to turn the unit on again before use once the unit is fully charged and unplugged from the battery cable.
3. The lithium polymer battery is fully charged within 2 hours. The lights will stay red during the charging process and turn green once the unit is fully charged.
4. After charging, cover the battery charging receptacle with the rubber plug.

Recharging is required when:

- The Indicator light on the collar is red
- The Indicator light on the collar is not illuminated
- Only one battery status bar remains on the collar Display
- The collar does not work when the button is pressed
Constant stimulation in Training tab(App)

MAINTENANCE

Basic Maintenance

Make sure the rubber charging cap is securely in place when the collar is in use. After each training session, carefully inspect the unit for any missing parts or damage to the casing. Damaged or broken casing may affect the waterproof guarantee on the unit. After confirming that there is no damage to the casing, rinse the collar and clean out any dirt or debris.

Storage Maintenance

The SMART NOBARK should be fully charged before storing for extended periods. While in storage, the unit should be given a full charge once a month and before the first use. Store the units in room temperature. Do not keep the units exposed to extreme climates.

Troubleshooting

If the unit is malfunctioning, please refer to the “Troubleshooting Guide” before sending it to Dogtra for service. If you have any questions or concerns, you may email them to info@dogtra.com, or call customer service at (888) 811-9111.

TROUBLESHOOTING GUIDE

1. My dog is not reacting to the collar.

- Make sure the collar is turned on.
- Make sure the strap is on the dog tight enough so that both contact points are touching the dog's skin.
- The contact points may be too short for the dog.
To place an order for longer contact points that are more appropriate for your dog, please call (888) 811- 9111. If you are already using the longest contact points available, you might need to trim down the hair on the dog's neck so both contact points are touching the dog's skin.
- The intensity level may be too low for your dog. Keep increasing the stimulation until the dog responds, usually with neck movement, head shaking, looking over its shoulder, etc. (response may be very subtle).

2. My Collar is not holding a charge.

- The batteries might not be charged properly, or the charger, splitter, and the charging port may not be functioning properly. You can send in your charging units to have us inspect them.
- The charging pin may be damaged. Inside the charging port, there is a metal pin that should be standing straight up and stiff. If the pin is wobbling, broken, or missing, you will need to send the unit in to the Repair Department. The charging port must be clean prior to charging; clean the dirt out with a cotton swab and some rubbing alcohol. If the dog is in saltwater, be sure to rinse the collar and charging port with clean water.
- If the above does not resolve your issues, contact Dogtra customer service at info@dogtra.com or (888) 811-9111.

3. My dog has skin irritation.

- Leaving the collar in the same location on the dog's neck for an extended period of time can cause skin irritation. If the dog is to wear the collar for long periods, occasionally reposition the collar so that the contact points are moved to a different location on the dog's neck. Make sure you check for skin irritation each time you use the unit.

FCC/IC WARNING STATEMENT

PART 15.19

This device complies with part 15 of the FCC Rules. Operation is subject to the following two conditions:

- (1) This device may not cause harmful interference, and
- (2) this device must accept any interference received, including interference that may cause undesired operation.

PART 15.21

Any changes or modifications (including the antennas) to this device that are not expressly approved by the manufacturer may void the user's authority to operate the equipment under FCC rules.

PART 15.105

Note: This equipment complies with the limits for a Class B digital device, pursuant to part 15 of the FCC Rules. These limits are designed to provide reasonable protection against harmful interference in a residential installation. This equipment generates, uses and can radiate radio frequency energy and, if not installed and used in accordance with the instructions, may cause harmful interference to radio communications. However, there is no guarantee that interference will not occur in a particular installation. If this equipment does cause harmful interference to radio or television reception, which can be determined by turning the equipment off and on, the user is encouraged to try to correct the interference by one or more of the following measures:

- Reorient or relocate the receiving antenna.
- Increase the separation between the equipment and collar.
- Connect the equipment into an outlet on a circuit different from that to which the collar is connected.
- Consult the dealer or an experienced radio/TV technician for help.

This device contains licence-exempt transmitter(s)/collar(s) that comply with Innovation, Science and Economic Development Canada's licence-exempt RSS(s). Operation is subject to the following two conditions:

- (1) This device may not cause interference.
- (2) This device must accept any interference, including interference that may cause undesired operation of the device.

FCC and IC RF Radiation Exposure Statement: This equipment complies with FCC and IC RF Radiation exposure limits set forth for an uncontrolled environment.

This device and its antenna must not be co-located or operating in conjunction with any other antenna or transmitter.

DOGTRA EXTENDED PRODUCT WARRANTY

EXTENDED LIMITED WARRANTY

For Certain Dogtra Products Purchased from Dogtra Authorized Dealers

1+1 Year Extended Warranty

Except as otherwise provided, Dogtra warrants to the original retail purchaser (“You”) that your Dogtra product shall be free of defects in materials and workmanship for a period of one (1) year from the date of purchase (“Original Warranty”). As a special promotion, Dogtra further warrants that your Dogtra product shall be free of defects in materials and workmanship for an additional one (1) year from the date that your original warranty expires (“Extended Warranty”). The Original and Extended Warranties cover the cost of repair (parts and labor) or replacement (if repair is not feasible) of a defective Dogtra product during said warranty periods. For such repaired or replaced products, the remaining portion of the warranty periods, or ninety (90) days, whichever is longer, shall apply. Dogtra, at its sole discretion, shall determine whether to repair or replace a product covered by the Original Warranty or Extended Warranty.

Warranty Conditions

The Original and Extended Warranties are not transferrable and apply to your Dogtra product only if:

- (1) You are the original retail purchaser of the product,
- (2) You bought the product from a Dogtra Authorized Dealer, and
- (3) You present a receipt or other proof of purchase showing a valid purchase date, the name and address of the Dogtra Authorized Dealer, and the purchased product identified by model and/or serial number.

Warranty Exclusions

The Original and Extended Warranties do not cover damage, loss, or deterioration to your Dogtra product caused: by misuse, neglect, abuse, or other improper handling of the product; by failure to follow use or care instructions; by use of the product for other than its intended purpose; by accident or natural forces such as fire or flooding; or by normal wear and tear such as scratches to the product surface.

The Original and Extended Warranties also do not cover Dogtra products that: are purchased from non-authorized dealers; are purchased outside of the United States or Canada; have been damaged during shipment (even if Dogtra paid or arranged for shipping); have been modified or tampered with in any manner; are opened or repaired by anyone other than Dogtra; or have serial numbers that have been altered or defaced.

Dogtra Customer Service

12322 Monarch Street, Garden Grove, CA 92841

(888) 811-9111

repair@dogtra.com

Mon - Fri, 8:00 AM to 4:30 PM (PST)

© 2024 Dogtra. All rights reserved.