

# Aclas ESL User Manual



# Contents

**I. Product Introduction**

**II. Daily Use in Stores**

## **FCC Statement:**

This device complies with part 15 of the FCC Rules. Operation is subject to the following two conditions:

- (1) This device may not cause harmful interference, and
- (2) this device must accept any interference received, including interference that may cause undesired operation.

This equipment has been tested and found to comply with the limits for a Class B digital device, pursuant to part 15 of the FCC Rules. These limits are designed to provide reasonable protection against harmful interference in a residential installation. This equipment generates, uses and can radiate radio frequency energy and, if not installed and used in accordance with the instructions, may cause harmful interference to radio communications. However, there is no guarantee that interference will not occur in a particular installation. If this equipment does cause harmful interference to radio or television reception, which can be determined by turning the equipment off and on, the user is encouraged to try to correct the interference by one or more of the following measures:

- Reorient or relocate the receiving antenna.
- Increase the separation between the equipment and receiver.
- Connect the equipment into an outlet on a circuit different from that to which the receiver is connected.
- Consult the dealer or an experienced radio/TV technician for help.

Caution: Any changes or modifications not expressly approved by the party responsible for compliance could void the user's authority to operate the equipment.

This equipment complies with FCC radiation exposure limits set forth for an uncontrolled environment. This transmitter must not be co-located or operating in conjunction with any other antenna or transmitter.

## **RF Exposure Warning:**

This equipment complies with radiation exposure limits set forth for an uncontrolled environment. This equipment should be installed and operated with Minimum distance 20cm between the radiator and your body.

# I. Product Introduction

# 1. EPD Shelf Label

| Product Pictures      |  |  |
|-----------------------|---|---|
| Model                 | SLX   | SL4   |
| Screen Size           | 2.66 inches   | 4.2 inches  |
| Resolution            | 296*152   | 400*300   |
| Display Color         | Black/White/Red/Yellow  | Black/White/Red/Yellow  |
| Communication Method  | 2.4G Wireless   | 2.4G Wireless   |
| Battery Capacity      | 2×CR2450 (Replaceable)  | 2×CR2450 (Replaceable)  |
| LED Light             | 8-Color Support   | 8-Color Support   |
| Operating Temperature | 0~40°C  | 0~40°C  |

## 2. Color Display ESL



| Model                | SLD                        |
|----------------------|----------------------------|
| Display              | 10.1-inch TFT Color Screen |
| Resolution           | 800*1280                   |
| Communication Method | 2.4G Wireless              |
| Power Supply         | 24V 2A                     |

### 3. Controller



| Model                | GW4  |
|----------------------|--|
| Communication Method | 2.4G Wireless  |
| Coverage Range       | Radius 15-20m (No Obstacles)   |
| Wi-Fi                | 802.11b/g/n (2.4GHz)   |
| Communication Ports  | Ethernet, RS485 (×3), RJ11, SD Card Slot                                       |
| Power Supply         | DC 9V  |
| Dimensions           | 125*120*30.6mm   |
| Installation         | Horizontal Placement (Keep away from large power equipment, iron frames, etc.) |

# 4. System Operating Principle

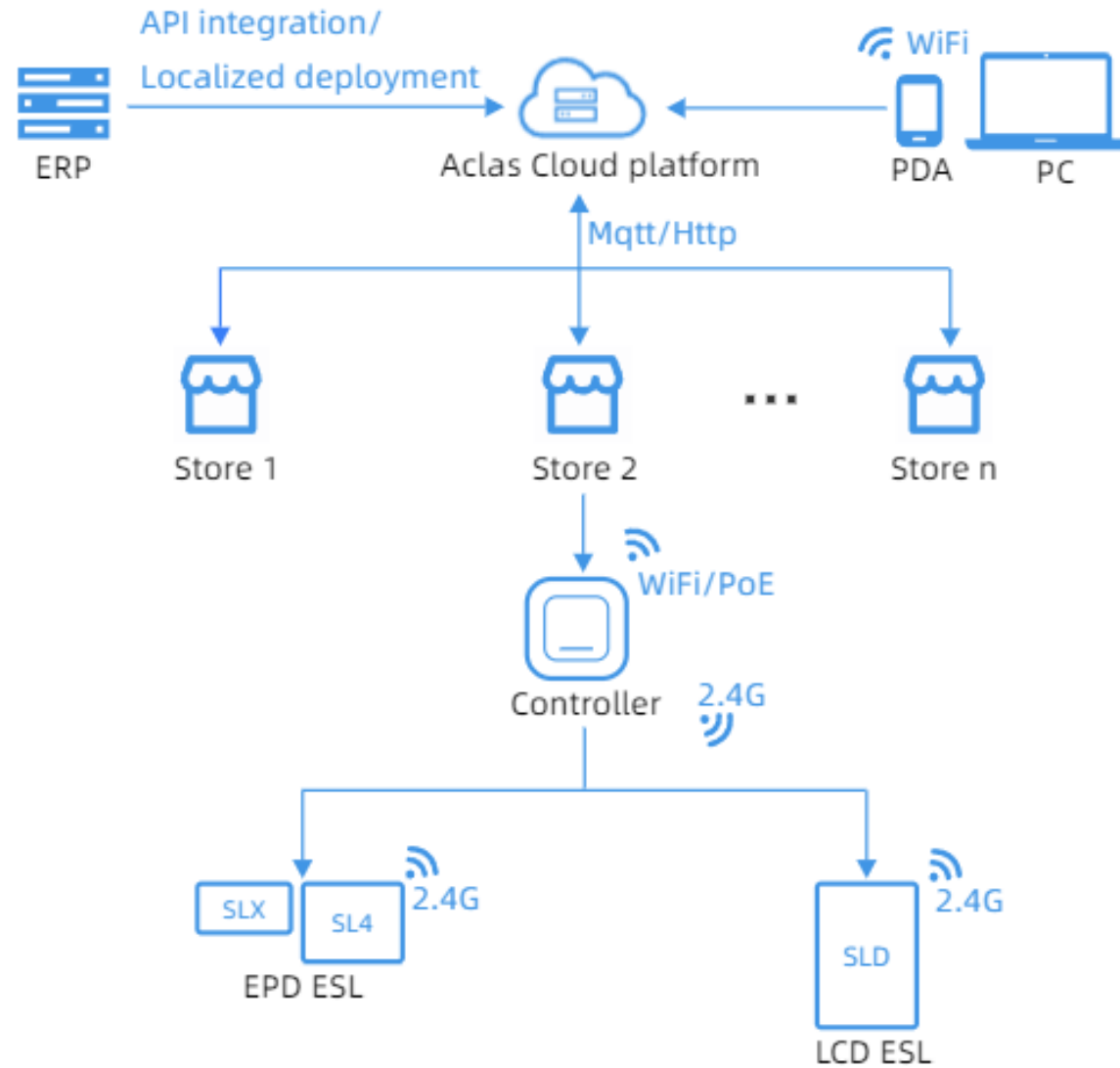

## II. Daily Use in Stores

# 1. Login

Obtain the account and password, and log in to the Aclas Web69 Cloud Device Manage System.

(Merchant number: 0202, User number: 0202, Password: 123456 )

- Open WeChat, scan the QR code and log in with your merchant number/user number and password.
- Open the webpage and enter the URL: <https://web69.aclas.com/>



微信扫一扫，使用小程序

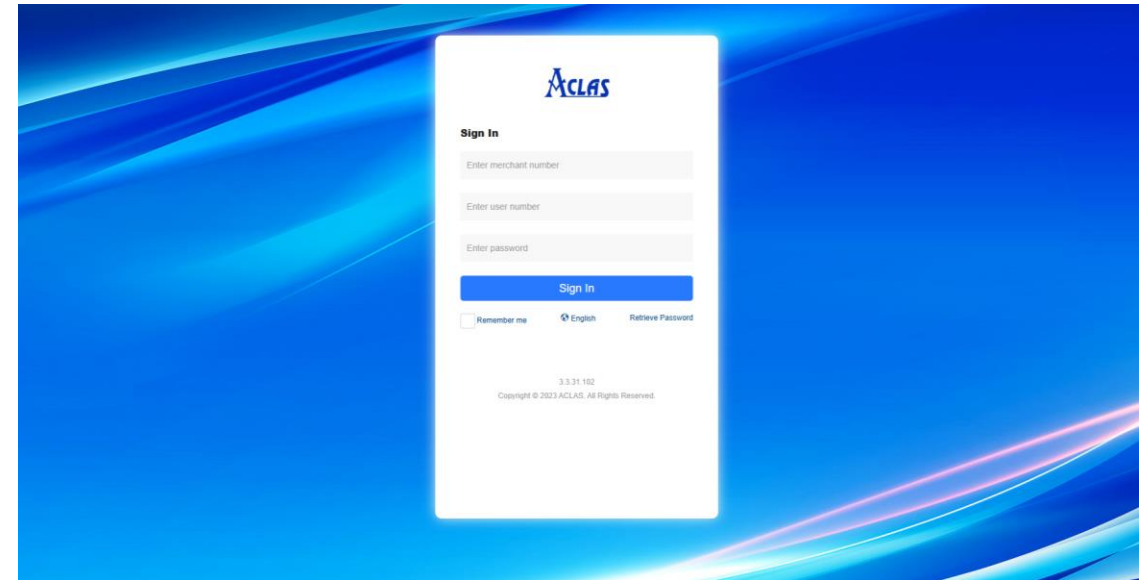
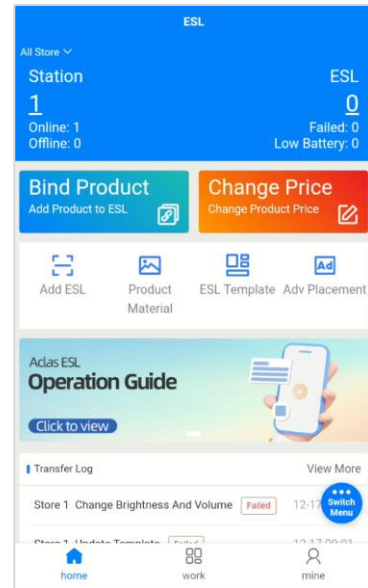
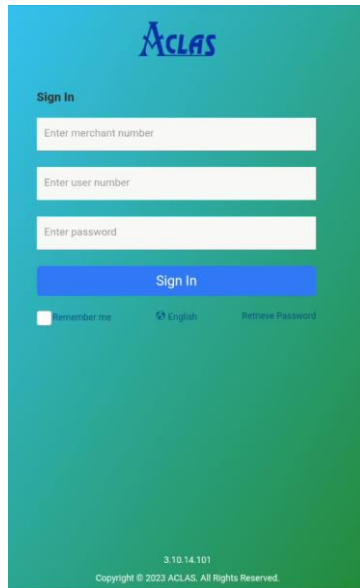

## 2. Add ESL Controller & Network Configuration --» 1. Connect via Ethernet (DHCP)

- First connect the ESL controller to an Ethernet cable and then plug in the power supply, or use Ethernet POE for both network connection and power supply.
- During startup: The controller first illuminates a white light (booting up), then briefly turns **red** (not connected to the network), and finally stays **green** (successfully connected).
- On the homepage, click the numeric link under the Station (or find 'Station' in the Work) → click '+' to add a controller.
- Click 'Add Station', enter the controller's SN (check the nameplate for the SN), select the affiliated Store, set a name and Channel, then click 'Save'. Confirm the controller is in 'Online' status.

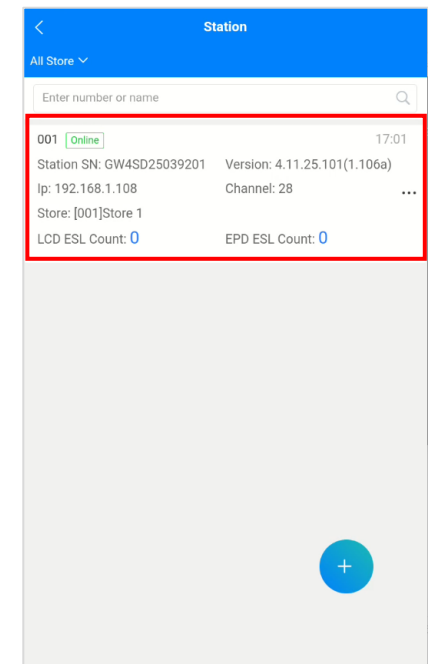
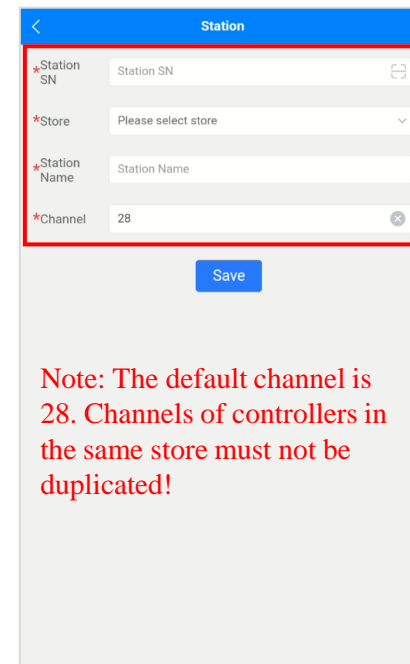
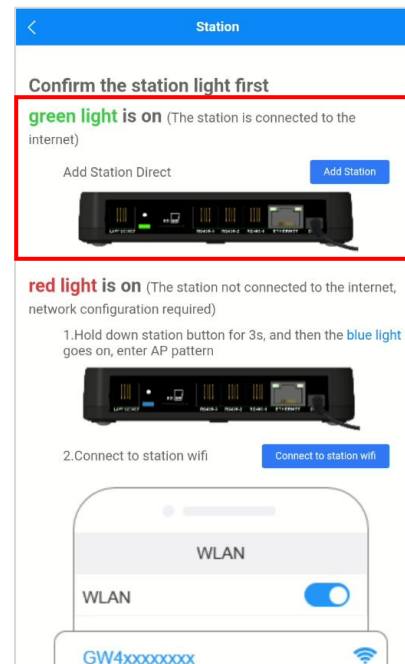
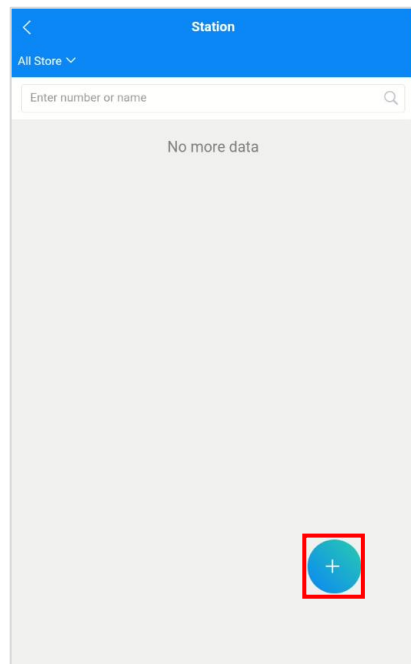
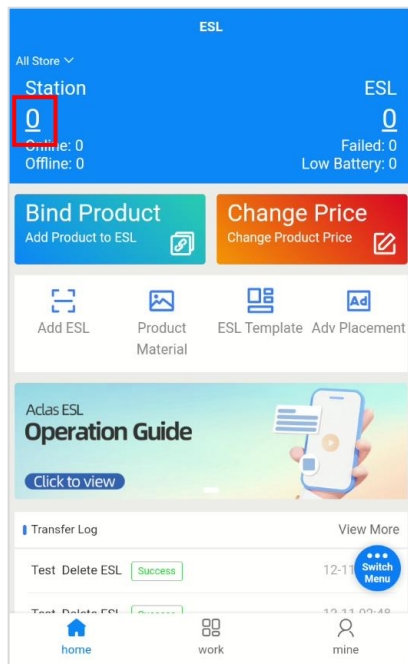

## 2. Add ESL Controller & Network Configuration --» 2.1 Connect to Controller AP



- Plug in the controller's power supply. During startup: It illuminates a white light (booting up), then stays **red** (not connected to the network, requiring configuration).
- Press and hold the controller's button for 3 seconds until the blue light stays steady (enters AP mode).
- On the homepage, click the numeric link under the Station (or find 'Station' in the Work) → click '+' to add a controller.
- Click 'Connect to Station Wi-Fi' (Wi-Fi name: GW4xxxxxxxx). Open your device's settings, connect to the controller's Wi-Fi, and return to the network configuration interface after successful connection.

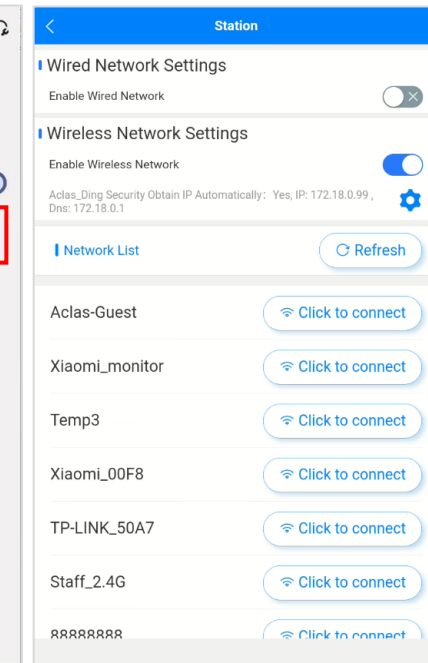
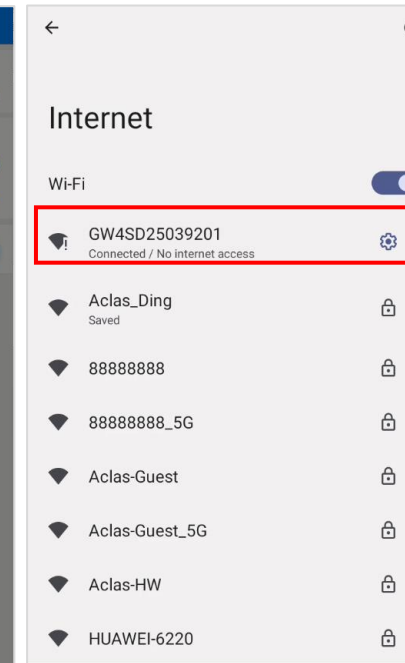
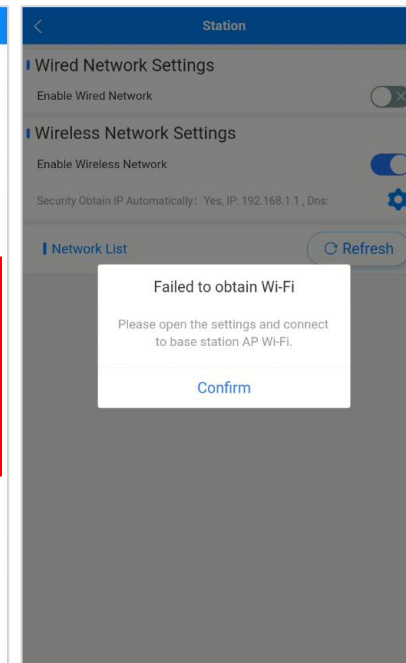
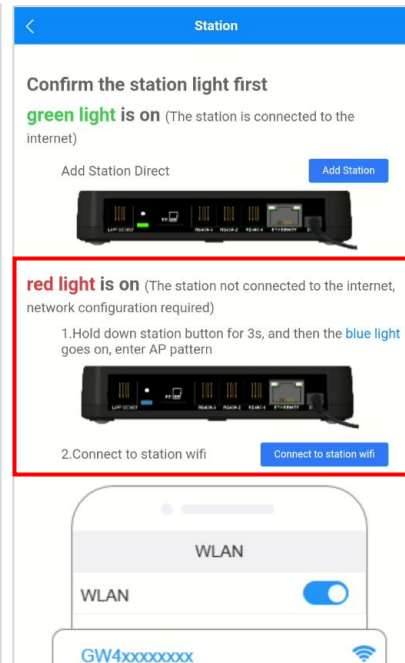
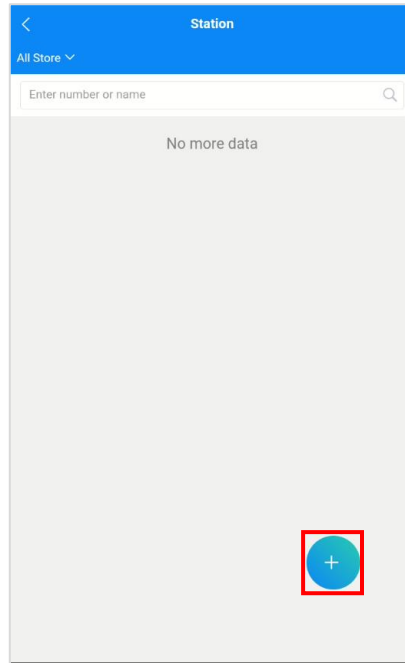
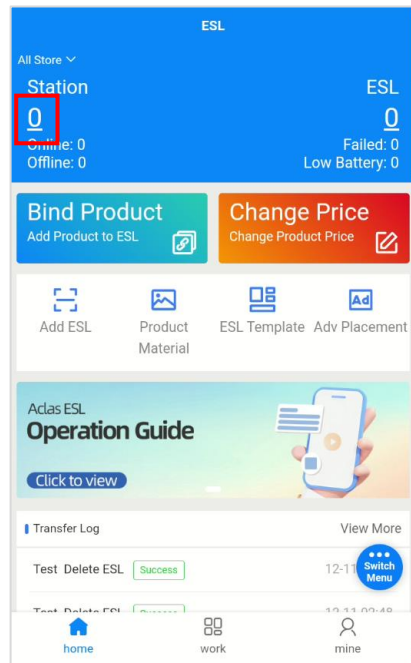

## 2. Add ESL Controller & Network Configuration --» 2.2 Select Network Configuration Type

### Enable Wired Network (Set Static Ethernet IP)

- Click to open the network properties configuration window.
- Disable 'Obtain IP Automatically', manually enter the network configuration.
- Click 'Confirm'.
- Verify successful configuration: The controller's green light stays steady = configuration completed.

### Enable Wireless Network (Wi-Fi)

- Select the target Wi-Fi name in the network list.
- Enable 'Obtain IP Automatically', enter the Wi-Fi password directly, then click 'Confirm'.  
Disable 'Obtain IP Automatically', manually enter the network configuration and Wi-Fi password, then click 'Confirm'.
- Verify successful configuration: The controller's green light stays steady = configuration completed.

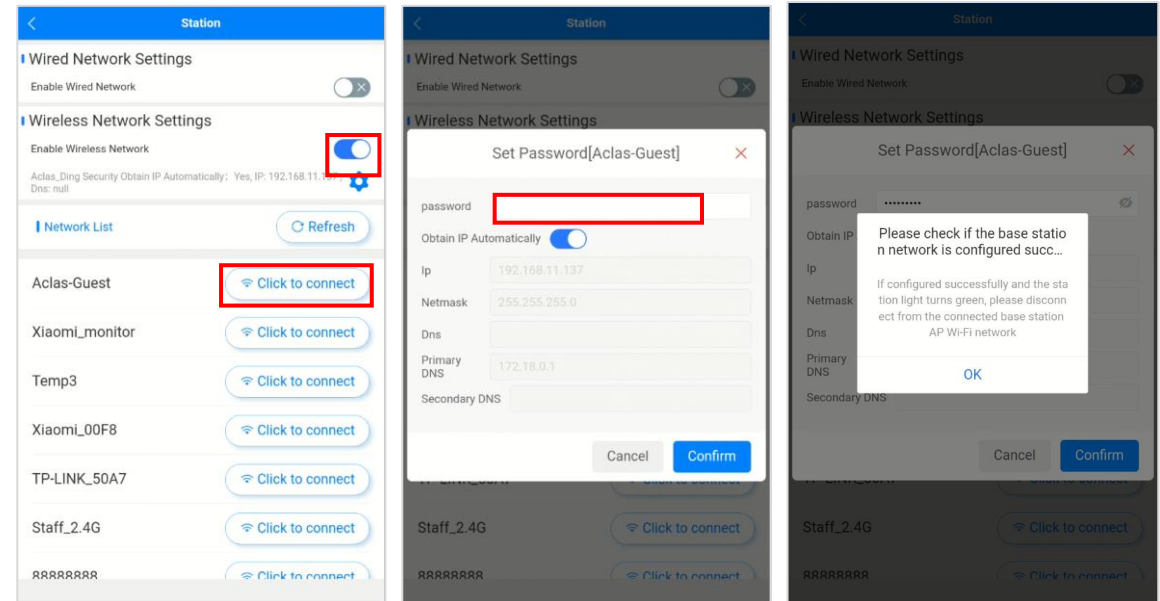
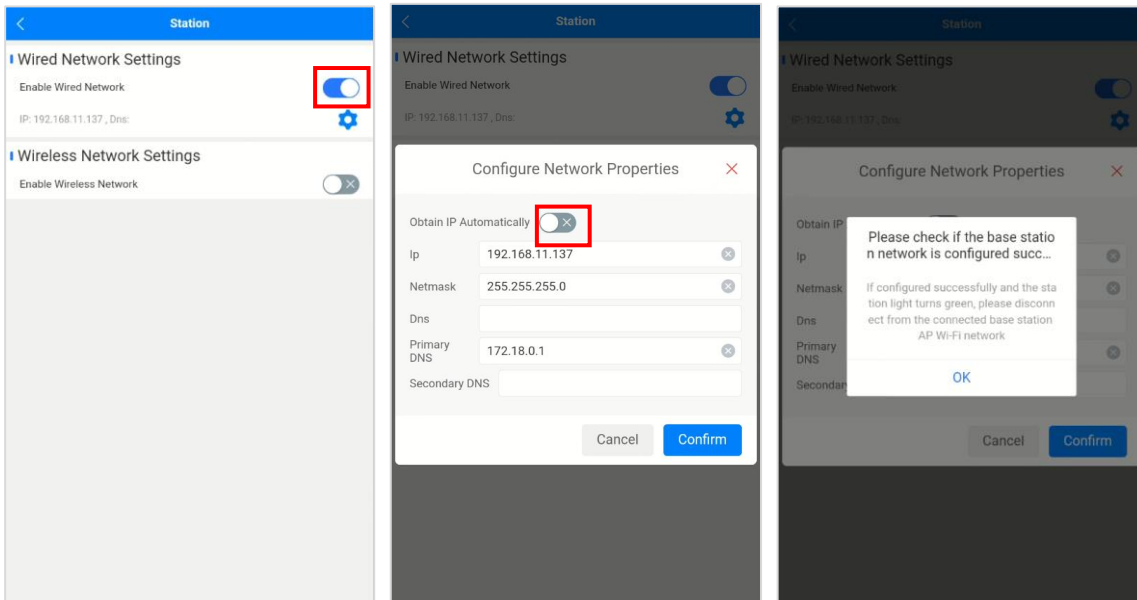

## 2. Add ESL Controller & Network Configuration --» 2.3 Set Store and Station Name

- Verify if the controller's network configuration is successful: If the controller's **green light** stays steady, disconnect from the connected controller AP Wi-Fi and click 'OK'.
- Once the controller network configuration is successful (green light), click '<' to return to the Store and Station Name settings.
- Select the controller's affiliated store, enter a name, and choose a channel, then click 'Save'.
- After the controller is successfully added, confirm that the controller status is 'Online' to complete the process.

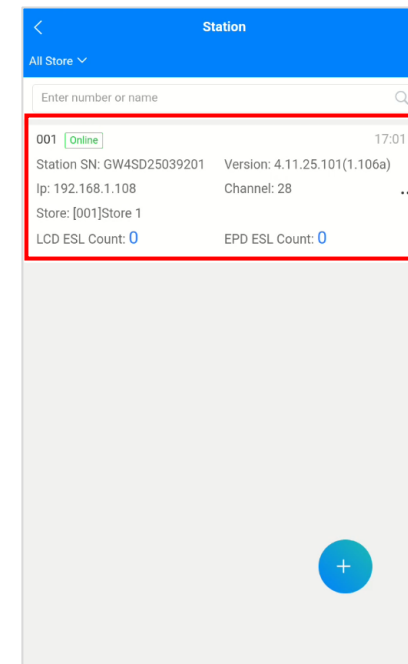
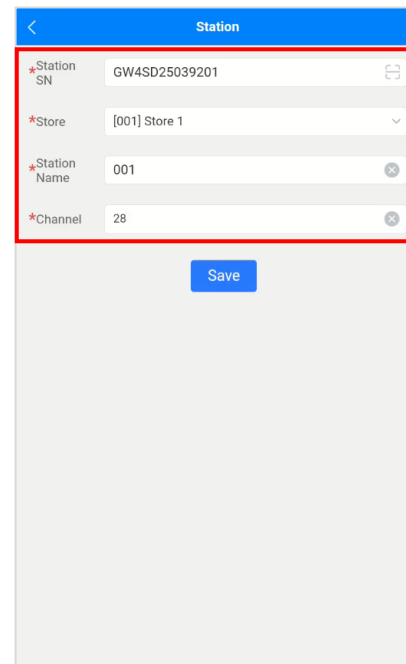
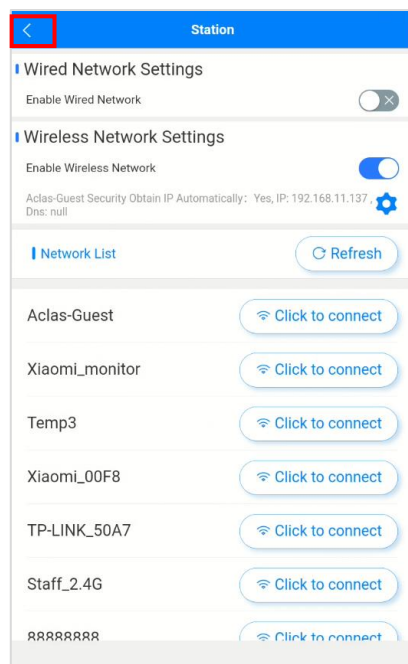
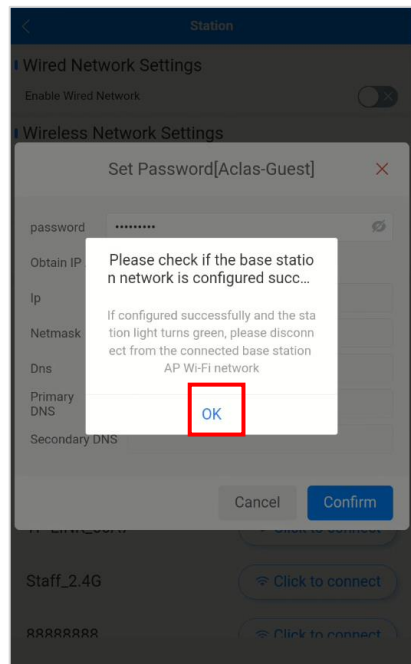

# 3. Bind Product

1. After successfully adding ESLs (ESL SNs exist in the ESL list), click ‘Bind Product’ directly on the homepage.
2. Enter the Product Binding page (screen orientation defaults to the one selected during ESL binding).
3. Select the number of products to bind (1-4 products supported by default for SLD; 1-2 for SL4; only 1 for SL2/SL3/SL6).
4. Choose the desired number of products to bind, scan or enter the Product SKU/EAN/Name, and press ‘Enter’ to search for the product.
5. After selecting the product, find the ESL to bind, click the Scan Icon, and scan the ESL's SN QR code. The product will be automatically bound.

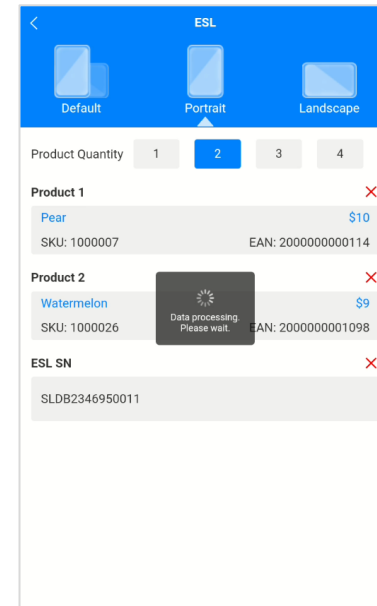
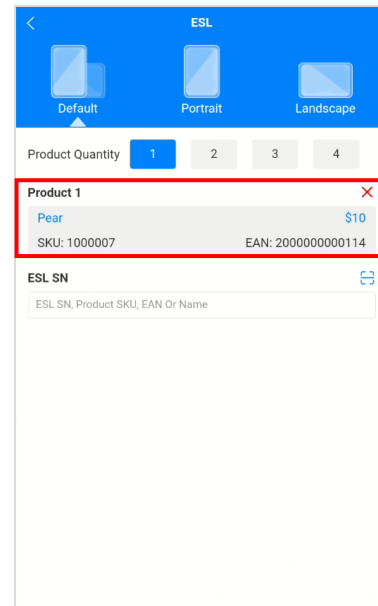
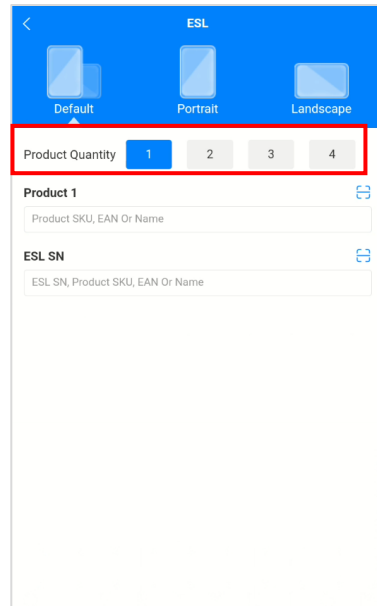
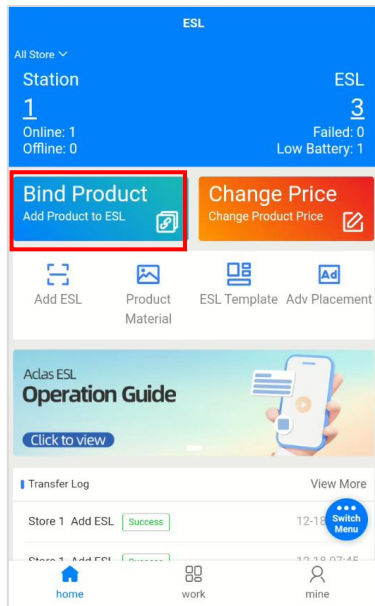

# 4. Change Price

1. Click 'Change Price' to enter the Change Price page.
2. Scan the ESL's SN to retrieve the product, or enter Product SKU/EAN/Name to search.
3. Adjust the corresponding price and click 'Save'.

