



Built-in Access Door Installation Instructions

Prepare Cabinet Rough Opening:

Prepare the rough opening using the dimensions in the following table. The opening should be plumb, level and square.

	Lower Doors Pro VGC30AD	Lower Doors Elite VGC42AD
Rough Opening Height	11-1/2"	11-1/2"
Rough Opening Width	27-3/8"	39-3/4"

Remove Doors:

Remove the doors for ease of installation. Open the doors and release them from the cabinet with the small clip on the inside portion of the hinge. Set the doors aside.

1) Open doors

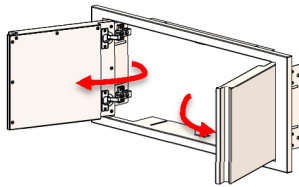

2) Release Hinges

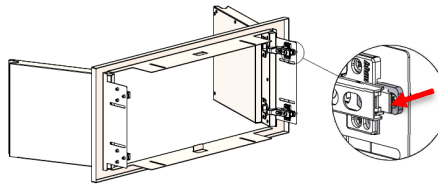

3) Remove doors.

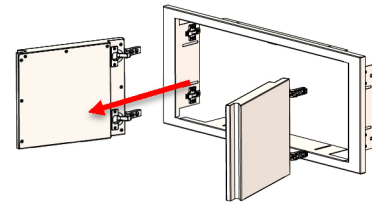

Install Cabinet:

Install the cabinet into the prepared rough opening. Ensure that the cabinet is plumb, level and square in the opening and fasten the cabinet to the structure. Use a minimum of four fasteners that are appropriate for the structure's material. Once installed, double check that the cabinet is still plumb, level and square. Reinstall the doors by clipping the hinges on the door onto the hinge plates on the cabinet. Clip one hinge at a time. Close the doors and use the hinge alignment mechanisms to align the doors in the cabinet.

4) Fasten cabinet to structure

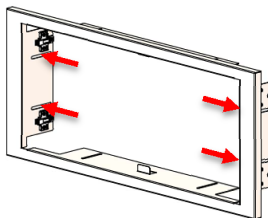

5) Reinstall doors

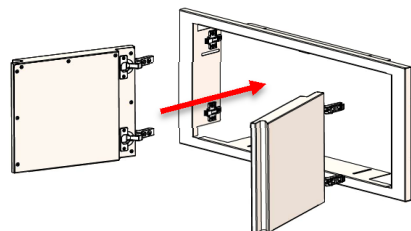

6) Close Doors

