

VIVOHOME

THANK
YOU!

NOTE:

To continuously improve its products, VIVOHOME reserves the right to modify this information without prior notification.

For any questions regarding assembly, please watch the video on the product page or contact our customer service. Our customer service will gladly assist you with any additional questions, comments, or concerns.

Thank you for using VIVOHOME products in your home!

Thank You for Purchasing from

VIVOHOME

Made in China

VIVOHOME

HOW-TO

USER MANUAL

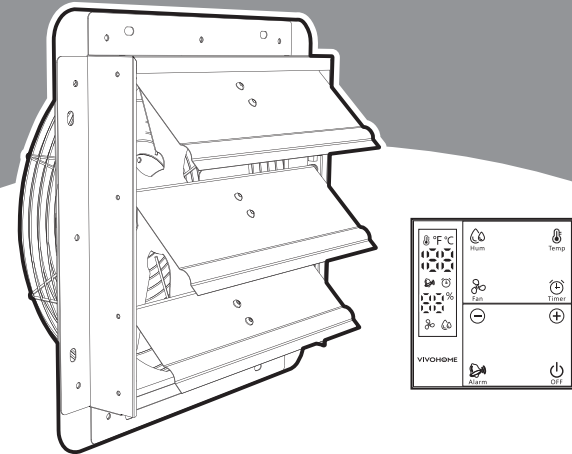

12 inch Shutter Exhaust Fan

Assembly is EASY!

**WE WANT
YOU TO
ENJOY LIFE
AT HOME**

GO TO THE PRODUCT LISTING PAGE
FOR AN INSTRUCTIONAL VIDEO!

CONTENTS

Safety Information.....	1
What's in the Box	2
Product Introduction.....	3
Installation Guide	4
Remote Control Operation.....	7
Troubleshooting.....	15
FAQ.....	16
Warranty.....	17

Safety Information



(Please read the instructions before use, Improper operation could cause fire, electric shock, or equipment damage.)

Electrical Safety

1. Use 110V 50/60Hz AC power. A voltage converter is required if the voltage is actually different; otherwise, the motor may burn out.
2. Stop using the appliance and contact customer support for a replacement cord if you see any damage, such as cuts, bends, or exposed wires.
3. Please disconnect the power plug before installation or maintenance.
4. Please follow all local state/provincial electrical and safety regulations.

Installation Restrictions

1. Do not install in flammable or explosive areas (e.g., paint warehouses) or highly corrosive environments.
2. Keep the unit ≥ 59 in (1.5 m) away from heat sources like stoves and heaters, ≥ 10 cm from corners, and ensure that the air intake and exhaust vents are unobstructed. Obstacles should be kept ≥ 98.4 in (2.5 m) from the exhaust vent. The wall must be able to support ≥ 22.1 lb (10 kg).
3. Ensure the ventilation ducts lead directly outdoors to prevent exhaust backflow.

Operation & Maintenance

1. Do not crush or cover power cords (e.g., under carpets).
2. Do not block air vents. Maintain a clearance of 11.8 in (30 cm) to prevent overheating.
3. Do not put your fingers or any objects into the grill. High-speed blades may cause severe injury.
4. Do not use chemicals or water for cleaning. Use a dry cloth only. Any internal repairs to the motor must be performed by a qualified professional.

Special Component Warnings

1. The remote control operates on 2 AAA batteries.
2. Do not mix old and new batteries. Remove the batteries from the unit when they are no longer in use for several months to prevent leakage.
3. Do not modify the circuit or hardwire the device yourself! For any issues, contact after-sales service. Unauthorized modifications will void the warranty.

What's in the Box

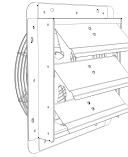

Shutter
Fan Unit
(x1)

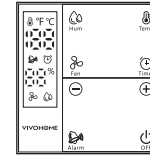

Smart Controller
(Batteries Not Included)
(X1)

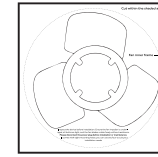

Cutout
Template
(X1)



Machine Screws
(Shutter Mount)
(X4)

TOOLS REQUIRED (not included)

	Hammer & roofing nails (or self-tapping screws)		Permanent marker / Chalk		Reciprocating saw (or jig saw)
	Caulk gun with waterproof silicone sealant		Power drill with a 1/2"-1" drill bit		Measuring tape
	Ladder (optional)		Protective goggles (optional)		Gloves (optional)

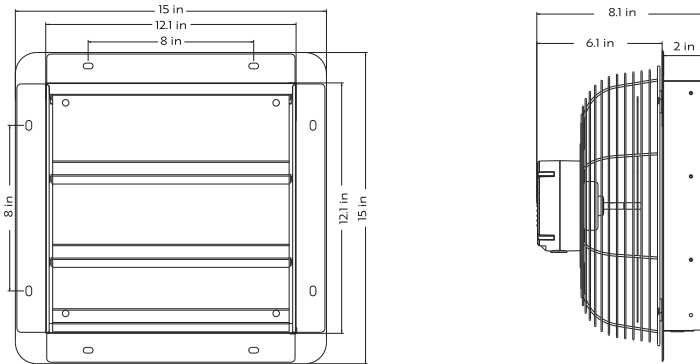

Model	VH1854
Size	15*15*7.5 in
Opening Size	12.4*12.4 in (315*315 mm)
Material	Metal
Power (Fan)	Max: 40W, Pactual: 34W±10%
Weight	GW: 9 lb (4.1 kg)/ NW: 6.4 lb (2.9 kg)
Fan Speed	1700 RPM
Airflow	1300 CFM
Noise Level	40-60 dBA
Applicable Area	1400 SQFT
Lifespan	≥20000h
Recommended Operating Temperature	-4°F-122°F
Recommended Operating Humidity	≤RH90

Warranty does not cover damage resulting from self-repair, improper installation, incorrect power connection, or unsuitable operating conditions.

STEP 1: Inspect the Fan

- Ensure the shutters open and close smoothly.
- Check that the fan blades are undamaged and rotate freely without resistance.
- Confirm all bolts and hardware are securely tightened.

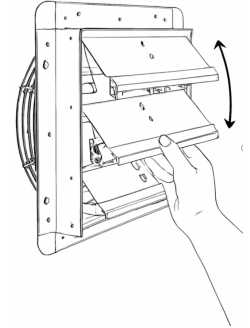

STEP 2: Test the Remote controller

- Open the remote's battery cover and insert two AAA batteries.
- Verify that the temperature and humidity sensors are working, and that all buttons respond correctly.
(To test this: set the desired temperature slightly below the ambient temperature. The fan should turn on automatically if functioning properly.)

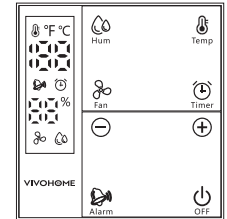

STEP 3: Choose Installation Location

- For large spaces (e.g., greenhouses, barns, or garages), install the fan on a wall opposite existing ventilation openings to achieve cross-ventilation and optimal airflow.
- Install the fan higher on the wall to help exhaust rising warm air.

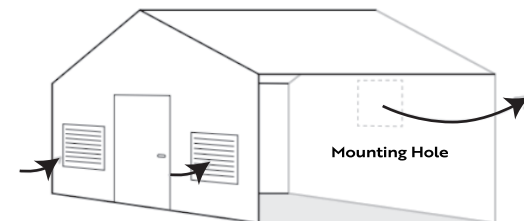

STEP 4: Prepare the Wall Opening

- Measure the shutter fan's mounting frame to determine the required opening size.
- Select a wall area free from electrical wiring or plumbing.
- Use a level and a straight edge to mark the cutting outline.
- Choose appropriate cutting tools based on your wall material.
- Using the provided cutting template as a guide, carefully cut along the marked outline to create the wall opening.

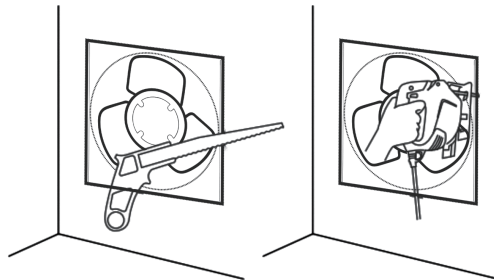
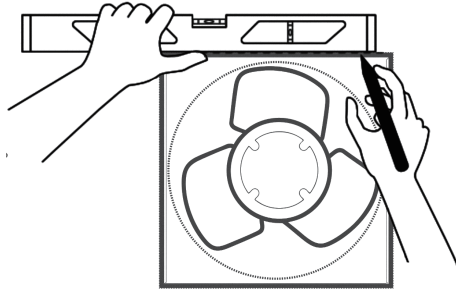

**Thinner Woods
or Plastic**

**Woods, Tougher
Plastic or, Metal**

Note: The supplied screws are not suitable for wood.

STEP 5: Drill Mounting Holes

- Test-fit the fan in the opening, mark the positions for the mounting holes, then remove it.
- Drill 4 holes (or 8 holes for added stability).

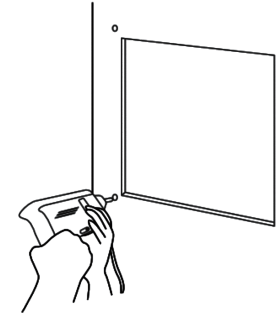

STEP 6: Install the Fan

- From inside the room, insert the fan into the opening.
- Keep the remote control and power cord inside the room.
- Secure the fan using the provided screws.

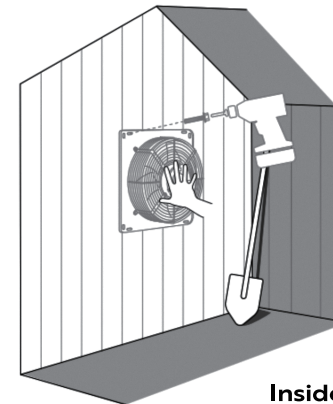

STEP 7: Power On and Test

- Plug in the fan and press "FAN" on the control panel.
- If unusual noise or vibration occurs, or if the shutters fail to open, immediately disconnect the power. Then, verify that the fan is installed level.

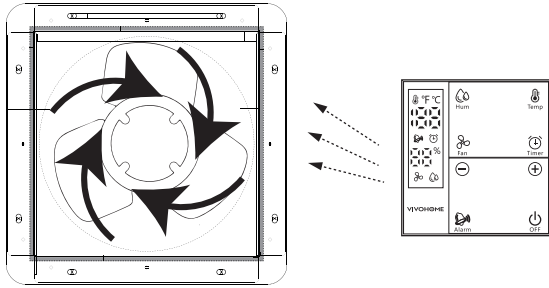

SECTION E

Remote Control Operation



Battery care: Remove batteries from the remote if it's not used for over a month to prevent leaks and circuit damage.

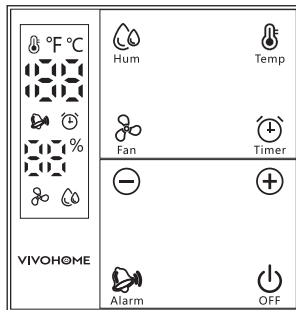









Remote Control Pairing

- Enter Pairing Mode: After powering on the main unit, there is a 35-second pairing window. A long beep signals the start of this period.
- Initiate Pairing: Within this window, press and hold the OFF button on the remote for at least 5 seconds.
- Confirm Success: A one-second long beep from the unit confirms successful pairing. If unsuccessful, power cycle the unit and repeat the above steps.
- Post-Pairing: Once paired, the remote will retain its pairing even after a power loss and can control the unit directly.
- Operation Feedback: The unit will sound a short beep when it receives a command.

Button Layout & Functions

Button	ICON	Fuction	Display Area
OFF Button		Press the OFF button once to turn off all function except for the temperature and humidity alarm settings.	
Humidity		Enter Humidity Mode. Use the +/- buttons to set a target humidity (adjustable from 30% to 90% in 10% steps). Once set, the fan will start automatically when the ambient humidity rises to your set level. The last setting is retained in memory. The display shows the set trigger humidity (default: 50%), not the real-time humidity.	
Temperature		Enter Temperature Mode. Use +/- buttons to set a target temperature (32°F-120°F / 0°C-60°C). Once set, the fan will start automatically when the ambient humidity rises to your set level. Press +/- simultaneously to switch between °C and °F. The last setting is retained in memory. The display shows the set trigger temperature (default 80°F/27°C), not the real-time temperature.	

Button	ICON	Fuction	Display Area
Alarm		Long press to enter Alarm Mode. This mode monitors both the ambient temperature and humidity. The fan will turn on automatically if either the temperature or the humidity reaches its preset alarm level (or if both are reached).	
Fan Speed		Adjust fan speed level (0-9) with +/- buttons.	
Increase		In Temperature, Humidity, or Alarm Mode, press "+" button to raise the respective setpoint; In Fan Speed Mode, press "+" button to increase the fan speed level.	
Decrease		In Temperature, Humidity, or Alarm Mode, press "-" button to lower the respective setpoint; In Fan Speed Mode, press "-" button to decrease the fan speed level.	
Timer		The timer can be set from 0 to 12 hours. The fan will automatically turn off when time expires.	

Main Mode Settings & Switching

1. Humidity Mode

Setup: Press the button once to enter Humidity Mode. Use the +/- buttons to set a target humidity (adjustable from 30% to 90% in 10% steps). Once set, the fan will start automatically when the ambient humidity rises to your set level.
Note: When triggered, the fan runs at its current speed setting. To change the fan speed, you must adjust the speed first and then re-enter Humidity Mode for the new speed to take effect.

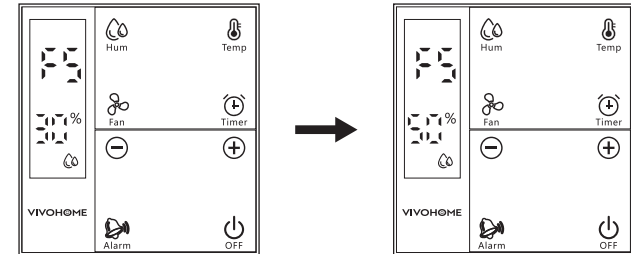

Note: In the display screen, the top indicates the fan speed level, and the bottom shows the set humidity value.

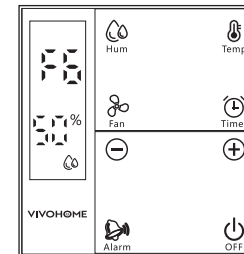

Turning Off the Mode: To exit this mode, press the Hum button again. Alternatively, press the OFF button to turn the entire unit off. (The last set humidity value is retained in memory. When you re-enter Humidity Mode, it will recall this previous setting.)

How it Operates: The fan turns on when humidity reaches the set level. The fan turns off only when humidity drops to 3% below the set level.

Note: This 3% buffer prevents the fan from cycling on and off too frequently.

2. Temperature Mode

Setup: Press the button once to enter Temperature Mode. Use the +/- buttons to set a target Temperature (adjustable from 32°F-120°F / 0°C-60°C in 1 °F / °C steps). Once set, the fan will start automatically when the ambient temperature rises to your set level.

Note: When triggered, the fan runs at its current speed setting. To change the fan speed, you must adjust the speed first and then re-enter Temperature Mode for the new speed to take effect.

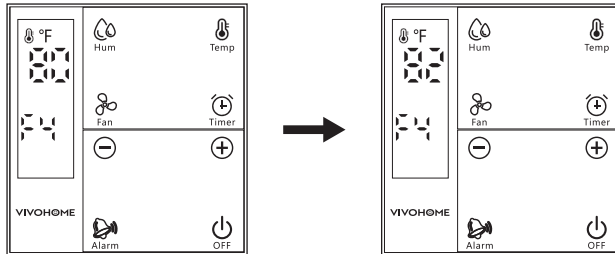

Note: In the display screen, the top indicates the set temperature value, and the bottom shows the fan speed level.

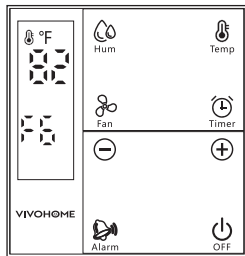

Turning Off the Mode: To exit this mode, press the Temp button again.

Alternatively, press the OFF button to turn the entire unit off.

(The last set temperature value is retained in memory. When you re-enter Temperature Mode, it will recall this previous setting.)

How it Operates: The fan turns on when temperature reaches the set level.

The fan turns off only when temperature drops to 3% below the set level.

Note: This 3% buffer prevents the fan from cycling on and off too frequently.

3. Alarm Mode

Setup: Press and hold the Alarm button for 3 seconds. Once activated, the main unit will emit a one-second long beep and the alarm bell icon will light up.

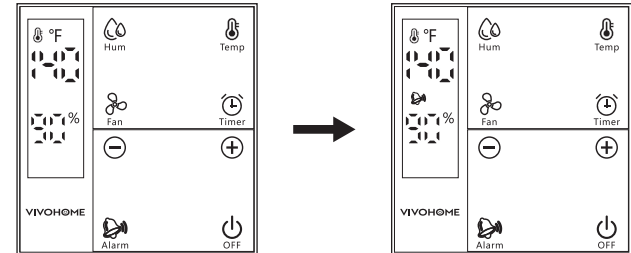

To set the humidity alarm level (default: 90%), press the Alarm button once. Use the +/- buttons to adjust the desired humidity level. Once set, stop pressing buttons. After a 3-second delay, the % icon stops blinking, indicating the new humidity alarm value is set and saved.

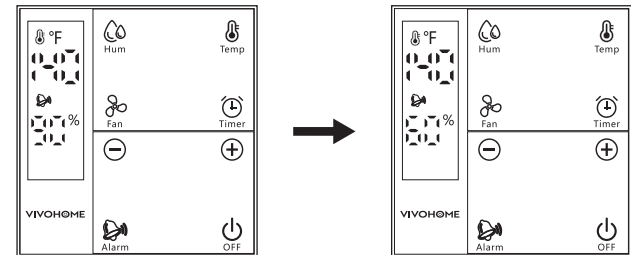

To set the temperature alarm level (default: 140°F), press the Alarm button once again. Use the +/- buttons to adjust the desired temperature level. Once set, stop pressing buttons. After a 3-second delay, the °F icon stops blinking, indicating the new temperature alarm value is set and saved.

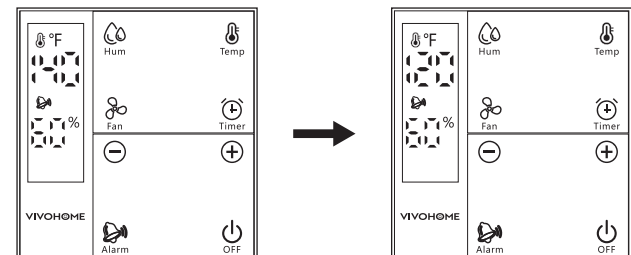

Cycling Between Alarms: Short press the Alarm button to cycle between Humidity Alarm and Temperature Alarm. During setup, the corresponding icon (% or °F) will blink. While blinking, pressing the Alarm button again immediately switches to the other alarm setting. You can cycle between and adjust both settings sequentially until you are finished.

Note: If you switch to another functional mode (e.g., by pressing the Temp or Fan button) during the setup process, any currently entered alarm value will be automatically saved. The Temperature and Humidity Modes can be activated concurrently with Alarm Mode. The alarm bell icon will remain steadily lit.

To Deactivate Alarm Mode: Press and hold the Alarm button for approximately 3 seconds. The main unit will emit a long beep, and the alarm bell icon will turn off. This indicates that the alarm function has been fully deactivated.

Alarm Trigger & Response

When the ambient temperature or humidity exceeds its set alarm value, an alarm will be triggered with the following responses:

- Audible & Visual Alert: The main unit emits a rapid series of beeps ("beep, beep, beep, beep"), and a red indicator light flashes.
- Fan Action: The fan immediately starts and runs at the last manually set fan speed.
- Alarm Duration: The alarm buzzer will sound continuously for 3 minutes.
- After 3 Minutes: The audible alarm stops, but the fan continues to run until the ambient temperature or humidity falls back below the set alarm threshold.
- Subsequent Trigger: If the alarm condition is met again, the audible and visual alert repeats for another 3 minutes.
- Setting Memory Feature: When Alarm Mode is turned off, the remote remembers the last set temperature and humidity alarm values.

Note: This memory function is retained by the remote's battery power. If the remote loses power (e.g., batteries are removed), all custom settings will be reset to factory defaults.

4. Fan Speed Setting

To Turn On: Press the Fan button once to enter Manual Fan Mode. The fan will start. The remote display will show the current speed level (F1-F9). Press the +/- buttons to select your desired speed level.

To Turn Off: Press the Fan button again to exit Manual Fan Mode and turn the fan off. The last fan speed setting is saved in memory. When the fan is automatically triggered by Temperature, Humidity, or Alarm Modes, it will run at this memorized speed level.

5. Timer Function

To Turn On: While in Manual Fan Mode, press the Timer button to activate the timer. The timer icon will light up, and the fan icon will turn off. The timer setting is now active. The fan will run for the set duration and then automatically shut off, and the remote will clear the timer icon. The current fan speed level is retained in memory.

Note: The timer function is only available in Manual Fan Mode (it is not available in Temperature, Humidity, or Alarm Modes).

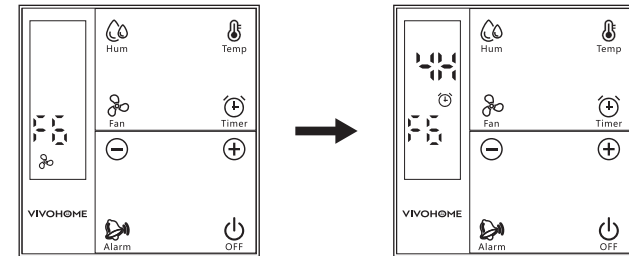

Setting: The remote display shows the timer duration (1H-12H, in 1H steps). Use the +/- buttons to set the desired time. Each time you activate the timer, it recalls the last setting.

To Turn Off: Press the Timer button again to turn off the timer function. The timer icon will turn off.

Note: When the timer icon is active and you press the Fan button to enter Manual Fan Mode, the fan icon will light up (the timer icon remains on). In this state, you can use the +/- buttons to adjust the fan speed level.

6. Mute Setting

Press and hold both the Alarm and OFF buttons simultaneously.

- Beep Off: Indicated by three short beeps ("beep, beep, beep").
- Beep On: Indicated by one short beep.

Note: This does not affect the alarm buzzer, which will always sound when an alarm is triggered.



Problem	Possible Cause	Solution
In temperature or humidity mode, the fan operates continuously.	The main unit is no longer in temperature or humidity mode; it is currently operating in manual mode.	To enter the mode, press the temperature or humidity button again when its icon is off.
	The unit enters alarm mode when either the temperature or humidity exceeds the set threshold.	Press and hold the Alarm button to exit Alarm Mode.
The fan fails to exhaust.	Insufficient airflow intake.	1. Install the shutter fan opposite existing ventilation; 2. Install the fan at a higher location.
	CFM is too low for the room size.	Ensure the fan's CFM rating is sufficient for the room's square footage.



- Q** Why doesn't the device switch functions when I press the button after the screen is off?
- A** After any function is enabled, the icon will remain displayed for 10 seconds and then turn off. Pressing any button at this point wakes up the display to show the current status icon; it does not change the function.
- Q** Why is the alarm icon still displayed after the timer expires?
- A** The alarm mode can only be turned off by long-pressing or by reaching a trigger value; other functions cannot disable the alarm function.
- Q** Can the main unit be controlled by two remote controls?
- A** The main unit can only be controlled by one remote control. Pairing a new remote control will automatically unpair and disable the previous one.
- Q** Why does the fan keep running even when the temperature or humidity is below the trigger value?
- A** To prevent short-cycling (frequent on/off operation), the fan is designed to continue running until the temperature or humidity drops 3% below the trigger value. It will then stop automatically.



The VIVOHOME warranty program is our commitment to you. We are committed to providing you with a high-quality product that meets your needs and expectations. To demonstrate our confidence in the durability and performance of our products, we offer the following warranty.

WARRANTY COVERAGE

This warranty applies to all orders, purchases, or use of products sold only by VIVOHOME and is valid for 1 year from the purchase date. Please note, this warranty only covers the original order. If a replacement is provided within the warranty period, it does not extend the warranty.

WARRANTY EXCLUSIONS

This warranty does not cover damages caused by misuse, accidents, unauthorized modifications, or any factors unrelated to product manufacturing and design, including but not limited to:

- Loss of parts during use.
- Normal wear and tear of products or parts.
- Incorrect installation (e.g., using the wrong voltage) or improper assembly.
- Overloading the product's bearing capacity.
- Usage in extremely harsh conditions.
- Improper cleaning or lack of maintenance.
- Damage resulting from unintended use of the product.
- Damage resulting from unauthorized modifications or service.
- Indirect losses or damages related to the product.



HOW TO MAKE A WARRANTY CLAIM

If you encounter any defects affecting the product's functionality or if the product fails and cannot be repaired during the warranty period, please reach out to our customer service team via email, or our app's messaging service at your earliest convenience. To expedite your claim, kindly include:

- Order number
- Photos and/or videos illustrating the issue
- A detailed description of the problem

VIVOHOME will provide technical support, replacement, refund, or other solutions based on the issue's specifics. If you wish to return the original package for any reason, please contact us for confirmation before initiating the return. You can expect a response within 48 hours.

Thank you for choosing VIVOHOME. We are dedicated to ensuring your satisfaction and the quality of your purchase. If you have any questions or need further assistance, please don't hesitate to reach out to our customer service team.