

Instruction Manual Smart Switch

Wi-Fi+RF433 Single Live

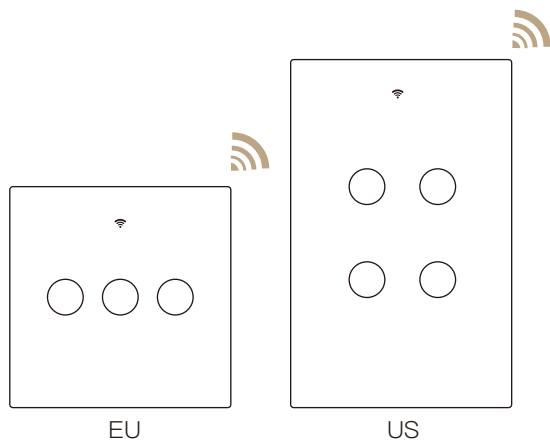

English



- Bitte scannen Sie den QR-Code hier für eine Anleitung in deutscher Sprache
- Por favor escanear el código QR aquí para instrucciones en español
- Veuillez scanner le QR code ici pour des instructions en français
- Пожалуйста, отсканируйте QR-код здесь, чтобы получить инструкции на русском языке.
- Leia o código QR aqui para obter instruções em português

English 1

Product Description

This new designed glass panel wireless touch smart switch is designed with WiFi+RF to replace traditional switches with a variety of ways to control. Now one new smart feature as multi-control association to other smart switches is added into the Smart Life/Tuya App, together with the backlight on/off and relay status. And its scratch resistance glass panel is suitable for different decoration styles with its best value.

Note: Button sound on and off: no button operations before operations begin within 6 seconds. Then press switch button for 4 times and long press for the fourth time until the switch beep sounds as Di-Di for 2 times for successful operation.

Safety Information

Risk of Electric Shock: Electricity can cause personal injury and property damage if handled improperly. If you are not sure about any part of these instructions, please seek professional assistance from a qualified electrician.

Technical Parameters:

Model: WS-EU-RF / WS-US-RF
Voltage: US: 90-130V AC, 60Hz/200-240V AC, 50Hz
EU: 200-240V AC, 50Hz
Max. current: 2.5A/Gang; Total 2.5A
Wireless protocol: Wi-Fi 2.4GHz+RF433MHz

Warnings:

Turn off the power at the circuit breaker and test that power is off before wiring.

Installation

Note:

- Install the switch with electricity off.
- Do not install in damp environment.
- Neutral wire is not required (single live line).
- Do not exceed the maximum load.
- Please follow instructions and properly install.
- If you don't have any wiring experience, please call a professional electrician.

Step 1

- Turn off the circuit breaker and use the electrical tester to test the power.
- Ensure the circuit breaker is off before wiring.



Attention:

Please disconnect the power supply before installing or removing the device for avoiding irreversible damage on the device from the electric current or some unpredictable problems such as lamp flashing.

Step 2

- Remove the old switch

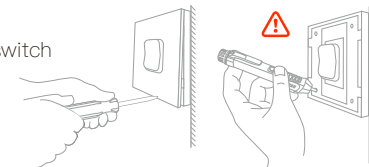

Step 3

- Remove the switch and pull it away from the wall. Identify Line/Load Wire (Note: The color of your wire may be different from the color shown on the manual.)

Verify power is off

- We recommend you remove the faceplate from the old switch and use an electrical tester to test all wires connected to the switch to ensure there is no voltage in the circuit.
- You may need to turn off more than one circuit breaker.

Step 4

- Take pictures of the wiring

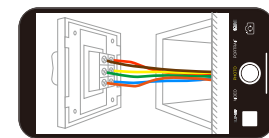

- Follow the wiring diagram to connect the switch wires to the wires in the wall box with the wire conductors.

Step 5

- Remove the panel with screwdriver (Please don't install with electricity power on)

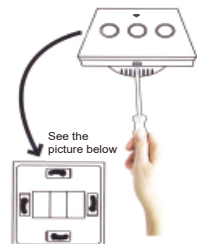

Step 6

- Prepare to install wiring
- A. Live wire connects "L" terminal
- B. Lamp wire connects "L1,L2,L3,L4" terminal
- 1 Gang connects "L1" terminal
- 2 Gang connects "L1,L2" terminal
- 3 Gang connects "L1,L2,L3" terminal
- 4 Gang connects "L1,L2,L3,L4" terminal

Capacitor Installation

- When the lamp lights or starts flashing, Please connect Capacitor as shown in the drawing:
- 1 Gang L1 and N line.
- 2 Gang L1 and N line.
- 3 Gang L1 and N line.
- 4 Gang L1 and N line.

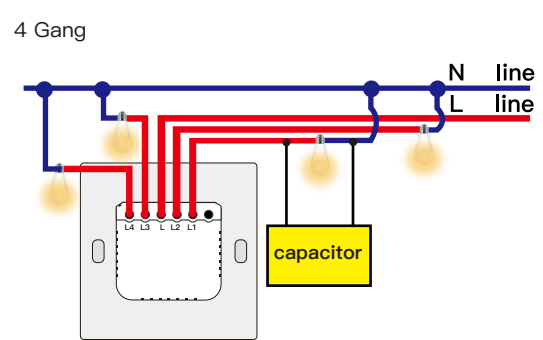
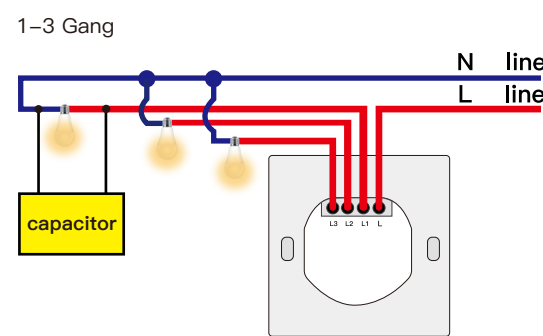

English 5

2

English

Step 7

- Put the switch into switch box in the wall
- Mount the two side screws
- Install the glass panel (install from up above)
- Finish installation

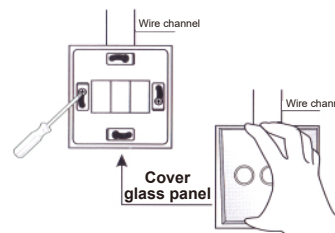

English 7

3

Add Devices

1 Download Smart Life App



Please scan the QR code or download Smart Life on App store.

2 Registration or Log in

- Download "Smart Life" Application
- Enter the Register/Login interface; tap "Register" to create an account by entering your phone number to get verification code and "Set password". Choose "Log in" if you already have a Smart Life account.

3 Configure the APP to the switch

- Preparation: Ensure the switch has been connected with electricity, ensure your phone has been connected to Wi-Fi and is able to connect to the Internet.

Note:

The switch only supports 2.4G network. If you have connected 5G network, please disconnect 5G network firstly and connect 2.4G network.

English 8

Wi-Fi link method:

1. Make sure your phone is connected to Wi-Fi and Bluetooth.
2. Open Smart Life/Tuya App and Click "+", then the prompt page will automatically show on the screen. Click "Go to add".

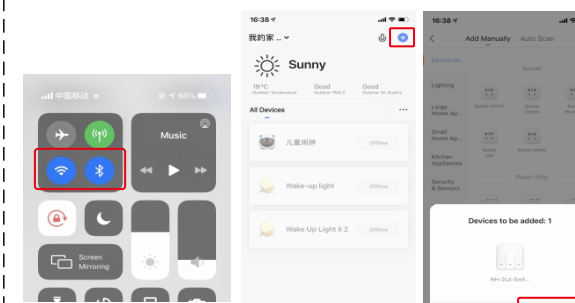

- (1)
- (2)

3. Select the device you want to add and click "Add"

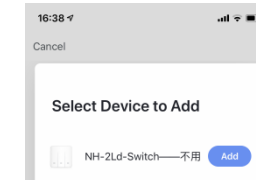

English 9

4. Enter Wi-Fi Password and click "Confirm", waiting for completing the connection.

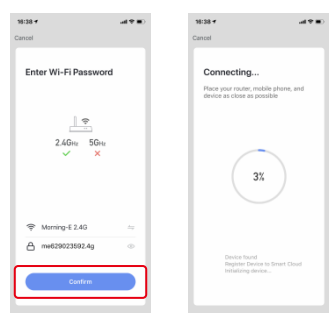

5. Add the device successfully, you can edit the name of the device to enter the device page by click "Done"

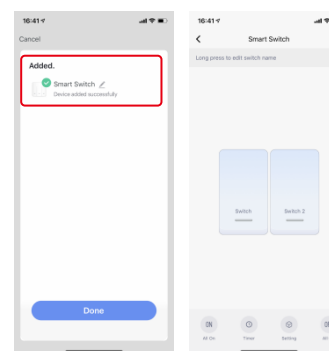

English 10

How to reset/re-pair Wi-Fi code

Press the switch button for 6 times, and hold on the 6th time, then release until you hear Di-Di-Di (3 times), and the blue indicator on the switch will flash fast after 3 seconds. Reset/re-pair is successful.

Remote radio frequency (RF) link method:

Pair and clear up the RF code

1. How to pair the RF code

1.1 (can be turned on and off): Confirm your switch is off before operations. Press the switch button for about 8 seconds until you hear Di-Di (2 times). Then the matching of RF code is successful. The key of the remote controller can control the switching of the state of the switch on and off corresponding to the position of the switch.

1.2 (Open only): Confirm your switch is off before operations. Press the switch button for about 5 seconds until you hear Di (1 time). After that, release the button, press the corresponding button on the remote control to turn on. Then the matching of RF codes is successful. The key of the remote controller can control the corresponding position of the switch to be open.

1.3 (Close only): Confirm your switch is on before operations. Press the switch button for about 5 seconds until you hear Di (1 time). After that, release the button, press the corresponding button on the remote control to turn on. Then the matching of RF codes is successful. The key of the remote controller can control the corresponding position of the switch to be closed.

2. How to clear up the RF code

Confirm your switch is off before operations. Press the switch button for a long time until you hear Di-Di-Di (4 times), and then release the button. The RF code is now cleared up.

English 11

Enter Smart Life Skill in Alexa APP

1. Complete product networking configuration in the App

Complete the device's networking configuration according to the prompts in the App. Note: In the App, change the name of the device to an easily identifiable name such as Alexa; names are usually in English, such as "bed light".

2. Configure the Amazon Echo device

(If you have already configured Amazon Echo, you can skip this step. The following instructions are based on the iOS client.)

- Make sure your Amazon Echo device is powered on and connected to a Wi-Fi network.
- Open the Alexa App on your phone. After successful login, tap on the menu in the upper left corner of the Home page, select "Settings" and tap "Set Up A New Device" to set up the Amazon Echo.
- Choose your Amazon Echo device type and language for connecting. Press and hold the small dot on the device until the light turns yellow. Then tap "Continue" to connect to the hotspot.
- After connecting to the Amazon Echo hotspot, return to the page. At this point, the connection is successful.

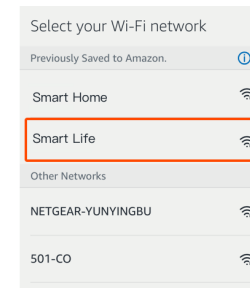
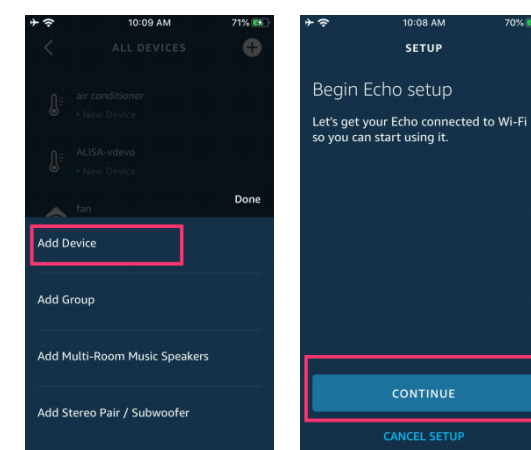

English 13

Tap "Continue" to proceed to the next step. Choose a Wi-Fi network to connect to. Amazon Echo will take a few minutes to try to connect to the network.

- After the network connection is successful, tap "Continue". An introduction video will appear. After the video ends, tap "Continue" to jump to the Alexa Home page. You have now completed the Amazon Echo's configuration process.

3. Key step — Link Skill

- Tap on "Skills" in the Alexa App menu.

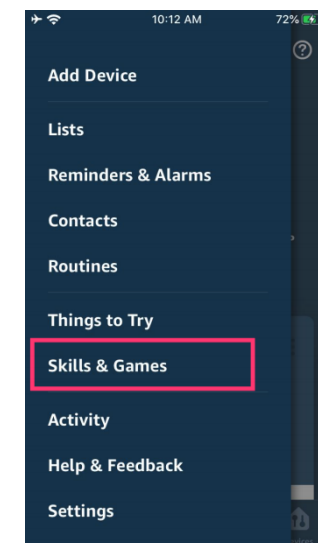

English 14

- Then search for "App Name". Tap "Enable" to enable the Skill.
- Enter the App account and password, then tap "Link Now" to link your App account to enable the Skill. Now you can start your smart home journey.

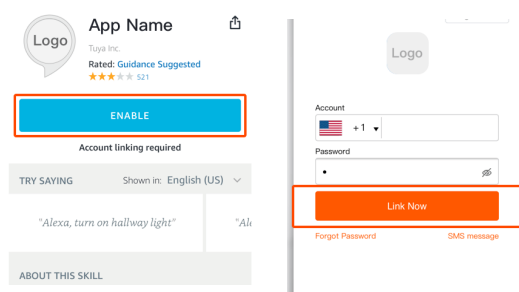

4. Common commands

Control the device via voice commands, now you can control your smart device with Echo. You can control your device (such as your bedroom light) with the following commands:

- Alexa, turn on/off bedroom light. (Turn on/off the light)
- Alexa, set bedroom light to 50 percent. (Set the light to any brightness)
- Alexa, brighten/dim bedroom light. (Increase/weaken the brightness of the light)
- Alexa, set bedroom light to green. (Adjust the color of the light)

English 15

SERVICE

1. During the free warranty period, if the product breaks down during normal use, we will offer free maintenance for the product.
2. Natural disasters/man-made equipment failures, disassembly and repair without the permission of our company, no warranty card, products beyond the free warranty period, etc., are not within the scope of free warranty.
3. Any commitment (oral or written) made by the third party (including the dealer/service provider) to the user beyond the warranty scope shall be executed by the third party.
4. Please keep this warranty card to ensure your rights.
5. Our company may update or change the products without notice. Please refer to the official website for the updates.

RECYCLING INFORMATION

All products marked with the symbol for separate collection of waste electrical and electronic equipment (WEEE Directive 2012/19 / EU) must be disposed of separately from unsorted municipal waste. To protect your health and the environment, this equipment must be disposed of at designated collection points for electrical and electronic equipment designated by the government or local authorities. Correct disposal and recycling will help prevent potential negative consequences for the environment and human health. To find out where these collection points are and how they work, contact the installer or your local authority.



English 16

WARRANTY CARD

Product Information

Product Name _____
Product Type _____
Purchase date _____
Warranty Period _____
Dealer Information _____
Customer's Name _____
Customer Phone _____
Customer Address _____

Maintenance Records

Failure date	Cause Of Issue	Fault Content	Principal

English 17

Thank you for your support and purchase at we Moes, we are always here for your complete satisfaction, just feel free to share your great shopping experience with us.



If you have any other need, please do not hesitate to contact us first, we will try to meet your demand.

FOLLOW US



WENZHOU NOVA NEW ENERGY CO., LTD
Address: Power Science and Technology Innovation Center, NO.238, Wei 11 Road, Yueqing Economic Development Zone, Yueqing, Zhejiang, China
Tel: +86-577-57186815
Email: service@moeshouse.com

AMZLAB GmbH
Laubenhof 23, 45326 Essen
Made In China

English 18

English 19