



## EN ■ Cordless Stick Vacuum Cleaner All in One

*Translation of the original manual*

**READ CAREFULLY AND STORE FOR FUTURE USE.****Important safety instructions**

- This vacuum cleaner may be used by children 8 years of age and older and by persons with physical, sensory, or mental impairments or by inexperienced persons, if they are properly supervised or have been informed about how to use this vacuum cleaner in a safe manner and understand the potential dangers.
- Children must not play with the vacuum cleaner. Cleaning and maintenance performed by the user must not be performed by unsupervised children.
- If the power adapter is damaged, it must be replaced with an original type. For a replacement power adapter, please contact an authorised service centre. It is forbidden to use the appliance if it has a damaged power adapter.

**WARNING :**

Avoid coming into contact with the rotating parts of the vacuum cleaner's hand accessories. There is a risk of getting caught on these parts and possible injury.

Only use the vacuum cleaner with the original power adapter, charging base and accessories that were supplied with it.

- This vacuum cleaner is designed for use in households, offices and similar types of areas. Do not use in industrial surroundings.
- Do not expose the vacuum cleaner to direct sunlight and do not place it near an open fire or appliances that are a source of heat.
- Before connecting the adapter to a power socket, check that the technical details on its rating label match the electrical voltage in the power socket.
- Make sure the adapter power cord is not touching a hot surface or sharp objects. Position the adapter power cord so that it will not be tripped over.
- Never submerge the vacuum cleaner, the charging base and the power adapter in water or any other liquid and do not wash under running water.
- Before turning on the vacuum cleaner, make sure that all the inflow and outflow filters are installed in their place.
- When the vacuum cleaner is running, ensure that the air outlets and the suction hole are not blocked.
- Do not use the vacuum cleaner to vacuum the following items:
  - smouldering cigarettes, burning items, matches or embers;
  - water and other liquids;
  - flammable or volatile materials;
  - items, e.g. broken glass, needles, pins, etc.;
  - flour, wall plaster, cement and other building materials;
  - larger pieces of paper or plastic bags, which can easily block the suction hole.
- Vacuuming of some types of floors or floor surfaces can create an electrostatic discharge, which presents no danger to the user.
- Do not use the TURBO function when you use the vacuum cleaner for wet cleaning
- Always turn off the vacuum cleaner when leaving it without supervision, after finishing using it and before cleaning it.
- Disconnect the power adapter from the power socket before cleaning it and after it has finished charging.
- Disconnect the power adapter from the power socket by pulling on the plug, never pull on the power cord. Otherwise, this could damage the power adapter or the socket.
- If the power adapter is damaged, it must be replaced with an original type. For a replacement power adapter, please contact an authorised service centre.
- Do not use the vacuum cleaner if it is not working correctly if it has been damaged or has been submerged in water.
- Do not repair the vacuum cleaner yourself or make any adjustments to it. Have all repairs performed at an authorised service centre. By tampering with the appliance, you risk voiding your legal rights arising from unsatisfactory performance or quality warranty.

A

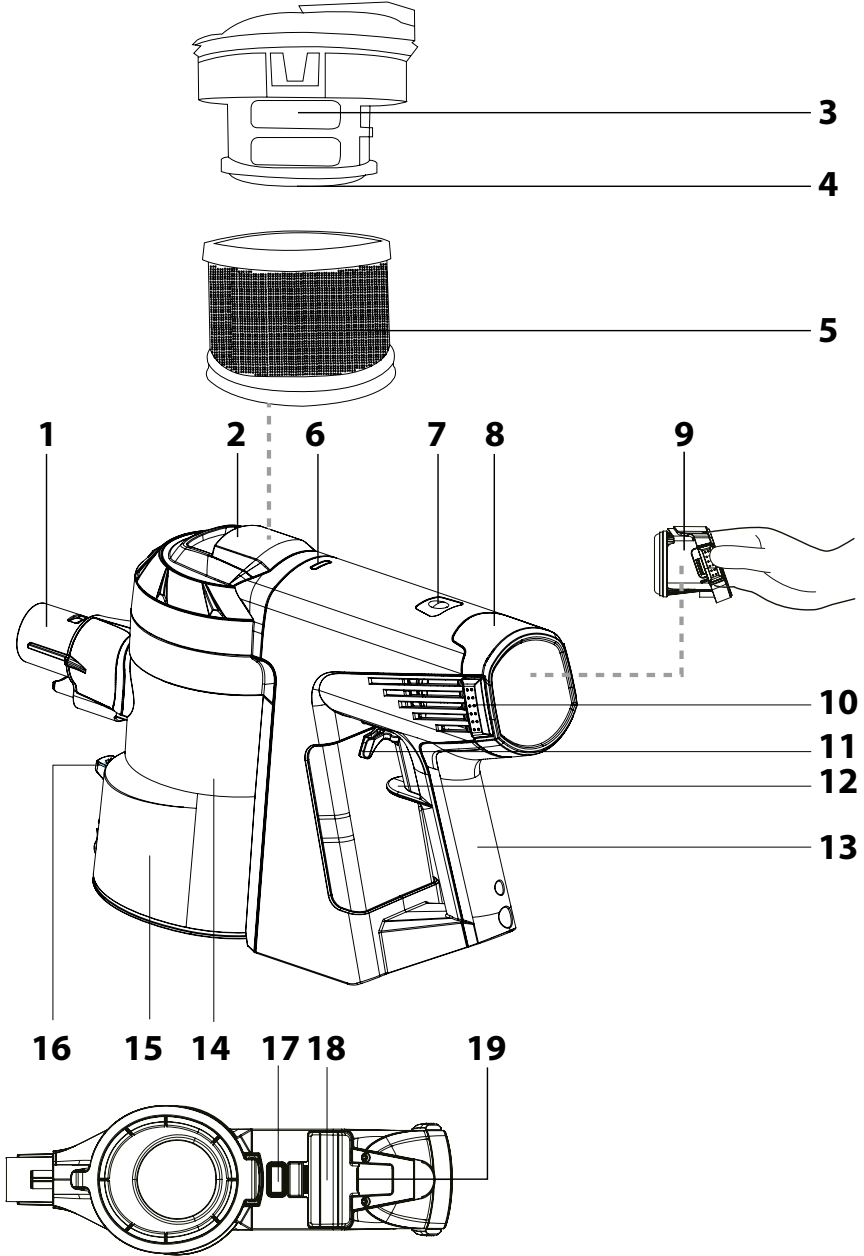

**B**

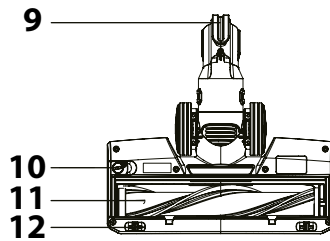
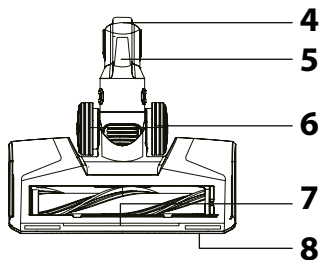
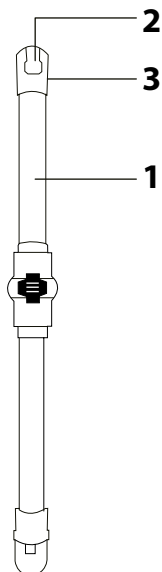

C

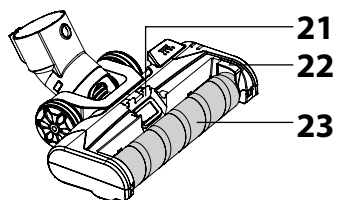
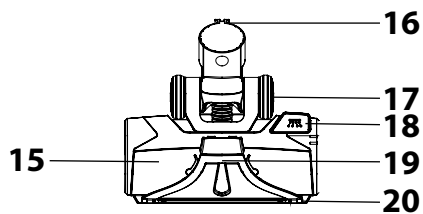
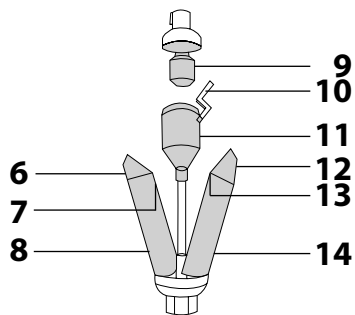
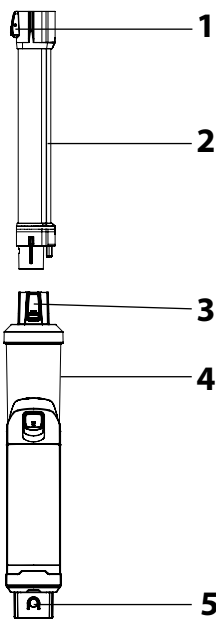

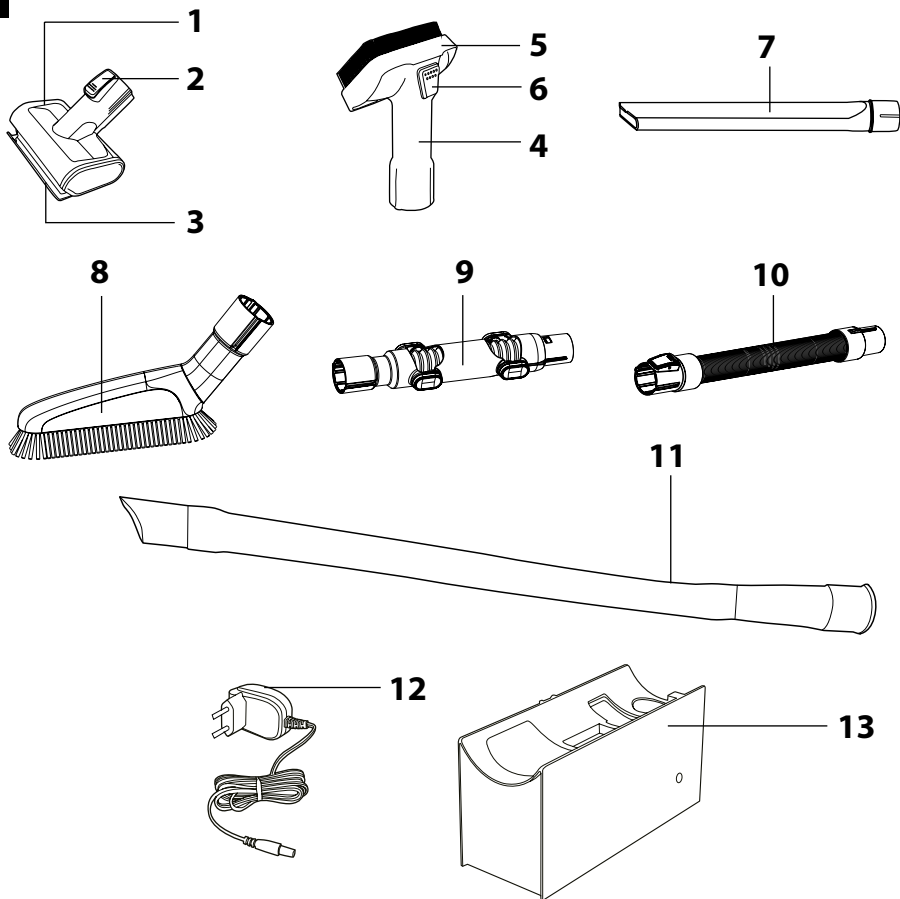
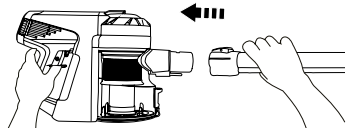
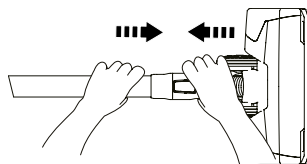
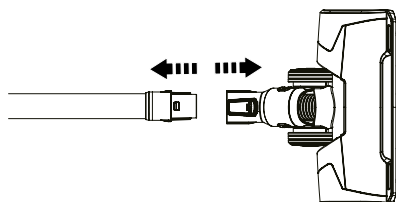
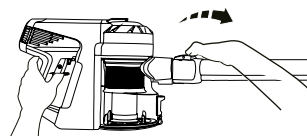
**D****E1****E2****E3****E4**

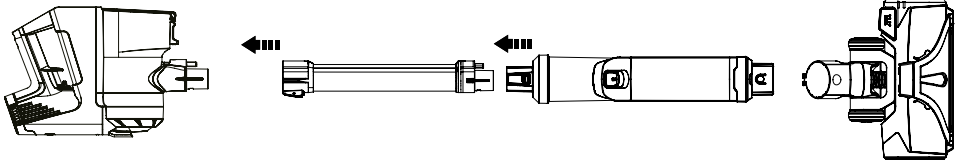
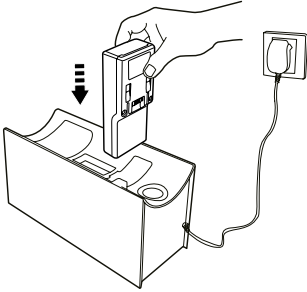
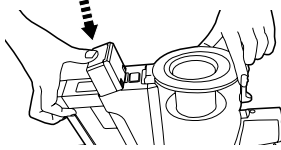
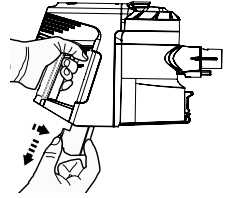
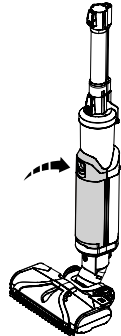
**F****G1****G2****G3****H1****H2****H3**

11

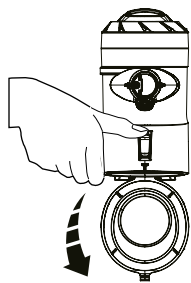

12

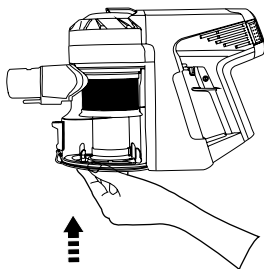

13

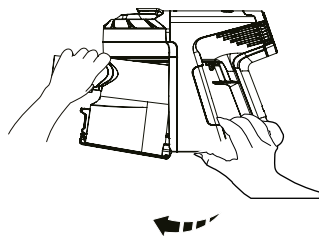

14

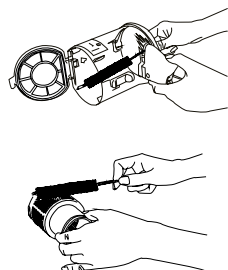

15

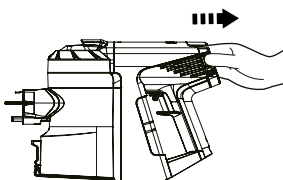

16

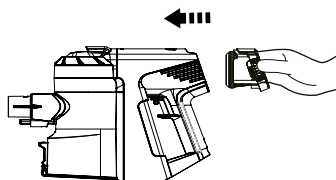

17

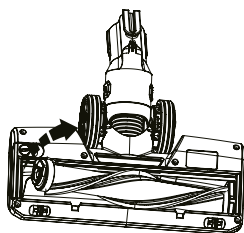

18

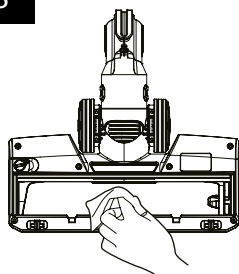

19

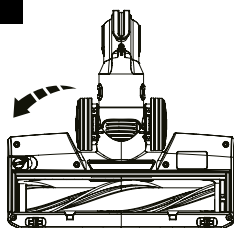

J1

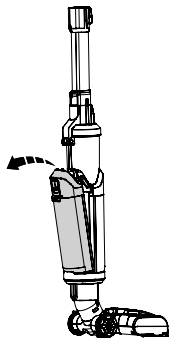

J2

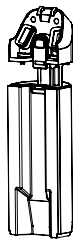

J3

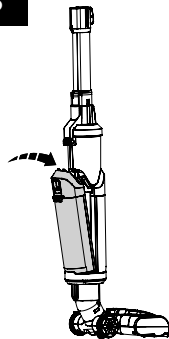

J4

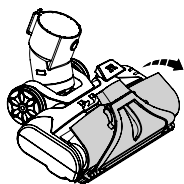

J5

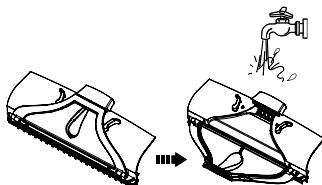

J6

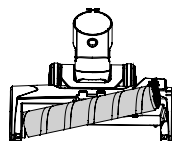

J7

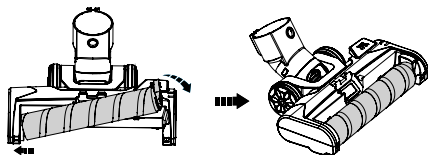

J8

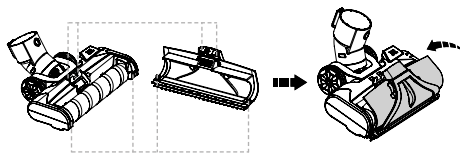

J9

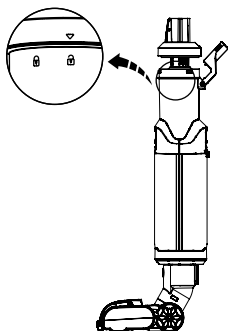

J10

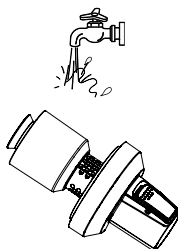

# EN Cordless Stick Vacuum Cleaner All in One

## User's manual

### DESCRIPTION OF THE VACUUM CLEANER

#### DESCRIPTION OF THE MOTOR UNIT

- |  |  |
|--|--|
| <b>A1</b> Output hole of the motor unit                | <b>A11</b> Switch lock   |
| <b>A2</b> Inflow filters cover                         | <b>A12</b> On / Off switch   |
| <b>A3</b> Foam inner inflow filter                     | <b>A13</b> Handle  |
| <b>A4</b> Inner inflow filter holder                   | <b>A14</b> Filter unit of the dust container                                     |
| <b>A5</b> Outer inflow filter                          | <b>A15</b> Transparent dust container  |
| <b>A6</b> Operation LED light                          | <b>A16</b> Release button of the dust container bottom for quick removal of dirt |
| <b>A7</b> TURBO button (operation at maximum power)    | <b>A17</b> Dust container release button   |
| <b>A8</b> Outflow filter cover                         | <b>A18</b> Rechargeable battery (2 pc in packaging)                              |
| <b>A9</b> Outflow filter                               | <b>A19</b> Battery release button  |
| <b>A10</b> Cover release locks (located on both sides) |  |

#### DESCRIPTION OF THE STICK VACUUM CLEANER

- |   |   |
|---|---|
| <b>B1</b> Articulated tube                            | <b>B8</b> Protective rubber guard                             |
| <b>B2</b> Articulated tube lock                       | <b>B9</b> Stopper for vertical parking position               |
| <b>B3</b> Joint release locks (located on both sides) | <b>B10</b> Lock to release the side cover of the rotary brush |
| <b>B4</b> Floor nozzle                                | <b>B11</b> Rotary brush of the floor nozzle                   |
| <b>B5</b> Floor nozzle release lock                   | <b>B12</b> Additional castors of the floor nozzle             |
| <b>B6</b> Castors                                     |   |
| <b>B7</b> Floor nozzle light                          |   |

#### DESCRIPTION OF THE WET CLEANING VACUUM CLEANER

- |   |  |
|---|--|
| <b>C1</b> Lock to release the motor unit  | <b>C14</b> Dirty water tank                                |
| <b>C2</b> Short tube  | <b>C15</b> Wet cleaning nozzle                             |
| <b>C3</b> Lock to release the short tube  | <b>C16</b> Stopper for vertical parking position           |
| <b>C4</b> Wet cleaning attachment   | <b>C17</b> Castors   |
| <b>C5</b> Lock to release the wet cleaning nozzle   | <b>C18</b> Button to release the clean water from the tank |
| <b>C6</b> Lock to release the clean water tank  | <b>C19</b> Front cover                                     |
| <b>C7</b> Clean water tank lid (located on the inner side of the tank)                                    | <b>C20</b> Protective rubber guard                         |
| <b>C8</b> Clean water tank  | <b>C21</b> Protrusions for attaching the front cover       |
| <b>C9</b> Filter unit   | <b>C22</b> Lock to release the soft rotary brush           |
| <b>C10</b> Lock to release the filter unit  | <b>C23</b> Soft rotary brush                               |
| <b>C11</b> Collecting tank  |  |
| <b>C12</b> Lock to release the dirty water tank   |  |
| <b>C13</b> Lock to release the upper part of the dirty water tank (located on the inner side of the tank) |  |

#### DESCRIPTION OF THE ACCESSORIES

- |  |                                 |
|--|---------------------------------|
| <b>D1</b> Cat&Dog motorised mini brush                         | <b>D7</b> Crevice nozzle        |
| <b>D2</b> Lock to release the mini brush                       | <b>D8</b> Soft brush            |
| <b>D3</b> Movable protective cover                             | <b>D9</b> Articulated connector |
| <b>D4</b> Multipurpose attachment for upholstery and furniture | <b>D10</b> Flexible hose        |
| <b>D5</b> Removable brush                                      | <b>D11</b> Long crevice nozzle  |
| <b>D6</b> Lock to release the attachment                       | <b>D12</b> Power adapter        |
|  | <b>D13</b> Charging base        |

### ASSEMBLY AND DISASSEMBLY OF THE VACUUM CLEANER

#### 1. ASSEMBLY AND DISASSEMBLY OF THE STICK VACUUM CLEANER

Attach the articulated tube **B1** to the outlet hole **A1** of the motor unit – see picture **E1**.

Attach the floor nozzle **B4** to the second end of the articulated tube **B1** – see picture **E2**.

When you need to disassemble the stick vacuum cleaner, press the lock **B5** to remove the floor nozzle **B4** – see picture **E3**. Then press the lock **B2** to remove the articulated tube **B1** – see picture **E4**.

#### 2. ASSEMBLY AND DISASSEMBLY OF THE WET CLEANING VACUUM CLEANER

Attach the wet cleaning nozzle **C15** to the bottom hole of the wet cleaning attachment **C4** until it clicks. Attach the short tube **C2** to the upper hole of the wet cleaning attachment **C4** until it clicks. Attach the motor unit to the short tube **C2** – see picture **F**.

When you need to disassemble the wet cleaning vacuum cleaner, press the lock **C1** and carefully remove the motor unit. Then press the lock **C3** and remove the short tube. Press the lock **C5** and remove the wet cleaning nozzle **C15**.

### 3. ASSEMBLY AND DISASSEMBLY OF THE VACUUM CLEANER WITH ACCESSORIES

To ensure perfect cleaning of your home, you can attach any of the supplied accessories to the output hole **A1** of the motor unit. Simply remove the accessory by pulling it out of the output hole **A1** of the motor unit. Press the lock **D2** first to remove the mini brush **D1**. Press the lock **D6** first to remove the multipurpose attachment **D6**.

#### 1) Cat&Dog motorised mini brush

Cat&Dog motorised mini brush is the ideal helper for removing animal fur, hair, etc., while at the same time being suitable for vacuuming hard-to-reach places. Its use is not limited to the home and can be used for vacuuming the car. It quickly and effectively removes hair, animal fur and other materials from car seats, upholstery, pillows, and other textile surfaces.

#### 2) Multipurpose attachment for upholstery and furniture

Thanks to the soft bristles, the attachment is ideal for removing dirt from fine surfaces, such as furniture, upholstery, net curtains, curtains, etc.

#### 3) Crevice nozzle

It is suitable for vacuuming hard to reach places (e.g., window frames, corners, libraries, spaces between mattresses, upholstery, etc.).

#### 4) Soft brush

It is ideal for vacuuming dirt and dust from fragile objects, libraries, walls, blinds, etc.

#### 5) Long crevice nozzle

It is ideal for vacuuming hard to reach places, such as behind the heating or in the car.

#### 6) Articulated connector and flexible hose

Attach the articulated connector **D9** or flexible hose **D10** to the output hole **A1** when you need to extend the reach of the used accessory, e.g., you need to vacuum dust on the wardrobe.

### CHARGING THE BATTERY

- The stick vacuum cleaner SVC 0825WH is supplied with two batteries.
- Place the charging base **D13** on a flat, dry, and stable surface within reach of a power socket.
- Attach the connector of the power adapter **D12** to the socket located on side of the charging base **D13** and insert the adapter plug into the power socket.
- Insert the battery **A18** into the charging base **D13** – see picture **G1**.



#### Warning:

Never insert the battery **A18** in the opposite way or with great force. There is a risk of damage.

#### Tip:

This vacuum cleaner contains a built-in Li-ion battery. To ensure the longest possible lifetime of the battery, we recommend:

- do not unnecessarily leave the battery fully charged or completely flat for too long,
- do not keep the battery permanently fully charged. Its lifetime will be extended by keeping it at approximately half charge.
- do not fully discharge the battery.

#### Operation LED light

Operating mode	Charging	Fully charged	Low battery
Blue LED light is lit.	Blue LED light flashes.	Blue LED light is lit for 2 minutes.	Red LED light is lit for 2 minutes.

### INSERTING AND REMOVING THE BATTERY

**1. Inserting the battery:** Carefully turn the motor unit upside down and insert the fully charged battery **A18** into the space next to the button **A17** – see picture **G2**. It clicks once correctly inserted. When inserting the battery **A18** mind the location of the connectors. The battery **A18** can only be inserted with one side.



#### Warning:

Never insert the battery **A18** in the opposite way or with great force. There is a risk of damage.

**2. Removing the battery:** When you need to remove the battery **A18**, press the **A19** button to release the battery **A18**. Carefully remove it from the motor unit – see picture **G3**.



#### Warning:

If you do not use the vacuum cleaner for a long time, remove the battery **A18** from it and store it in a cold and dry place. Charge the battery **A18** regularly. Keep it away from the reach of metal objects to prevent excessive discharge.

## USING THE STICK VACUUM CLEANER

1. Assemble the vacuum cleaner according to the instructions in the section "ASSEMBLY AND DISASSEMBLY OF THE STICK VACUUM CLEANER".
2. Insert the fully charged **A18** into the motor unit.
3. Press the switch **A12** and the vacuum cleaner starts.
4. The vacuum will operate while you hold the switch **A12**. As soon as it is released, the operation of the vacuum cleaner stops automatically.
5. If you need to keep the vacuum cleaner running, push the switch lock **A11** towards the handle **A13**. As soon as the switch lock **A11** is released, the operation of the vacuum cleaner stops automatically.

## USING THE WET CLEANING VACUUM CLEANING

1. Assemble the vacuum cleaner according to the instructions in the section "ASSEMBLY AND DISASSEMBLY OF THE WET CLEANING VACUUM CLEANER".
2. Insert the fully charged **A18** into the motor unit.
3. Press the lock **C6** to release the clean water tank and carefully remove the tank **C8** from the vacuum cleaner body – see picture **H1**.
4. Turn the tank lid **C7** counterclockwise and remove it from the tank **C8**. Pour clean water into the tank **C8** finding the MAX mark – see picture **H2**. Place the lid **C7** back and turn it clockwise to fix it.
5. To insert the clean water tank **C8** back, insert the lower part of the tank **C8** into the vacuum cleaner body and gently press the upper part to the vacuum cleaner body until it clicks – see picture **H3**.



### Warning:

Never fill the tank **C8** over the MAX mark. There is a risk of damage of the vacuum cleaner.

Before filling the tank **C8** make sure the wet cleaning vacuum cleaner is correctly assembled, it is especially important the wet cleaning nozzle **C15** is attached.

Water temperature you pour into the tank **C8** should not exceed 50°C.

If water starts accumulating in the collecting tank **C11**, immediately turn the vacuum cleaner off, clean it before using it again.

Do not tilt the wet cleaning attachment **C4** over 30°.



### Note:

You can add a small amount of neutral cleaning agent with mild foaming effects into the tank **C8**.



### Warning:

Do not use the TURBO function when you use the vacuum cleaner for wet cleaning.

6. Press the switch **A12** and the vacuum cleaner starts. The vacuum will operate while you hold the switch **A12**. As soon as it is released, the operation of the vacuum cleaner stops automatically. If you need to keep the vacuum cleaner running, push the switch lock **A11** towards the handle **A13**. As soon as the switch lock **A11** is released, the operation of the vacuum cleaner stops automatically.
7. To start the wet cleaning function, press the **C18** button and the water will be released from the tank **C8** through the nozzle **C15** into the soft rotary brush **C23** which will wipe the dirt from the floor. At the same time, the dirty water will be vacuumed back into the vacuum cleaner and through the collecting tank **C11**, it will be discharged into the dirty water tank **C14**.
8. If you release the switch **A12**, the water supply from the tank **C8** will be also interrupted and you will have to press the **C18** button when turning the vacuum cleaner on again.
9. You can use the wet cleaning vacuum cleaner for vacuuming split water, wine, or other wet dirt from the floor. In such case, there is no need to press the **C18** button to dose water. Dirty water will be vacuumed into the vacuum cleaner and through the collecting tank **C11**, it will be discharged into the dirty water tank **C14**.
10. After finishing the vacuuming, empty the dirty water tank **C14**. Follow the instructions in the section "Cleaning and maintenance".

## Lights of the wet cleaning nozzle

Lights	Definition
White light is lit.	Water dose is on.
No light is lit.	Water dose is stopped.
Red light flashes.	Dirty water tank is full.

## TURBO FUNCTION

- If you need to increase the power of the vacuum cleaner to the maximum, press the TURBO **A7** button. The vacuum cleaner starts at the maximum power. Once you need to lower the power, press the TURBO **A7** button again.

## STORAGE UNDER NORMAL USE

- The charging base **D13** is designed to store the motor unit and accessories in it and to charge one battery **A18** at the same time. Insert the motor unit into the charging base **D13**.
- There is a groove at the back of the charging base **D13** to attach the floor nozzle **B4** or wet cleaning nozzle **C15**. Both the floor nozzle **B4** and the wet cleaning nozzle **C15** are provided with stoppers which you insert into the groove.

- You can attach the selected accessories you use the most often to the two pins located at the back of the charging base **D13**.

## CLEANING AND MAINTENANCE

- Before cleaning, always make sure the vacuum cleaner is switched off. Remove the battery **A18** from the motor unit.

## CLEANING THE MOTOR UNIT AND ACCESSORIES

- Use a soft cloth, lightly dampened in a lukewarm water, to clean the outer parts of the vacuum cleaner. Do not use abrasive cleaning agents, solvents, or dissolving agents, otherwise the unit surface may be damaged.

## CLEANING THE STICK VACUUM CLEANER

### Empty the dust container

- It is advised to empty the dust container **A15** after each use. However, if the dirt level reaches the MAX mark, it is necessary to empty the dust container **A15** immediately.
1. Remove the accessory from the motor unit.
  2. Place the motor unit above the waste bin with the dust container bottom facing down.
  3. Press the **A16** button and the dust container bottom is released and it opens – see picture **I1**.
  4. This will empty the container content directly into the waste bin.
  5. Use your hand to close the container bottom. It clicks once correctly fitted – see picture **I2**.

### Cleaning the dust container

- Clean the dust container **A15** regularly to prevent unpleasant odours.
1. Remove the accessory from the motor unit and empty the dust container **A15** according to the instructions above.
  2. Press the button **A17** to release the dust container and carefully remove it from the motor unit – see picture **I3**.
  3. Wipe the inner walls of the dust container **A15** using a light dampened soft sponge. Dry with a clean cloth.
  4. Turn the filter unit **A14** counter clockwise and remove it from the motor unit. Remove the dirt from the filter unit above the waste bin. You can use a cleaning brush if needed – see picture **I4**.



### Note:

Cleaning brush is not a part of the packaging.

5. Attach the filter unit **A14** to the motor unit (align the symbol of open lock with an arrow on the motor unit) and turn the filter unit **A14** clockwise until the arrow points to the closed lock symbol.
6. Attach the container **A15** to the motor unit. The container **A15** clicks once correctly assembled.

## Cleaning and change of the outflow filter

- It is advised to clean the outflow filter **A9** regularly to ensure proper vacuum cleaner operation. Depending on how often you use the vacuum cleaner, change the outflow filter **A9** once every 3 or 6 months.

1. Press the locks **A10** on both sides of the cover **A8** and pull the cover with outflow filter out – see picture **I5**.
2. Remove the dirt from the filter **A9**. If the filter **A9** is heavily soiled, rinse it under running clean water. Leave it to dry and then insert it back into the motor unit – see picture **I6**.



### Warning:

Never insert wet or damp filter **A9** into the motor unit! Always wait until it is completely dry. Do not use any appliances, e.g., hair dryer, or never place it to dry to dry the filter **A9**. Avoid drying on the direct sunshine.

## Cleaning and change of the inflow filters

- It is advised to clean inflow filters **A3** and **A5** regularly to ensure proper vacuum cleaner operation. Depending on how often you use the vacuum cleaner, change the inflow filters **A3** and **A5** once every 3 or 6 months. Always change both filters at the same time.

1. Hold the cover **A2** and pull it upwards.
2. Remove the outer inflow filter **A5** from the holder **A4** and beat it above the waste bin.
3. Remove the inner inflow filter **A3** from the holder **A4** and beat it above the waste bin. If the inner inflow filter **A3** is heavily soiled, rinse it under running clean water. Leave it to dry and then insert it back into the holder **A4**.
4. Place the outer inflow filter **A5** onto the holder **A4** and then insert the assembled inflow filter into the motor unit until it clicks.

## Cleaning the floor nozzle

- It is necessary to clean the floor nozzle **B4** regularly to ensure the desired and stable suction power.
1. Remove the floor nozzle **B4** from the vacuum cleaner and turn it upside down.
  2. Turn the lock **B10** to release the side cover.
  3. Carefully remove the rotary brush **B11** – see picture **I7**.

- Remove tangled hair, animal hair and other dirt from the rotary brush **B11**. You can use scissors to remove tangled hair or animal hair quicker.
- Clean the inner part of the floor nozzle by a dry cloth – see picture **I8**.
- Insert the clean rotary brush **B11** back to the floor nozzle by placing the protrusions on its right side into the slots on the right side of the floor nozzle. Then carefully place the left side until it clicks – see picture **I9**.

## CLEANING THE WET CLEANING VACUUM CLEANER

### Emptying and cleaning the dirty water tank

- After finishing the vacuuming, turn the vacuum cleaner off and remove the motor unit.
- Press the lock **C12** to release the dirty water tank and remove the dirty water tank **C14** from the vacuum cleaner body – see picture **J1**.
- Place the tank **C14** above the sink and press the lock **C13** to release the upper part. Pull the upper part of the tank **C14** upwards and then carefully remove it – see picture **J2**.
- Pour the content of the tank **C14** out and rinse it by clean water. Leave it to dry.
- As soon as the dirty water tank **C14** is clean and dry, put it back into the vacuum cleaner body.
- To insert the dirty water tank **C14** back, insert the lower part of the tank **C14** into the vacuum cleaner body and gently press the upper part to the vacuum cleaner body until it clicks – see picture **J3**.

### Cleaning the wet cleaning nozzle

- Carefully remove the front cover **C19** from the nozzle **C15** – see picture **J4**.
- Rinse the front cover **C19** under running clean water – see picture **J5**. Dry with clean cloth.
- You can remove the soft rotary brush **C23** by pulling the lock **C22** upwards – see picture **J6**. Remove tangled hair, animal hair and other dirt from the soft rotary brush **C23**. You can use scissors to remove tangled hair or animal hair quicker. If heavily soiled, you can rinse the brush **C23** under fine running clean water. Leave it to dry.
- You can insert the soft rotary brush **C23** into the nozzle **C15** by attaching the left part of the brush **C23** first and then the right side – see picture **J7**. Ensure the lock **C22** faces up.
- Now, you can attach the front cover **C19**. Insert the protrusions on the cover **C19** into the holes in the nozzle **C15** and close the front cover **C19** until its upper part clicks – see picture **J8**.

### Cleaning the filter unit

- It is necessary to clean the filter unit **C9** after each use.
- Release the lock **C10** and turn the filter unit **C9** counter clockwise – see picture **J9**.
- Take the filter unit **C9** out of the collecting tank **C11**.
- Rinse the filter unit **C9** under running clean water and dry it with clean cloth – see picture **J10**.



#### Warning:

Be careful when rinsing the filter unit not to let water enter the hole for connecting the short tube **C2**.

- Place the filter unit **C9** into the collecting tank **C11** so that the holes around the filter unit **C9** are aligned with the protrusions around the collecting tank **C11**. Then turn the filter unit **C9** clockwise.
- Close the lock **C10**.

### Storage

- If you do not use the vacuum cleaner, clean it according to the instructions above and remove the battery **A18** from the motor unit.
- Before storing, make sure the vacuum cleaner and all accessories are clean and dry.
- Store the appliance on a dry, clean and well-ventilated place where it will not be exposed to extreme temperature and out of reach of children or animals.
- It is advised to regularly charge the battery **A18** every 6 months.

## TROUBLESHOOTING

- Before you decide to contact an authorised service centre, please read through the following table:

Problem	Possible cause	Solution
Vacuum cleaner does not work.	Battery <b>A18</b> is discharged.	Charge the battery <b>A18</b> before using the vacuum cleaner.
	Suction hole is blocked.	Remove the dirt from the suction hole.
Suction power is low.	Dust container <b>A15</b> is full, or the filter unit <b>A14</b> is soiled.	Empty the dust container <b>A15</b> and clean the filter unit <b>A14</b> .
	A large amount of hair or animal hair is wound on the rotary brush <b>B11</b>	Clean the rotary brush <b>B11</b> .
Abnormal noise of the vacuum cleaner.	Articulated tube <b>B1</b> is blocked.	Remove the blocked material.
Difficult manipulation with the vacuum cleaner.	There are too many obstacles in the room.	Take the obstacles out.
	Articulated tube <b>B1</b> is blocked.	Remove the blocked material.
Battery <b>A18</b> is not charged.	Power cord plug is not correctly inserted in the socket.	Make sure the power adapter is correctly inserted.
	Battery <b>A18</b> is not correctly inserted.	Insert the battery <b>A18</b> correctly.



#### Cautions:

If you cannot find your problem in the table above, or the problem persists, stop using the vacuum cleaner, turn it off and contact the authorised service centre.

## TECHNICAL SPECIFICATIONS

### Adapter

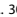
Input..... 100 – 240 V~, 50/60 Hz, 0.8 A  
 Output..... 30 V  0.6 A  
 Electric shock protection class..... II

### Vacuum cleaner

Power input..... 380 W  
 Electric rotary brush..... 40 W  
 Electric rotary mop..... 40 W  
 Electric rotary brush for hand unit..... 15 W  
 Battery..... Li-Ion / 25.2 V / 2,000 mAh  
 Timer required for charging to full capacity..... approx. 4 - 5 hours  
 Operating time when fully charged..... up to 50 min  
 Noise level..... 83 dB(A)  
 Dust container capacity..... 0.5 l  
 Clean water tank capacity..... 0.4 l  
 Dirty water tank capacity..... 0.4 l

The declared noise emission level of vacuum cleaner is 83 dB(A), which represents level A of acoustic power with respect to a reference acoustic power of 1 pW.

We reserve the right to change text and technical specifications.

### Safety class for electrical shock protection:



Class II – Electrical shock protection is provided by double or heavy-duty insulation.



The product is intended for household use only. The product is not intended for outdoor use.



Thoroughly read the all the instructions before using the product.

## DISPOSAL OF BATTERIES



Prior to disposing of the product or handing it over at a specialised collection facility, it is necessary to ensure that the battery is removed. Before removing the battery, it is necessary to start the vacuum cleaner and wait until it is completely flat. The battery contains environmentally damaging substances and therefore does not belong in standard household waste. Their correct disposal will be performed by the respective collection facility.

## INSTRUCTIONS AND INFORMATION REGARDING THE DISPOSAL OF USED PACKAGING MATERIALS

Dispose of used packaging material at a site designated for waste in your municipality.

## DISPOSAL OF USED ELECTRICAL AND ELECTRONIC EQUIPMENT



This symbol on products or original documents means that used electric or electronic products must not be added to ordinary municipal waste. For proper disposal, renewal and recycling, hand over these appliances to determined collection points. Alternatively, in some European Union states or other European countries you may return your appliances to the local retailer when buying an equivalent new appliance.

Correct disposal of this product helps save valuable natural resources and prevents potential negative effects on the environment and human health, which could result from improper waste disposal. Ask your local authorities or collection facility for more details.

In accordance with national regulations penalties may be imposed for the incorrect disposal of this type of waste.

### For business entities in European Union states

If you want to dispose of electric or electronic equipment, ask your retailer or supplier for the necessary information.

### Disposal in other countries outside the European Union.

This symbol is valid in the European Union. If you wish to dispose of this product, request the necessary information about the correct disposal method from the local council or from your retailer.



This product meets all the basic requirements of EU directives related to it.