

## BassBloom

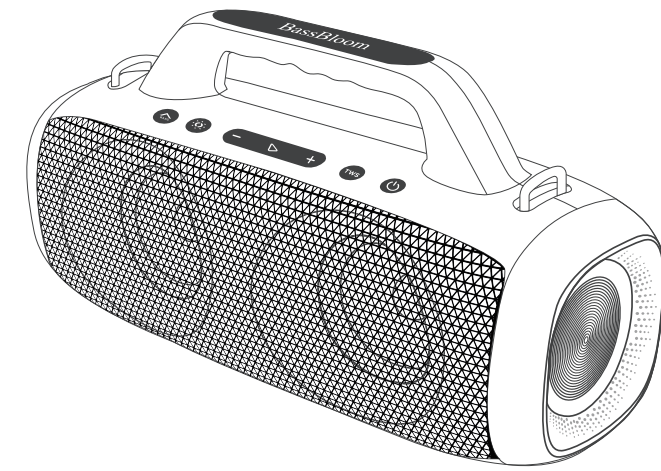

### ROAR 1 Portable Wireless Speaker USER MANUAL

VO.2 2025.08.28

## Button Instructions

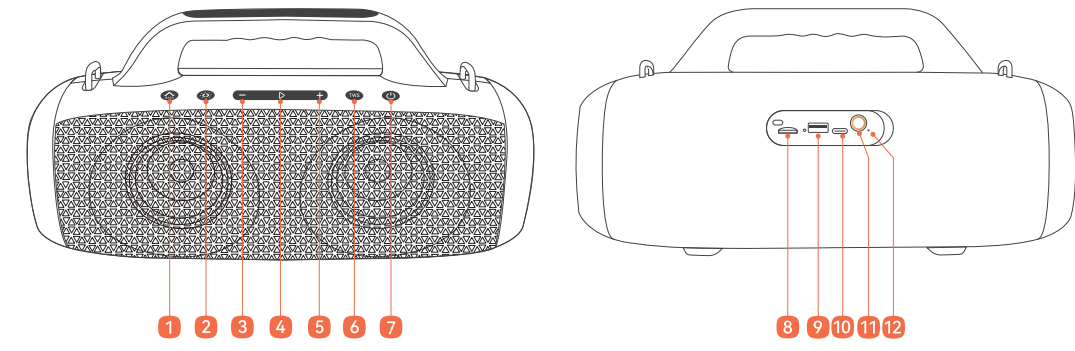

1 Bassboost Button	8 TF Card Slot
2 Light Show Button	9 USB Flash Drive Port
3 Volume Down / Previous Track Button	10 USB-C Charging Port
4 Play / Pause Button	11 Mic Port
5 Volume Up / Next Track Button	12 Charging Indicator
6 Multi-Speaker Pairing Button	
7 Power Button	

## Installing the Strap

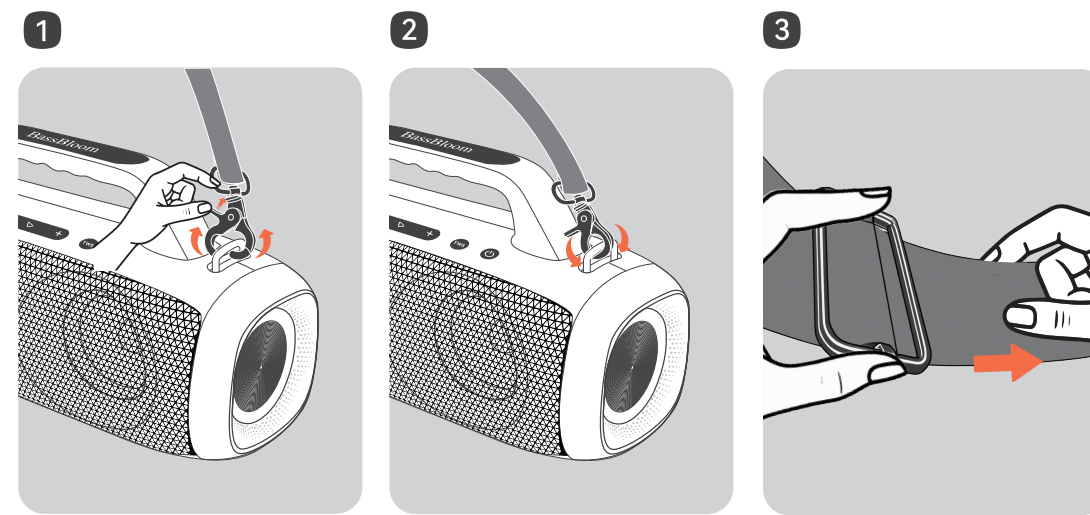

Attach the strap to both sides of the speaker. Adjust the strap length according to the illustration for optimal comfort.

## Main Product Functions

No.	Function	Describe
1	Mono / Stereo L/R	Stereo L/R
2	BT Mode	Connect via Bluetooth to play music.
3	TF-Mode	Play music from TF flash drives (supports up to 32GB capacity and MP3/WAV formats)
4	USB Flash Disk Mode	Play music from USB drives (supports up to 32GB storage and MP3/WAV formats)
5	USB-C Charging	USB-C Charging
6	RGB Ambient Lights	Default startup lighting is Mode 1 (RGB enabled), with 8 lighting modes available. Mode 9 turns off RGB lighting entirely
7	TWS Mode	When connected via Bluetooth, the two units can pair in TWS mode to create an enhanced stereo system
8	Disconnects due to out-of-range	Auto-reconnection within 10 minutes after disconnection
9	Automatic Sleep Mode	Automatically powers off after 10 minutes without connection. Remains active when connected
10	Charging	The red indicator light is on
11	Charging Complete	The charging light turns off

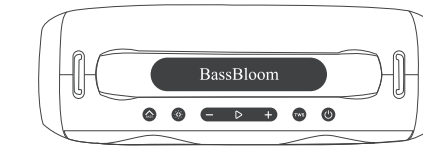

## Charging Your Speaker

Use the provided USB-C/USB-A to USB-C cable to connect the speaker and a certified charger to a power source.

☀️ Steady Red	Charging
🌙 Red Light Turns Off	Charging Complete

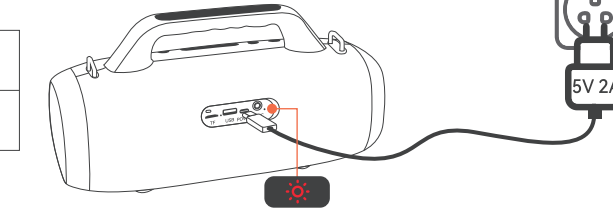

Please use a charger with a power output of 1W to 10W to charge the speaker.

## Powering On / Off

🔌 Power On/Power Off	Press and Hold for 2 Seconds
🔄 Mode Switches (BT/TF Card/USB Drive)	Press Once
🔄 Restart	Press and Hold for 10 Seconds

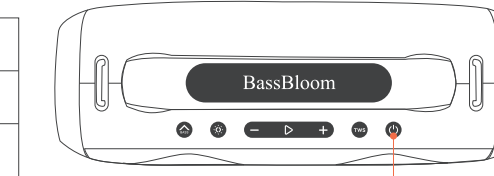

This speaker will power off automatically after 10 minutes if no device is connected.



## Using Your Speaker

### Bluetooth Mode (Press power once switch modes.)

Turn on the speaker first, then enable Bluetooth on your phone. Select 'ROAR 1' to pair. When not paired, the blue LED will flash. Upon successful pairing, you'll hear a confirmation tone and the light will remain steady.

To pair a new device with the speaker, disconnect the previously connected phone first. When powered on, the speaker automatically reconnects to the last used device. If the phone's Bluetooth is off or the connection fails, the speaker will enter pairing mode. Simply pair it with the new device directly.

Press Once the power button to switch between operation modes (Bluetooth/TF Card/USB modes). You can toggle them based on your current needs.

### True Wireless Stereo (TWS) Mode

Two identical BassBloom speakers can pair with each other for stereo sound. Both speakers can play the same audio (one as the left channel and the other as the right channel).

With one speaker connected to a smartphone, press and hold the TWS button for 2 seconds on two speakers to enter TWS pairing mode.

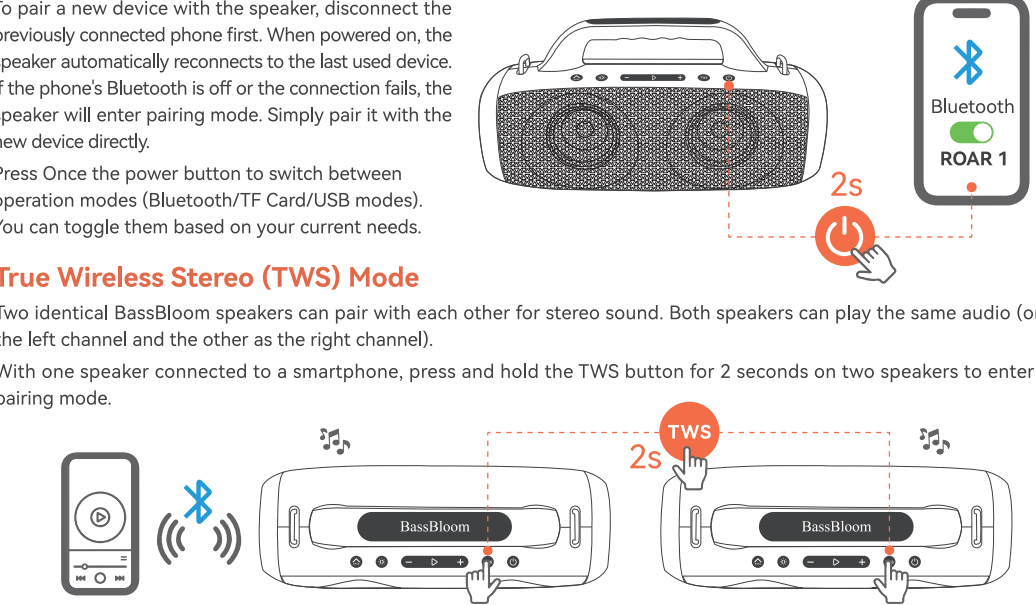

## Light Show

The front of the speaker features 8 dynamic light effects that move with the music's rhythm, while the ambient lighting stays constant to enhance the atmosphere. You can switch between different lighting effects to match your mood or preference.

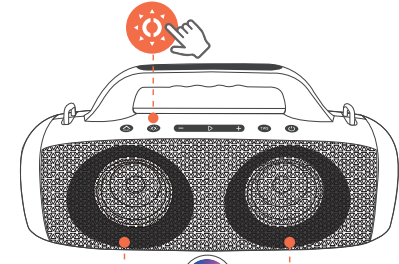

## Bass Enhancement

When the bass boost is enabled, the speaker will attenuate the high-frequency vocal range to maintain optimal bass performance. You may notice a perceived volume reduction, which is a normal effect of high-frequency attenuation.

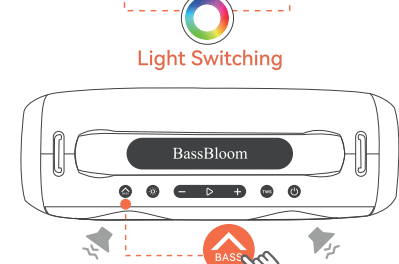

## Switch Songs

Press and hold the - button for 2 seconds to replay the previous track. Press the + button for the next track. Press once to decrease/increase volume.

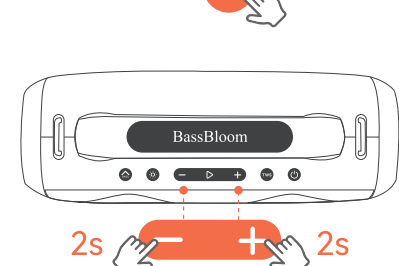

## Button Controls

🔌	Press Once	Mode Switches (BT/TF Card/USB Drive)
	Press and Hold for 2 Seconds	Power On/Power Off
	Press and Hold for 10 Seconds	Restart
+	Press Once	Volume Up
	Press and Hold for 2 Seconds	Next Track
-	Press Once	Volume Down
	Press and Hold for 2Seconds	Previous Track
▶️	Press Once	Play /Pause
	Press and Hold for 3 Seconds	Manually Force a Bluetooth Disconnect
☀️	Press Once	Light Effect Switching
	Press Once	Bassboost On/Off
🔄	Press and Hold for 2 Seconds	TWS On/Off
	Press Three Times	Restore factory settings

## Specifications

Model	ROAR 1
Product Name	Wireless Speaker
Power Input	5V ⚡ 2A
Battery Capacity	7.4V 3600mAh, 26.64Wh
Audio Output Power	60W
Playtime (Varies by volume level and music content)	24 Hours
Charging Time	About 3.5H
Waterproof and Dustproof Rating	IPX6
Speaker Driver	φ75mm/4Q Speaker *2
Link Range	>10M
Frequency Response	50 Hz-20 kHz
Cable Length	1M
FCC ID	2BRLM-ROAR 1

## NOTE:

Friendly reminder: If the speaker is not used for a long time, it is necessary to keep some battery power stored. It is essential to fully charge it once a month.

This is to protect the battery life of your speaker, which may vary depending on usage patterns and environmental conditions.

Furthermore, do not expose the BassBloom-ROAR 1 to liquids without disconnecting the cable. Avoid submerging the BassBloom-ROAR 1 in water while charging, as this may cause permanent damage to the speaker or power source.

Chemicals, salt, or foreign substances in pools or the ocean, if not promptly cleaned after use, can damage the waterproof seals or harm the connector surfaces in the long run. After any liquid spillage or rinsing, refrain from charging the speaker until it is completely dry and clean.

Charging while damp may result in speaker damage. (It is advisable to avoid direct water rinsing and instead use a tissue or damp cloth for cleaning.)

When using an external adapter, ensure that the output voltage/current of the adapter does not exceed 5V/2A. This will help maintain the proper functioning of your BassBloom-ROAR 1 speaker.

## Battery Warning

Using the wrong battery can cause fire and other hazards (for example, in the case of some lithium battery types)

1. Disposal of a battery into fire or a hot oven, or mechanically crushing or cutting of a battery, that can result in an explosion.
2. Do not leaving a battery in an extremely high temperature surrounding environment that can result in an explosion or the leakage of flammable liquid or gas.
3. A battery subjected to extremely low air pressure that may result in an explosion or the leakage of flammable liquid or gas.

## FCC Caution

Any Changes or modifications not expressly approved by the party responsible for compliance could void the user's authority to operate the equipment.

This device complies with part 15 of the FCC Rules. Operation is subject to the following two conditions:

- (1) This device may not cause harmful interference, and
- (2) This device must accept any interference received, including interference that may cause undesired operation.

Note: This equipment has been tested and found to comply with the limits for a Class B digital device, pursuant to part 15 of the FCC Rules. These limits are designed to provide reasonable protection against harmful interference in a residential installation. This equipment generates, uses and can radiate radio frequency energy and, if not installed and used in accordance with the instructions, may cause harmful interference to radio communications. However, there is no guarantee that interference will not occur in a particular installation. If this equipment does cause harmful interference to radio or television reception, which can be determined by turning the equipment off and on, the user is encouraged to try to correct the interference by one or more of the following measures:

- Reorient or relocate the receiving antenna.
  - Increase the separation between the equipment and receiver.
  - Connect the equipment into an outlet on a circuit different from that to which the receiver is connected.
  - Consult the dealer or an experienced radio/TV technician for help.
- This equipment complies with FCC radiation exposure limits set forth for an uncontrolled environment. This transmitter must not be co-located or operating in conjunction with any other antenna or transmitter.

## ISED Warning

This device complies with Industry Canada licence-exempt RSS standard(s). Operation is subject to the following two conditions:

- (1) This device may not cause interference, and
- (2) This device must accept any interference, including interference that may cause undesired operation of the device.

Le présent appareil est conforme aux CNR d'Industrie Canada applicables aux appareils radio exempts de licence. L'exploitation est autorisée aux deux conditions suivantes:

- (1) l'appareil ne doit pas produire de brouillage, et
- (2) l'utilisateur de l'appareil doit accepter tout brouillage radioélectrique subi, même si le brouillage est susceptible d'en compromettre le fonctionnement.

The device is compliance with RF exposure guidelines, users can obtain Canadian information on RF exposure and compliance. Le présent appareil est conforme

Après examen de ce matériel aux normes de conformité ou aux limites d'intensité de champ RF, les utilisateurs peuvent sur l'exposition aux radiofréquences et la conformité et compliance d'acquiescer les informations correspondantes.

## CE Caution

DISPOSE OF USED BATTERIES ACCORDING TO THE INSTRUCTIONS

⚡ The symbol indicates DC voltage

♻️ RECYCLING

This product bears the selective sorting symbol for Waste electrical and electronic equipment (WEEE). This means that this product must be handled pursuant to European directive 2012/19/EU in order to be recycled or dismantled to minimize its impact on the environment. User has the choice to give his product to a competent recycling organization or to the retailer when he buys a new electrical or electronic equipment.

This product can be used across EU member states.

The device is low power device, it can meet the requirement of the RF exposure.

⚠️ Hearing Safety:

1. High Sound Pressure
2. Hearing Damage Risk
3. Do not listen at high volume levels for long periods.

CE  
Made in China

## ROAR-1说明书

单页尺寸: 160x120mm

材质: 108g双铜纸, 不覆膜

装订方式: 风琴折



# BassBloom

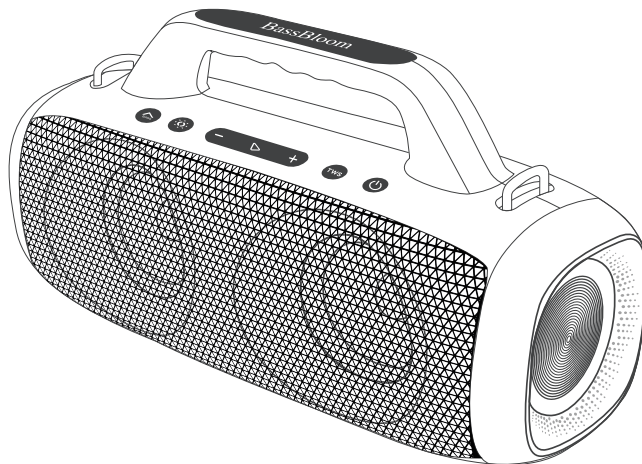

## **ROAR 1 Portable Wireless Speaker**

### USER MANUAL

V0.2 2025.08.28

# Button Instructions

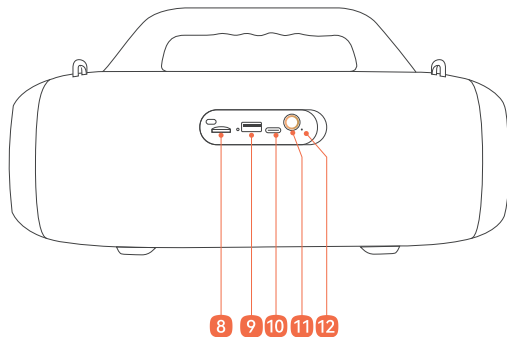
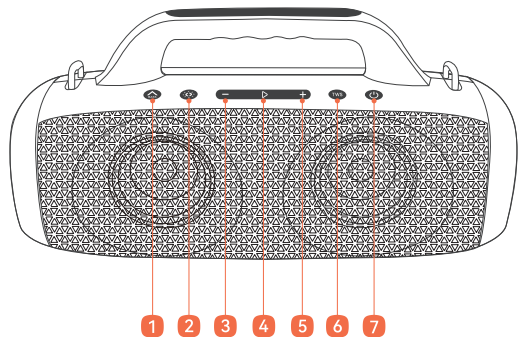

<b>1</b> Bassboost Button	<b>8</b> TF Card Slot
<b>2</b> Light Show Button	<b>9</b> USB Flash Drive Port
<b>3</b> Volume Down / Previous Track Button	<b>10</b> USB-C Charging Port
<b>4</b> Play / Pause Button	<b>11</b> Mic Port
<b>5</b> Volume Up / Next Track Button	<b>12</b> Charging Indicator
<b>6</b> Multi-Speaker Pairing Button	
<b>7</b> Power Button	

# Installing the Strap

1

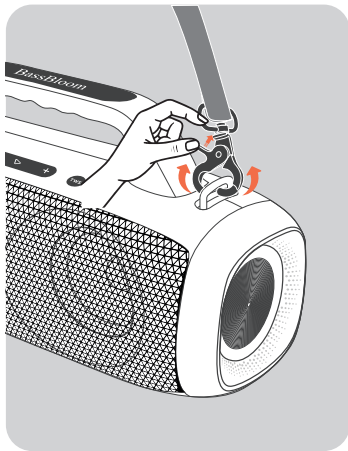

2

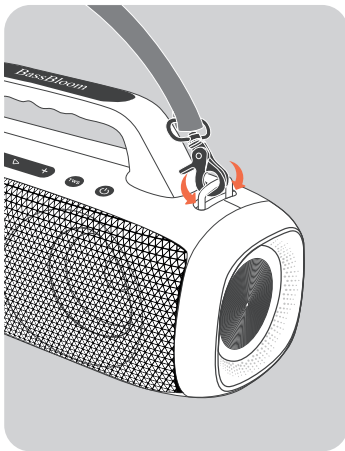

3

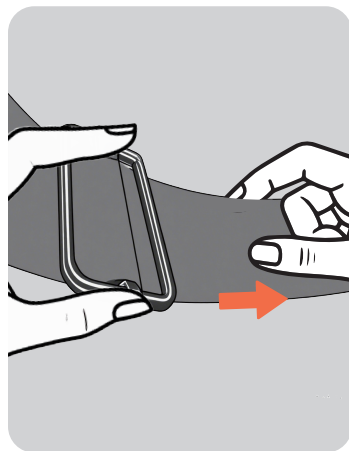

Attach the strap to both sides of the speaker. Adjust the strap length according to the illustration for optimal comfort.

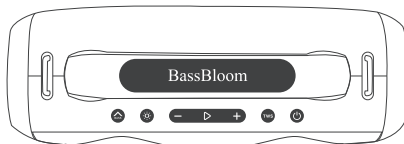

# Main Product Functions

No.	Function	Describe
1	Mono / Stereo L/R	Stereo L/R
2	BT Mode	Connect via Bluetooth to play music.
3	TF Mode	Play music from TF flash drives (supports up to 32GB capacity and MP3/WAV formats)
4	USB Flash Disk Mode	Play music from USB drives (supports up to 32GB storage and MP3/WAV formats)
5	USB-C Charging	USB-C Charging
6	RGB Ambient Lights	Default startup lighting is Mode 1 (RGB enabled), with 8 lighting modes available. Mode 9 turns off RGB lighting entirely
7	TWS Mode	When connected via Bluetooth, the two units can pair in TWS mode to create an enhanced stereo system
8	Disconnects due to out-of-range	Auto-reconnection within 10 minutes after disconnection
9	Automatic Sleep Mode	Automatically powers off after 10 minutes without connection. Remains active when connected
10	Charging	The red indicator light is on
11	Charging Complete	The charging light turns off



# Charging Your Speaker

Use the provided USB-C /USB-A to USB-C cable to connect the speaker and a certified charger to a power source.

	Steady Red	Charging
	Red Light Turns Off	Charging Complete

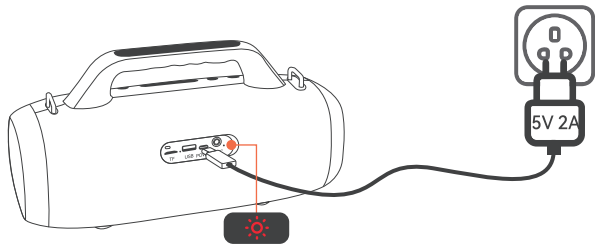

Please use a charger with a power output of 1W to 10W to charge the speaker.

# Powering On / Off

	Power On/Power Off	Press and Hold for 2 Seconds
	Mode Switches (BT/TF Card/USB Drive)	Press Once
	Restart	Press and Hold for 10 Seconds

This speaker will power off automatically after 10 minutes if no device is connected.

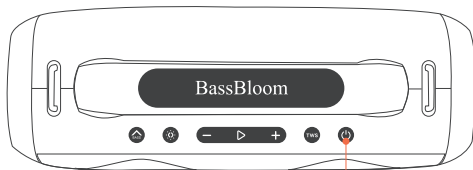

 2s       1x       10s

**ON/OFF**      **Mode Switches**      **Restart**

# Using Your Speaker

## Bluetooth Mode (Press power once switch modes.)

Turn on the speaker first, then enable Bluetooth on your phone. Select 'ROAR 1' to pair. When not paired, the blue LED will flash. Upon successful pairing, you'll hear a confirmation tone and the light will remain steady.

To pair a new device with the speaker, disconnect the previously connected phone first. When powered on, the speaker automatically reconnects to the last used device. If the phone's Bluetooth is off or the connection fails, the speaker will enter pairing mode. Simply pair it with the new device directly.

Press Once the power button to switch between operation modes (Bluetooth/TF Card/USB modes). You can toggle them based on your current needs.

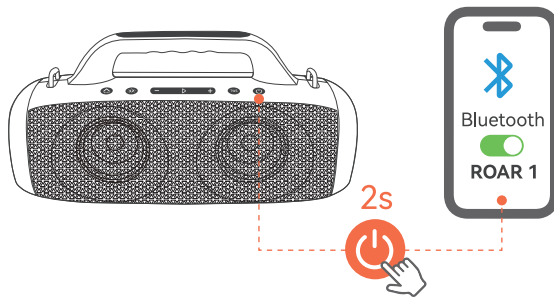

## True Wireless Stereo (TWS) Mode

Two identical BassBloom speakers can pair with each other for stereo sound. Both speakers can play the same audio (one as the left channel and the other as the right channel).

With one speaker connected to a smartphone, press and hold the TWS button for 2 seconds on two speakers to enter TWS pairing mode.

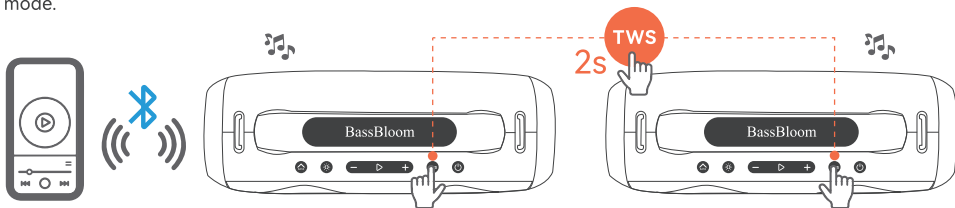

## Light Show

The front of the speaker features 8 dynamic light effects that move with the music's rhythm, while the ambient lighting stays constant to enhance the atmosphere. You can switch between different lighting effects to match your mood or preference.

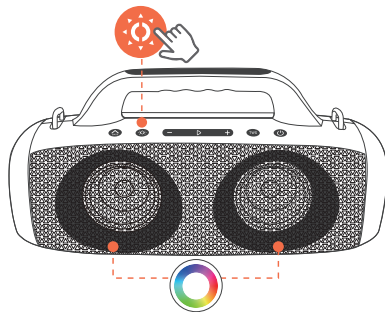

Light Switching

## Bass Enhancement

When the bass boost is enabled, the speaker will attenuate the high-frequency vocal range to maintain optimal bass performance. You may notice a perceived volume reduction, which is a normal effect of high-frequency attenuation.

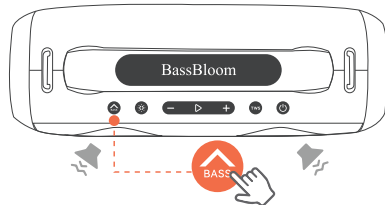

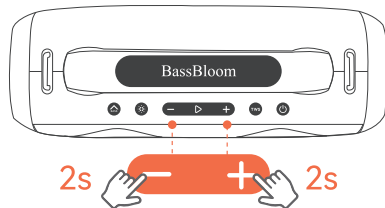

## Switch Songs

Press and hold the - button for 2 seconds to replay the previous track. Press the + button for the next track. Press once to decrease/increase volume.



# Button Controls

	Press Once	Mode Switches (BT/TF Card/USB Drive)
	Press and Hold for 2 Seconds	Power On/Power Off
	Press and Hold for 10 Seconds	Restart
	Press Once	Volume Up
	Press and Hold for 2 Seconds	Next Track
	Press Once	Volume Down
	Press and Hold for 2Seconds	Previous Track
	Press Once	Play /Pause
	Press and Hold for 3 Seconds	Manually Force a Bluetooth Disconnect
	Press Once	Light Effect Switching
 BASS	Press Once	Bassboost On/Off
TWS	Press and Hold for 2 Seconds	TWS On/Off
	Press Three Times	Restore factory settings

# Specifications

Model	ROAR 1
Product Name	Wireless Speaker
Power Input	5V $\overline{\text{---}}$ 2A
Battery Capacity	7.4V 3600mAh, 26.64Wh
Audio Output Power	60W
Playtime (Varies by volume level and music content)	24 Hours
Charging Time	About 3.5H
Waterproof and Dustproof Rating	IPX6
Speaker Driver	$\Phi$ 75mm/4 $\Omega$ Speaker *2
Link Range	>10M
Frequency Response	50 HZ~20 kHz
Cable Length	1M
FCC ID	2BRLM-ROAR 1

## NOTE:

Friendly reminder: If the speaker is not used for a long time, it is necessary to keep some battery power stored. It is essential to fully charge it once a month.

This is to protect the battery life of your speaker, which may vary depending on usage patterns and environmental conditions.

Furthermore, do not expose the BassBloom-ROAR 1 to liquids without disconnecting the cable. Avoid submerging the BassBloom-ROAR 1 in water while charging, as this may cause permanent damage to the speaker or power source.

Chemicals, salt, or foreign substances in pools or the ocean, if not promptly cleaned after use, can damage the waterproof seals or harm the connector surfaces in the long run. After any liquid spillage or rinsing, refrain from charging the speaker until it is completely dry and clean.

Charging while damp may result in speaker damage. (It is advisable to avoid direct water rinsing and instead use a tissue or damp cloth for cleaning.)

When using an external adapter, ensure that the output voltage/current of the adapter does not exceed 5V/2A. This will help maintain the proper functioning of your BassBloom-ROAR 1 speaker.

## Battery Warning

Using the wrong battery can cause fire and other hazards (for example, in the case of some lithium battery types)

1. Disposal of a battery into fire or a hot oven, or mechanically crushing or cutting of a battery, that can result in an explosion.
2. Do not leaving a battery in an extremely high temperature surrounding environment that can result in an explosion or the leakage of flammable liquid or gas.
3. A battery subjected to extremely low air pressure that may result in an explosion or the leakage of flammable liquid or gas.

## FCC Caution

Any Changes or modifications not expressly approved by the party responsible for compliance could void the user's authority to operate the equipment.

This device complies with part 15 of the FCC Rules. Operation is subject to the following two conditions:

- (1) This device may not cause harmful interference, and
- (2) This device must accept any interference received, including interference that may cause undesired operation.

Note: This equipment has been tested and found to comply with the limits for a Class B digital device, pursuant to part 15 of the FCC Rules. These limits are designed to provide reasonable protection against harmful interference in a residential installation. This equipment generates, uses and can radiate radio frequency energy and, if not installed and used in accordance with the instructions, may cause harmful interference to radio communications. However, there is no guarantee that interference will not occur in a particular installation. If this equipment does cause harmful interference to radio or television reception, which can be determined by turning the equipment off and on, the user is encouraged to try to correct the interference by one or more of the following measures:

- Reorient or relocate the receiving antenna.
- Increase the separation between the equipment and receiver.
- Connect the equipment into an outlet on a circuit different from that to which the receiver is connected.
- Consult the dealer or an experienced radio/TV technician for help.

This equipment complies with FCC radiation exposure limits set forth for an uncontrolled environment.

This transmitter must not be co-located or operating in conjunction with any other antenna or transmitter.

## ISED Warning

This device complies with Industry Canada licence-exempt RSS standard(s). Operation is subject to the following two conditions:

- (1) This device may not cause interference, and
- (2) This device must accept any interference, including interference that may cause undesired operation of the device.

Le présent appareil est conforme aux CNR d'Industrie Canada applicables aux appareils radio exempts de licence. L'exploitation est autorisée aux deux conditions suivantes:

- (1) l'appareil ne doit pas produire de brouillage, et
- (2) l'utilisateur de l'appareil doit accepter tout brouillage radioélectrique subi, même si le brouillage est susceptible d'en compromettre le fonctionnement.

The device is compliance with RF exposure guidelines, users can obtain Canadian information on RF exposure and compliance.

Le présent appareil est conforme

Après examen de ce matériel aux conformité ou aux limites d'intensité de champ RF, les utilisateurs peuvent sur l'exposition aux radiofréquences et la conformité and compliance d'acquérir les informations correspondantes.

## CE Caution

### DISPOSE OF USED BATTERIES ACCORDING TO THE INSTRUCTIONS

 The symbol indicates DC voltage

 RECYCLING

This product bears the selective sorting symbol for Waste electrical and electronic equipment (WEEE). This means that this product must be handled pursuant to European directive 2012/19/EU in order to be recycled or dismantled to minimize its impact on the environment. User has the choice to give his product to a competent recycling organization or to the retailer when he buys a new electrical or electronic equipment.

This product can be used across EU member states.

The device is low power device, it can meet the requirement of the RF exposure.

 Hearing Safety:

1. High Sound Pressure
2. Hearing Damage Risk
3. Do not listen at high volume levels for long periods.



Made in China