

KitchenAid®

KFC3516



PARTS AND FEATURES

PARTS AND ACCESSORIES

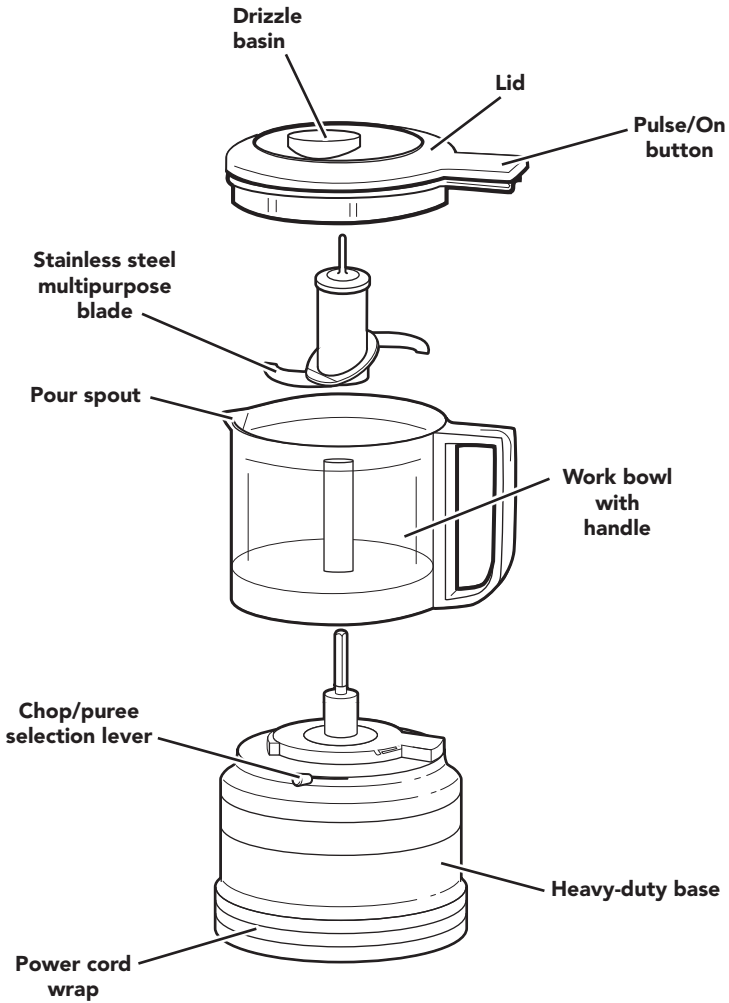

MINI FOOD PROCESSOR SAFETY

Your safety and the safety of others are very important.

We have provided many important safety messages in this manual and on your appliance. Always read and obey all safety messages.



This is the safety alert symbol.

This symbol alerts you to potential hazards that can kill or hurt you and others.

All safety messages will follow the safety alert symbol and either the word "DANGER" or "WARNING." These words mean:

! DANGER

You can be killed or seriously injured if you don't immediately follow instructions.

! WARNING

You can be killed or seriously injured if you don't follow instructions.

All safety messages will tell you what the potential hazard is, tell you how to reduce the chance of injury, and tell you what can happen if the instructions are not followed.

State of California Proposition 65 Warnings:

WARNING: This product contains one or more chemicals known to the State of California to cause cancer.

WARNING: This product contains one or more chemicals known to the State of California to cause birth defects or other reproductive harm.

IMPORTANT SAFEGUARDS

When using electrical appliances, basic safety precautions should always be followed, including the following:

1. Read all instructions.
2. To protect against risk of electrical shock do not put motor body, cord, or electrical plug of this Mini Food Processor in water or other liquid.
3. Close supervision is necessary when any appliance is used by or near children.
4. Unplug from outlet when not in use, before putting on or taking off parts, and before cleaning.
5. Avoid contacting moving parts.
6. Do not operate any appliance with a damaged cord or plug or after the appliance malfunctions, or is dropped or damaged in any manner. Return appliance to the nearest Authorized Service Facility for examination, repair or electrical or mechanical adjustment.
7. The use of attachments not recommended or sold by the manufacturer may cause fire, electric shock or injury.

MINI FOOD PROCESSOR SAFETY

- Do not use outdoors.
- Do not let cord hang over edge of table or counter.
- Keep hands and utensils away from the cutting blade while chopping food to reduce the risk of severe injury to person or damage to the Mini Food Processor. A scraper may be used but only when the Mini Food Processor is not running.
- Blade is sharp. Handle carefully.
- To reduce the risk of injury, never place cutting blade on base without first putting bowl properly in place.
- Be certain cover is securely locked in place before operating the Mini Food Processor.
- Do not attempt to defeat the cover interlock mechanism.

SAVE THESE INSTRUCTIONS

This product is designed for household use only.

ELECTRICAL REQUIREMENTS

Volts: 120 V.A.C.

Hertz: 60 Hz

NOTE: This Mini Food Processor has a polarized plug (one blade is wider than the other). To reduce the risk of electrical shock, this plug will fit in a polarized outlet

only one way. If the plug does not fit fully in the outlet, reverse the plug. If it still does not fit, contact a qualified electrician. Do not modify the plug in any way.

A short power-supply cord is provided to reduce the risk resulting from becoming entangled in or tripping over a longer cord.

TROUBLESHOOTING

If your Mini Food Processor should malfunction or fail to operate, check the following:

- Is the Mini Food Processor plugged in?
- Make sure that the bowl and lid are properly aligned and locked in place.
- Press the Pulse/On button with a rapid up and down motion, do not hold down continuously.
- Unplug the Mini Food Processor, then plug it back into the outlet.

- Is the fuse in the circuit to the Mini Food Processor in working order? If you have a circuit breaker box, be sure the circuit is closed.

If the problem is not due to one of the above items, see the "Warranty and service" section.

Do not return the Mini Food Processor to the retailer. Retailers do not provide service.

USING THE MINI FOOD PROCESSOR

CHOP AND PUREE RECOMMENDATIONS CHART

Use the Mini Food Processor to chop raw fruits and vegetables or nuts, and mince parsley, chives, or garlic for easy preparation in your favorite recipes. Purée cooked fruit or vegetables to make baby food, or to use as bases for soups or sauces. You can also make bread crumbs, or grind raw meat. Use the drizzle basin and pour spout to easily make mayonnaise or dressings.

NOTE: For best results, larger food items should be cut to approximately 1 inch cubes before processing. This step also allows processing of more food at a single time.

IMPORTANT: Do not process coffee beans or hard spices such as nutmeg, which may damage the Mini Food Processor.

SUGGESTED FOOD	PREPARE FOR PROCESSING	AMOUNT	SETTING
RAW FRUITS & VEGETABLES	Cut into 1 inch pieces	Up to 3 cups	Chop or Puree
COOKED FRUITS & VEGETABLES	Cut into 1 inch pieces	Up to 2.5 cups	Puree
LIQUIDS/ EMULSIONS (SUCH AS MAYONNAISE OR SALAD DRESSINGS)	Place dry ingredients, or thicker wet ingredients in work bowl; then, use the drizzle basin to add oils or liquids to the mixture during use.	Up to 1.5 cups	Puree
MEAT	Meat should be raw, and cut into 1 inch pieces for best processing results.	Up to 1/2 pound (227g) at one time.	Chop or Puree
HERBS & SPICES	Add herbs, and spices as they are; no preparation needed.	Up to 3 cups	Chop
BREAD, COOKIES, OR CRACKERS	Break bread, crackers, or cookies into pieces that fit into the bowl before processing.	Up to 3 cups	Chop
NUTS	Add nuts as they are; no preparation needed.	Up to 3 cups	Puree

TIP: For better consistency, or to achieve coarsely chopped results, use the Pulse operation.

Visit [KitchenAid.com/Quickstart](https://www.kitchenaid.com/Quickstart) for additional instructions with videos, inspiring recipes, and tips on how to use your Mini Food Processor.

USING THE MINI FOOD PROCESSOR

PREPARING THE MINI FOOD PROCESSOR FOR USE

! WARNING

Cut Hazard

Handle blades carefully.

Failure to do so can result in cuts.

Before first use

Before using the Mini Food Processor for the first time, wash the work bowl, lid, and blade in hot, soapy water. Work bowl, lid, and blade may also be washed in the top rack of a dishwasher.

For convenient storage, always reassemble the Mini Food Processor after cleaning.

DISASSEMBLING THE MINI FOOD PROCESSOR

Follow these instructions to disassemble the Mini Food Processor for cleaning and when removing ingredients from the work bowl.

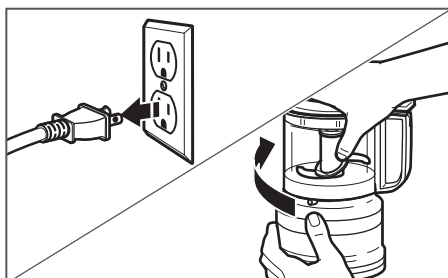

- 1** Be sure the Mini Food Processor is unplugged. Hold the lid as shown, and rotate it clockwise to unlock. Then, lift the lid off of the work bowl.

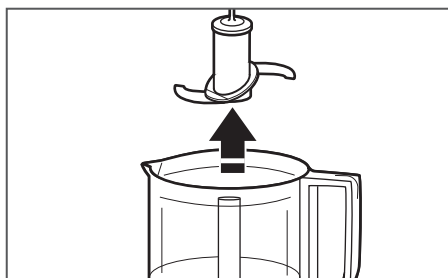

- 2** Pull the blade straight up to unlock and remove it from the work bowl.

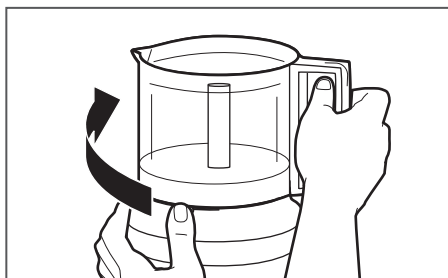

- 3** Hold the base steady with one hand, and use the other hand to rotate the work bowl clockwise to unlock and lift it off of the base.

USING THE MINI FOOD PROCESSOR

ASSEMBLING AND RUNNING THE MINI FOOD PROCESSOR

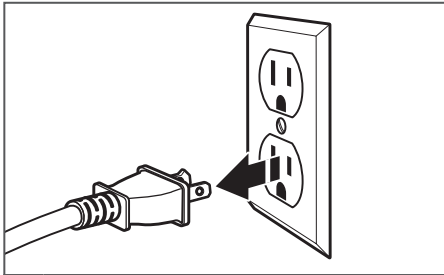

- 1** Be sure the Mini Food Processor is unplugged.

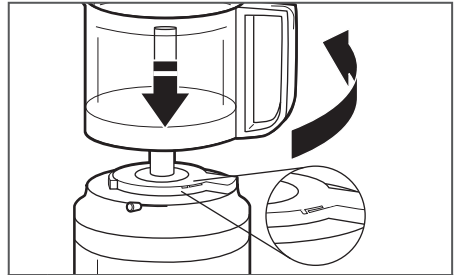

- 2** Start with the work bowl handle facing front on the base. Rotate the handle 90° counterclockwise to lock into place. When assembled properly, the handle will face the right side.

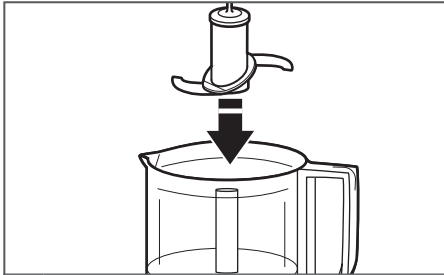

- 3** Fit the blade over the shaft in the center of the work bowl, rotate and press down until it locks into position.

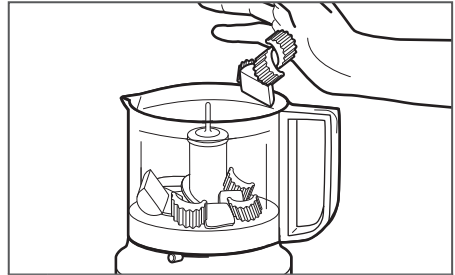

- 4** Place ingredients to be processed inside the work bowl. For uniform consistency of processed foods, cut fruits, vegetables, and meats into 1 inch pieces.

IMPORTANT: Do not process coffee beans or hard spices such as nutmeg, which may damage the Mini Food Processor.

USING THE MINI FOOD PROCESSOR

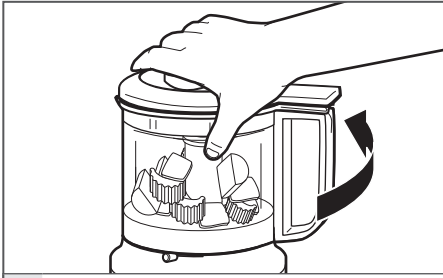

5

Place the lid on the work bowl with the lid handle facing front. Rotate the lid handle to the right. The lid will click when locked into place. Rotate the lid counterclockwise to lock into place.

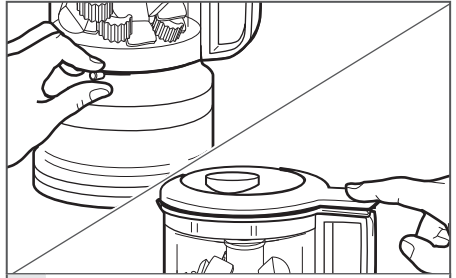

6

Slide the Chop/Puree lever to your desired setting. Press down on the PULSE/ON button to start the Mini Food Processor.

NOTE: The work bowl and lid must be locked into place for the Mini Food Processor to operate.

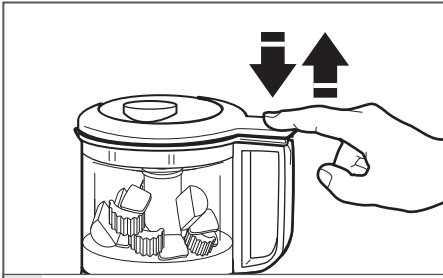

7

For a coarse chop, use a pulsing motion to rapidly press and release the PULSE/ON button until your desired results are achieved.

USING THE MINI FOOD PROCESSOR

USING THE DRIZZLE BASIN AND POUR SPOUT

Use the drizzle basin to conveniently add liquid ingredients while processing, to make dressings, mayonnaises, emulsions, sauces, and more. Use the pour spout for easier serving.

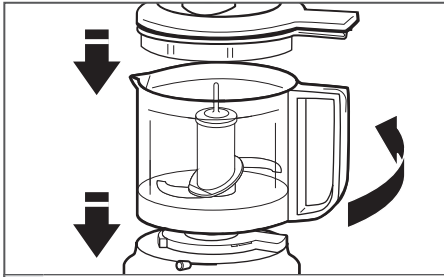

- 1** Place the lid on the work bowl with the lid handle facing front. Rotate the lid handle to the right. Rotate the lid counterclockwise to lock into place.

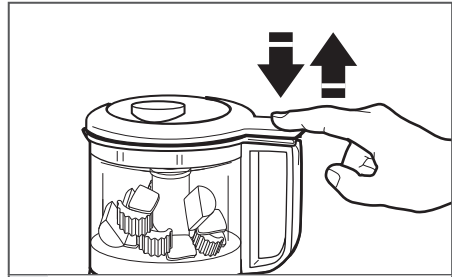

- 2** Press rapidly up and down on the handle PULSE/ON button to get your ingredients moving in the work bowl.

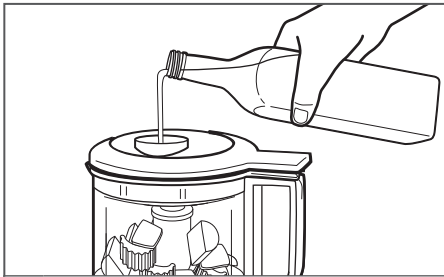

- 3** Slowly pour liquids, such as oil, into the drizzle basin. The liquid will be efficiently and thoroughly mixed into the ingredients as they spin inside the work bowl.

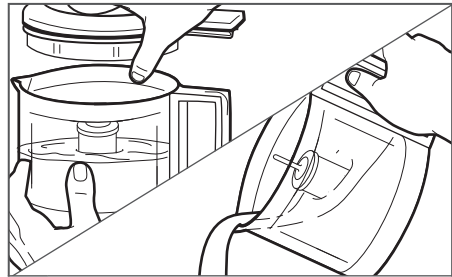

- 4** Once processing is complete, remove the lid to use the pour spout.

FOR DETAILED INFORMATION ON USING THE MINI FOOD PROCESSOR:

Visit kitchenaid.com/quickstart for additional instructions with videos, inspiring recipes, and tips on how to use your Mini Food Processor.

CARE AND CLEANING

⚠ WARNING

Cut Hazard
Handle blades carefully.
Failure to do so can result in cuts.

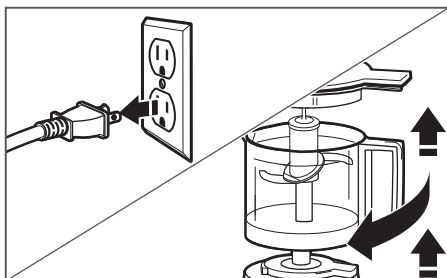

- 1 Unplug the Mini Food Processor. Remove the work bowl, lid, and blade.

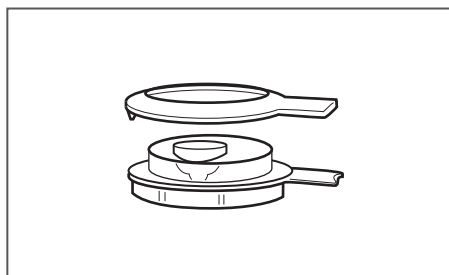

OPTIONAL: The lid ring can be removed for more detailed cleaning, if necessary.

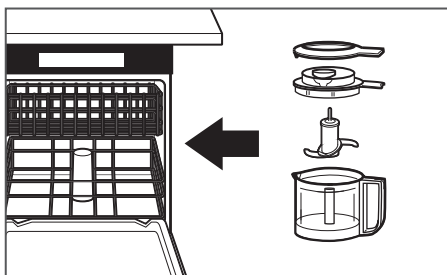

- 2 The work bowl, lid, lid ring and blade can be washed in the top dishwasher rack; or, wash all parts in hot, soapy water. Rinse and dry.

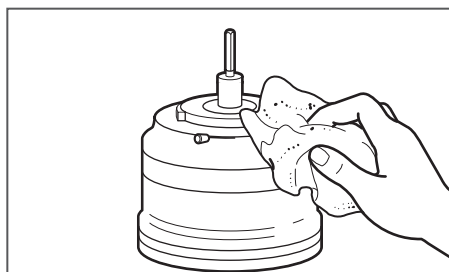

- 3 Wipe the base clean with a damp cloth. Do not use abrasive cleaners. Do not immerse the base in water.

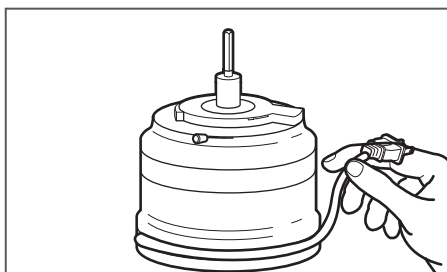

- 4 Wrap the cord counterclockwise around the base for easy storage.

NOTE: For convenient storage, always reassemble the Mini Food Processor after cleaning.

FOR DETAILED INFORMATION ON CLEANING THE MINI FOOD PROCESSOR:

Visit kitchenaid.com/quickstart for additional instructions with videos, inspiring recipes, and tips on how to use your Mini Food Processor.

WARRANTY AND SERVICE

KITCHENAID® MINI FOOD PROCESSOR WARRANTY FOR THE 50 UNITED STATES, THE DISTRICT OF COLUMBIA, PUERTO RICO, AND CANADA

This warranty extends to the purchaser and any succeeding owner for Mini Food Processors operated in the 50 United States, the District of Columbia, Puerto Rico, and Canada.

Length of Warranty:	One Year Full Warranty from date of purchase.
KitchenAid Will Pay for Your Choice of: 	Hassle-Free Replacement of your Mini Food Processor. See the next page for details on how to arrange for service, or call the Customer eXperience Center toll-free at 1-800-541-6390 . OR The replacement parts and repair labor costs to correct defects in materials and workmanship. Service must be provided by an Authorized KitchenAid Service Center.
KitchenAid Will Not Pay for:	<ul style="list-style-type: none"> A. Repairs when your Mini Food Processor is used in other than normal single family home use. B. Damage resulting from accident, alteration, misuse or abuse. C. Any shipping or handling costs to deliver your Mini Food Processor to an Authorized Service Center. D. Replacement parts or repair labor costs for Mini Food Processors operated outside the 50 United States, District of Columbia, Puerto Rico, and Canada.
<p>DISCLAIMER OF IMPLIED WARRANTIES; LIMITATION OF REMEDIES</p> <p>IMPLIED WARRANTIES, INCLUDING TO THE EXTENT APPLICABLE WARRANTIES OF MERCHANTABILITY OR FITNESS FOR A PARTICULAR PURPOSE, ARE EXCLUDED TO THE EXTENT LEGALLY PERMISSIBLE. ANY IMPLIED WARRANTIES THAT MAY BE IMPOSED BY LAW ARE LIMITED TO ONE YEAR, OR THE SHORTEST PERIOD ALLOWED BY LAW. SOME STATES AND PROVINCES DO NOT ALLOW LIMITATIONS OR EXCLUSIONS ON HOW LONG AN IMPLIED WARRANTY OF MERCHANTABILITY OR FITNESS LASTS, SO THE ABOVE LIMITATIONS OR EXCLUSIONS MAY NOT APPLY TO YOU.</p> <p>IF THIS PRODUCT FAILS TO WORK AS WARRANTED, CUSTOMER'S SOLE AND EXCLUSIVE REMEDY SHALL BE REPAIR OR REPLACEMENT ACCORDING TO THE TERMS OF THIS LIMITED WARRANTY. KITCHENAID AND KITCHENAID CANADA DO NOT ASSUME ANY RESPONSIBILITY FOR INCIDENTAL OR CONSEQUENTIAL DAMAGES. This warranty gives you specific legal rights and you may also have other rights which vary from state to state or province to province.</p>	

WARRANTY AND SERVICE

HASSLE-FREE REPLACEMENT WARRANTY – 50 UNITED STATES, DISTRICT OF COLUMBIA, AND PUERTO RICO

We're so confident the quality of our products meets the exacting standards of KitchenAid that, if your Mini Food Processor should fail within the first year of ownership, KitchenAid will arrange to deliver an identical or comparable replacement to your door free of charge and arrange to have your original Mini Food Processor returned to us. Your replacement unit will also be covered by our one year limited warranty.

If your Mini Food Processor should fail within the first year of ownership, simply

call our toll-free Customer eXperience Center at **1-800-541-6390** Monday through Friday. Please have your original sales receipt available when you call. Proof of purchase will be required to initiate the claim. Give the consultant your complete shipping address. (No P.O. Box numbers, please.)

When you receive your replacement Mini Food Processor, use the carton, packing materials, and prepaid shipping label to pack up your original Mini Food Processor and send it back to KitchenAid.

HASSLE-FREE REPLACEMENT WARRANTY – CANADA

We're so confident the quality of our products meets the exacting standards of the KitchenAid brand that, if your Mini Food Processor should fail within the first year of ownership, we will replace your Mini Food Processor with an identical or comparable replacement. Your replacement unit will also be covered by our one year limited warranty.

If your Mini Food Processor should fail within the first year of ownership, simply call our toll-free Customer eXperience

Centre at **1-800-807-6777** Monday through Friday. Please have your original sales receipt available when you call. Proof of purchase will be required to initiate the claim. Give the consultant your complete shipping address.

When you receive your replacement Mini Food Processor, use the carton, packing materials, and prepaid shipping label to pack up your original Mini Food Processor and send it back to KitchenAid.

ARRANGING FOR SERVICE AFTER THE WARRANTY EXPIRES, OR ORDERING ACCESSORIES AND REPLACEMENT PARTS

In the United States and Puerto Rico:

For service information, or to order accessories or replacement parts, call toll-free at **1-800-541-6390** or write to:

Customer eXperience Center,
KitchenAid Small Appliances,
P.O. Box 218, St. Joseph, MI 49085-0218

Outside the United States and Puerto Rico:

Consult your local KitchenAid dealer or the store where you purchased the Mini Food Processor for information on how to obtain service.

For service information in Canada:

Call toll-free **1-800-807-6777**.

For service information in Mexico:

Call toll-free **01-800-0022-767**.

DISCOVER MORE. DÉCOUVREZ PLUS. DESCUBRA MÁS.
KITCHENAID.COM/QUICKSTART

PRODUCT QUESTIONS OR RETURNS
QUESTIONS SUR LE PRODUIT OU LES RETOURS
PREGUNTAS SOBRE EL PRODUCTO O DEVOLUCIONES

USA: 1.800.541.6390 | KitchenAid.com
CANADA: 1.800.807.6777 | KitchenAid.ca
MEXICO: KitchenAid.com.mx
LATIN AMERICA: KitchenAid-latam.com



KitchenAid[®]
FOR THE WAY IT'S MADE.[®]

®/™ © 2016 KitchenAid. All rights reserved. KITCHENAID and the design of the Stand Mixer are trademarks in the U.S. and elsewhere. Used under license in Canada.

®/™ © 2016 KitchenAid. Tous droits réservés. KITCHENAID et la forme du batteur sur socle sont des marques de commerce aux E.-U. et dans d'autres pays. Utilisé sous licence au Canada.

®/™ © 2016 KitchenAid. Todos los derechos reservados. KITCHENAID y el diseño de la batidora con base son marcas registradas en EE.UU. y en otras partes. Usada en Canadá bajo licencia.