

说明书制作要求

材质：105g哑粉

成品尺寸：110x134mm，共24P

印刷：单k

装订方式：骑马钉，按照顺序装订



Solar-Powered Security Camera System

SolarCam Max/Pro System

Quick Start Guide



United States: +1-866-905-9950 Mon-Fri 9AM-5PM

United Kingdom: +44-20-3885-0830 Mon-Fri 9AM-5PM (GMT)

Germany: +49-32-221094692 Mon-Fri 9:00-17:00

Japan: +81-50-5840-2601 Mon-Fri 9AM-5PM (JST)



www.aosulife.com



[@aosulife](https://www.facebook.com/aosulife)



support@aosulife.com

TABLE OF CONTENTS

01	What's Included	P01
02	Product Overview	P02-P03
03	Connecting the Homebase	P04
04	Setting Up the System	P05
05	Mounting the SolarCam Max/Pro	P06-P09
06	Installation Instruction of Solar Panel	P10-P14
07	Charging the Camera	P15
08	Notice	P16-P18
09	Customer Service	P19

What's Included

SolarCam Max/Pro



SolarCam Max/Pro
x2



USB-C Charging
Cablex2



Mounting Bracket
x2



Mounting Base
x2



1 Mounting Screws
and Anchorsx2



Quick Start Guide



HomeBase



Power Adapter
for HomeBase



EthernetCable

Solar Panel x2



Solar Panel



Universal Joint



Socket nut



Locking
Screw Cap



Base

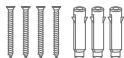

2 Mounting Screws
and Anchors

Product Overview

SolarCam Max/Pro

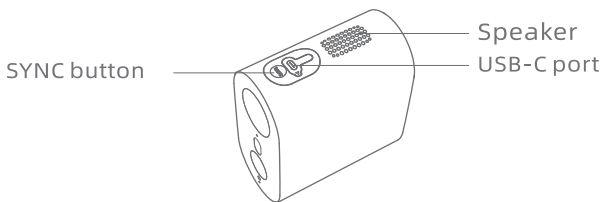
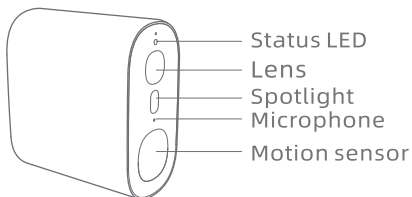

Product Overview

HomeBase

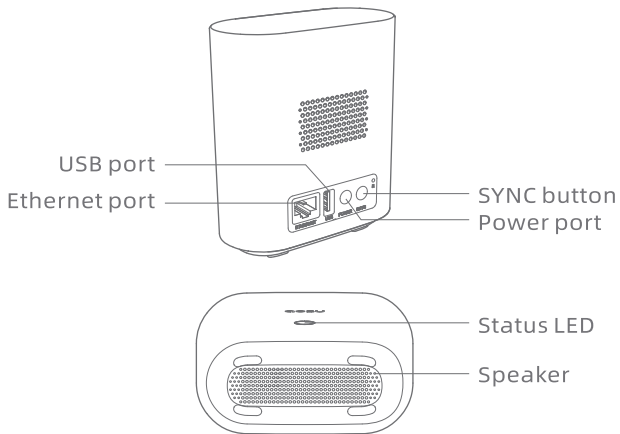

Connecting the Homebase

Connect the HomeBase to the Internet

1. Power on the HomeBase, then use the ethernet cable provided to connect the HomeBase to your home router.

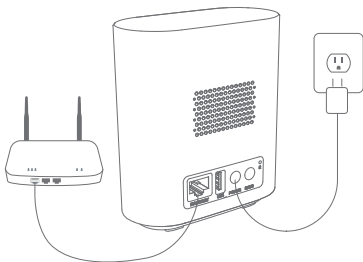

2. The LED indicator turns green (this may take up to 1min) when HomeBase is ready for setup.



Setting Up the System

Download the App and Set up the System

Download the **Aosu** App from the App Store (iOS devices) or Google Play (Android devices).



Sign up for an **Aosu** App account, then follow the onscreen instructions to complete the setup.

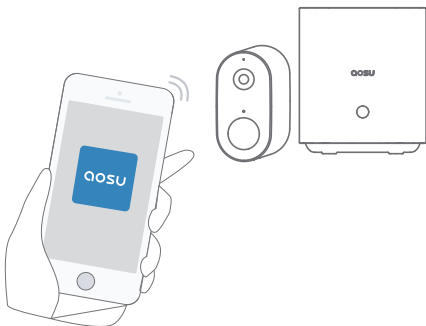

Mounting the SolarCam Max/Pro

Find a Good Mounting Spot

To find a spot to mount SolarCam Max/Pro, you need to test wireless signal strength.

- ① Open the **Aosu** App, go to Camera Settings > Mounting Guide.
- ② To test the wireless signal strength, take your camera and phone to the location where you want to mount the camera.
- ③ Move the camera as close to the Wi-Fi Router as possible to get a better signal.



Select Height and Location

Hang SolarCam Max/Pro SE 7-10 ft (2-3 m) above the ground. This height maximizes the detection range of the motion sensor of SolarCam Max/Pro.

Avoid placing SolarCam Max/Pro under direct sunlight.

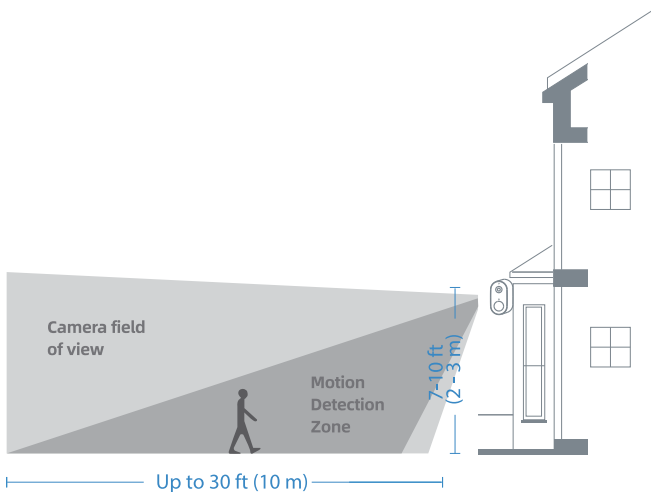

Mount the Camera

1. Drill holes with a 15/64 inch (5.95mm) drill bit, then insert the anchors into the holes; anchors are necessary for walls that are made out of hard materials such as concrete, brick, or stucco. Firmly nail the mounting base onto the wall.

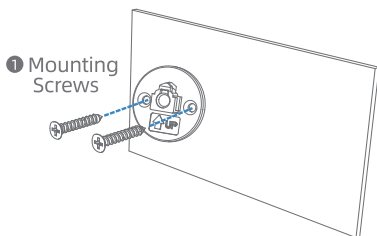

2. Tighten the camera to the mounting bracket.

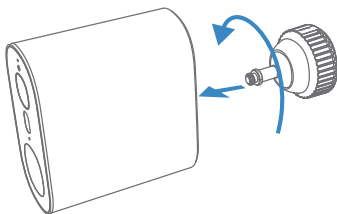

Mount the Camera

3. Accurately snap the camera to the mounting base.

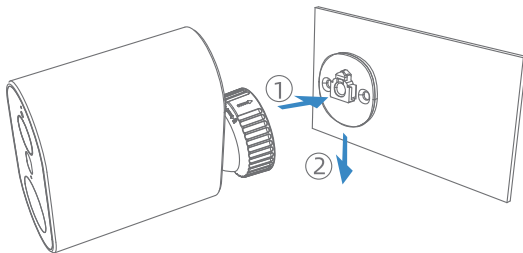

4. Adjust the viewing angle by checking the live stream feed in the **aosu** App.

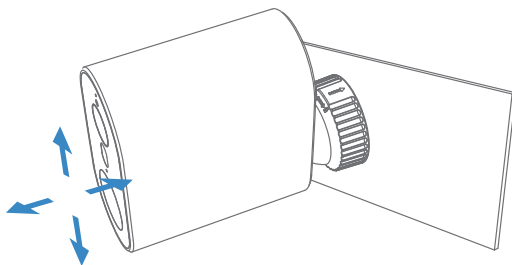

Installation Instruction of Solar Panel

Place Solar Panel in an area with consistent sunlight throughout the year. It only needs a few hours of direct sunlight each day to keep your camera powered.

The amount of energy that the solar panel produces is affected by weather conditions, seasonal changes, geographic location, etc.

1. Fix the base to your mounting location using the included screws. If the installation surface is soft or unstable, first use a $\phi 6.0$ drill bit to drill a hole in the wall, then insert the anchor nail into the hole, and fix the base with screws.

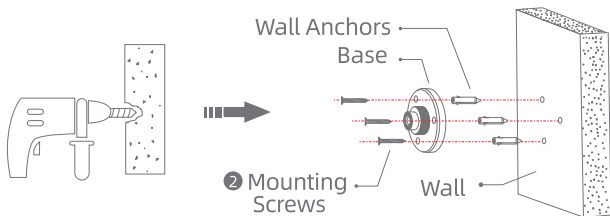

2. First, install the locking screw cap into the universal joint and then screw the circular socket nut into the universal joint.

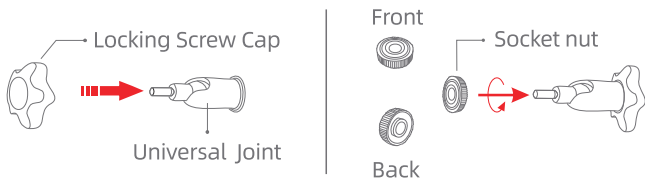

3. Screw the universal joint into the back of the solar panel. Tighten it firmly with the attached nut.

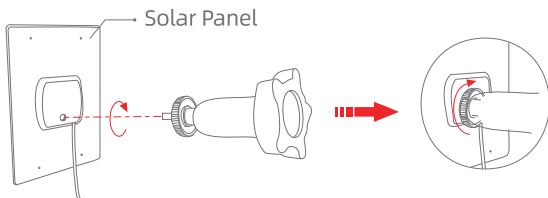

4. Screw the locking screw cap into the base. Make sure that the universal joint is angled upward.

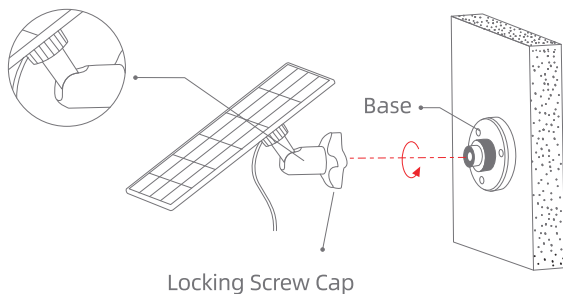

5. When adjusting the solar panel left or right, loosen the locking screw cap, turn the sleeve rod, and tighten the locking screw cap when the panel is in position.

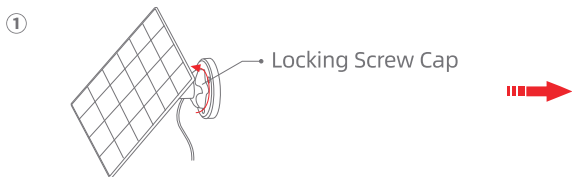

②

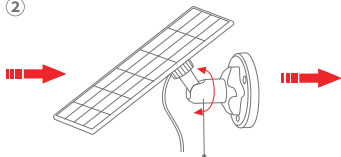

Sleeve Rod

③

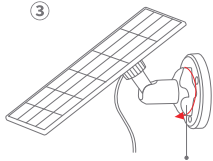

Locking Screw Cap

6. Solar panel's angle can be adjusted up and down up to 90°.

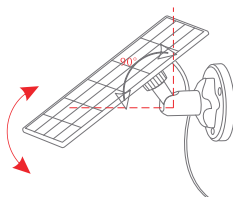

Tip: After the installation is complete, please check that all locking mechanisms are tightly secured.

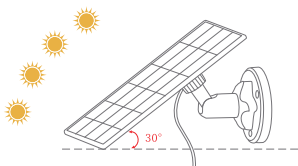

1. keep the installation angle of solar panels about 30-45° with the horizontal plane, as shown in the picture below.
2. The installation between the solar panel and the camera is shown in the following figure (open up the silicone cover at the bottom of the camera, insert the power cord through the opening and plug it into the USB-C Charging Port and then close the cover taking up any slack in the power cord from the solar panel).

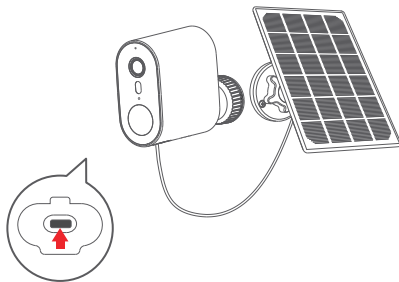

2. Tighten the camera to the mounting bracket.

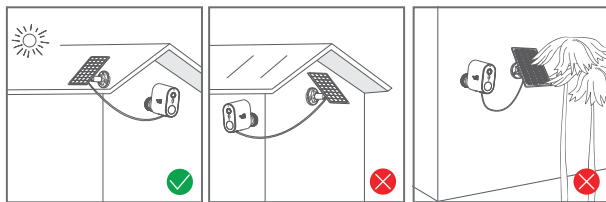

Charging the Camera

Download the App and Set up the System

LED indication	
Charging	Green light flashing
Fully charged	Steady green
Charging time	
7 hours	

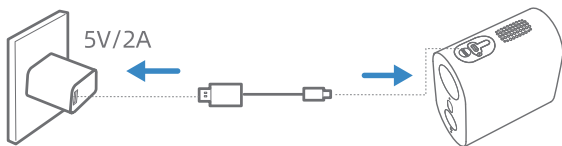

SolarCam Max/Pro comes with a built-in battery. Before setup, fully charge your SolarCam using the provided USB-C Charging cable.

Notice

FCC Statement

This device complies with Part 15 of the FCC Rules. Operation is subject to the following two conditions: (1) this device may not cause harmful interference, and (2) this device must accept any interference received, including interference that may cause undesired operation.

Warning: Changes or modifications not expressly approved by the party responsible for compliance could void the user's authority to operate the equipment. Note: This equipment has been tested and found to comply with the limits for a Class B digital device, pursuant to Part 15 of the FCC Rules. These limits are designed to provide reasonable protection against harmful interference in a residential installation.

This equipment generates uses and can radiate radio frequency energy and, if not installed and used in accordance with the instructions, may cause harmful interference to radio communications. However, there is no guarantee that interference will not occur in a particular installation. If this equipment does cause harmful interference to radio or television reception, which can be determined by turning the equipment off and on, the user is encouraged to try to correct the interference by one or more of the following measures: (1) Reorient or relocate the receiving antenna. (2) Increase the separation between the equipment and receiver. (3) Connect the equipment into an outlet on a circuit different from that to which the receiver is connected. (4) Consult the dealer or an experienced radio/TV technician for help.

FCC Radio Frequency Exposure Statement

The device has been evaluated to meet general RF exposure requirements.

The device can be used in fixed/mobile exposure condition. The minimum separation distance is 20cm.



This product complies with the radio interference requirements of the European Community.

Declaration of Conformity

Hereby, Glazero Limited declares that this device is in compliance with the essential requirements and other relevant provisions of Directive 2014/53/EU.

For the declaration of conformity, visit the Web site: <https://www.aosulife.com/>.

This product can be used across EU member states.

Do not use the Device in the environment at too high or too low temperature, never expose the Device under strong sunshine or too wet environment.

The suitable temperature for HomeBase and accessories is -10°C-45°C.

The suitable temperature for Video Doorbell and accessories is -20°C - 40°C .

When charging, please place the device in an environment that has a normal room temperature and good ventilation.

It is recommended to charge the device in an environment with a temperature that ranges from 5°C~25°C.

RF exposure information: The Maximum Permissible Exposure (MPE) level has been calculated based on a distance of $d=20$ cm between the device and the human body. To maintain compliance with RF exposure requirement, use product that maintain a 20cm distance between the device and human body.

For HomeBase: Wi-Fi Operating Frequency Range: 2412~2472MHz ;

Wifi Max Output Power: 17.13dBm(EIRP)

Wi-Fi Operating Frequency Range: 5150MHz ~ 5850MHz, Wifi Max

Output Power: 13.7dBm(EIRP)

For Video Doorbell :

Wi-Fi Operating Frequency Range: 2412~2472MHz ; Wi-Fi Max Output

Power: 18.30 dBm



This product is designed and manufactured with high quality materials and components, which can be recycled and reused.



This symbol means the product must not be discarded as household waste, and should be delivered to an appropriate collection facility for recycling. Proper disposal and recycling helps protect natural resources, human health and the environment. For more information on disposal and recycling of this product, contact your local municipality, disposal service, or the shop where you bought this product.



Battery Warning

- Replacement of a battery with an incorrect type that can defeat a safeguard (for example, in the case of some lithium battery types).
- Disposal of a battery into fire or a hot oven, or mechanically crushing or cutting of a battery, that can result in an explosion.
- Leaving a battery in an extremely high temperature surrounding environment that can result in an explosion or the leakage of flammable liquid or gas.
- A battery subjected to extremely low air pressure that may result in an explosion or the leakage of flammable liquid or gas.

Customer Service

Warranty

12-month limited warranty (The actual warranty period shall be implemented according to the requirements of local laws and regulations)

Email Us

Customer Support: support@aosulife.com

Call Us

United States: +1-866-905-9950 Mon-Fri 9AM-5PM

United Kingdom: +44-20-3885-0830 Mon-Fri 9AM-5PM (GMT)

Germany: +49-32-221094692 Mon-Fri 9:00-17:00

Japan: +81-50-5840-2601 Mon-Fri 9AM-5PM (JST)



Facebook: [@aosulife](#)



Twitter: [@aosulife](#)



YouTube: [@aosulife](#)

nosu