

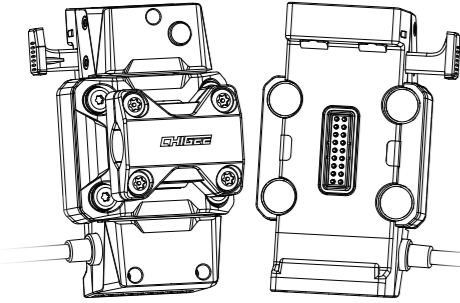

CG Navigator holder for BMW
CG 宝马电动快拆底座



User Instruction
使用说明书

MPack0617

Product Overview (产品概述)

The CG BMW Electric Quick-Release Mount is specifically designed for BMW models equipped with the original LIN protocol power interface. The mount supports the BMW NAV LIN bus protocol, enabling transmission of vehicle data to compatible display units and providing Wonder Wheel control signals. It also supports the BMW LIN bus protocol, allowing original vehicle data—such as vehicle speed, engine RPM, total mileage, temperature, and lean angle—to be transmitted to compatible display units.

CG 宝马电动快拆底座专为配备 BMW 原装 LIN 协议电源接口的宝马摩托车设计。底座支持BMW NAV LIN总线协议，可向兼容车机传输原车数据，并提供 Wonder Wheel 滚轮控制信号。底座支持BMW LIN总线协议，可将原车数据传至兼容车机(如车速、转速、总里程、温度、倾角等)。

Package Contents (产品清单)

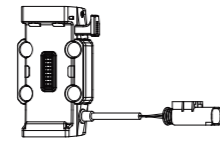

Electric Quick-Release Mount x1
电动快拆底座 x1



Disassembly Tool Kit x1
拆装工具包 x1

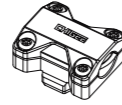

12-16mm Crossbar Mounting Base x1
12-16mm 横杆安装底座 x1

Parts Description (部件详情)

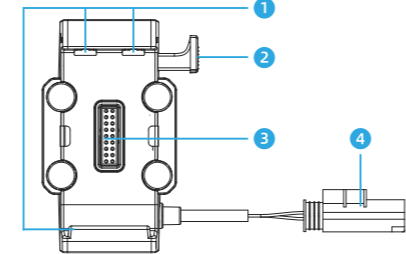

- ① Mounting latch hooks (底座安装卡扣) fit the BMW OEM Navigator mounting interface 适配BMW原厂车机安装卡口
- ② Release lever (脱扣推杆) press to release the latch and remove the display (only when unlocked) 按压以释放卡扣，用于取下车机(需在已解锁状态下)
- ③ 18-pin data connector (18PIN通讯连接器) plugs into the BMW OEM infotainment data port (vehicle data + Wonder Wheel signals) 适配BMW原装车机数据接口(用于数据与滚轮控制信号传输)
- ④ Power connector (底座供电插头) compatible with the BMW OEM LIN power plug (12V supply) 适配BMW原装LIN协议电源插头(12V供电)

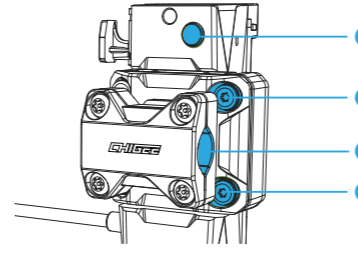

- ⑤ Unlock button (ignition ON) (解锁按键(需上电)) Press and hold the button for 2 seconds to unlock. After releasing, press the release lever within 10 seconds to remove the display; after 10 seconds, it will automatically relock. 长按按键2秒解锁。松开后请在10秒内按下脱扣推杆即可取下车机;超过10秒将自动重新上锁。
- ⑥ Fits Ø12/Ø16 crossbar (适配 Ø12-Ø16 横杆) Includes a mounting clamp for Ø12-Ø16 crossbars. 包装内含支架，适配 Ø12-Ø16 横杆。
- ⑦ 4-point silicone dampers (四点硅胶减震) Four silicone dampers help reduce vibration for a more stable mount. 四点硅胶减震用于降低震动传递，提升骑行稳定性与观感。

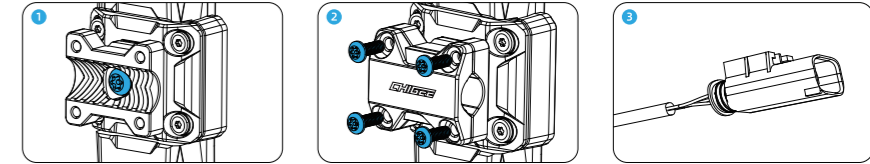

- ① Attach the lower half of the horizontal rod clamp to the base. 将横杆管夹下半部分固定至底座上。
- ② Mount the base onto the Ø12-Ø16mm horizontal rod, securing it firmly with the four screws. 将底座安装到Ø12-Ø16mm的横杆上，并拧紧4颗螺丝牢固固定。
- ③ Plug the base's power connector into the BMW OEM LIN protocol power interface. Once powered, the system will be ready for use. 随后将底座供电插头接入BMW原厂LIN协议电源接口，为底座供电后即可正常使用。

Professional installation is recommended. Route cables away from heat sources and moving parts, and avoid pinching or tension. For 12V systems only-do not connect to 24V. 建议由具备经验的技师安装。布线需避开高温与活动部件，避免拉扯与夹线。仅适用于DC 12V 系统，请勿接入24V。

Anti-Theft & Quick Release (防盗与快拆机制)

The cradle has a built-in electromagnetic lock-no physical key required. 底座内置电磁锁，无需实体钥匙。

- Ignition OFF / unpowered: the cradle stays locked, and the display cannot be removed. 车辆熄火/断电:底座保持上锁，无法拆下车机。
- Ignition ON / powered: Hold the unlock button for 2 seconds to unlock. Then press the release lever to remove the display. 车辆上电:长按解锁键两秒，即可解锁。随后按压脱扣推杆即可取下车机。

Latch status window (卡扣状态指示窗)

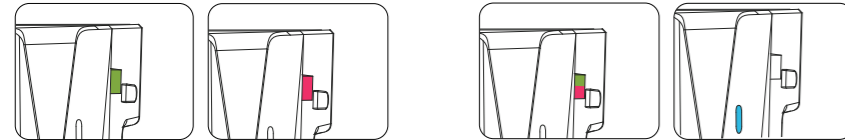

- Green: fully latched (ready to ride)
绿色:已扣紧，可正常使用
- Red: unlatched/released
红色:已脱扣/未锁定
- *The latch status window is located at the upper-left of the cradle and indicates the latch status. 卡扣状态指示窗位于底座左上方，用于显示锁扣状态。
- Half red/half green = not fully seated (do not ride-reinstall and confirm it clicks in)
半红半绿:未完全扣紧(请勿骑行，请重新安装并确认到位)
- Button LED (blue): Lights up when the unlock button is pressed. 按键指示灯(蓝色):按下解锁按键时点亮，用于提示按键动作已触发。

Emergency release procedure (应急解锁操作步骤)

当底座故障或摩托车无法通电，导致无法通过解锁按键解锁时
If the cradle fails or the bike has no power and you can't unlock using the button:

- Use the included T6 Torx tool to remove the two screws. 使用配件包内的T6扳手，拧下盖子上的2颗螺丝。
- Open the emergency release cover to access the manual release mechanism inside. 打开应急解锁盖，内部为应急解锁装置。

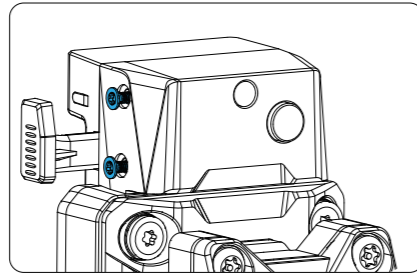

T6 screws (use the included T6 tool)
T6螺丝 (配件包内T6扳手)

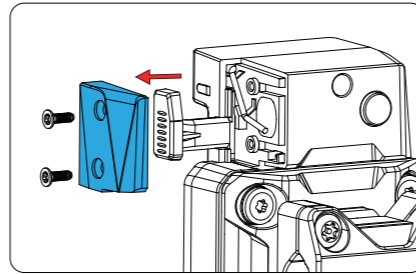

Emergency release cover
应急解锁盖

- With the cover open, move the override pin in the direction shown and hold it in the UNLOCK position. 打开应急解锁盖后，按箭头方向拨动拨针，并保持拨针在解锁位置。
- While holding the pin, press the release lever to remove the display. 同时按压脱扣推杆，即可取下车机。
- After removal, return the pin to its normal position and reinstall the cover and screws. 取下后请复位拨针，并装回应急解锁盖与螺丝。

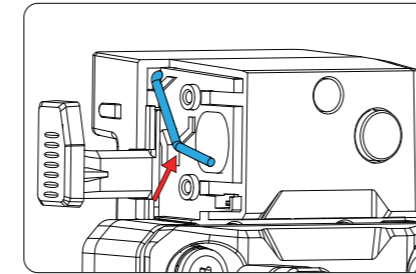

Override pin (hold in UNLOCK)
拨针 (保持在解锁位)

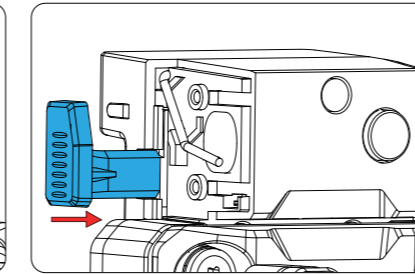

Press release lever to remove
按压脱扣推杆取下车机

Product Specifications (产品规格)

Dimensions (尺寸)	91 x 53 x 55 mm
Clamp fitment (标配管夹适配管径)	Ø12-Ø16 mm
Materials (材料)	Cradle body: PC + 10% GF; Clamp: Aluminum alloy 底座PC+10%GF;管夹铝合金
Cable length (线材长度)	70 cm
Operating voltage (工作电压)	DC 12V
Fuse rating (保险丝规格)	3A
Waterproof rating (防水等级)	IP69K
Power connector (底座供电插头)	Compatible with BMW OEM LIN-protocol power plug 适配宝马原装LIN协议电源插头
18-pin communication connector (底座18PIN通讯连接器)	Compatible with BMW OEM infotainment data port 适配宝马原装车机数据接口
Mounting latch interface (底座安装卡扣)	Compatible with BMW OEM head-unit latch structure 适配宝马原装车机安装卡口

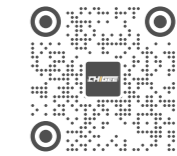

扫描二维码
获取产品安装教程

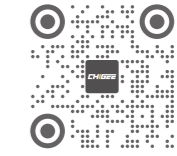

CHIGEE.COM

说明书内容如有更新，恕不另行通知
Makers/メーカー/제작자/Hersteller/creator/производители: CHIGEE Technology Co., Ltd
Address/住所/주소/Adresse/адрес: Building 5, Lingya Industrial Park, No. 1 Tangtou Road, Bao'an District, Shenzhen, China.
CHIGEE is a trademark of CHIGEE Copyright ©2021 CHIGEE All Rights Reserved
本产品由深圳市骑技科技有限公司授权生产
地址: 深圳市宝安区石岩街道领亚美生智慧绿谷5栋
执行标准: GB4943.1-2022



FCC Warning:

This equipment has been tested and found to comply with the limits for a Class B digital device, pursuant to part 15 of the FCC Rules. These limits are designed to provide reasonable protection against harmful interference in a residential installation. This equipment generates, uses and can radiate radio frequency energy and, if not installed and used in accordance with the instructions, may cause harmful interference to radio communications. However, there is no guarantee that interference will not occur in a particular installation. If this equipment does cause harmful interference to radio or television reception, which can be determined by turning the equipment off and on, the user is encouraged to try to correct the interference by one or more of the following measures:

- Reorient or relocate the receiving antenna.
- Increase the separation between the equipment and receiver.
- Connect the equipment into an outlet on a circuit different from that to which the receiver is connected.
- Consult the dealer or an experienced radio/TV technician for help.

Caution: Any changes or modifications to this device not explicitly approved by manufacturer could void your authority to operate this equipment.

This device complies with part 15 of the FCC Rules. Operation is subject to the following two conditions:

(1) This device may not cause harmful interference, and (2) this device must accept any interference received, including interference that may cause undesired operation.

This equipment complies with FCC radiation exposure limits set forth for an uncontrolled environment. This equipment should be installed and operated with minimum distance 20cm between the radiator and your body.