

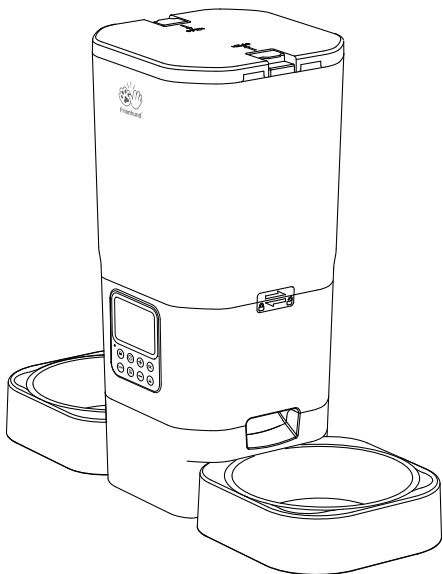

User Manual

Smart Pet Feeder with Two Bowls



Model: ACF200W

If the product is upgraded in the following please refer to the actual product in hand.

Contents

Safety Instructions	02
Warranty	03
Product Specifications	04
Packing List	05
Product Overview	06
Assembled Products	07
Screen Display Explanation	12
Key Operation Explanation	13
Indicator Lights & Screen Instructions	15
Program Settings	16
Disassemble for Cleaning	20
FAQ	20

Safety Instructions



Please do not use wet, canned or moist food.



This product uses 3 × D Cell Batteries(not included) as a backup power supply. Please use double power supply to ensure the normal use of the product.



Examine the feeder after installation. Do not plug in if there is water on the power cable or plug.



Do not immerse the base part in water at any time as it may damage electronic components.



Do not disassemble the feeder other than as instructed in this user manual.



Only use accessories recommended or sold by the manufacturer. The use of accessories not recommended or sold by the manufacturer may cause an unsafe condition.



Dispose of all packaging materials properly. Some items may be packed in plastic bags, these bags could cause suffocation.

Warranty

Any questions about the use of the product, you can contact our brand after-sales staff. We will solve your problem until it is resolved.

- ◆ **1-Year Warranty**
- ◆ **24/7 Online Support**

For guidance on product use and warranty extension, please contact our brand after-sales staff via email: **support@friehund.com**
If any questions related to orders, please contact the seller through the shopping platform.

- ◆ **Monday-Friday:**
Tel: 1-877-631-3655, (PST 8:00 am-5:00pm)

- ◆ **Scan the code to view installation Video, Feeding Program Setup Tutorial.**



Product Specifications

Product Name	Smart Pet Feeder with Two Bowls (ACF200W)
Suit For	Cat, Dog, Rabbit, Small Pets, Multiple Pets
Rated Voltage	5V / 1A
Product Power	5W
Power Supply	Power Adapter and 3× D Cell Batteries(not included)
Material	ECO-Friendly ABS
Product Size	180*470*400mm/7*18.5*15.75in
Product Weight	1.86kg/4.1lb
Product Capacity	7L
Pet Food	Dry Food
Portion Weight	10~15g(0.02~0.03lb)

Packing List

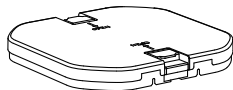

Lid*1



Power Adapter*1



Desiccant*1

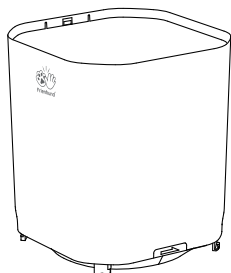

Food Tank*1



USB Cable*1



Desiccant Compartment*1



ABS Wall Hook*1



Anchors*4



Screws*4



Stainless Steel Feeding Bowl*2

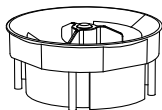

Meal Splitter*1

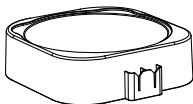

Bowl Tray*2

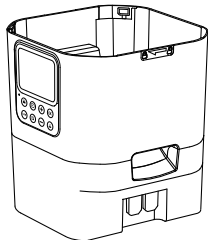

Feeder Base*1



User Manual*1

Product Overview

1	Lid
2	Desiccant
3	Desiccant Compartment
4	Food Tank
5	Meal Splitter
6	Control Panel
7	Food Outlet
8	Stainless Steel Feeding Bowls
9	Bowl Trays

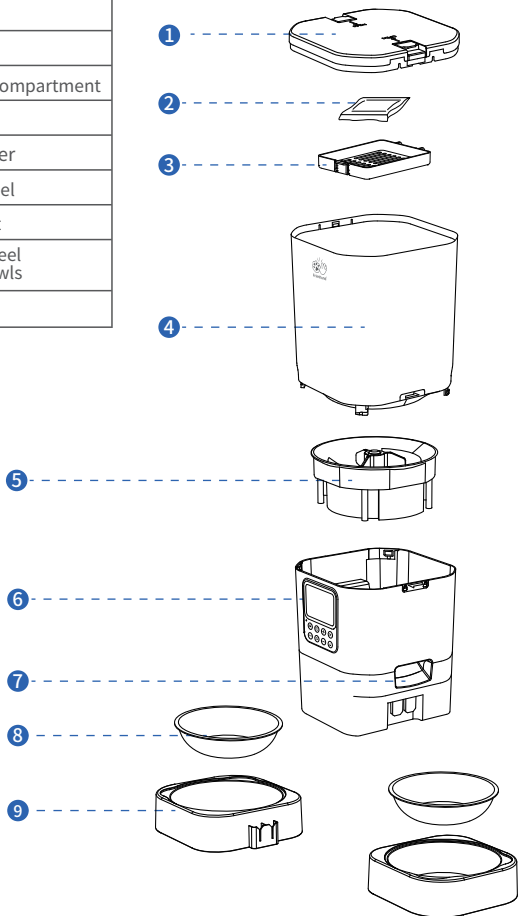

Assembled Products

Step 1 Connecting Power

1

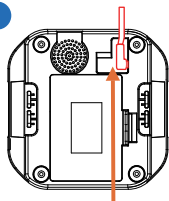

Power Cable

- Plug the 5V power adapter into the bottom of the feeder.

2

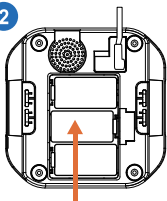

Battery

- Install 3× D Cell Batteries (not include) in the bottom of the feeder in case of power outages in the home.

3

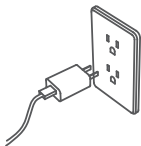

- Plug in the home power supply.

Step 2 Meal Splitter Installation

5

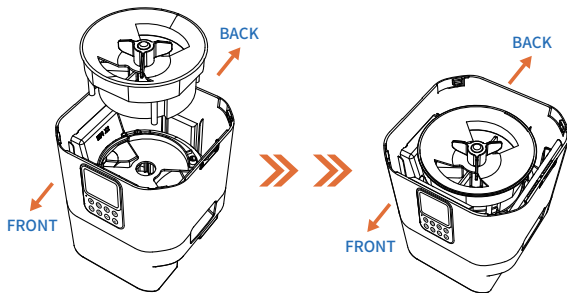

Step 3 Food Tank Installation

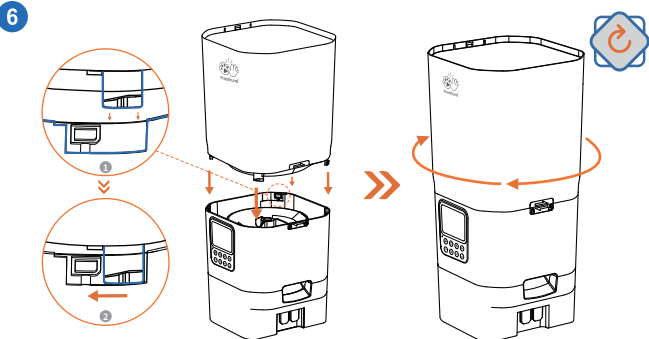

- Install as shown.
- The opening in the bottom of the food tank should match the opening in the base of the feeder, then turn clockwise to lock.

Step 4 Feeder Base Installation

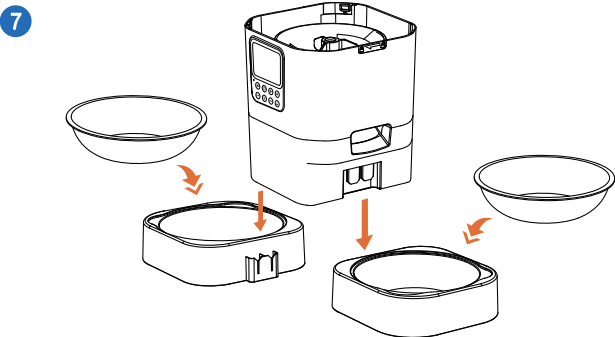

- Place the stainless steel bowl into the bowl tray.
- Insert the bowl tray into the feeder base.

Step 5 Add Food

8

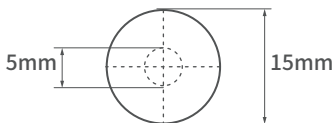
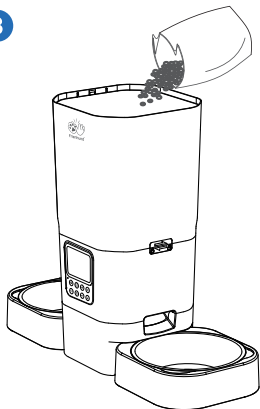

⚠ Note:

1. Please pour in dry food, not wet food or canned food.
2. Recommended food size: 5-15mm (0.19-0.59in)

9

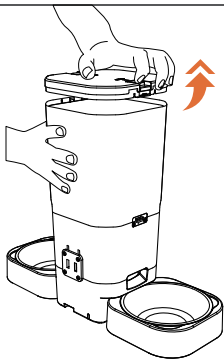
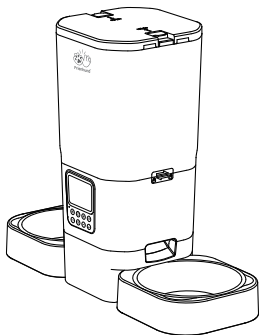

- Close the lid

Tips:

Please refer to the picture to open the feeder lid.

Step 6 Wall Hook Installation

1

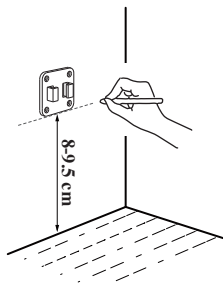

- Place the wall hook on the wall and mark the holes using a pen.
Note: The wall hook must be kept 8-9.5cm (3.15-3.75in) away from the floor.

2

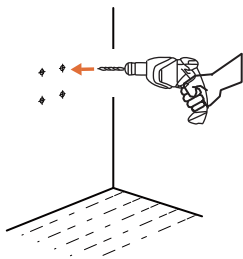

- Use an impact drill to drill the holes
Note: Use a 1/4" (6mm) diameter drill bit.

3

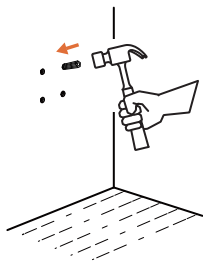

- Use a hammer to tap the plastic wall anchors plug into the hole, flush with the wall.

4

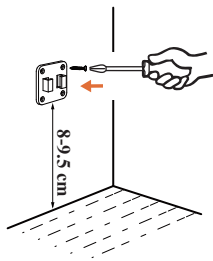

- Tighten screws to secure wall hook.

5

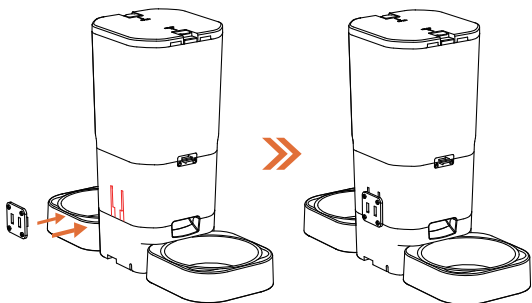

6

- Align the holes on the back of the feeder with the hooks on the wall hook and slide down.
- Installation completed.

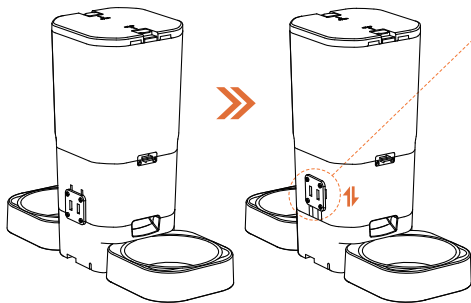

Screen Display Explanation

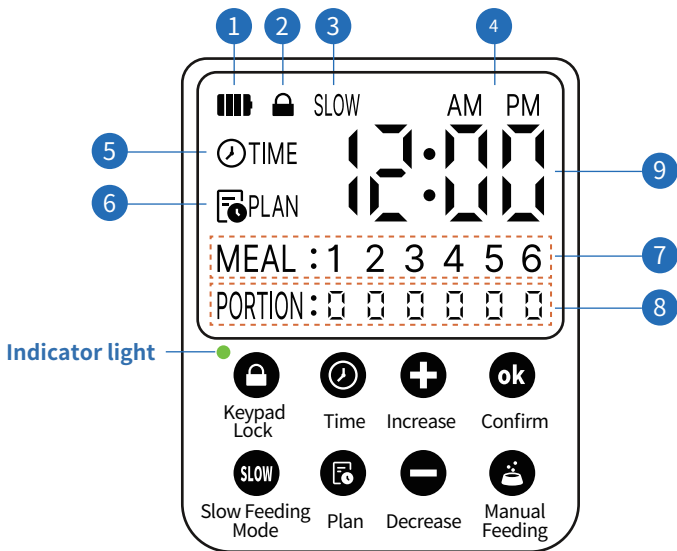



- 1 Battery Level Display** : Displays the power status of the powered battery only when it is powered by the battery. When the power supply is used, the battery level status is not displayed.
- 2 Keypad Lock**: When the icon is displayed, it means that the keys are all locked, and when the icon disappears, it means that the keys are all unlocked.
- 3 Slow Feeding Mode**: When the SLOW icon is displayed, all feeding schedules turn on Slow Feeding mode. When the icon disappears, all feeding schedules turn off Slow Feeding mode.
- 4 AM/PM**: The feeder uses a twelve-hour system, with AM indicating morning and PM indicating afternoon.

- 5 **System Time Setting:** When entering the system time setting, only this icon is displayed, indicating that the current time setting is the system time setting.
- 6 **Feeding Schedule Setup:** When entering PLAN settings, only this icon is displayed, indicating that the current time setting is the time setting for the meals in the feeding schedule.
- 7 **MEAL:** Indicates the number of meals for the feeding schedule. You could set 6 meals a day.
- 8 **PORTION:** Indicates the number of portions set per meal, up to 9 portions per meal. When the value is 0, it means that the meal does not perform any feeding schedule.
- 9 **Interface Time:** When on the main interface, the time indicates the daily usage time. In the system time settings interface, it represents the daily time settings. In the feeding schedule settings interface, it denotes the execution time of the feeding schedule for that meal.





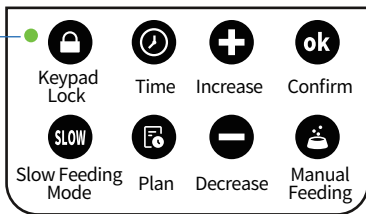

Key Operation Explanation

Indicator light



-  **Green Light:**
Normal (Battery Power Only)
-  **Red Light Flashing:**
Low Battery (Battery Power Only)
-  **Red Light Slow Flashing:**
System Failure



- Press and hold for 2 seconds to lock or unlock all buttons, the device will emit a reminder tone if the lock or unlock is successful.

 Time	<ul style="list-style-type: none"> • Short press to start setting the system time and short press "ok" button to complete the setting.
 Increase  Decrease	<ul style="list-style-type: none"> • Short press to increase or decrease the number slowly, long press to adjust the number quickly. • Press "+" and "-" simultaneously for 3 seconds to restore factory settings.
 Confirm	<ul style="list-style-type: none"> • Short press to complete the setting of system time or feeding schedule. • In any interface, long press for 3 seconds can directly return to the main interface. (Example: When you have finished setting up the third feeding schedule and do not need to set up the fourth feeding schedule, you can long press "ok" button to end the feeding plan setting early and return to the main interface.)
 Slow Feeding Mode	<ul style="list-style-type: none"> • In any situation, press and hold the "SLOW" button for 2 seconds to turn on the Slow Feeding mode . When Slow Feeding mode is on, all feeding plans will release one portion of food every minute while they are being executed.
 Plan	<ul style="list-style-type: none"> • Short press to enter the setting interface of feeding schedule, first set the execution time of this meal, then set the number of portions of this meal. Press "ok" button to enter the next setting.
 Manual Feeding	<ul style="list-style-type: none"> • Short press releases one portion of food. • Long press keeps releasing food.

Indicator Lights & Screen Instructions

Power Supply Mode	 or 	
Indicator Status	<ul style="list-style-type: none"> • Only Power Supply • Power Supply & Battery Power <p>○ Normal State: No light</p> <p>● System Failure: Indicator light up red for 3 seconds, then goes out for 3 seconds, and the cycle continues. (You can contact our after-sales support for assistance)</p>	<ul style="list-style-type: none"> • Only Battery Power <p>● Normal State: Green light always on.</p> <p>● Low Battery: Indicator light red for 1 second, then off for 1 second, and the cycle continues.</p> <p>● System Failure: Indicator light up red for 3 seconds, then goes out for 3 seconds, and the cycle continues. (You can contact our after-sales support for assistance)</p>
Screen Status	<ul style="list-style-type: none"> • Screen Always On 	<ul style="list-style-type: none"> • If no operation is performed within 2 minutes, the screen will enter sleep mode. • When in sleep mode, the screen will light up during the execution of the feeding schedule. After the feeding schedule is completed, the screen will automatically turn off after 6 seconds and re-enter sleep mode. <p>Tips: When the screen is in sleep mode, pressing any button can wake it up.</p>

Program Settings

• System Time Setting

Example 1: Adjust the system time of the feeder to 6:15 AM.

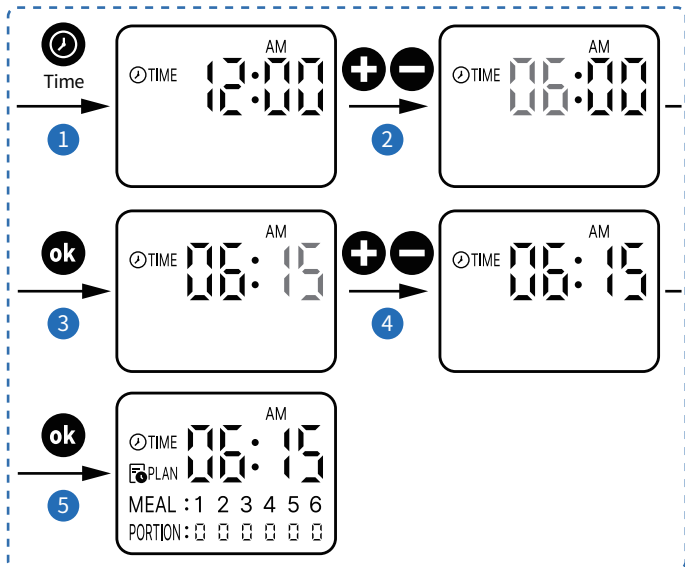

- 1 Short press **⌚** to enter system time setting.
- 2 Adjust the number of hours to 6 by **+** **-**.
- 3 Click **ok** to confirm information, go to next step.
- 4 Adjust the number of minutes to 15 by **+** **-**.
- 5 Click **ok** to confirm information. The device emits a prompt tone, and the system time is set successfully.

Tips:

1. After entering the system time setting interface, short press  to switch between hours and minutes.

2. The feeder uses a 12-hour system, please pay attention to the distinction between AM/PM when you set the time.

3. If you only set the feeding schedule without setting the system time, it will lead to inaccurate feeding.

• Feeding Schedule Settings

 Note: Please set the system time before setting the feeding schedule, otherwise the feeding schedule will not be executed on time.

Example 1: Set up a feeding schedule for your pet:

Meals	Feeding Time	Feeding Portion
Meal 1	06:30 AM	3 portions
Meal 2	11:20 AM	2 portions
Meal 3	06:15 PM	3 portions

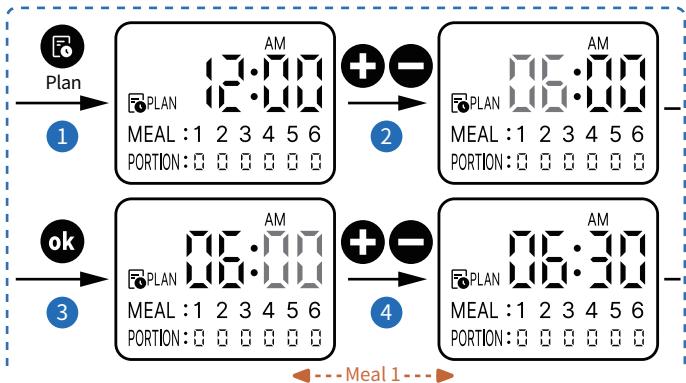

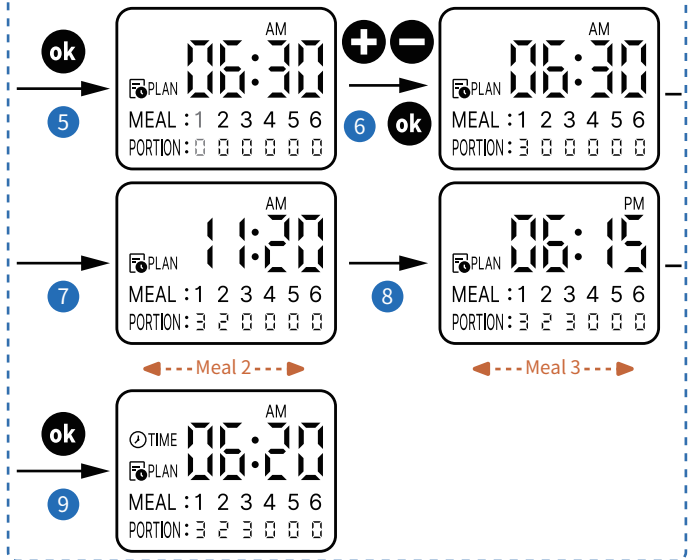



- 1 Short press **PLAN** to enter feeding schedule setting.
- 2 Adjust the number of hours to 6 by **+** **-**.
- 3 Click **ok** to confirm information, go to next step.
- 4 Adjust the number of minutes to 30 by **+** **-**.
- 5 Click **ok** to confirm information, go to next step.
- 6 Adjust the number of portion to 3 by **+** **-**. Click **ok** to confirm information, device emits a prompt tone, **Meal 1** setup complete.
- 7 Repeat steps 2-6 to complete the **Meal 2** setup.
- 8 Repeat steps 2-6 to complete the **Meal 3** setup.

- 9 Long press **ok** to return to the main interface, feeding schedule setting is completed.



Tips:

1. After entering the feeding schedule setting interface, short press  to switch between Meal 1-6.
2. The **PORTION** number shown on the display means the amount for each bowl.
3. It **Does Not** support to deliver different portions to each bowl.

• Manual Feeding Setting

- Short press on  to dispense a portion of food.
- Press and hold  to keep dispensing food.

• Reset the Feeder

Press and hold the  and  simultaneously for 3 seconds. The device will emit a prompt tone and restore the factory settings

Disassemble for Cleaning

We recommend to clean the feeder regularly for the health of your pet. The washable parts of the feeder are as follows: lid, food tank, meal splitter, stainless steel feeding bowls, bowl trays.

Washable Parts

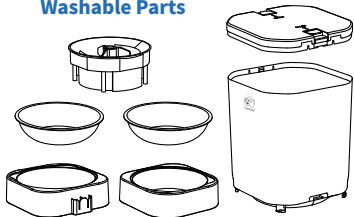

Do Not Wash

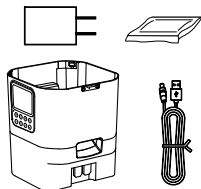

FAQ

- Q:** Why is the screen unresponsive when any button is pressed?
- A:** It is likely that the buttons are locked. Long-press the lock button for 2 seconds until you hear a "beep" and the lock icon disappears from the main interface. Then all buttons can be used normally.
- Q:** I forgot the content of the feeding schedule. How can I check it?
- A:** The "MEAL" section on the screen represents the parameters in the feeding schedule, and "PORTIONS" below corresponds to the number of portions to be executed for each meal. You can intuitively view the portion size required for each meal in the feeding schedule. If you need to check the feeding time for each meal, you can short-press  to view the time for each meal.

- Q:** During the setup of the feeding schedule, I only need to set 3 meal. How do I end the setup for the remaining feeding schedule?
- A:** After setting all the required feeding schedule, if you do not need to set the remaining ones, you can long-press the OK button for 3 seconds to return directly to the main interface.
- Q:** The feeding schedule has 6 meals. How can I set only 3 meals and have the remaining 3 not execute any plan?
- A:** You only need to set the portion size of the meals you do not want to execute to 0, and those meals will not perform any feeding schedule.
- Q:** 5. Each meal's feeding schedule can execute a maximum of 9 portions. How do I feed 10 portions if needed?
- A:** You can set the same feeding time for two meals, allowing the portions of the two meals to be stacked.
- Q:** When using both power supply and battery, will the power supply charge the battery?
- A:** The power supply does not charge the battery. It is recommended to use both battery and power supply simultaneously to prevent issues in case of a power outage at home.
- Q:** 7. The food won't come out
- A:** 1) Please make sure the food in the tank is dry, and food size is within 5-15mm in diameter.
2) Remove the food tank and tank base, check if the chute inside is blocked.
3) Check whether the battery level is low. Whether the power adapter is connected. Whether power outage occurs when the power adapter is connected and batteries are not installed.



THANK YOU FOR TRUSTING AND CHOOSING Frienhund

Smart Pet Feeder with Two Bowls

Model : ACF200W

Manufacturer : ShenZhen Aochen Technology Co., Ltd

Address : 306, Zhida Industrial Park2, No. 4, Longping West Road,
Shengping Community, Longcheng Street, Longgang District,
Shenzhen, China

Email : support@frienhund.com

Made in China

FCC ID : FCC-SDOC-ACF200W

If there is anything you would like to say to us

 Email: support@frienhund.com  www.frienhund.com
