



# Refrigerator user manual

imagine the possibilities

Thank you for purchasing a Samsung product.

**Free Standing Appliance**



# contents

---

SAFETY INFORMATION .....	2
SETTING UP YOUR REFRIGERATOR .....	14
OPERATING THE SAMSUNG REFRIGERATOR .....	17
TROUBLESHOOTING .....	24

## safety information

---

### SAFETY INFORMATION

- Before operating the appliance, please read this manual thoroughly and retain it for your reference.
- Use this appliance only for its intended purpose as described in this instruction manual. This appliance is not intended for use by persons (including children) with reduced physical, sensory or mental capabilities, or lack of experience and knowledge, unless they have been given supervision or instruction concerning use of the appliance by a person responsible for their safety.
- Warnings and Important Safety Instructions in this manual do not cover all possible conditions and situations that may occur. It is your responsibility to use common sense, caution, and care when installing, maintaining, and operating your appliance.
- Because these following operating instructions cover

various models, the characteristics of your refrigerator may differ slightly from those described in this manual.

R-600a or R-134a is used as a refrigerant. Check the compressor label on the rear of the appliance or the rating label inside the fridge to see which refrigerant is used for your refrigerator. When this product contains flammable gas (Refrigerant R-600a), contact your local authority in regard to safe disposal of this product.

- It is hazardous for anyone other than an Authorised Service Person to service this appliance. In Queensland – the authorized Service Person MUST hold a Gas Work Authorisation or Licence for hydrocarbon refrigerants, to carry out Servicing or repairs which involve the removal of covers. (For Australia only)



- In order to avoid the creation of a flammable gas-air mixture if a leak in the refrigerating circuit occurs, the size of the room in which the appliance may be sited depends on the amount of refrigerant used.
- Never start up an appliance showing any signs of damage. If in doubt, consult your dealer. The room must be 1 m<sup>3</sup> in size for every 8 g of R-600a refrigerant inside the appliance. The amount of refrigerant in your particular appliance is shown on the identification plate inside the appliance.
- Refrigerant squirting out of the pipes could ignite or cause an eye injury. When refrigerant leaks from the pipe, avoid any naked flames and move anything flammable away from the product and ventilate the room immediately.
  - Failing to do so may result in fire or explosion.
- This appliance is intended to be used in household and similar applications such as
  - staff kitchen areas in shops, offices and other working environments;
  - farm houses and by clients in hotels, motels and other residential type environments;
  - bed and breakfast type environments;
  - catering and similar non-retail applications.

## Important safety symbols and precautions:

 WARNING	Hazards or unsafe practices that may result in <b>severe personal injury or death.</b>
 CAUTION	Hazards or unsafe practices that may result in <b>minor personal injury or property damage.</b>
	Do NOT attempt.
	Do NOT disassemble.
	Do NOT touch.
	Follow directions carefully.
	Unplug the power plug from the wall socket.
	Make sure the machine is grounded to prevent electric shock.
	Call the contact center for help.
	Note.

**These warning signs are here to prevent injury to you and others. Please follow them carefully. After reading this section, keep it in a safe place for future reference.**

## CE Notice

This product has been determined to be in compliance with the Low Voltage Directive (2006/95/EC), the Electromagnetic Compatibility Directive (2004/108/EC), RoHS Directive (2011/65/EU), Commission Delegated Regulation (EU) No 1060/2010 and the Eco-Design Directive (2009/125/EC) implemented by Regulation (EC) No 643/2009 of the European Union. (For products sold in European Countries only)



### SEVERE WARNING SIGNS FOR TRANSPORTATION AND SITE

- ★ • When transporting and installing the appliance, care should be taken to ensure that no parts of the refrigerating circuit are damaged.
- Refrigerant leaking from the pipe work could ignite or cause an eye injury. If a leak is detected, avoid any naked flames or potential sources of ignition and air the room in which the appliance is standing for several minutes.
- This appliance contains a small amount of isobutane refrigerant

(R-600a), a natural gas with high environmental compatibility that is, however, also combustible.

When transporting and installing the appliance, care should be taken to ensure that no parts of the refrigerating circuit are damaged.

- When transporting and installing the refrigerator, do not touch the water hose on the back side of the refrigerator.
- This may damage the refrigerator and as a result the water dispenser can not be used.



### SEVERE WARNING SIGNS FOR INSTALLATION



- Deteriorated insulation of electrical parts may cause an electric shock or fire.
- Do not place this refrigerator in direct sunlight or expose to the heat from stoves, room heaters or other appliance.
- Do not plug several appliances into the same multiple power board.  
The refrigerator should always be plugged into its own individual electrical outlet which has a voltage rating that matched the rating plate.
- This provides the best performance and also prevents overloading house wiring circuits, which could cause a fire hazard from overheated wires.

- If the wall socket is loose, do not insert the power plug.
  - There is a risk of electric shock or fire.
  - Do not use a cord that shows cracks or abrasion damage along its length or at either end.
  - Do not pull or excessively bend the power cord.
  - Do not twist or tie the power cord.
  - Do not hook the power cord over a metal object, place a heavy object on the power cord, insert the power cord between objects, or push the power cord into the space behind the appliance.
  - When moving the refrigerator, be careful not to roll over or damage the power cord.
  - This may result in an electric shock or fire.
  - Do not use aerosols near the refrigerator.
  - Aerosols used near the refrigerator may cause an explosion or fire.
  - Do not bend the power cord excessively or place heavy articles on it.
- 
- ★ • This refrigerator must be properly installed and located in accordance with the manual before it is used.
  - Do not install the refrigerator in a damp place or place where it may come in contact with water.
- Deteriorated insulation of electrical parts may cause an electric shock or fire.
  - Connect the power plug in proper position with the cord hanging down.
  - If you connect the power plug upside down, wire can get cut off and cause fire or an electric shock.
  - Make sure that the power plug is not squashed or damaged by the back of the refrigerator.
  - When moving the refrigerator, be careful not to roll over or damage the power cord.
  - This constitutes a fire hazard.
  - Keep the packing materials out of reach of children.
  - There is a risk of death from suffocation if children put them on their head.
  - This appliance should be positioned in such a way that it is accessible to the power plug.
  - Failing to do so may result in an electric shock or fire due to electric leakage.
  - Do not install this appliance near a heater, inflammable material.
  - Do not install this appliance in a humid, oily or dusty location, in a location exposed to direct sunlight and water (rain drops).
  - Do not install this appliance in a location where gas may leak.
  - This may result in an electric shock or fire.
  - If any dust or water is in the refrigerator, pull out power plug

and contact your Samsung Electronics service center.

- Otherwise there is a risk of fire.
- Do not stand on top of the appliance or place objects (such as laundry, lighted candles, lighted cigarettes, dishes, chemicals, metal objects, etc.) on the appliance.
- This may result in an electric shock, fire, problems with the product, or injury.



- This appliance must be properly grounded.
- Do not ground the appliance to a gas pipe, plastic water pipe, or telephone line.
- You must ground the refrigerator to prevent any power leakages or electric shocks caused by current leakage from the refrigerator.
- This may result in an electric shock, fire, explosion, or problems with the product.
- Never plug the power cord into a socket that is not grounded correctly and make sure that it is in accordance with local and national codes.



- If the power cord is damaged, have it replaced immediately by the manufacturer or its service agent.
- The fuse on the refrigerator must be changed by a qualified technician or service company.

- Failing to do so may result in an electric shock or personal injury.



## CAUTION SIGNS FOR INSTALLATION



- Keep ventilation opening in the appliance enclosure or mounting structure clear of obstruction.
- Allow the appliance to stand for 2 hours after installation.
- The installation or any service of this appliance is recommended by a qualified technician or service company.
- Failing to do so may result in an electric shock, fire, explosion, problems with the product, or injury.



## SEVERE WARNING SIGNS FOR USING



- Do not touch the power plug with wet hands.
  - This may result in an electric shock.
- Do not store articles on the top of the appliance.
- When you open or close the door, the articles may fall and cause a personal injury and/or material damage.

- Do not put items filled with water on the refrigerator.
- If spilled, there is a risk of fire or electric shock.
- Do not touch the inside walls of the freezer or products stored in the freezer with wet hands.
- This may cause frostbite.
- Do not use or place any substances sensitive to temperature such as inflammable sprays, inflammable objects, dry ice, medicine, or chemicals near the refrigerator. Do not keep volatile or inflammable objects or substances (benzene, thinner, propane gas, alcohol, ether, LP gas and other such products etc.) in the refrigerator.
- This refrigerator is for storing food only.
- This may result in a fire or an explosion.
- Do not store pharmaceuticals products, scientific materials or temperature-sensitive products in the refrigerator.
- Products that require strict temperature controls must not be stored in the refrigerator.
- Do not place or use electrical appliance inside the refrigerator/freezer, unless they are of a type recommended by the manufacturer.
- If you smell pharmaceutical or smoke, pull out power plug immediately and contact your Samsung Electronics service center.
- If any dust or water is in Refrigerator, pull out power plug and contact your Samsung Electronics service center.
- Otherwise there is a risk of fire.
- If gas leak is detected, avoid any naked flames or potential sources of ignition and air the room in which the appliance is standing for several minutes.
- Do not use mechanical devices or any other means to accelerate the defrosting process, other than those recommended by the manufacturer.
- Do not damage the refrigerant circuit.
- Do not spray volatile material such as insecticide onto the surface of the appliance.
- As well as being harmful to humans, it may also result in an electric shock, fire or problems with the product.
- Do not use a hair dryer to dry the inside of the refrigerator. Do not place a lighted candle in the refrigerator for removing bad odours.
- This may result in an electric shock or fire.
- Fill the water tank, ice tray and water cubes only

- with potable water (mineral water or purified water).
- Do not fill the tank with tea, juice or sports drink, this may damage the refrigerator.
  - Do not let children hang on the door. If not, a serious injury may occur.
  - Risk of children entrapment. Do not let children enter inside the refrigerator.
  - Do not leave the doors of the refrigerator open while the refrigerator is unattended and do not let children enter inside the refrigerator.
  - Do not allow babies or children go inside the drawer.
  - It can cause death from suffocation by entrapment or personal injury.
  - Do not use mechanical devices or any other means to accelerate the defrosting process, other than those recommended by the manufacturer.
  - Do not damage the refrigerant circuit.
  - Do not put fridge shelf in upside down. Shelf stopper could not work.
  - It may cause a personal injury because of glass shelf drop.
  - Do not put fridge shelf in place for box. If put in to force, inside wall or glass could be crashed.
- 
- It may cause a personal injury or material damage.
- 
- ★ • In the event of a gas leak (such as propane gas, LP gas, etc.), ventilate immediately without touching the power plug. Do not touch the appliance or power cord.
  - Do not use a ventilating fan.
  - A spark may result in an explosion or fire.
  - Use only the LED Lamps provided by manufacturer or service agent.
  - Children should be supervised to ensure that they do not play with the appliance.
  - Keep fingers out of “pinch point” areas; clearances between the doors and cabinet are necessarily small.
  - Do not let children hang on the door. If not, a serious injury may occur.
  - There is a Risk of children entrapment. Do not let children enter inside the refrigerator.
  - Bottles should be stored tightly together so that they do not fall out.
  - This product is intended only for the storage of food in a domestic environment.
  - Never put fingers or other objects into the dispenser hole, and ice maker bucket.

- It may cause a personal injury or material damage.
  - Do not insert hands, feet or metal objects (such as chopsticks, etc.) into the bottom or the back of the refrigerator.
  - This may result in an electric shock or injury.
  - Any sharp edges may cause a personal injury.
- 
- Do not attempt to repair, disassemble, or modify the appliance yourself.
  - Do not use any fuse (such as cooper, steel wire, etc.) other than the standard fuse.
  - When repairing or reinstalling the appliance is required, contact your nearest service center.
  - Failing to do so may result in an electric shock, fire, problems with the product, or injury.
- 
- If the appliance generates a strange noise, a burning or smell or smoke, unplug the power plug immediately and contact your nearest service center.
- Failing to do so may result in an electric or fire hazards.
  - Pull the power plug out of the socket before changing the interior lamps of the refrigerator
  - Otherwise, there is a risk of electric shock.
  - If you experience difficulty when changing the light, contact service agent.
  - If the products is equipped with the LED Lamp, do not disassemble the Lamp Cover and LED Lamp by yourself.
  - Please contact your service agent.
  - Plug the power plug into the wall socket firmly.  
Do not use a damaged power plug, damaged power cord or loose wall socket.
  - This may result in an electric shock or fire.
  - Do not put a container filled with water on the appliance.
  - If spilled, there is a risk of fire or electric shock.
  - Never stare directly at the UV LED lamp for long periods of time.
  - This may result in eye strain due to the ultraviolet rays.



## CAUTION SIGNS FOR USING

- ★ • To get best performance from the product.
- Do not place foods too closely in front of the vents at the rear of the appliance as it can obstruct free air circulation in the refrigerator compartment.
- Wrap the food up properly or place it in airtight containers before putting it into the refrigerator.
- Do not put any newly introduced food for freezing near to already existing food.
- Do not place glass or bottles or carbonated beverages into the freezer.
- The container may freeze and break, and this may result in injury.
- Please observe maximum storage times and expiry dates of frozen goods.
- There is no need to disconnect the refrigerator from the power supply if you will be away for less than three weeks. But, remove all the food if you are going away for the three weeks or more. Unplug the refrigerator and clean it, rinse and dry.
- Do not place carbonated or fizzy drinks in the freezer compartment. Do not put bottles or glass containers in the freezer.
- When the contents freeze, the glass may break and cause personal injury and property damage.
- Do not change or modify the functionality of the refrigerator.
- Changes or modifications may result in a personal injury and/or property damage. Any changes or modifications performed by a 3rd party on this completed appliance are neither covered under Samsung warranty service, nor is Samsung responsible for safety issues and damages that result from 3rd party modifications.
- Do not block air holes.
- If the air holes are blocked, especially with a plastic bag, the refrigerator can be over cooled.
- Use only the ice-maker provided with the refrigerator.
- Wipe excess moisture from the inside and leave the doors open.
- Otherwise, odor and mold may develop.
- When the refrigerator got wet by water, pull out the power plug and contact your Samsung Electronics service center.
- Do not apply strong shock or excessive force onto the surface of glass.

- Broken glass may result in a personal injury and/or property damage.
- Be careful that your fingers are not caught in.

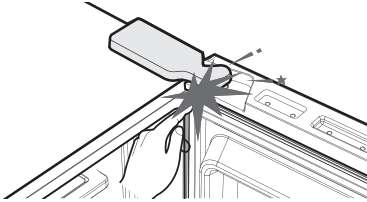

## CAUTION SIGNS FOR CLEANING AND MAINTENANCE

- ★ • Do not spray cleaning products directly on the display.
- Printed letters on the display may come off.
- If any foreign substance such as water has entered the appliance, unplug the power plug and contact your nearest service center.
- Failing to do so may result in an electric shock or fire.
- Remove all foreign substances such as dust or water from the power plug terminals and contact points using a dry cloth on a regular basis.

- Unplug the power plug and clean it with a dry cloth.
- Failing to do so may result in an electric shock or fire.
- Do not clean the appliance by spraying water directly onto it.
- Do not use benzene, thinner, or Clorox, Chloride for cleaning.
- They may damage the surface of the appliance and may cause a fire.
- Never put fingers or other objects into the dispenser hole.
- It may cause a personal injury or material damage.



- Before cleaning or performing maintenance, unplug the appliance from the wall socket.
- Failing to do so may result in an electric shock or fire.



## SEVERE WARNING SIGNS FOR DISPOSAL

- Leave the shelves in place so that children may not easily climb inside.
- Ensure that none of the pipes on the back of the appliance are damaged prior to disposal.
- R-600a or R-134a is used as a refrigerant. Check the compressor label on the rear of the appliance or the rating label inside the refrigerator to see which refrigerant is used for your refrigerator.

When this product contains flammable gas (Refrigerant R-600a), contact your local authority in regard to safe disposal of this product.

Cyclopentane is used as an insulation blowing gas.

The gases in insulation material require special disposal procedure.

Please contact your local authorities in regard to the environmentally safe disposal of this product. Ensure that none of the pipes on the back of the appliances are damaged prior to disposal. The pipes shall be broken in the open space.

- When disposing of this or other refrigerator/s, remove the door/door seals, door latch so that children or animals cannot become trapped inside. Children

should be supervised to ensure that they do not enter and play with the appliance.

- If trapped inside, the child may become injury and suffocate to death.
- Please dispose of the packaging material for this product in an environmentally friendly manner.
- Keep all packaging materials well out of the reach of children, as packaging materials can be dangerous to children.
- If a child places a bag over its head, it may result in suffocation.



## ADDITIONAL TIPS FOR PROPER USAGE

- In the event of a power failure, call the local office of your Electricity Company and ask how long it is going to last.
- Most power failures that are corrected within an hour or two will not affect your refrigerator temperatures. However, you should minimize the number of door openings while the power is off.
- But should the power failure last more than 24 hours, remove all frozen food.

- If keys are provided with the refrigerator, the keys should be kept out of the reach of children and not be in the vicinity of the appliance.
- The appliance might not operate consistently (possibility of defrosting of contents or temperature becoming too warm in the frozen food compartment) when sited for an extended period of time below the cold end of the range of temperature for which the refrigerating appliance is designed.
- Do not store food which goes bad easily at low temperature, such as bananas, melons.
- Your appliance is frost free, which means there is no need to manually defrost your appliance, as this will be carried out automatically.
- Temperature rise during defrosting can comply with ISO requirements. But if you want to prevent an undue rise in the temperature of the frozen food while defrosting the appliance, please wrap the frozen food up in several layers of newspaper.
- Any increase in temperature of frozen food during defrosting can shorten its storage life.
- Do not re-freeze frozen foods that have thawed completely.

## Saving Energy Tips

- Install the appliance in a cool, dry room with adequate ventilation. Ensure that it is not exposed to direct sunlight and never put it near a direct source of heat (radiator, for example).
- Never block any vents or grilles on the appliance.
- Allow warm food to cool down before placing it in the appliance.
- Put frozen food in the refrigerator to thaw. You can then use the low temperatures of the frozen products to cool food in the refrigerator.
- Do not keep the door of the appliance open for too long when putting food in or taking food out. The shorter time for which the door is open, the less ice will form in the freezer.
- Allow clearance to the right, left, back and top when installing. This will help reduce power consumption and keep your energy bills lower.

# setting up your refrigerator

## GETTING READY TO INSTALL THE REFRIGERATOR

Congratulations on the purchase of your Samsung Refrigerator. We hope you will enjoy the many state-of-the-art features and efficiencies that this new appliance has to offer.



- This refrigerator must be properly installed and located in accordance with the manual before it is used.
- Use this appliance only for its intended purpose as described in this instruction manual.
- We strongly recommend that any servicing be performed by a qualified individual.
- Please dispose of the packaging material for this product in an environmentally friendly manner.
- Pull the power plug out of the socket before changing the interior light of the refrigerator.
- Otherwise, there is a risk of electric shock.

- If your refrigerator is not level, the internal cooling system may not work correctly.
- Overall space required in use. Refer to drawing and dimension as below.

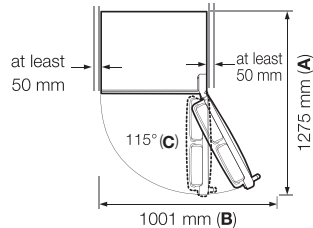
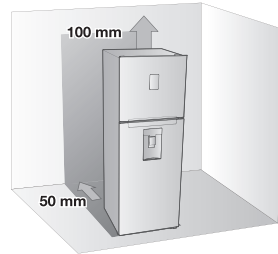



## Selecting the best location for the refrigerator

- Select a location without direct exposure to sunlight.
- Select a location with level (or nearly level) flooring.
- Select a location with enough space for the refrigerator doors to open easily.
- Allow sufficient space to install the refrigerator on a flat surface.

The figure above shows a RT38\*.

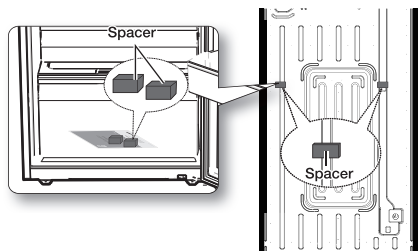
Model	A	B	C
RT38	1275	1001	115°
RT38(Glass Door Only)	1290	1001	115°
RT35	1275	1001	115°
RT35(Glass Door Only)	1290	1001	115°
RT32	1221	1040	135°
RT29	1221	1040	135°
RT25	1141	964	135°
RT22	1141	964	135°
RT20	1141	964	135°





 Remove paper on spacer and then attach two spacers (Gray block) on the back side of refrigerator for better performance. Make sure two spacers fix like below image when you install the refrigerator. It is improving the refrigerator performance. (Optional)

 Allow sufficient space to the right, left, back and top for air circulation. This will help reduce power consumption and keep your energy bills lower.

Please install the refrigerator where the temperature is 10 °C to 43 °C.

Please ensure that appliance can be moved freely in the event of maintenance & service.

 **CAUTION** Please install the refrigerator where the temperature is 10 °C to 43 °C. If your refrigerator is installed in too low or high temperature, the internal cooling system may not work correctly.

 **CAUTION** When installing, servicing, or cleaning behind the refrigerator, be sure to pull the unit straight out and push back in straight after finishing. Also, make sure your floor supports the full-load refrigerator. Otherwise, it may cause floor damage.

 **CAUTION** Please tie up the extra length of the power cord at the back of the refrigerator so as not to be touched on the floor preventing the power cord from being crushed by the rollers upon relocation.

## FLOORING

For proper installation, this refrigerator must be placed on a level surface of hard material that has the same height as the rest of the flooring. This surface should be strong enough to support a fully loaded refrigerator (or approximately 100 kg). To protect the floor finish, cut a large section of the cardboard carton and place it under the refrigerator where you are working.

 Pulling or pushing the refrigerator may damage the floor. Moving the refrigerator after installation may damage the floor.

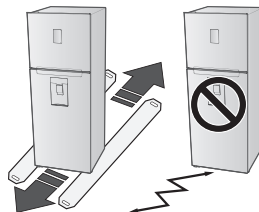

 **CAUTION** Be careful : do not damage the cover leg while moving the refrigerator. The cover leg protects the wire and hose . If it is damaged, the refrigerator may also be damaged. (Optional)

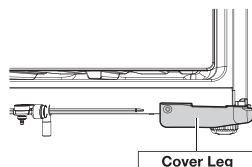

## LEVELLING THE REFRIGERATOR

To avoid a hazard due to instability of the refrigerator, please place the refrigerator on a horizontal support and levelled in accordance with the following instruction for installation.

Failing to do so may result in the refrigerator tipping and a personal injury.

If the front of the appliance is slightly higher than the rear, the door can be opened and closed more easily.

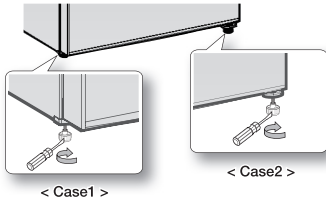

Case 1) The appliance tilts down to the left.

- Turn the left adjusting leg in the direction of the arrow until the appliance is level.

Case 2) The appliance tilts down to the right.

- Turn the right adjusting leg in the direction of the arrow until the appliance is level.

#### Standtable

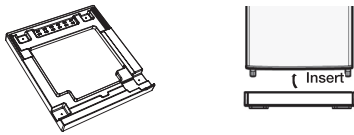

- Optional Standtable set base of refrigerator, when you use it you can not turn the adjusting leg.  
(There is no Standtable according to the model).

## ASSEMBLING THE DOOR SUPPORTS (OPTIONAL)

Please assemble the door supports to avoid the product being fallen or shaken (Glass-Door models only).

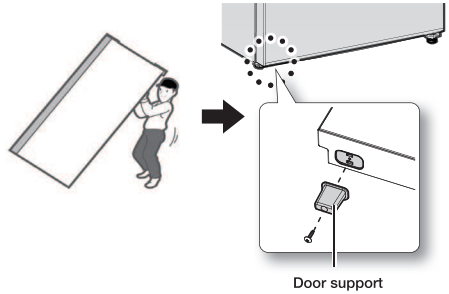

1. Tilt the product backwards.
2. Assemble the support onto the bottom of door using a Philips head screwdriver.

**CAUTION** Be careful not to drop, damage or scratch the product while assembling the supports. It may cause a personal injury or material damage.

**CAUTION** Please assemble the door supports to avoid the product being fallen forward or shaken with the Door guard stuffed while the refrigerator empty.

## SETTING UP THE REFRIGERATOR

Now that you have your new refrigerator installed and in place, you are ready to set up and enjoy the full features and functions of the appliance. By completing the following steps, your refrigerator should be fully operational.

If not, first check the power supply and electricity source or try the troubleshooting section at the back of this user guide.

If you have any further questions, contact your Samsung Electronics service center.

1. Place the refrigerator in an appropriate location with reasonable clearance between the wall and the refrigerator.  
Refer to installation instructions in this manual.
2. Once the refrigerator is plugged in, make sure the interior light comes on when you open the doors.
3. Set the temperature control to the coldest temperature and wait for an hour.  
The freezer should get slightly chilled and the motor should run smoothly.
4. After powering the refrigerator, it will take a few hours to reach the appropriate temperature. Once the refrigerator temperature is sufficiently cool, you can store food and drink in the refrigerator.

# operating the SAMSUNG refrigerator

## USING THE CONTROL PANEL (DISPLAY TYPE)

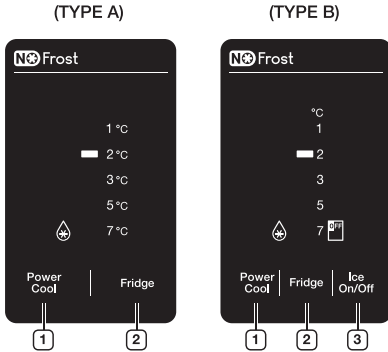

Each time you press the button, a short beep will sound.

### 1 Power Cool

1. When you press the **Power Cool** button, the Indicator ( ) will light up and the refrigerator will speed up the time.
2. This function will be activated for several hours and then return to the previous temperature.
3. This function switches off automatically. When the Power Cool process is completed, the Power Cool indicator switches off and the freezer switches back to the previous temperature setting. To deactivate this function, press the Power Cool button.

When you use the Power Cool function, the cooling of the refrigerator will be speeded up for several hours.

When you use this function the energy consumption of the refrigerator will increase. Remember to turn it off when you do not need it and return the freezer to your original temperature setting. If you need to freeze large amount of food stuff, set the temperature of the freezer compartment to the right end and the

temperature of refrigerator to 1~2 °C (Display model) or Optimal-5 (non-Display model) at least 24 hours before.

### 2 Fridge

Press the **Fridge** button to set the fridge to desired temperature from the range 1 °C to between 1 °C and 7 °C. Default set temperature is set on 2 °C and each time you press the **Fridge** button, temperature will changing following order and temperature indicator will display the desired temperature.

If you need to freeze large amount of food stuff, set the temperature of the freezer compartment on right end and the temperature of the refrigerator to 1~2 °C (Display model) or Optimal-5 (non-Display model) at least 24 hours before.



### 3 Ice On/Off

If you do not want to make more ice, press the **Ice On/Off** button, and the indicator will light up. Default set Ice On/Off function is ON. We recommend you stop ice making if the following occur:

- There is enough ice in the ice bucket.
- You want to save water and energy.
- The water tank is empty.

# CONTROLLING THE TEMPERATURE

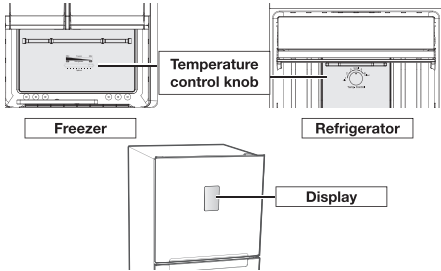

We recommend setting the temperature of the freezer and the refrigerator to **Optimal** to ensure a stable performance of the appliance.

If food in the refrigerator is frozen or if you wish to increase the temperature of the freezer, set the Freezer Temperature Controller to the Left.

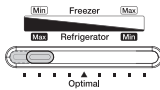

- In Winter, set the Freezer Temperature Controller to the Right to make ice.

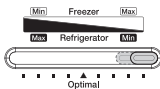

- In Summer (higher than 35 °C), set the Freezer Temperature Controller on **Optimal** to make ice.

## Adjusting the Temperature of the Freezer.

If you wish to lower the temperature of the freezer, set the temperature controller of the freezer to the Right.

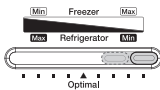

If you wish to increase the temperature of the freezer, set the temperature controller to the Left.

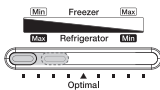

- In Winter, **set** the Freezer Temperature Controller to the Right.

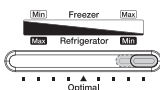

Otherwise the performance of the refrigerator may cause problems.

- In Summer (higher than 35 °C), **do not set** the Freezer Temperature Controller to the Right. Otherwise there may be problems with the refrigerator's performance.

## Adjusting the Fridge Temperature

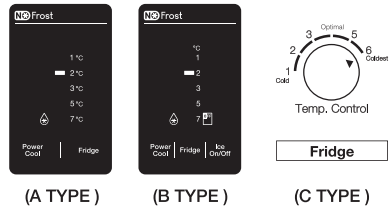

If the food in the refrigerator is not as cold as you would like or if you wish to lower the temperature of the refrigerator, set the refrigerator's Temperature Controller 5~6 or the Temperature on the Display model to 1. If food in the refrigerator is frozen or if you wish to increase the temperature of the freezer, set the refrigerator's Temperature Controller to 1~3 or the Temperature of the Display model to 3~7.

- In Winter, **do not set** the refrigerator's Temperature Controller to 1~2 or the Temperature of the Display model to 5~7. Otherwise there may be problems with the refrigerator's performance.
- In Summer (higher than 35 °C), **set** the Fridge Temperature Controller on 4~6 or the Temperature of Display model on 1~2. Otherwise there may be problems with the refrigerator's performance.

## MAKING ICE (OPTIONAL)

### TWIST ICE MAKER

#### Making Ice Cubes

Remove the ice cube tray by pulling it towards you. Fill the tray with water up to the maximum water level marked on the rear of the tray.

Slide the tray back into the holder, taking care not to spill the water.

Wait until the ice cubes are formed.

#### Removing the Ice Cubes

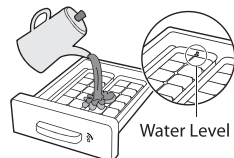

Make sure that the ice cube storage bin is in place under the ice cube tray. If not, slide it into place.

Twist one of the levers firmly in the clockwise direction until the tray twists slightly.  
Result : The ice cubes fall into the storage bin.  
Repeat Step 2 for the other half of the tray, if necessary. Remove the storage bin by:

- Lifting it slightly
- Pulling it towards you

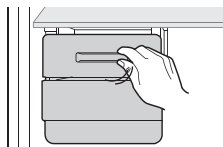

### Danger of explosion

- Glass bottles containing liquids that can freeze should never be stored in the freezer as the glass will explode when the contents freeze.

## TRAY TYPE (OPTIONAL)

### Making ice cubes

Fill up the ice tray with water and that till it reaches the maximum level mark on the rear of the tray. Put the ice tray in the freezer.

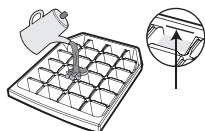

### Removing the ice cubes

Hold both ends of the ice tray, remove the ice cubes from the tray by twisting it gently.

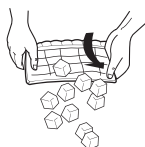

## USING WATER DISPENSER (OPTIONAL)

With the water dispenser, you can obtain chilled water easily without opening the refrigerator door.



If you push continually the dispenser lever for about 1 minute, the dispenser will stop to work. To get more water, push the lever

again.

The dispenser is designed with an operating time of about 1 minute and a capacity of about 1 L. at each use.

### Lift up and pull out the water tank.

- Hold the handgrips on both sides to lift out the water tank.
- Clean the inside of water tank before using it for the first time.
- After disassembling the water tank, wipe up the inside of refrigerator until it is clean and dry.

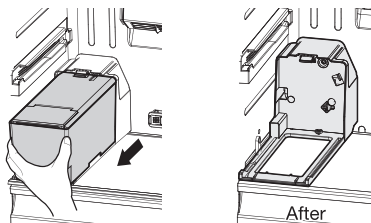

After putting back the water tank, do not disassemble the shelf below the water tank. It may cause a personal injury or material damage.



For more space, empty the water off the water tank, remove the lid completely, place the water tank back and use it to store food.

### Fill the water tank with water, ensuring that it is in a stable position, allowing for the extended water supply outlet.

- Fill with water up to 5 L. If it is filled higher than this, it may overflow when the lid is closed.
- It is impossible to fill the tank with water while it is positioned in the refrigerator.

#### Method 1.

Fill the water lifting the round lid in the arrow direction to open.

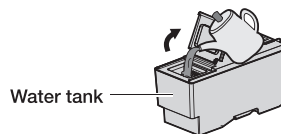

#### Method 2.

Please fill the water after holding and lifting the large lid to open it.

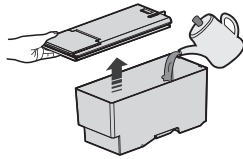

**Close the refrigerator door after fitting the water tank.**

- Confirm that the dispenser cock is outside after closing the door.

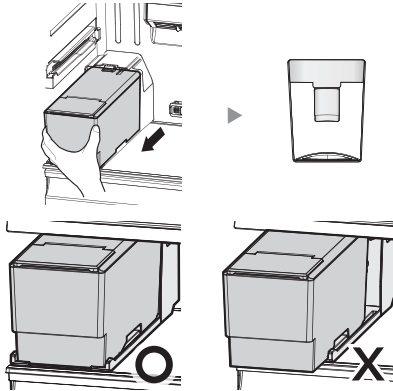

**CAUTION** Fix water tank on the shelf inside the fridge.  
 If not, water tank may not be operate correctly.  
 Do not use the refrigerator without the water tank.  
 If not, it may cause an efficiency problem.  
 While fixing the water tank, be careful that your fingers will not be caught.

**CAUTION** Only fill the tank with water (mineral water or purified water) and do not use any other liquid.

**CAUTION** Be careful that the tank will not drop while you are moving the refrigerator because you may get hurt if the water tank is filled with water.

**CAUTION** Do not disassemble the internal pump which is connected to the water tank. Be careful to not damage the hose and nozzle of the water tank. The dispenser can not be operated if it is disassembled or damaged.

**Place a glass underneath the water outlet and push gently against the dispenser lever with your glass.**

**Make sure the glass is in line with the dispenser to prevent the water from bouncing out.**

**CAUTION** When you do not use the water dispenser for 2~3 days (especially during the summer), the dispensed water may have a funny smell or taste. If this occurs, we recommend that you discard the first 1~2 glasses for better tasting water.

If you have just installed the Refrigerator, pour out the first six glassfuls of water to flush out impurities in the water supply system. Make sure water flows cleanly before drinking.

**CAUTION** Make sure that no water is in the water tank when you are going on a long vacation or business trip.

**CAUTION** Please wait 1 second before removing the cup after dispensing water to prevent spills.  
 Please push the dispenser lever 1~10 seconds when you use it first time due to air with in the hose.

**Using the Auto Ice Maker (Optional)**

When you turn on the refrigerator, let the ice maker make ice for 1 to 2 days. Over that period of time, throw out the first 1 or 2 buckets of ice the freezer makes to ensure all impurities have been removed from the water system.

< Before >

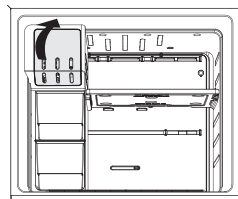

< After >

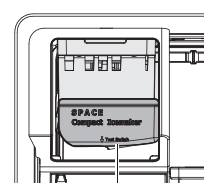

**Test button**

\* The figure above shows the Auto Ice Maker option model.

When upper Ice Tray full, switch the upper and lower ice tray.

**CAUTION** **Test button**

- In case ice does not come out, pull out the ice bucket and press test button located on right side of ice maker.



Some parts in the picture may differ from your refrigerator, depending of the model and option (for example ice tray, auto ice maker, twice ice maker, cool pack, shelf or water dispenser).



- If you plan to go away for a significant time, empty the refrigerator and turn it off. Wipe the excess moisture from the inside of the appliance and leave the doors open. This helps keep odour and mold from developing.
- If the refrigerator is not to be used for a long period of time, pull out the power plug.



- To get more space in the freezer compartment, you can remove applicable fitting(s) such as cool pack(s), shelf(s), twist Ice maker(s), ice storage bin(s) and their supporter(s) which can be removed without aid of a tool. It does not affect thermal and mechanical characteristics. A declared storage volume of freezer compartment is calculated with above things removed.
- If you want to remove both ice maker

kits, you have to remove right one first. (only for Ice Max option model)

- To get the best energy efficiency of this product, please leave all selves, drawers and baskets on their original position like as 15 page illustration.
- The lower guard of the freezer compartment is only two star section. So, the lower guard shall be placed on the original position for proper performance.
- The Alarm function of the display model works when door of the fridge is open. Please also check if the freezer door is closed, because alarm does not ring when the freezer door is opened. In the case of a non-display model, the alarm does not ring even if the doors of the fridge and the freezer are open. Check if the doors are closed.
- In particular, there is load limit line at the right side of the freezing upper Guard compartment. Please do not put food items on the right side of the load limit line. (Optional)

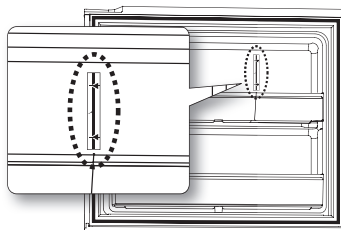

## REMOVING THE REFRIGERATOR ACCESSORIES

**CAUTION** While assembling, put the freezer shelf, refrigerator shelves and cool pack in the correct position and do not put them upside down. It may cause a personal injury or material damage.

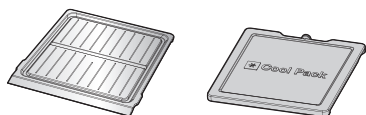
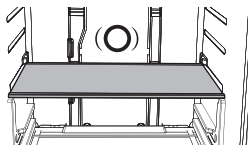

1. Pull out the ice tray and box and then pull out the right side of support tray ice. Same steps to left side. (Only for ice max option model)

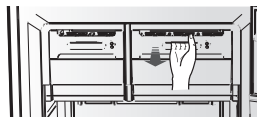

**CAUTION** Be careful when you pull out the ice tray support because it will protrude up to you suddenly.

Be careful when you disassemble and assemble the ice tray support because the upper side of it has a sharp edge. It may occur finger injury.

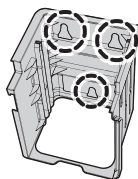

To assemble, place the ice tray support above the slots with the right side higher. Hold it underneath in the middle and push the ice tray support until it snaps into place.

2. Lift up the freezer shelf or cool pack and pull it forward and then pull out the ice tray and box. Pull out the support tray ice. (Only for freezer shelf or cool pack option model)

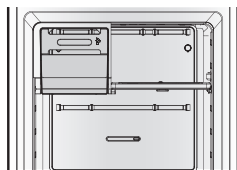

3. Remove ice tray and then lift up the freezer shelf, and pull it forward. (Only for ice tray option model)

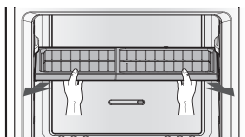

4. Pull the the refrigerator shelves towards you.

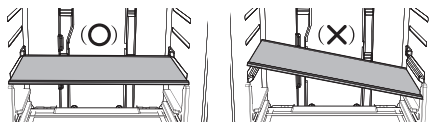

- To remove the refrigerator shelves when it is possible to open the doors widely, pull the shelves forward, lift them up and then pull out.
- To remove the refrigerator shelves when it is impossible to open the doors widely, pull the shelves forward, lift them up and tilt in order to pull them out.
- When you put the shelves back, make sure the side with the label "Front" on it face the front of the refrigerator.

5. Lift up the cool pack and pull it forward. (Only for auto ice maker option model)

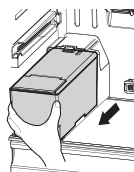

- Pull it out while pressing the end of the sill on the low temperature catalyzing deodorizer. (Only for Deodorizing Filter option model)

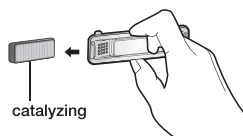

- Lift up and pull out the door guards.

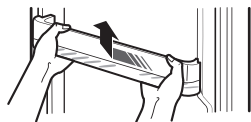

Before removing any accessories, make sure that no food is in the way. When possible, remove the food altogether to reduce the risk of accidents.

## CLEANING THE REFRIGERATOR



**WARNING** Do not use Benzene, Thinner or Clorox™ for cleaning. They may damage the surface of the appliance and can create a risk of fire.

Do not spray the refrigerator with water while it is plugged in, as it may cause an electric shock.

Do not clean the refrigerator with benzene, thinner or car detergent for risk of fire.

- Unplug the power cord of the refrigerator.
- Slightly dampen a soft lint-free cloth or paper towel with water.



Do not use any kind of detergent to clean the refrigerator because that can discolor or damage the refrigerator.

- Wipe the inside and outside of refrigerator until it is clean and dry.
- Plug the power cord of the refrigerator.

## REPLACING THE INTERIOR LIGHT



For LED lamp, please contact service engineer to replace it.

# Troubleshooting

PROBLEM	SOLUTION
The appliance is not operating at all or the temperature is too high.	<ul style="list-style-type: none"> <li>• Check that the power plug is correctly connected.</li> <li>• Is the temperature control on the front panel correctly set?</li> <li>• Does sun shine on the appliance or are there heat sources nearby?</li> <li>• Is the back of the appliance too near to the wall?</li> </ul>
The food in the refrigerator is frozen.	<ul style="list-style-type: none"> <li>• Is the temperature control on the front panel set to the coldest temperature?</li> <li>• Is the surrounding temperature too low?</li> <li>• Did you store the food with a high water content in the coldest part of the fridge?</li> </ul>
There are unusual noises.	<ul style="list-style-type: none"> <li>• Check that the appliance is installed on a stable, level floor.</li> <li>• Is the back of the appliance too near to the wall?</li> <li>• Have any foreign objects fallen behind or under the appliance?</li> <li>• Is the noise coming from the compressor in the appliance?</li> <li>• A ticking sound may be heard inside the appliance; this is normal. This sound occurs when the various accessories contract or expand.</li> </ul>
The front corners and sides of the appliance are warm and condensation starts to form.	<ul style="list-style-type: none"> <li>• Heat-proof pipes are installed in the front corners of the appliance to prevent condensation from forming. When the surrounding temperature rises, this may not always be effective. However, this is not abnormal.</li> <li>• In very humid weather, condensation may form on the outer surface of the appliance when the moisture in the air comes into contact with the cool surface of the appliance.</li> </ul>
Ice Maker is not producing ice.	<ul style="list-style-type: none"> <li>• Did you wait for 12 hours after installation of the refrigerator before making ice?</li> <li>• Did you manually stop the ice making function?</li> <li>• Is the freezer temperature too warm? Try setting the freezer temperature lower.</li> <li>• Did you fill the water tank with water?</li> <li>• Did you check fitting the water tank correctly ?</li> </ul>
Water dispenser is not functioning.	<ul style="list-style-type: none"> <li>• Is the water tank frozen because the fridge temperature is too low? Try selecting a warmer setting on the Digital display.</li> <li>• Did you fill with water in water tank?</li> <li>• Did you check fitting the water tank correctly ?</li> </ul>
You can hear a liquid bubbling in the appliance.	<ul style="list-style-type: none"> <li>• This is the refrigerant, which cools the inside of the appliance.</li> </ul>
There is a bad smell inside the appliance.	<ul style="list-style-type: none"> <li>• Has a food item spoiled?</li> <li>• Make sure that strong smelling food (for example, fish) is wrapped so that it is airtight.</li> <li>• Clean out your freezer periodically and throw away any spoiled or suspect food.</li> </ul>
There is a layer of frost on the appliance walls.	<ul style="list-style-type: none"> <li>• Are the air outlet vents blocked by food stored inside the refrigerator.</li> <li>• Space the food out as much as possible to improve ventilation.</li> <li>• Is the door fully closed?</li> </ul>
Condensation forms on the inside wall of the appliance and around vegetables.	<ul style="list-style-type: none"> <li>• Food with a high water content is stored uncovered with a high humidity level or the door has been left open for a long time.</li> <li>• Store the food with a cover or in sealed containers.</li> </ul>

memo

---

memo

---

memo

---

## Ambient Room Temperature Limits

This refrigerator is designed to operate in ambient temperatures specified by its temperature class marked on the rating plate.

Class	Symbol	Ambient Temperature range (°C)	
		IEC 62552 (ISO 15502)	ISO 8561
Extended Temperate	SN	+10 to +32	+10 to +32
Temperate	N	+16 to +32	+16 to +32
Subtropical	ST	+16 to +38	+18 to +38
Tropical	T	+16 to +43	+18 to +43



Internal temperatures may be affected by such factors as the location of the fridge/freezer, ambient temperature and the frequency with which you open the door. Adjust the temperature as required to compensate for these factors.

### Correct Disposal of This Product (Waste Electrical & Electronic Equipment)

#### English



*(Applicable in countries with separate collection systems)*

This marking on the product, accessories or literature indicates that the product and its electronic accessories (e.g. charger, headset, USB cable) should not be disposed of with other household waste at the end of their working life. To prevent possible harm to the environment or human health from uncontrolled waste disposal, please separate these items from other types of waste and recycle them responsibly to promote the sustainable reuse of material resources.

Household users should contact either the retailer where they purchased this product, or their local government office, for details of where and how they can take these items for environmentally safe recycling.

Business users should contact their supplier and check the terms and conditions of the purchase contract. This product and its electronic accessories should not be mixed with other commercial wastes for disposal.

## Contact SAMSUNG WORLD WIDE

If you have any questions or comments relating to Samsung products, please contact the SAMSUNG customer care center.

COUNTRY	CALL	Web site
AUSTRALIA	1300 362 603	<a href="http://www.samsung.com/au/support">www.samsung.com/au/support</a>
COLOMBIA	Bogotá 600 12 72 Gratis desde cualquier parte del país 01 8000 112 112 ó desde su celular #SAM(726)	<a href="http://www.samsung.com/co/support">www.samsung.com/co/support</a>
EIRE	0818 717100	<a href="http://www.samsung.com/ie/support">www.samsung.com/ie/support</a>
HONG KONG	(852) 3698 4698	<a href="http://www.samsung.com/hk/support">www.samsung.com/hk/support</a> (Chinese) <a href="http://www.samsung.com/hk_en/support">www.samsung.com/hk_en/support</a> (English)
INDIA	1800 3000 8282 - Toll Free 1800 266 8282 - Toll Free 30308282 - Non Toll Free	<a href="http://www.samsung.com/in/support">www.samsung.com/in/support</a>
MALAYSIA	1800-88-9999	<a href="http://www.samsung.com/my/support">www.samsung.com/my/support</a>
NEW ZEALAND	0800 SAMSUNG (0800 726 786)	<a href="http://www.samsung.com/nz/support">www.samsung.com/nz/support</a>
PANAMA	800-7267 800-0101	<a href="http://www.samsung.com/latin/support">www.samsung.com/latin/support</a> (Spanish) <a href="http://www.samsung.com/latin_en/support">www.samsung.com/latin_en/support</a> (English)
PHILIPPINES	1-800-10-7267864 [PLDT] 1-800-8-7267864 [Globe landline and Mobile] 02-4222111 [Other landline]	<a href="http://www.samsung.com/ph/support">www.samsung.com/ph/support</a>
SINGAPORE	1800-SAMSUNG(726-7864)	<a href="http://www.samsung.com/sg/support">www.samsung.com/sg/support</a>
SOUTH AFRICA	0860 SAMSUNG (726 7864)	<a href="http://www.samsung.com/support">www.samsung.com/support</a>
U.K	0330 SAMSUNG (7267864)	<a href="http://www.samsung.com/uk/support">www.samsung.com/uk/support</a>
VIETNAM	1800 588 889	<a href="http://www.samsung.com/vn/support">www.samsung.com/vn/support</a>

