

IAP2301Av2 QSG

Introduction

This Quick Start Guide is designed to guide you through the installation of Access Point, model IAP2301Av2 , including hardware mounting and configuration.



Ceiling Mount Access Point

Model: IAP2301Av2

Wi-Fi 7 technology for high-performance Wi-Fi in high-density, multi-device environments.

Supercharged speeds up to 2,832 Mbps (5 GHz), and up to 688 Mbps (2.4 GHz).

2.5GbE Ethernet realizes greater throughput and supports 802.3at and 30W PoE injector input for flexible installation over 100 meters (328 feet).

Content Quick Links

[Hardware Overview](#)

[Hardware Mounting](#)

[Configure with Senao Cloud](#)

Package Contents



Access Point



Quick Installation Guide

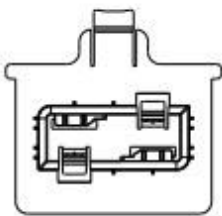

Ceiling Mount Base
(9/16" T-Rail)

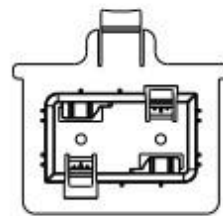

Ceiling Mount Base
(15/16" T-Rail)



Mounting kit

System Requirements

The Senao Cloud is primarily accessible with a web browser or mobile app. Before signing up for the Senao Cloud Service or logging on to the Senao Cloud Platform to manage your network, ensure that you have downloaded the right app and use the supported browser.

Mobile App:

Senao Cloud To-Go (iOS/ Android supported)

↓ [Download the Cloud To-Go mobile app here](#)

Web Browser:

Google Chrome (57.0.2987.110 and later)

Microsoft Edge (80.0.361.103 and later)

Mozilla Firefox (52.0 and later)

Network Requirements

Before you get started, please make sure your network environment is DHCP-enabled. Senao Access Points (IAP series) are default assigned an IP address dynamically by the DHCP server.

- ⓘ If you encounter issues with IP address assignment, you may want to change your IP assignment from "DHCP mode" to "Static IP". Please check the "[User Manual: Login to Local Access Page](#)" for more details.

Hardware Overview

Ports



i Reset Button:

Reset to default: Press and hold the reset button for over 10 seconds, and the LED(PWR) will start *Fast Flashing* (0.2 sec). Then, the device will be reset to factory default settings.

LEDs

Status	LED Color/ Behavior
Connecting to Cloud	Orange Flashing (0.5 Sec)
Cloud Connected	Blue Solid on (5 Sec)
Firmware Upgrading	Blue Flashing (0.5 Sec) <---> White Flashing (0.5 Sec)
Reset to Default	Blue Fast Flashing (0.2 Sec)
LAN Connected	Blue Breathing (3 Sec)
2.4GHz Radio On	Yellow Breathing (3 Sec)
5GHz Radio On	Green Breathing (3 Sec)
6GHz Radio On	Purple Breathing (3 Sec)
AP Locating Mode	Blue Flashing (1.5 sec on -> 0.5 sec off)

Hardware Mounting

The access point can be mounted on the Ceiling and Wall. Please perform the steps for the appropriate installation:

Ceiling Mount

- Slide the ceiling mount base into the slot of the Access Point.
- Hold the Access Point with one hand to reach the other hand over the T-Rail sides of the bracket. Then Gook the stationary end of the ceiling mount bracket onto the T-Rail.

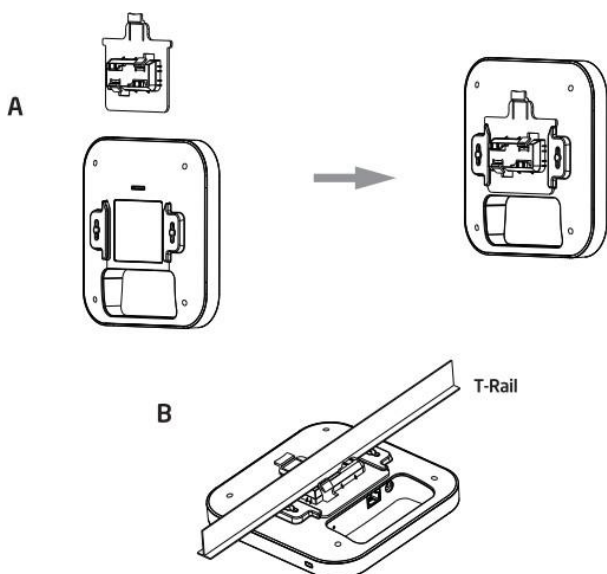

Wall Mount

- C) Continued from A, determine where the Access Point to be placed and mark location on the surface for the two mounting holes. Use the appropriate drill bit to drill two 8.1mm diameter and 26mm depth holes in the markings and hammer the bolts into the openings.
- D) Screw the anchors onto the holes until they are flush with the wall; screw the included screws into the anchors.
- E) Place the Access Point against wall with the mounting screw heads.

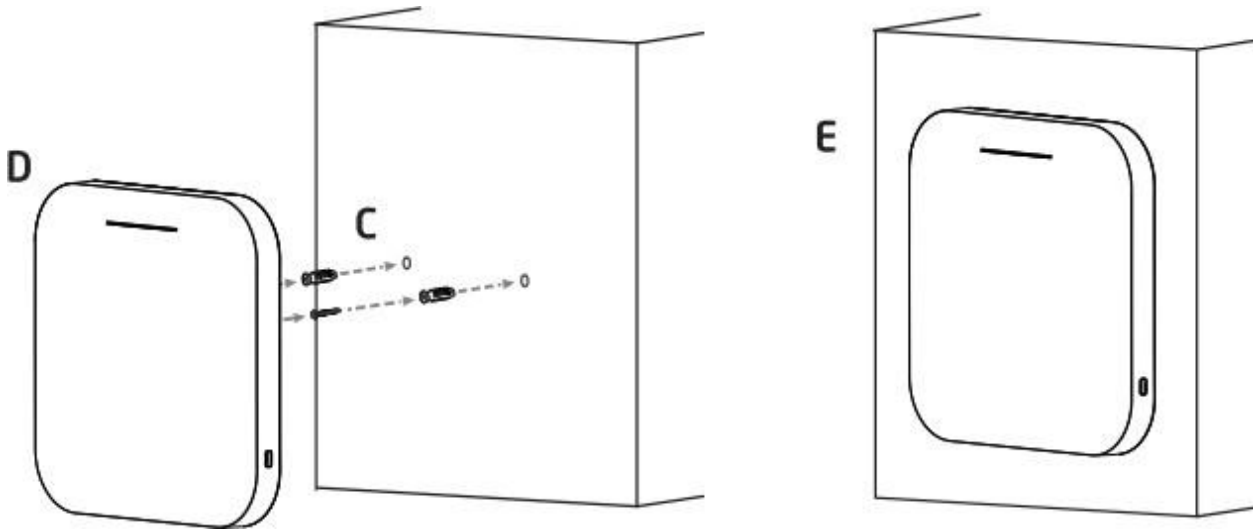

Configure with Senao Cloud

Step1: Register Device and Assign to Network

You can register the device either by the Cloud To-Go mobile app or the Senao Cloud platform.

Cloud To-Go Mobile App

Open and log in to the Senao Cloud To-Go mobile app.

Scan the QR code on the back of the device via the app.

If the camera successfully scans a QR code, the app will display the device Information. You can tap "Register" to complete the Registration.

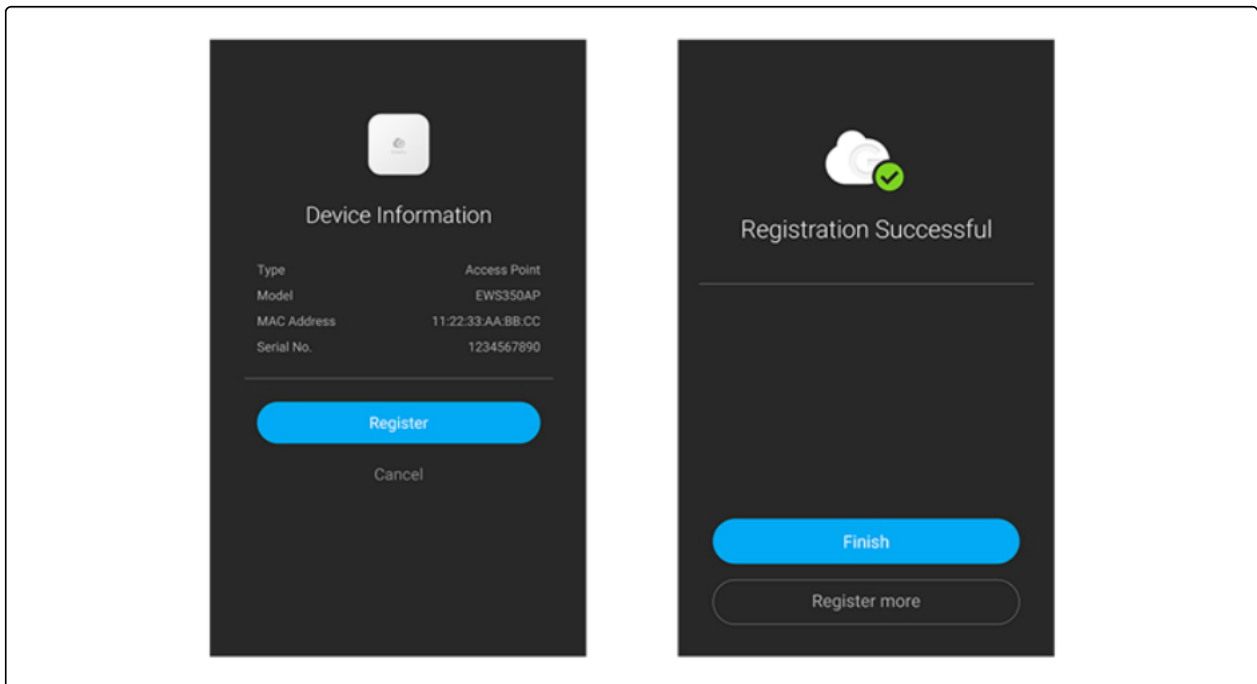

Device registration

1. Registered devices will be shown on the *Inventory&License* page. Slide left the device and click "Add to Network". Add the device to your personalized Network.

i Network: Management domain shared same configurations within Senao Cloud.

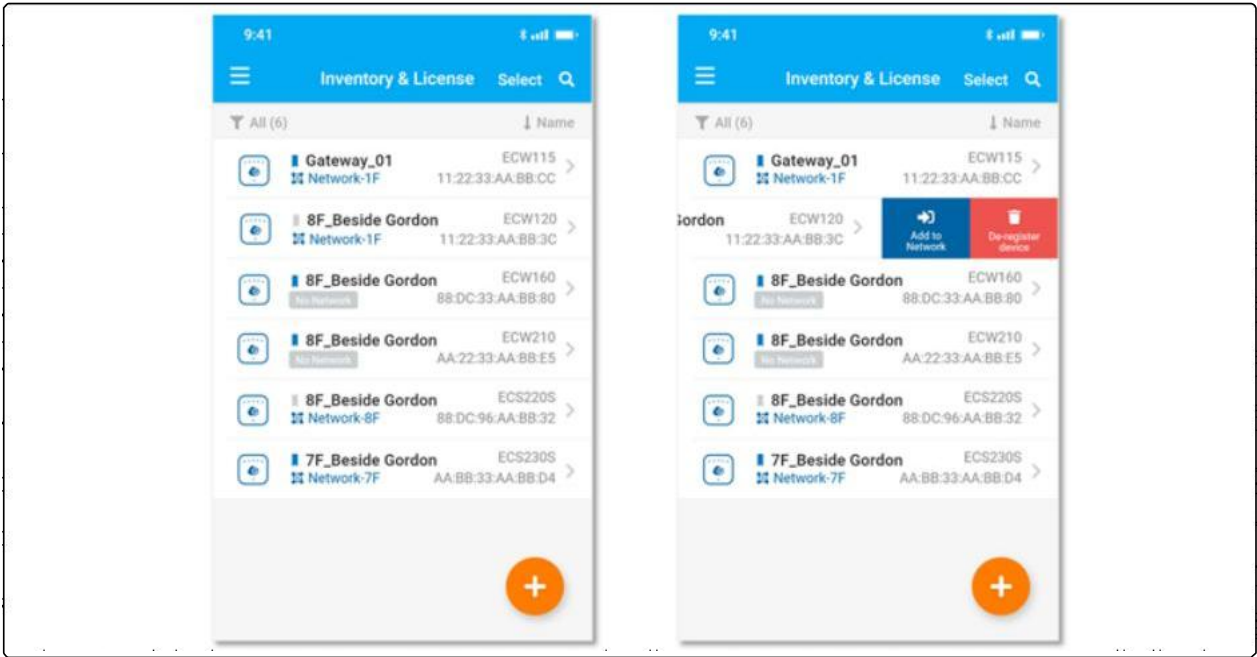

Assign device to a managed Network

Senao Cloud Platform

Log in to the Senao Cloud Platform: <https://cloud.Senao.ai/>.

Go to the *home* > *Inventory&License* page and click "Register Device".

Enter the Serial Number of the device(s) for device registration. Please refer to "[User Manual- Registering Devices to Organization](#)".

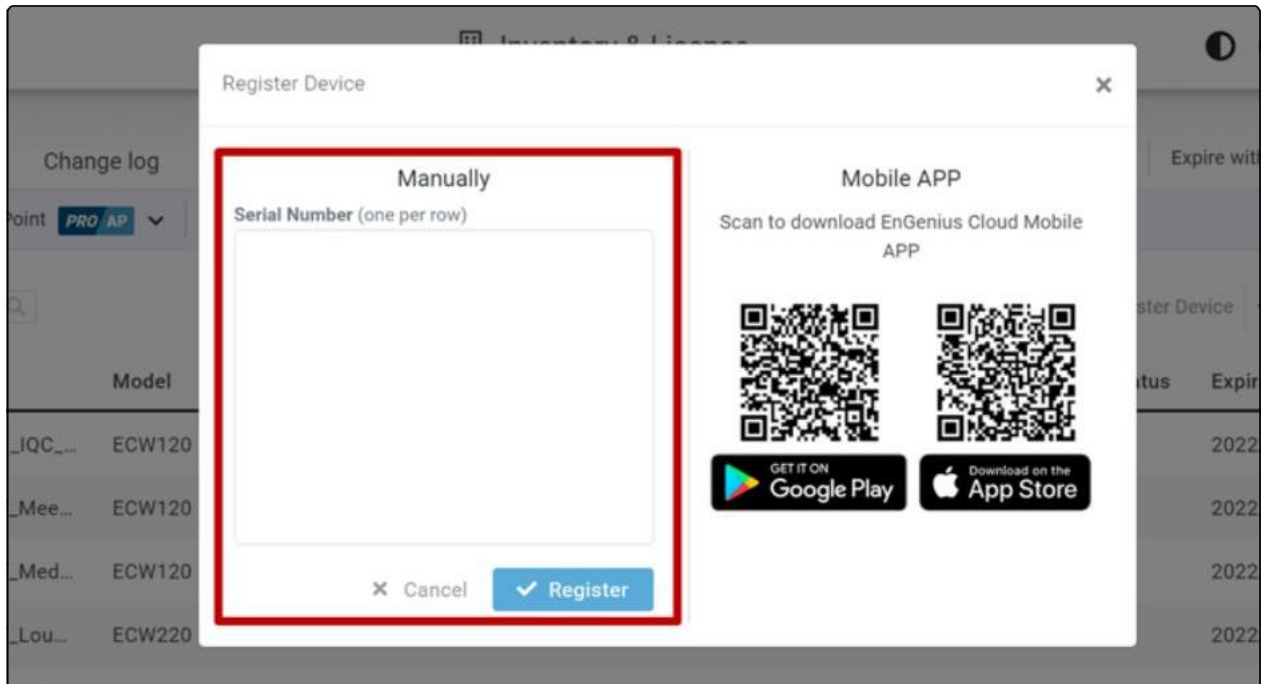

Register device(s) with device's Serial Number

4. Select the registered device and click "Assign to Network" to add the device to your personalized Network.

i **Network:** Management domain shared same configurations within Senao Cloud.

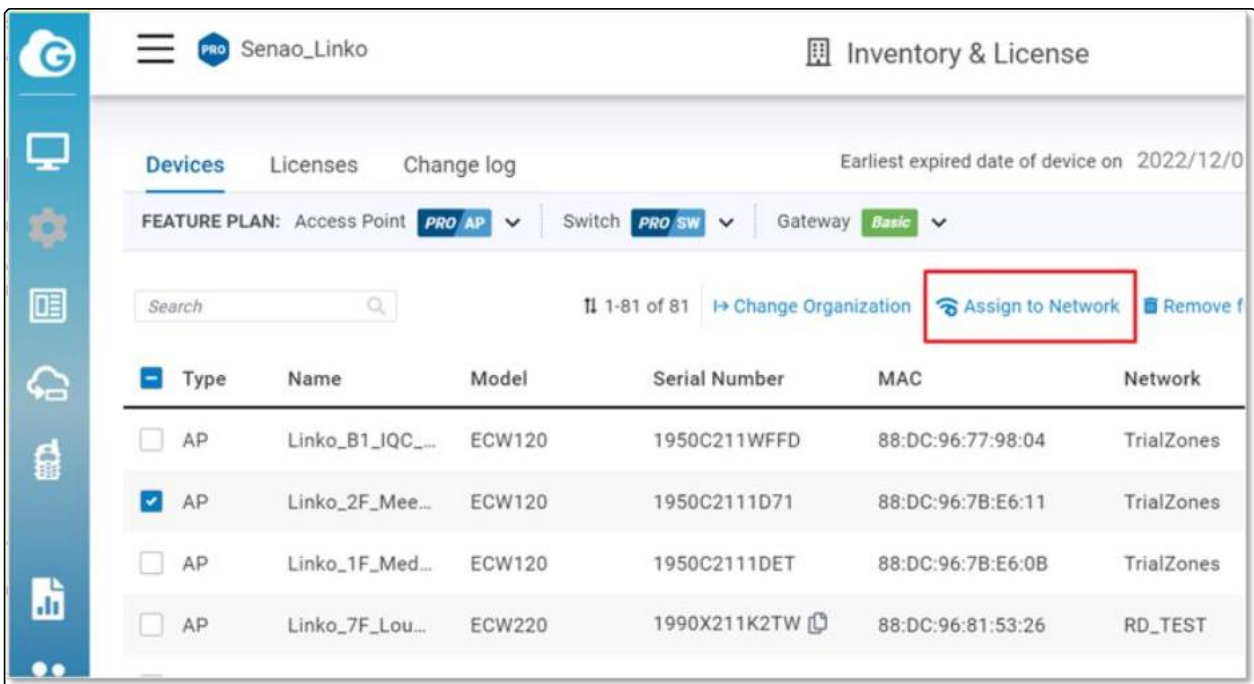

Assign selected device(s) to a managed Network

Step2: Power On Device

The Senao Cloud AP devices can be powered by any of the following:

- Senao Cloud PoE Switch or 802.3af/ 802.3at PoE+ compliant Switch Senao PoE adaptor (EPA5006GP/EPA5006GAT)
- Power Adapter (DC 12V/2A power input)

! Do not use both power sources at the same time.

Connecting to a PoE Switch

Connect the Ethernet cable from the Senao Cloud AP directly to the PoE port of the PoE switch.

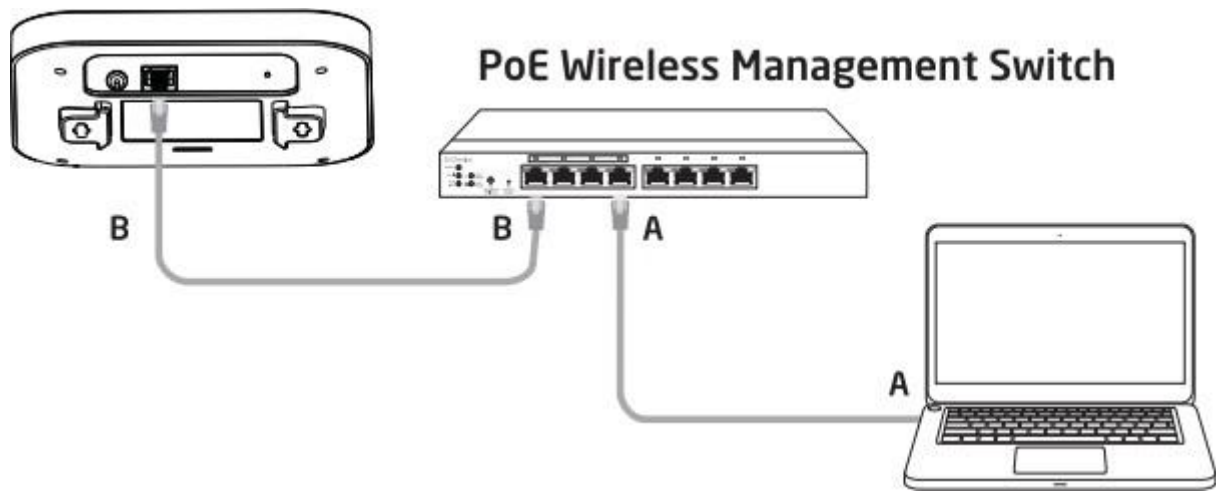

AP is powered by a PoE Switch

Powered with a PoE Adapter

(A) Connect one end of the Ethernet cable into the LAN (PoE) port of Senao Cloud AP and the other end to the PoE port on the PoE Adapter.

(B) Connect the power cord with the PoE Adapter and plug the other end into an electrical outlet. (C) Connect the second Ethernet cable into the LAN port of the PoE Adapter and the other end to the Ethernet port on the computer.

- ⓘ Please ensure to use cat5/cat5e UTP/STP RJ45 Ethernet cables.

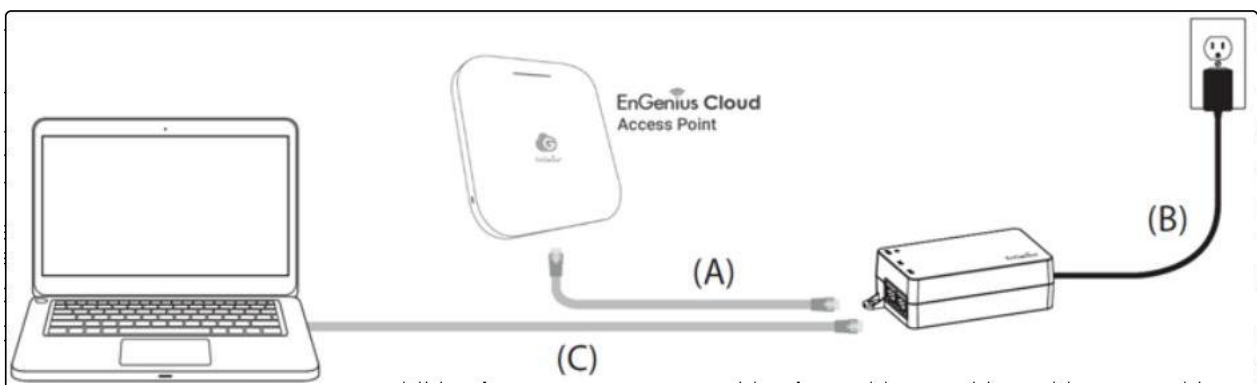

Powered with a Power Adapter

Connect the Power Cord to the adapter, and then plug the Power Cord into the power outlet.

AP is powered with a power adapter

Step3: Connect to the Senao Cloud

Once the device is powered on and ready to connect to the Internet, the LED indicator will stay **Solid On**, which means the device is now connected to the Senao Cloud Platform. It will automatically download the default configuration settings from Senao Cloud for automated provisioning.

! When the Access Point is connected to the Senao Cloud Platform for the first time, it will automatically check the latest firmware version available. If the firmware upgrade is required, it might take 8-10 minutes to complete. The LED indicator will be **Flashing** (0.5 sec) until the process is finished.

Step4: Manage with the Senao Cloud

Log in to the [Senao Cloud platform](#) to configure detailed settings. For more information, please refer to [User Manual](#).

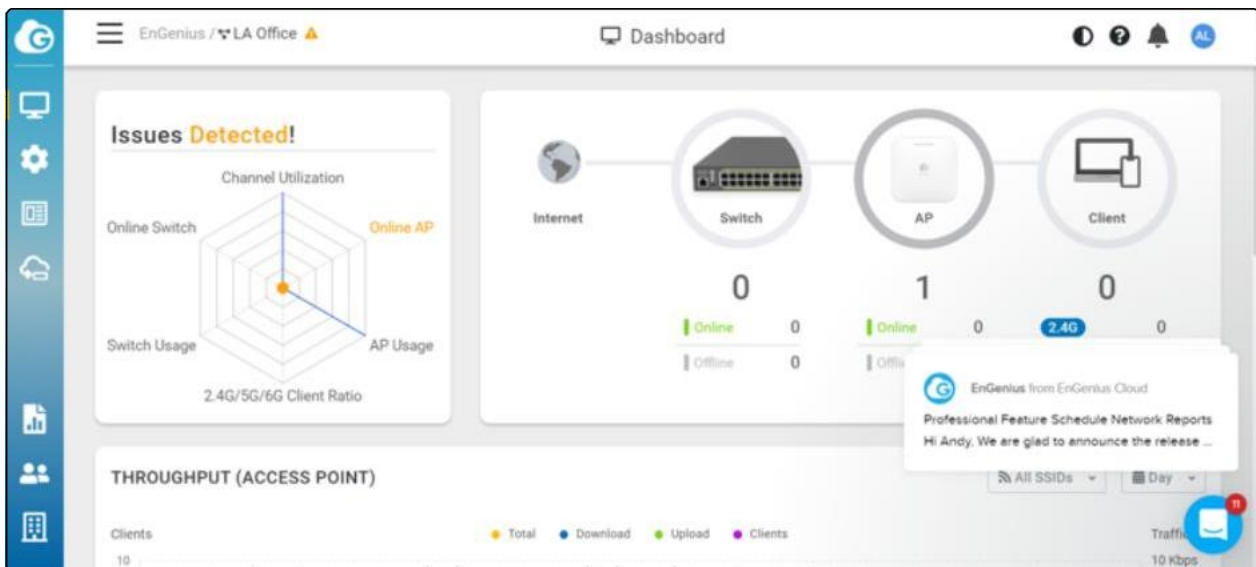

Senao Cloud Dashboard

Troubleshooting

If the Senao Cloud Platform cannot manage your AP, there might be a problem with connecting to Senao Cloud.

To troubleshoot the connection issue, you may log in to the Device Local Access page:

Use your client device (e.g., a laptop, mobile device, or tablet) to find the SSID: "EnMGMTxxxx" (xxxx is the last four digits of MAC MAC would be found on the back of the device) and connect to it.

Under your web browser, enter the URL <http://Senao.local> or <http://192.168.1.1> to access the device's user interface.

You can review the device status after logging into the AP with the default admin account/password (**admin/admin**).

Check the information on Network Connectivity and take action if necessary.

 [Change IP Assignment Settings](#)

By default, the Senao Cloud Access Point (ECW series) is assigned an IP address dynamically by the DHCP server. If you encounter issues with IP address assignment, please double-check the IP setting, including IP address, subnet mask, gateway, proxy, and management VLAN. If the issue still exists, you may change your IP assignment from "*DHCP mode*" to "*Static IP*" via the following procedure.

Go to the Local Setting section.

Change IPv4 settings to "*Use Static IP*".

Configure the *IP address, gateway, subnet mask, and proxy* settings.

Reconnect this device to the LAN network and try again.

IPv4 Settings

- As DHCP Client: Get IP from LAN DHCP Server (default)
- Use Static IP

IPv6 Settings

Link-local Address

Spanning Tree Protocol (STP) Settings

Status Enable Disable

Management VLAN Settings

- Untagged
- Tagged VLAN ID 4094 (1-4094)

Firmware Upgrade

Drag & drop firmware file to upgrade here
選擇檔案 未選擇任何檔案 提交

Miscellaneous

HTTP Proxy

Address 192.168.10.25
Port 80

Authorization

HTTPS Proxy Copy HTTP settings

Address 192.168.10.25
Port 80

Authorization

No Proxy for 192.168.100.0/24 192.168.110.0/24

Compliance

FCC

This device complies with Part 15 of the FCC Rules. Operation is subject to the following two conditions:

(1) This device may not cause harmful interference, and (2) this device must accept any interference received, including interference that may cause undesired operation.

This equipment has been tested and found to comply with the limits for a Class B digital device, pursuant to Part 15 of the FCC Rules. These limits are designed to provide reasonable protection against harmful interference in a residential installation. This equipment generates uses and can radiate radio frequency energy and, if not installed and used in accordance with the instructions, may cause harmful interference to radio communications. However, there is no guarantee that interference will not occur in a particular installation. If this equipment does cause harmful interference to radio or television reception, which can be determined by turning the equipment, the user is encouraged to try to correct the interference by one of the following measures:

Reorient or relocate the receiving antenna.

Increase the separation between the equipment and receiver.

Connect the equipment into an outlet on a circuit different from that to which the receiver is connected.

Consult the dealer or an experienced radio/TV technician for help.

FCC Caution:

Any changes or modifications not expressly approved by the party responsible for compliance could void the user's authority to operate this equipment.

This transmitter must not be co-located or operating in conjunction with any other antenna or transmitter.

Operations of this device is indoor use only; the 5.150 - 5.250GHz band are restricted to indoor usage only. This device meets all the other requirements specified in Part 15E, Section 15.407 of the FCC Rules.

Radiation Exposure Statement:

This equipment complies with FCC radiation exposure limits set forth for an uncontrolled environment. This equipment should be installed and operated with a minimum distance of 20 cm between the radiator & your body.

CE

The device complies with Directive 2014/53/EU issued by the Commission of the European Community.

Standards:

ETSI EN 300 328 V2.2.2 (2019 07)
ETSI EN 301 893 V2.1.1 (2017 05) Final Draft
ETSI EN 303 687 V0.0.20 (2022 03)
EN 55032:2015+A1:2020 EN 55035:2017/A11:2020 ETSI
EN 301489 1 V2.2.3 (2019 11)
ETSI EN 301 489 17 V3.2.4 (2020 09)
EN 62368 1:2014+A11: 2017
EN 62311: 2020

UKCA

The device is in conformity with the relevant legislation of United Kingdom: 2017 (S.I. 2017/1206)/
Regulations 2016 (S.I. 2016/1091)/ Regulations 2016 (S.I. 2016/1101).

Standards:

EN 300 328 V2.2.2 (2019 07)
EN 301 893 V2.1.1 (2017 05) Final Draft
EN 303 687 V0.0.20 (2022 03)
EN 55032:2015+A1:2020
EN 55035:2017/A11:2020
EN 301489 1 V2.2.3 (2019 11)
EN 301 489 17 V3.2.4 (2020 09)
EN 62368 1:2014+A11: 2017
EN 62311: 2020
IR 2030

systèmes de satellites mobiles utilisant les mêmes canaux

Declaration of Conformity

Hereby, Senao Networks declare that this product is in compliance with:

Directive 2014/53/EU

Regulations 2017 (S.I. 2017/1206)/ Regulations 2016 (S.I. 2016/1091)/ Regulations 2016 (S.I. 2016/1101)

RoHS 2015/863

WEEE 2022

REACH Regulation

Disclaimer/ Note

Maximum data rates are based on the IEEE standards. Actual throughput and range may vary depending on many factors including environmental conditions, the distance between devices, radio interference in the operating environment, and the mix of devices in the network.

Features and specifications are subject to change without notice.

This device complies with Part 15 of the FCC Rules.

Operation is subject to the following two conditions: (1) this device may not cause harmful interference, and (2) this device must accept any interference received, including interference that may cause undesired operation.

Trademarks and registered trademarks are the property of their respective owners. For the United States of America: Copyright © 2026 Senao Technologies, Inc. All rights reserved.