

Mobile Mixer Stand

ASSEMBLY INSTRUCTIONS

CAUTION

INSPECT CONTENTS IMMEDIATELY AND FILE CLAIM WITH DELIVERING CARRIER FOR ANY DAMAGE.
SAVE YOUR BOX AND ALL PACKING MATERIALS.
YOU ARE RESPONSIBLE FOR DAMAGE TO YOUR UNIT IF RETURNED IMPROPERLY PACKED.

Parts List

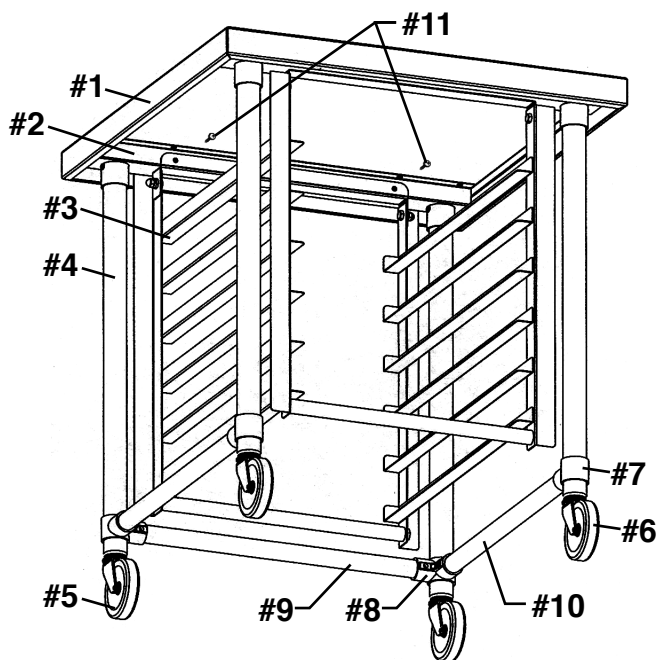

#	qty	part	description
#1	1	330126	Table Top
#2	2	348345	Leg Channel
#3	1	315463	Tray Slide Rack
#4	4	315461	Leg
#5	2	300699	Caster
#6	2	300698	Caster with Brake
#7	2	317646	Front Fitting
#8	2	317647	Corner Fitting
#9	1	317663	Side-to-side Crossbrace
#10	2	317643	Front-to-back Crossbrace
#11	6	300794	#8 x 1/2" Screw
#12	4	377798	1/8" - 16 x 1/2" Hex Cap Screw
#13	4	305010	Flat Washer
#14	4	306122	Lock Washer
#15	4	306137	Cap Nut
#16	4	300962	1/2" - 13 x 1 1/2" Bolt
#17	4	311243	5/16" - 24 Set Screw

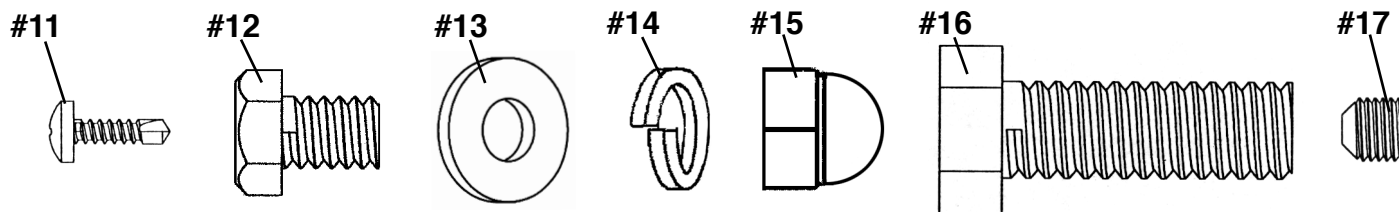

(actual size of hardware)

(continued on page 2)

Mobile Mixer Stand

ASSEMBLY INSTRUCTIONS

Step 1 - Assemble rack (Item #3) and set aside.

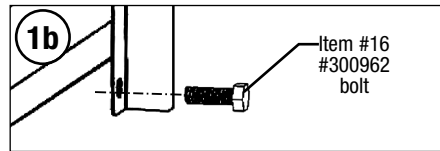
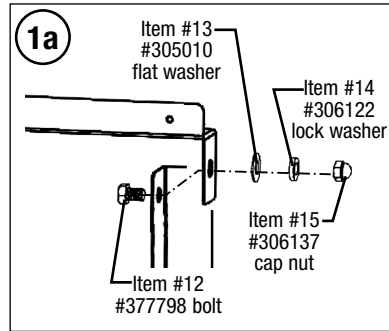
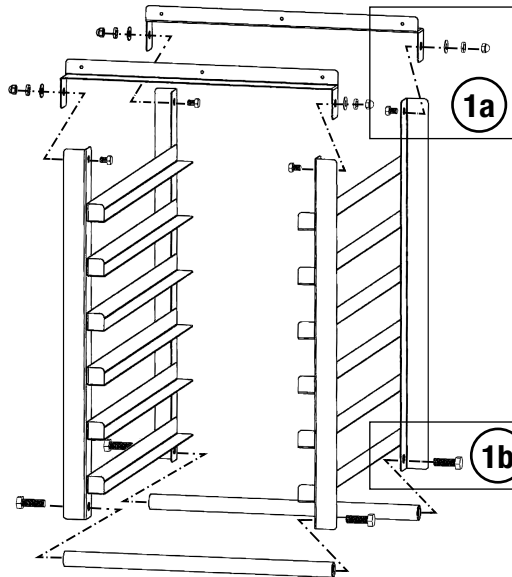

Step 2 - Assemble crossbrace subassembly.

- Loosen Item #17 set screws* in Items #7 and #8 castings.
- Assemble castings to Items #9 and #10 crossbracing, as shown.
- With 5/32" allen wrench, tighten set screws* in the appropriate threaded hole in castings (see below).

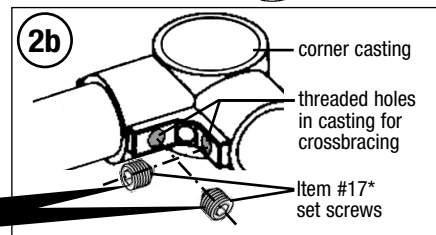
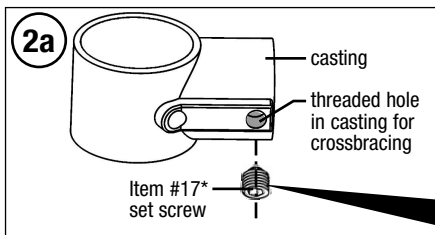
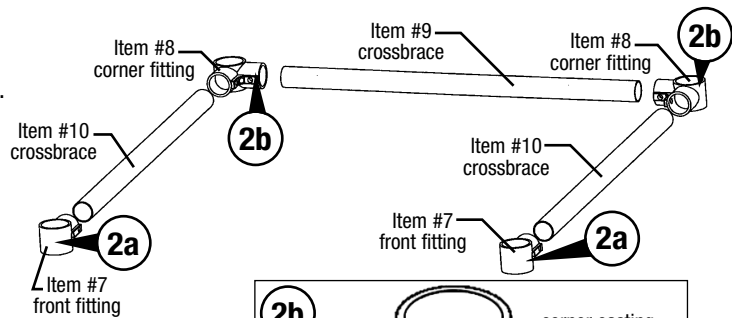

*** To meet NSF standards:**
Set screws must be filled
with NSF-approved sealant.

Step 3 - Slide legs through crossbrace subassembly and snug set screws*.

- Loosen Item #17 set screws* in Items #7 and #8 castings of crossbrace subassembly.
- Insert legs through castings. Position legs so that approximately 1" of each leg protrudes through each casting.
- With 5/32" allen wrench, tighten set screws* in the appropriate threaded hole in castings (see below).

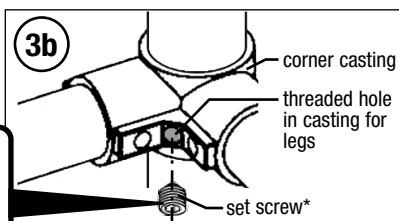
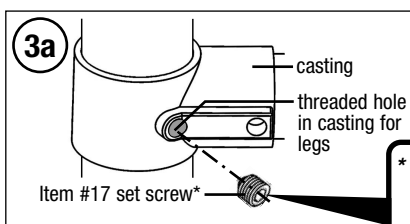
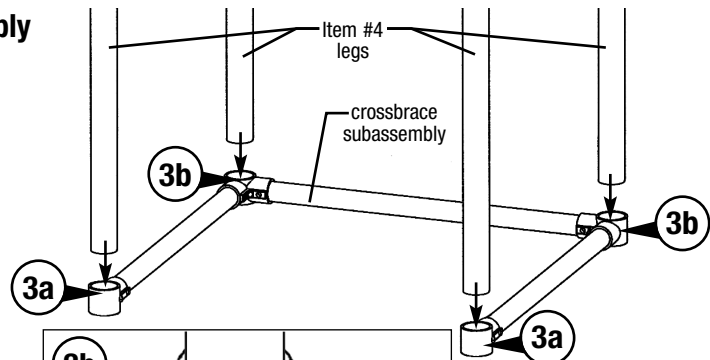

*** To meet NSF standards:**
Set screws must be filled
with NSF-approved sealant.

(continued on page 3)

